

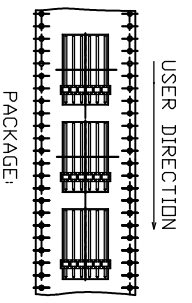

**THE DATASHEET OF  
68004-202HLF**

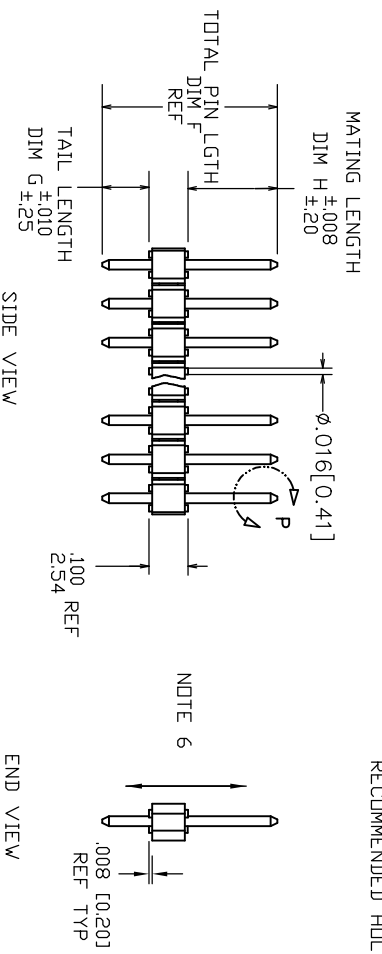

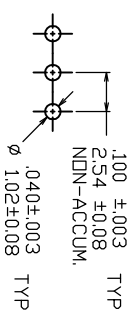
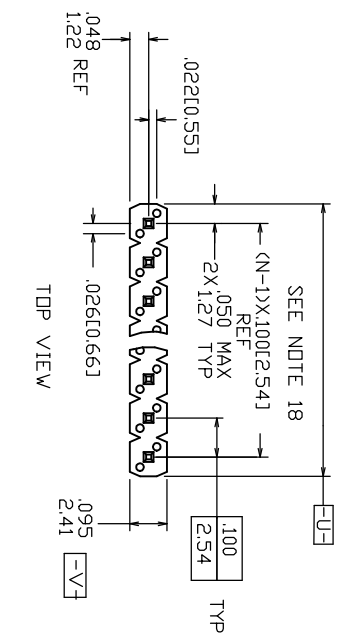
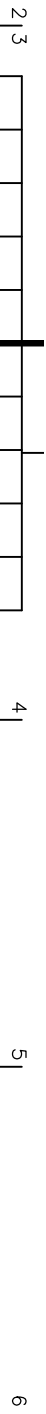

DRAWING ONLY FOR 68000-406160035ALF

BELOW)  
SEE NOTE 15 & 16)  
BELOW)  
SEE NOTE 15 & 16)  
NOTE 1)

mat'l code		surface		tolerance		projection		product family			
NOTES 2 & 3		ISD 1302		ISD 405		INCH/MM		BERGSTIK			
ltr	ecn no	dir	date	tolerances unless otherwise specified	angle	line or	scale	title			
CY	EX-+-01995	JZ	2012-06-12	XXX01/XX3			1:1	BERGSTIK® II HEADER			
DA	EX-+-1605	ZK	2013-10-22	XXX0006/XX415				100/2.54cc SR STRAIGHT			
DB	EX-+-1299	ZK	2014-03-27	09Z2							
DC	EX-+-28578	MZ	2017-11-23	dir	09Z2	XXX0002/XXX008					
				engr	T.BREWBAKER	01/05/95					
				chr	JMURPHY	01/05/95					
				pppd	T.HANNA	01/05/95					
sheet	revision	DC	DC	DC	DC	DC	DC	DC	DC		
index	sheet	1	2	3	4	5	6	7	8		
dwg no		sheet 1 of 8		size							
68000		A3									
type		Product Customer		Drawing							

ER 50u"/1.27u MIN NI
R 50u"/1.27u MIN NI
ER 50u"/1.27u MIN NI
7u MIN NI (SEE NOTE 14)
R 50u"/1.27u MIN NI
R 50u"/1.27u MIN NI
R 50u"/1.27u MIN NI
R 50u"/1.27u MIN NI
R 50u"/1.27u MIN NI
R 50u"/1.27u MIN NI
R 50u"/1.27u MIN NI

2

- ③ PIN MATERIAL : PHOS-BRONZE.
- ④ MEASURED WITH PART IN RESTRAINED CONDITION.
- 5. TWO SIDES OF PIN TIPS NOT PLATED. TYPICAL BOTH ENDS.
- ⑥ 2LBS/0.9KG MIN PIN RETENTION IN EITHER DIRECTION.
- ⑦ PIN CANNOT PROTRUDE PAST EDGE OF HOUSING. MUST BE .005±.005/13±.13 FROM END OF HOUSING HOLE.
- 8. MILITARY BERGSTIK HEADER  
P/N XXXXX-XXX-MIL.  
NOT AVAILABLE.

3

- ⑨ ±.010/0.25 TOL APPLIES TO ALL 'G' TAILS EXCEPT INDICATED PARTS ON TABLE WHERE +.010/0.25 -.000/0.00 APPLIES.
- ⑩ INDICATED PART NUMBERS ARE PRODUCED AND SOLD IN THE TAIWAN/SINGAPORE AREAS. THESE ARE NOT AVAILABLE IN BERGSTIK CONTINUOUS STRIP.
- ⑪ NOTCH CONFIGURATION WILL VARY PER VENDOR'S DISCRETION.
- ⑫ THESE PRODUCTS MEETS EUROPEAN UNION DIRECTIVES AND OTHER COUNTRY REGULATION AS DESCRIBED IN GS-22-008.
- ⑬ PLATING OPTIONS:  
PERFORMANCE PLATING WILL BE EITHER GOLD OR GXT ON POST OR TAIL, OPTIONALLY (78-295u"/2-75u) TIN ON TAIL.
- ⑭ THIS PRODUCT HAS 100% TIN PLATING IN THE INTERFACE AND HAS NOT BEEN TESTED FOR WHISKER GROWTH IN ALL INTERCONNECT ENVIRONMENTS.
- ⑮ THE DAL DON'T EXCEED 34.5mm
- ⑯ INCREMENTS BY 0.1mm IN LENGTHS ONLY

B

- ⑰ FOR SPECIAL PACKAGING REQUEST PLEASE CONTACT PRODUCT MANAGER FOR AVAILABILITY
- ⑱ TO DETERMINE DIMENSIONS:  
N=NUMBER OF POSITION PER ROW  
EXAMPLE: 10 POS. N X .100/2.54
- 19. 68000-406160035ALF IS SPECIAL PART NUMBER. IT IS 6PIN, MATING LENGTH IS 16mm. TAIL LENGTH IS 35mm. AND PACKAGE IS TAPE AND REEL AND NO CAP.

4

www.fciconnect.com		surface	tolerance std	projection	INCH/MM
		ISD 1302	ISD 406 ISD 1101		
TOLERANCES UNLESS OTHERWISE SPECIFIED					Scale 1.000
Dp	T3REWBAKER	01/05/95	ANGULAR	0X	±0.3
Eng	THANNA	01/05/95	LINEAR	0XX	±0.15
Chr	JMRPRHY	01/05/95	0° ±2°	0XXX	±0.05
Appr	THANNA	01/05/95	Product family	BERGSTIK	Spec ref
FCI logo		BERGSTIK® II HEADER		68000	
catalog no		.100/2.54cc SR STRAIGHT		CUSTOMER	
				sheet 2 of 8	
				Rev. DC	

D

DN, PCT FILLED TURE LCP 94V-0. FIX WILL WITHSTAND EXPOSURE ENDS IN E SOLDER PROCESS.

4

C

2

3

4

HEADER

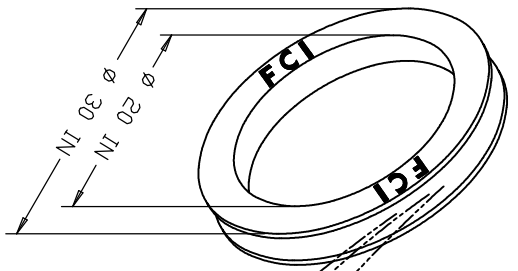
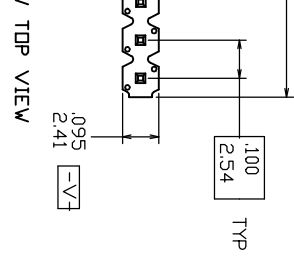

REEL PACKING DIMENSIONS  
UNREELING DIRECTION

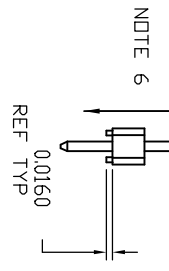
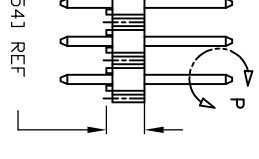
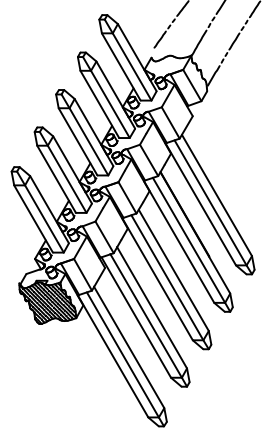

SINGLE ROW  
END VIEW

2

PDS: Rev:DC

STATUS:Released

3

Printed: Dec 14, 2017

4

www.fciconnect.com				surface ISD 1302 ✓		tolerance std ISD 406 ISD 110		projection		INCH/MM	
TOLERANCES UNLESS OTHERWISE SPECIFIED				ANGULAR		LINEAR		size		Scale 1.000	
Dr	T.BREWBAKER	01/05/95	01/05/95	0X	±0.3	±0.15	±0.05	A4			
Eng	THANNA	01/05/95	01/05/95	0XX	±0.15	±0.05	±0.05	ENI			
Chr	JMURPHY	01/05/95	01/05/95	0	±2°	±0.05	±0.05	Spec ref			
Appr	THANNA	01/05/95	01/05/95	Product family		BERGSTIK					
FCI logo				BERGSTIK® II HEADER				CUSTOMER		68000	
catalog no				.100/2.54cc SR STRAIGHT				Rev.		DC	

2

3

4

ITEM	MATING	LENGTH	BERGSTRIPTM	LF
TRIC	ENGLISH	METRIC	AVAILABLE	OPTION
41	0-120	3.05	NO	DB
33	0-310	7.87	NO	DB
35	0-310	7.87	NO	DB
41	0-240	6.10	NO	DB
41	0.230	5.84	YES	NOTE 1,12
05	0.230	5.84	YES	
81	0.230	5.84	YES	
95	0-230	5.84	NO	DB
72	0.318	8.08	YES	
81	0.318	8.08	YES	
55	0.230	5.84	NO	DB
41	0-230	5.84	NO	DB
01	0.135	3.43	NO	
02	0.400	10.16	NO	
27	0.230	5.84	NO	
16	0.230	5.84	NO	
41	0.318	8.08	NO	
80	0-230	5.84	NO	DB
92	0-610	15.49	NO	DB
30	0.318	8.08	NO	
11	0-230	5.84	NO	DB
25	0.697	17.70	NO	
49	0-400	10.16	NO	DB
86	0-230	5.84	NO	DB
59	0-318	8.08	NO	DB
79	0-495	12.57	NO	DB
43	0-230	5.84	NO	DB
65	0-230	5.84	NO	DB
16	0.427	10.85	NO	
05	0.335	8.51	NO	
05	0.380	9.65	NO	NOTE 1,12

www.fciconnect.com		surface		tolerance std		projection		INCH/MM	
ISD 1302		ISD 406		ISD 1101		ISD 1101		Scale	
TOLERANCES UNLESS OTHERWISE SPECIFIED		ANGULAR		LINEAR		size		1,000	
Dr	T.BREWBAKER	01/05/95	0°	0X	±0.3	±0.3	A4		
Eng	THANNA	01/05/95	±2°	0XX	±0.15	±0.15	ENI		
Chr	J.MURPHY	01/05/95	Product family	0XXX	±0.05	±0.05	Spec ref		
Appr	THANNA	01/05/95	BERGSTIK® II HEADER	BERGSTIK	68000	68000	Rev.	DC	
			100/2.54cc SR STRAIGHT	CUSTOMER	sheet 4 of 8				

ENGTH	MATING	LENGTH	BERGSTRIPTM	LF
DIM G	DIM H	DIM H	AVAILABLE	OPTION
METRIC	ENGLISH	METRIC	NOTES	
-5.16	0.318	8.08	POLY-BAGS	NO
-6.93	0.230	5.84	POLY-BAGS	NO
-5.16	0.400	10.16	POLY-BAGS	NO
-10.49	0.230	5.84	POLY-BAGS	NO
5.72	0.318	8.08	POLY BAGS	NO
-17.35	0.230	5.84	POLY-BAGS	NO
-14.81	0.230	5.84	POLY-BAGS	NO
-17.02	0.700	17.78	POLY-BAGS	NO
2.41	0.540	13.72	POLY BAGS	NO
-17.02	0.280	7.11	POLY-BAGS	NO
7.37	0.318	8.08	POLY BAGS	NO
-15.57	0.400	10.16	POLY-BAGS	NO
9.35	0.120	3.05	POLY BAGS	NO
-3.30	0.590	14.99	POLY-BAGS	NO
-10.11	0.110	2.79	POLY-BAGS	NO
-14.63	0.458	11.63	POLY-BAGS	NO
-5.41	0.600	15.24	POLY-BAGS	NO
2.41	0.200	5.08	POLY BAGS	NO
7.24	0.230	5.84	POLY BAGS	NO
-5.72	0.230	5.84	POLY-BAGS	NO
-11.18	0.340	8.64	POLY-BAGS	NO
-13.21	0.396	10.06	POLY-BAGS	NO
-13.54	0.533	13.54	POLY-BAGS	NO
-8.97	0.350	8.89	POLY-BAGS	NO
-5.41	0.275	6.99	POLY-BAGS	NO
2.54	0.270	6.86	POLY BAGS	NO
-6.93	0.318	8.08	POLY-BAGS	NO

www.fciconnect.com		surface ISD 1302		tolerance std ISD 406 ISD 1101		projection		INCH/MM	
TOLERANCES UNLESS OTHERWISE SPECIFIED		ANGULAR		0X		±0.3		Scale 1.000	
Dr	T.BREWBAKER	01/05/95	LINEAR	0XX	±0.15	size A4			
Eng	THANNA	01/05/95	0°	±2°	±0.05	ENI			
Chr	JMURPHY	01/05/95	Product family		Spec ref				
Appr	THANNA	01/05/95	BERGSTIK		68000				
FCI		BERGSTIK® II HEADER		CUSTOMER		sheet 5 of 8		Rev. DC	
100/2.54cc SR STRAIGHT		catalog no							

ENGTH	MATING	LENGTH		BERGSTRIPTM	LF
DIM G	DIM H	DIM H		AVAILABLE	OPTION
<del>1.57</del>	<del>0.338</del>	<del>8.59</del>		<del>NO</del>	<del>OB</del>
<del>10.74</del>	<del>0.110</del>	<del>2.79</del>		<del>NO</del>	<del>OB</del>
5.41	0.100	2.54		NO	NOTE 1,12
<del>0.00</del>	<del>0.350</del>	<del>8.89</del>		<del>NO</del>	<del>OB</del>
<del>3.05</del>	<del>0.500</del>	<del>12.70</del>		<del>NO</del>	<del>OB</del>
3.43	0.295	7.49		NO	
8.46	0.318	8.08		NO	
<del>4.32</del>	<del>0.170</del>	<del>4.32</del>		<del>NO</del>	<del>OB</del>
<del>2.92</del>	<del>0.449</del>	<del>11.40</del>		<del>NO</del>	<del>OB</del>
<del>2.29</del>	<del>0.740</del>	<del>18.80</del>		<del>NO</del>	<del>OB</del>
<del>2.54</del>	<del>1.000</del>	<del>25.40</del>		<del>NO</del>	<del>OB</del>
<del>2.29</del>	<del>0.910</del>	<del>23.11</del>		<del>NO</del>	<del>OB</del>
3.05	0.880	22.35		NO	
<del>15.49</del>	<del>0.318</del>	<del>8.08</del>		<del>NO</del>	<del>OB</del>
<del>8.46</del>	<del>0.230</del>	<del>5.84</del>		<del>NO</del>	<del>OB</del>
<del>3.05</del>	<del>0.458</del>	<del>11.63</del>		<del>NO</del>	<del>OB</del>
12.70	0.650	16.51		NO	
3.05	0.318	8.08		YES	
BLE				-	
BLE				-	
BLE				-	
BLE				-	
BLE				-	
3.94	0.175	4.45		NO	
<del>3.05</del>	<del>0.475</del>	<del>12.07</del>		<del>NO</del>	<del>OB</del>
<del>3.05</del>	<del>0.400</del>	<del>10.16</del>		<del>NO</del>	<del>OB</del>

NOTE 1,12

www.fciconnect.com				surface ISD 1302		tolerance std ISD 406 ISD 1101		projection		INCH/MM	
				TOLERANCES UNLESS OTHERWISE SPECIFIED				A4		Scale 1.000	
Dr	T.BREWBAKER	01/05/95	ANGULAR	0X	±0.3	size		A4			
Eng	THANNA	01/05/95	LINEAR	0XX	±0.15	ECN					
Chr	JMRRPH	01/05/95	0° ±2°	0XXX	±0.05	Spec ref					
Appr	THANNA	01/05/95	Product family	BERGSTIK		Spec ref					
FCI			BERGSTIK® II HEADER			68000			Rev. DC		
catalog no			.100/2.54cc SR STRAIGHT			CUSTOMER			sheet 6 of 8		

2

3

4

ENGTH	MATING	LENGTH		BERGSTRIIP™	LF
DIM G	DIM H	DIM H		AVAILABLE	OPTION
METRIC	ENGLISH	METRIC		NOTES	
3.05	0.120	3.05		YES	OB
3.81	0.120	3.05		YES	OB
3.05	0.220	5.59		YES	OB
3.05	0.230	5.84		NOTE 9	NO OB
BLE				-	NOTE 1,12
BLE				-	
BLE				-	
BLE				-	
2.54	0.700	17.78		NOTE 10	NO OB
3.05	0.800	20.32		POLY BAGS	NO OB
2.41	1.043	26.49		POLY BAGS	NOTE 10 NO
3.05	0.675	17.15		POLY BAGS	NO OB
3.05	0.780	19.81		POLY BAGS	NO OB
2.79	0.920	23.37		POLY BAGS	NO OB
3.05	0.160	4.06		POLY BAGS	NO
3.25	0.830	21.08		POLY BAGS	NO NOTE 1,12
2.41	0.341	8.66		POLY BAGS	NOTE 10 NO OB
2.54	0.700	17.78		POLY BAGS	NO OB
0.00	0.230	5.84		POLY BAGS	NOTE 7 NO OB

www.fciconnect.com				surface ISD 1302		tolerance std ISD 406 ISD 1101		projection		INCH/MM	
				TOLERANCES UNLESS OTHERWISE SPECIFIED						Scale 1.000	
Dr	T.BREWBAKER	01/05/95	ANGULAR	0X	±0.3	size	A4				
Eng	THANNA	01/05/95	LINEAR	0XX	±0.15	ECN					
Chr	JMURPHY	01/05/95	0° ±2°	0XXX	±0.05	Product family	BERGSTIK	Spec ref			
Appr	THANNA	01/05/95	BERGSTIK® II HEADER								
			.100/2.54cc SR STRAIGHT			CUSTOMER			68000		
FCI				catalog no		Rev. DC					

2

3



4

ENGTH	MATING	LENGTH	BERGSTRIPTM	LF
DIM G	DIM H	DIM H	AVAILABLE	OPTION
3.43	0.433	11.00	NOTE 10	OB
2.41	0.313	7.95	NOTE 10	OB
2.69	0.178	4.52	NO	OB
2.79	0.230	5.84	YES	OB
5.72	0.900	22.86	NO	NOTE 1,12
2.39	0.178	4.52	NO	OB
3.00	0.354	8.99	NO	OB
1.50	0.235	5.97	NO	OB
2.16	0.400	10.16	NO	OB
3.30	0.711	18.06	NO	OB
2.16	0.230	5.84	NO	OB
3.51	0.138	3.51	NOTE 10	NO
7.98	0.178	4.52	NO	OB
3.30	0.330	8.38	NOTE 10	OB
2.41	0.125	3.18	NO	OB
1.52	0.400	10.16	NO	OB
14.00	0.531	13.49	NOTE 10	OB
3.20	0.144	3.66	NOTE 10	OB
3.94	0.400	10.16	NO	OB
2.41	0.969	24.61	NOTE 10	OB
10.67	0.090	2.29	NO	OB
2.41	0.280	7.11	NO	OB
2.41	0.095	2.41	NO	OB
2.9	0.265	6.75	YES	OB
3.30	0.105	2.67	NO	OB
3.05	0.406	10.3	POLY BAGS/TAPE REEL	NOTE 1,12

www.fciconnect.com		surface		tolerance std		projection		INCH/MM	
ISD 1302		ISD 406		ISD 1101		A4		Scale 1.000	
TOLERANCES UNLESS OTHERWISE SPECIFIED		0X		±0.3		A4			
DIP		T3REWBAKER		01/05/95		ANGULAR			
Eng		THANNA		01/05/95		LINEAR			
Chr		JMRPHY		01/05/95		0XX		±0.15	
Appr		THANNA		01/05/95		0XXX		±0.05	
FCI		BERGSTIK® II HEADER		Product family		BERGSTIK		Spec ref	
100/2.54cc SR STRAIGHT		CUSTOMER		68000		Rev.		DC	
catalog no		sheet 8 of 8							

## Looking for pricing, stock, or lifecycle information?

Click below to explore more details on WIN SOURCE:

-  [View 68004-202HLF on WIN SOURCE](#)
-  [Amphenol FCI Information](#)

## Optimize Your Supply Chain with WIN SOURCE Solutions

-  Global Sourcing Solution
-  Obsolete Management
-  Cost Control Management
-  Shortage Management
-  Alternative Solution
-  Excess Inventory Management