



**THE DATASHEET OF**  
**6-1419121-6**



3

2

1

DATE: 16-DEC-13  
REVISED: 26-JUL-12

LOC: HB  
DIST: -

REVISIONS

P	LTR	DESCRIPTION	DATE	DMN	APVD
D		1.CHANGE LOGO, 2.VENT HOLE SHAPE, 3.ADD TERMINALS PLATING THICKNESS LINE IDENTIFIER	26-JUL-12	D.L	BH.Y
E		CHANGE THE VENT HOLE SHAPE FROM RECTANGLE TO CIRCLE ONE	16-DEC-13	XL.Y	B.F

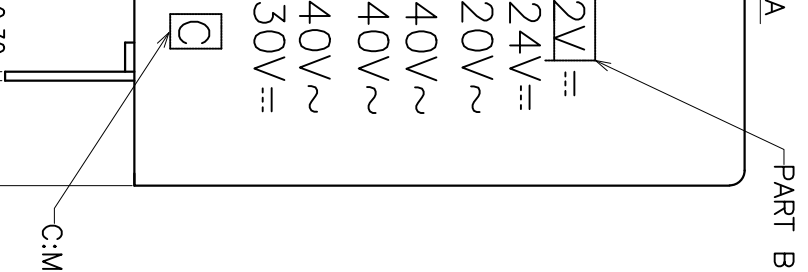
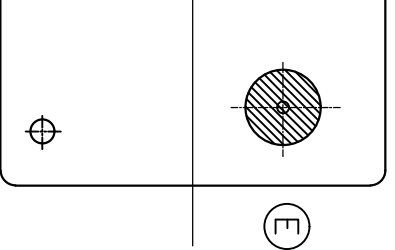

C:MADE IN CHINA

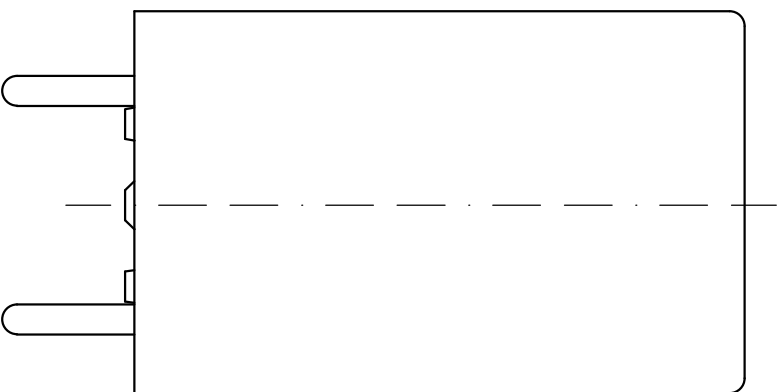
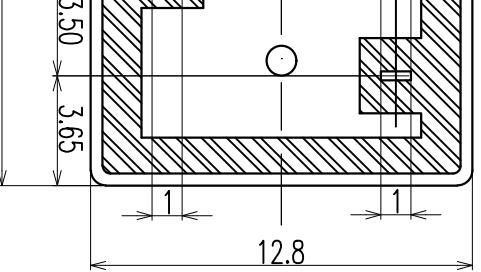

CONNECTION DIAGRAM (BOTTOM VIEW)

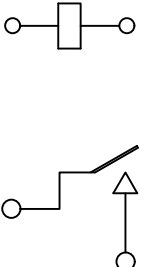

DRILLING DIAGRAM(2/1) (BOTTOM VIEW)

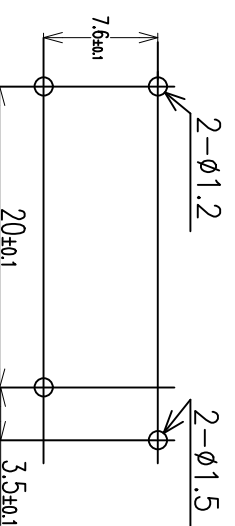

THIS DRAWING IS A CONTROLLED DOCUMENT.

DIMENSIONS: mm  
TOLERANCES UNLESS OTHERWISE SPECIFIED:

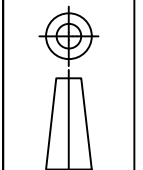

0 PLC	±
1 PLC	±
2 PLC	±
3 PLC	±
4 PLC ANGLES	±

MATERIAL

FINISH -



TE Connectivity

OMIH CUSTOMER DRAWING

DMN: Y.Xiao  
CHK: N.Fungyqmm  
APVD: CH.HSU  
PRODUCT SPEC: -  
APPLICATION SPEC: -  
WEIGHT: -

NAME: OMIH CUSTOMER DRAWING  
SIZE: A3  
CAGE CODE: 00779  
DRAWING NO: G=5-1419121-7  
SCALE: 4:1  
SHEET: 1 OF 2  
RESTRICTED TO: -

CUSTOMER DRAWING

REV E



## Looking for pricing, stock, or lifecycle information?

Click below to explore more details on WIN SOURCE:

[View 6-1419121-6 on WIN SOURCE](#)

[TE Connectivity Information](#)

## Optimize Your Supply Chain with WIN SOURCE Solutions

- ✓ Global Sourcing Solution
- ✓ Obsolete Management
- ✓ Cost Control Management
- ✓ Shortage Management
- ✓ Alternative Solution
- ✓ Excess Inventory Management