

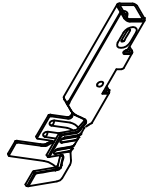

THE DATASHEET OF
460550005





D

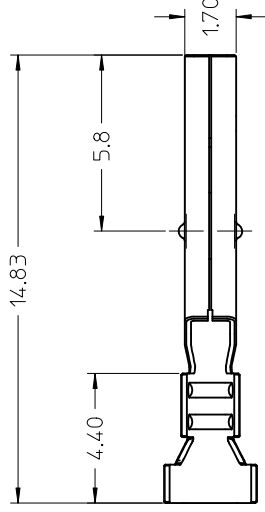

C

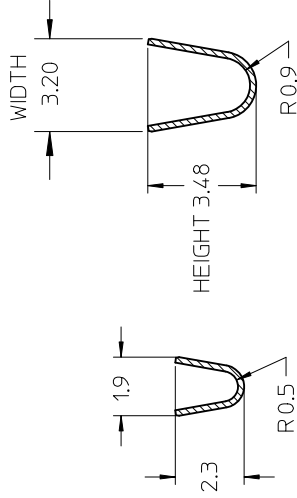

SECTION Y-Y
CONDUCTOR CRIMP

SECTION Z-Z
INSULATION CRIMP

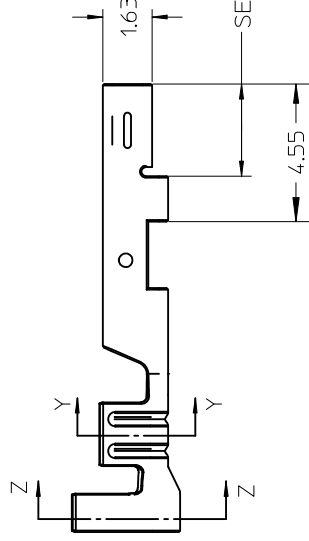

SEE NOTE 7

NOTES:

1. MATERIAL: HIGH PERFORMANCE
2. FINISH:
222 - OVERALL TIN: 100
228 - SELECT GOLD: 30
SELECT TIN: 100 MICRONS
OVER NICKEL
3. PRODUCT SPECIFICATION: PS
4. PACKAGING: REEL PACK PER
LOOSE PACK PER
5. TERMINAL TO BE USED WITH
6. WIRE SPECIFICATION: SEE CHART
7. WHEN USING OVERALL TIN FINISH
FOR APPLICATIONS INVOLVING
THERMAL CYCLING, MOLEX RECOMMENDS
THE USE OF NYE LUBRICANT
MATING END OF THE TERMINAL
BE APPLIED PRIOR TO INSULATION

B

LOOSE PACKAGED	REEL PACKAGED	FINISH	WIRE SPEC	INSULATION	INSULATION (CRIMPE
MATERIAL NUMBER	MATERIAL NUMBER			DIA	HEIGHT
46055-0007	46055-0005	222 - TIN	UL1015 18/20 AWG	2.52 / 2.81	MIN
46055-0008	46055-0006	228 - SELECT GOLD	UL1015 18/20 AWG	2.52 / 2.81	MAX
					MIN
					2.70
					2.70

UPDATE NOTE 4 EC NO: UCP201-1228 DRWN: JJAUGILAR 2010/10/29 CHKD: APPR: FSMITH 2010/11/09 DESCRIPTION	REV
	D2

QUALITY SYMBOLS	GENERAL TOLERANCES (UNLESS SPECIFIED)	DIMENSION STYLE
$\nabla = 0$ $\nabla = 0$ $\nabla = 0$	mm INCH 4 PLACES ± --- ± --- 3 PLACES ± --- ± --- 2 PLACES ± 0.25 ± --- 1 PLACE ± 0.38 ± --- ANGULAR ± 3 °	MM ONLY

DRAFT WHERE APPLICABLE MUST REMAIN WITHIN DIMENSIONS	SEE CHART
--	-----------

APPROVED BY FSMITH	DATE 2010/11/09	SCALE 4:1
CHECKED BY	DATE	TITLE
KSAMIEC	2007/03/22	RE

MATERIAL NO.	DOCUMENT NO.

Looking for pricing, stock, or lifecycle information?

Click below to explore more details on WIN SOURCE:

 [View 460550005 on WIN SOURCE](#)

 [Molex, LLC Information](#)

Optimize Your Supply Chain with WIN SOURCE Solutions

-  Global Sourcing Solution
-  Obsolete Management
-  Cost Control Management
-  Shortage Management
-  Alternative Solution
-  Excess Inventory Management