

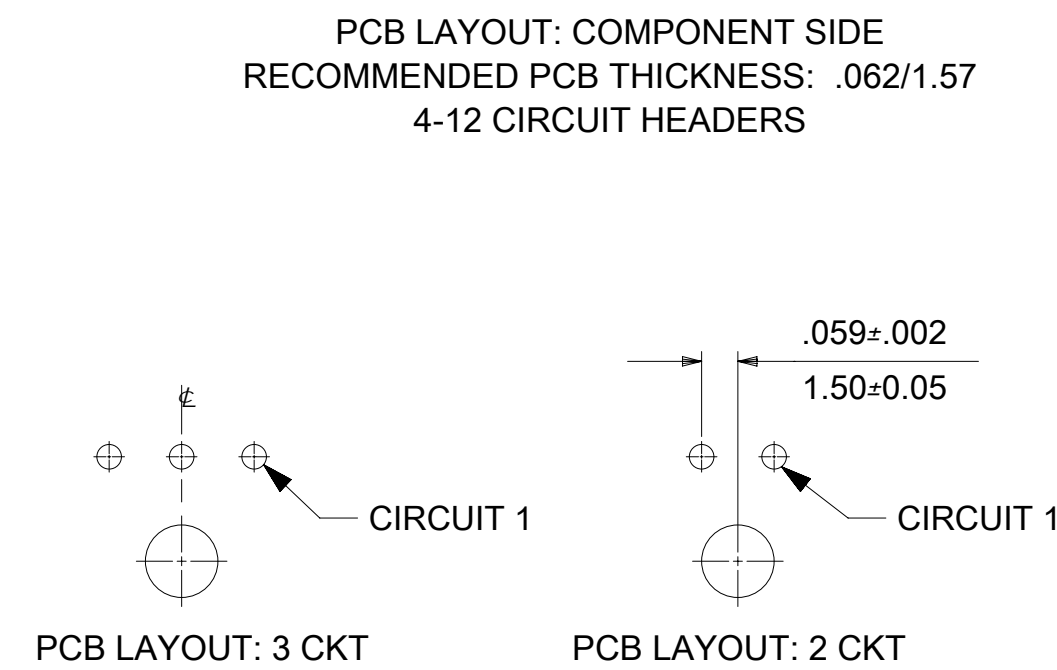

**THE DATASHEET OF
43650-0200**

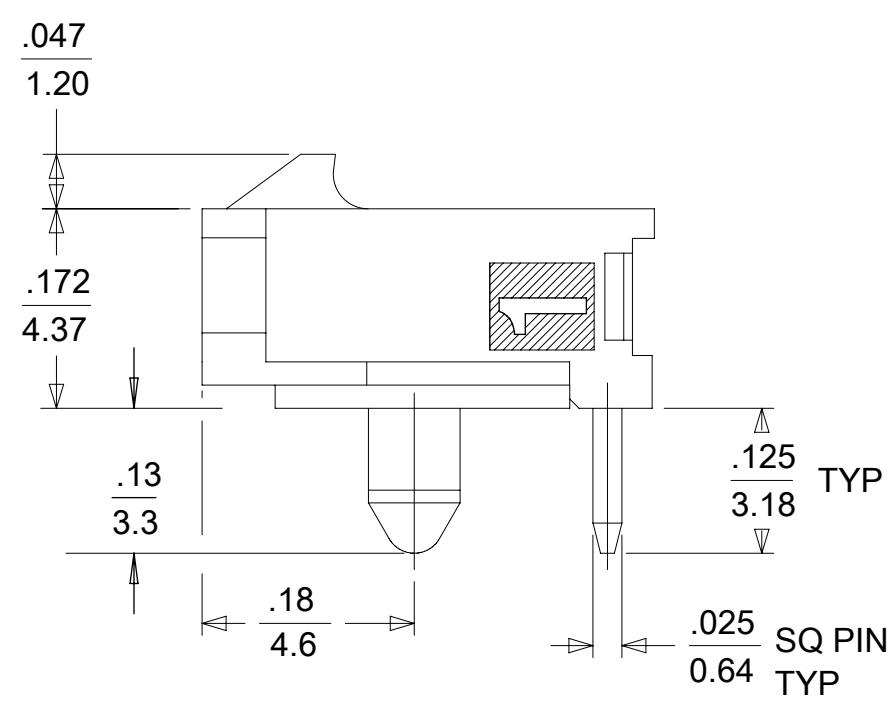

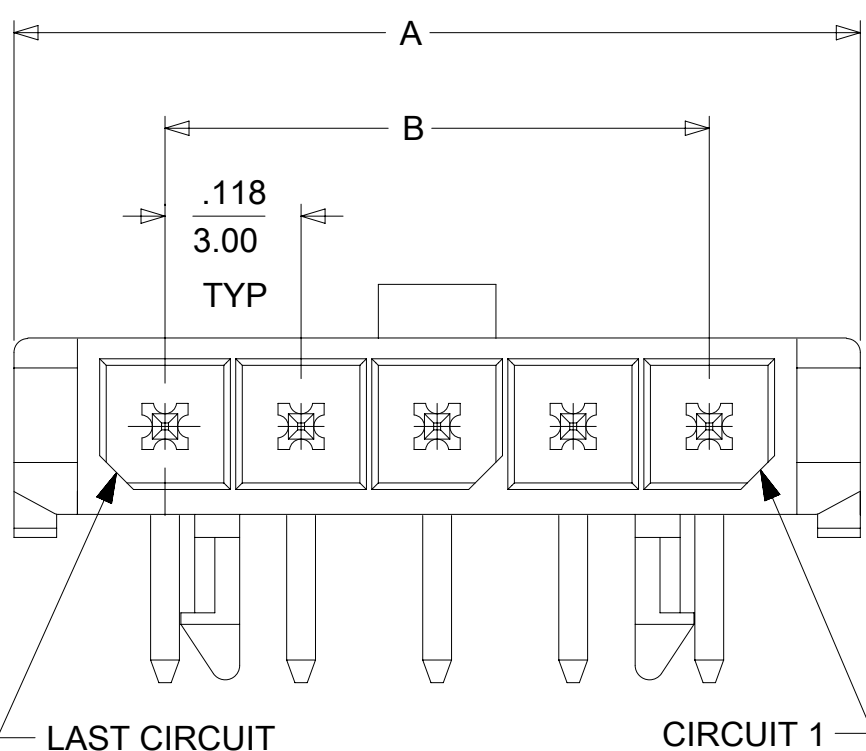
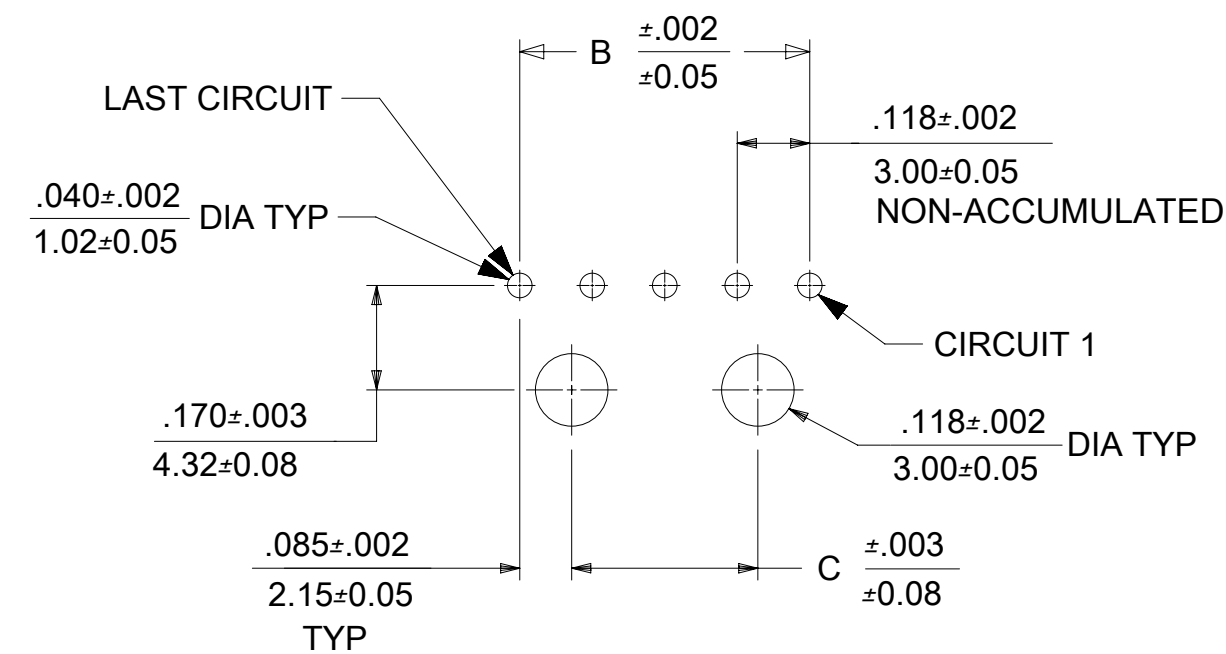
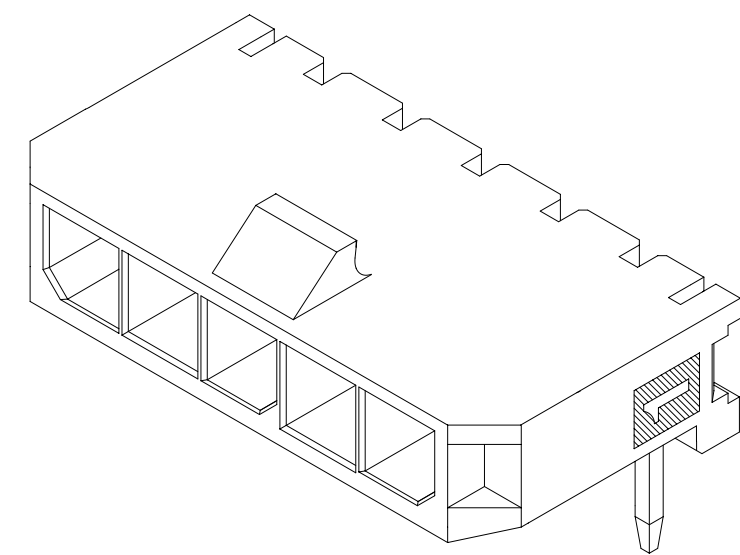
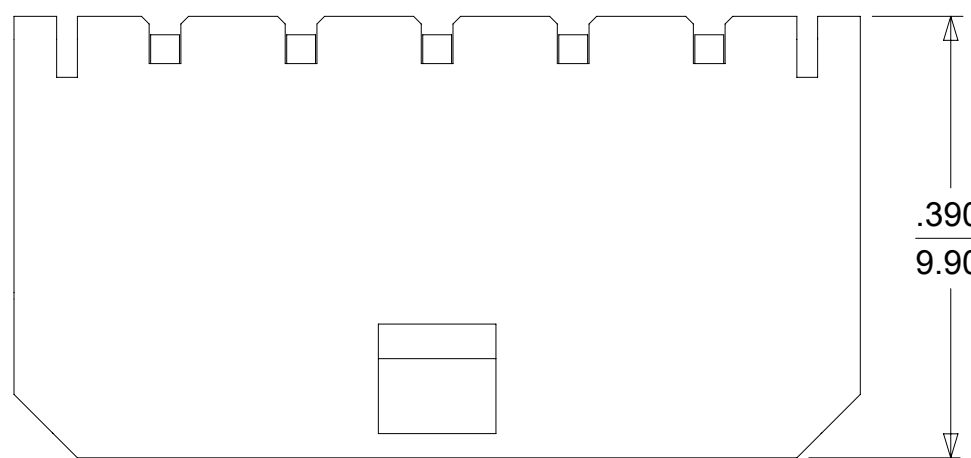

CKTS	A	B	C
2	.380 / 9.65	.118 / 3.00	N/A
3	.498 / 12.65	.236 / 6.00	N/A
4	.616 / 15.65	.354 / 9.00	.185 / 4.70
5	.734 / 18.64	.472 / 12.00	.303 / 7.70
6	.852 / 21.64	.591 / 15.00	.421 / 10.70
7	.970 / 24.64	.709 / 18.00	.539 / 13.70
8	1.088 / 27.64	.827 / 21.00	.657 / 16.70
9	12.06 / 30.63	.945 / 24.00	.776 / 19.70
10	1.325 / 33.66	1.063 / 27.00	.894 / 22.70
11	1.443 / 36.65	1.181 / 30.00	1.012 / 25.70
12	1.561 / 39.65	1.299 / 33.00	1.130 / 28.70

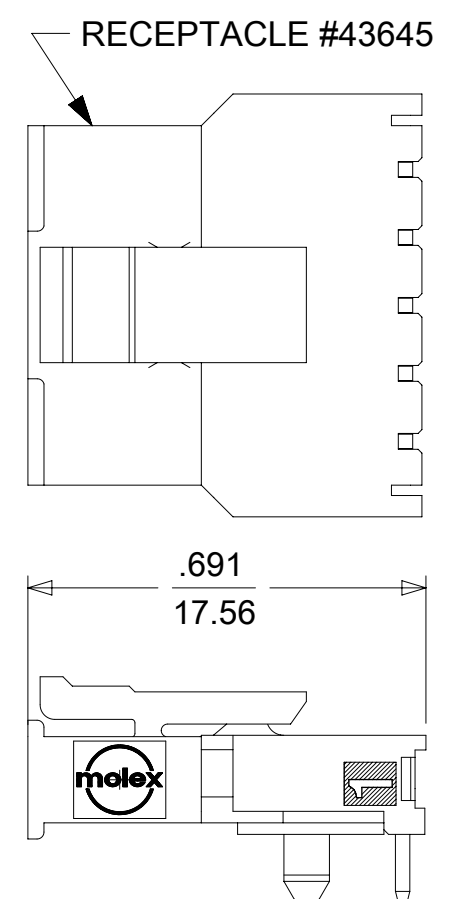

MATED MICRO FIT CONNECTOR

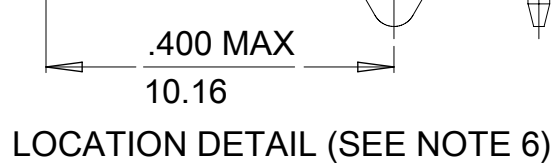

LOCATION DETAIL (SEE NOTE 6)

- NOTES:
- HOUSING MATERIAL: LIQUID CRYSTAL POLYMER, GLASS FILLED. UL94V-0, COLOR - BLACK
TERMINAL MATERIAL: BRASS ALLOY
 - FINISH:
 - A = .000060/(0.00152) MIN. REFLOWED MATTE TIN OVER
.000050/(0.00127) MIN. NICKEL
(FINISH IS BRIGHT IN APPEARANCE, THICKNESS AS APPLIED PRIOR TO REFLOW)
 - B = .000015/(0.00038) MIN. SELECT GOLD IN CONTACT AREA
.000100/(0.00254) MIN. SELECT MATTE TIN ON SOLDER TAILS BOTH OVER
.000050/(0.00127) NICKEL OVERALL
 - C = .000030/(0.00076) MIN. SELECT GOLD IN CONTACT AREA
.000100/(0.00254) MIN. SELECT MATTE TIN ON SOLDER TAILS BOTH OVER
.000050/(0.00127) NICKEL OVERALL
 - D = .000100/(0.00254) MIN. MATTE TIN OVER
.000050/(0.00127) MIN. NICKEL
 - PRODUCT SPECIFICATION: PS-43650
 - TRAY PACKAGED : SEE MOLEX DRAWING PK-70873-0321
 - MATES WITH MICRO FIT (3.0) RECEPTACLE SERIES 43645
 - TO AVOID INTERFERENCE BETWEEN RECEPTACLE AND PCB, HEADER MUST BE PLACED WITHIN .400/(10.16) MAX. FROM EDGE OF PCB, AS SHOWN IN LOCATION DETAIL.
 - PARTS CONFORM TO CLASS 'B' REQUIREMENTS OF COSMETIC SPECIFICATION PS-45499-002
 - TEXT ON PART IS FOR REFERENCE ONLY. TEXT AND TEXT LOCATION MAY VARY DEPENDING ON PART NUMBER AND/OR TOOL.

CKTS	FINISH A		VOID CKT #	FINISH B		VOID CKT #	FINISH C		VOID CKT #	FINISH D		
	MATERIAL NUMBER			MATERIAL NUMBER			MATERIAL NUMBER			MATERIAL NUMBER		
02	43650-0200		N/A	43650-0201		N/A	43650-0202		N/A	43650-0237		
03	43650-0300		N/A	43650-0301		N/A	43650-0302		N/A			
04	43650-0400		N/A	43650-0401		N/A	43650-0402		N/A			
05	43650-0500		N/A	43650-0501		N/A	43650-0502		N/A			
06	43650-0600		N/A	43650-0601		N/A	43650-0602		N/A			
07	43650-0700		N/A	43650-0701		N/A	43650-0702		N/A			
08	43650-0800		N/A	43650-0801		N/A	43650-0802		N/A			
09	43650-0900		N/A	43650-0901		N/A	43650-0902		N/A			
10	43650-1000		N/A	43650-1001		N/A	43650-1002		N/A			
11	43650-1100		N/A	43650-1101		N/A	43650-1102		N/A			
12	43650-1200		N/A	43650-1201		N/A	43650-1202		N/A			
03	43650-1300		2									
05								43650-1502				2,3,4
09	43650-1900		2,4,5	43650-1901		2,4,6,8						
10								43650-2002		2,3,5,6,8,9		

THIS DRAWING CONTAINS INFORMATION THAT IS PROPRIETARY TO MOLEX ELECTRONIC TECHNOLOGIES, LLC AND SHOULD NOT BE USED WITHOUT WRITTEN PERMISSION

QUALITY SYMBOLS	2017/02/02 2017/08/24 2017/08/29 ADD 43650-2002 EC NO: 113012 DRWN: JQUILES CHKD: SSOUSEK REV / APPR: FSMITH	GENERAL TOLERANCES (UNLESS SPECIFIED)	DIMENSION UNITS	SCALE																								
		<table border="1"> <tr><th colspan="2">MM</th><th colspan="2">INCH</th></tr> <tr><td>4 PLACES</td><td>±</td><td>±</td><td></td></tr> <tr><td>3 PLACES</td><td>±</td><td>± 0.01</td><td></td></tr> <tr><td>2 PLACES</td><td>± 0.25</td><td>± 0.014</td><td></td></tr> <tr><td>1 PLACES</td><td>± 0.35</td><td>±</td><td></td></tr> <tr><td>0 PLACES</td><td>±</td><td>±</td><td></td></tr> </table>	MM			INCH		4 PLACES	±	±		3 PLACES	±	± 0.01		2 PLACES	± 0.25	± 0.014		1 PLACES	± 0.35	±		0 PLACES	±	±		IN/MM
MM		INCH																										
4 PLACES	±	±																										
3 PLACES	±	± 0.01																										
2 PLACES	± 0.25	± 0.014																										
1 PLACES	± 0.35	±																										
0 PLACES	±	±																										
ANGULAR TOL = 0.5 DRAFT WHERE APPLICABLE MUST REMAIN WITHIN DIMENSIONS	DRAWING SIZE	C	THIRD ANGLE PROJECTION	PRODUCT CUSTOMER DRAWING SERIES: 43650 MATERIAL NUMBER: SEE CHART CUSTOMER: GENERAL MARKET																								
RELEASE STATUS		RELEASE DATE		DOCUMENT NUMBER: SD-43650-001		DOC TYPE: PSD		DOC PART: 000		SHEET NUMBER: 1 OF 1																		

Looking for pricing, stock, or lifecycle information?

Click below to explore more details on WIN SOURCE:

 [View 43650-0200 on WIN SOURCE](#)

 [Molex, LLC Information](#)

Optimize Your Supply Chain with WIN SOURCE Solutions

-  Global Sourcing Solution
-  Obsolete Management
-  Cost Control Management
-  Shortage Management
-  Alternative Solution
-  Excess Inventory Management