



**THE DATASHEET OF
OSTV8225150**



5

4

3

2

1

THESE DRAWINGS AND SPECIFICATIONS ARE THE PROPERTY OF ON-SHORE TECHNOLOGY, INC. AND SHALL NOT BE REPRODUCED, COPIED OR USED IN ANY MANNER WITHOUT THE PRIOR WRITTEN CONSENT OF ON-SHORE TECHNOLOGY, INC.

| | | |
|------|------------|---------------------|
| SIGN | DATE | Approval address |
| | 2011.08.08 | THIS IS CAD DRAWING |

Material

- Insulator (Body): Therm
- Insulator (Cover): Therm
- Terminal screw: Steel Z
- Terminal body: Brass(Cu)
- Contact Pin: Brass, Tin

Electrical

- Voltage rating: 300VAC
- Current rating: 20A
- Wire range: Solid wire(AWG): 12-24 Stranded wire(AWG): 16-18
- Torque: 4Lb-In
- Screw: M3
- Wire strip length: 7-8mm
- Withstanding Voltage: 1000V
- Operating temperature: -40 to 100°C
- Safety Approval:

RoHS Compliant

PART NUMBER:

OSTV8XX5

| | |
|-------------|---------|
| No. of Pole | 02 2 Po |
| | 03 3 Po |
| | |
| | 24 24 P |

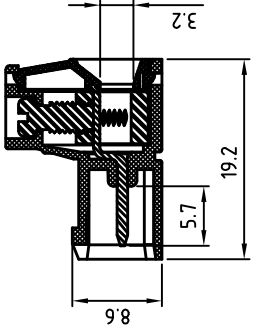
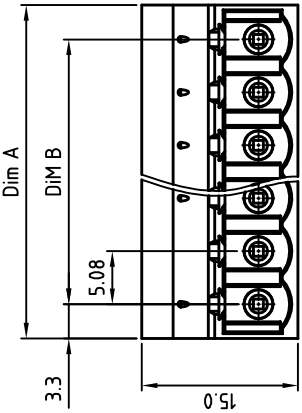
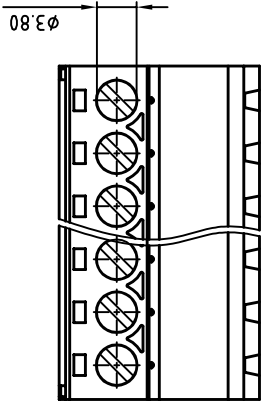

| Poles | 2 | 3 | 4 | 5 | 6 | 7 | 8 | 9 | 10 | 11 | 12 | 13 |
|-------|-------|-------|-------|-------|-------|-------|--------|--------|--------|--------|--------|-------|
| Dim A | 11.66 | 16.74 | 21.82 | 26.90 | 31.98 | 37.06 | 42.14 | 47.22 | 52.30 | 57.38 | 62.46 | 67.54 |
| Dim B | 5.08 | 10.16 | 15.24 | 20.32 | 25.40 | 30.48 | 35.56 | 40.64 | 45.72 | 50.80 | 55.88 | 60.96 |
| TOL | ±0.15 | | | | | | | | | | | |
| Poles | 14 | 15 | 16 | 17 | 18 | 19 | 20 | 21 | 22 | 23 | 24 | |
| Dim A | 72.62 | 77.70 | 82.78 | 87.86 | 92.94 | 98.02 | 103.10 | 108.18 | 113.26 | 118.34 | 123.42 | |
| Dim B | 66.04 | 71.12 | 76.20 | 81.28 | 86.36 | 91.44 | 96.52 | 101.60 | 106.68 | 111.76 | 116.84 | |
| TOL | ±0.25 | | | | | | | | | | | |



| | | | |
|----------|----------------------------------|----------|----------------------|
| TITLE | OSTV8 5.08 Series without flange | | |
| PART NO. | OSTV8XX5150 | DESIGNED | DRAWN |
| APPROVED | Marvin 2008.06.06 | CHECKED | Marvin 2008.06.06 |
| | | DESIGNED | Tason 2007,10,31 |

5

4



3

2

1

Looking for pricing, stock, or lifecycle information?

Click below to explore more details on WIN SOURCE:

-  [View OSTV8225150 on WIN SOURCE](#)
-  [On Shore Technology Inc. Information](#)

Optimize Your Supply Chain with WIN SOURCE Solutions

-  Global Sourcing Solution
-  Obsolete Management
-  Cost Control Management
-  Shortage Management
-  Alternative Solution
-  Excess Inventory Management