



**THE DATASHEET OF
OMIT-SH-112LM**



REVISED: _____

3

2

1

LOC HB DIST -

REVISIONS

P	LTR	DESCRIPTION	DATE	DWN	APVD
E		1.UPDATE TE LOGO AND LOGO2 ADD LINE IDENTIFICATION	06-APR-12	D.L	BH.Y
F		3.TERMINALS TOLERANCE CLASSIFICATION,VENT HOLE CHANGE REUSE ONLY	16-DEC-13	XL,Y	B,F
		ECO-12-005726			
		ECO-13-015347			

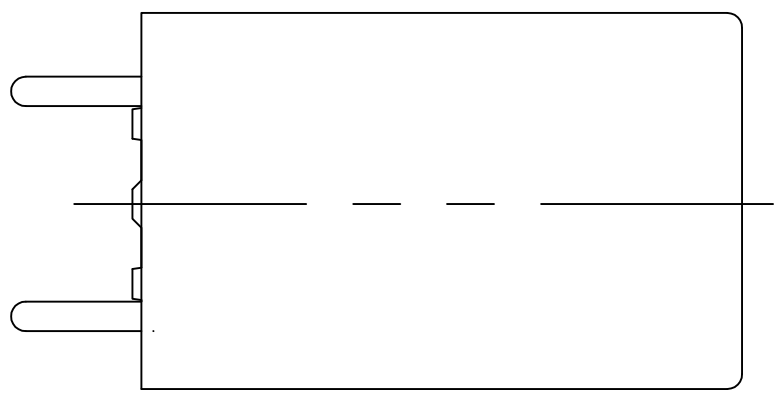
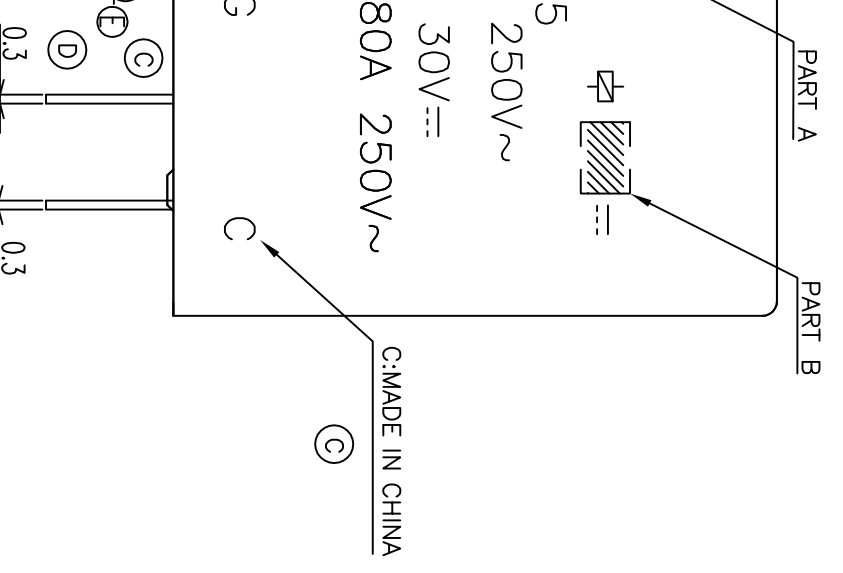
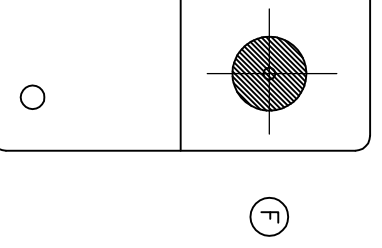

CONNECTION DIAGRAM
(BOTTOM VIEW)

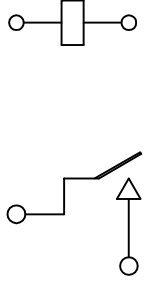

DRILLING DIAGRAM(2/1)
(BOTTOM VIEW)

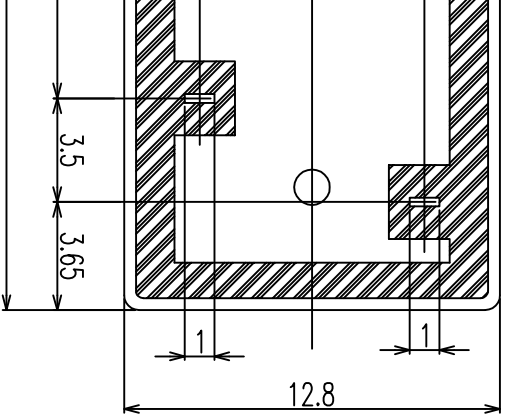
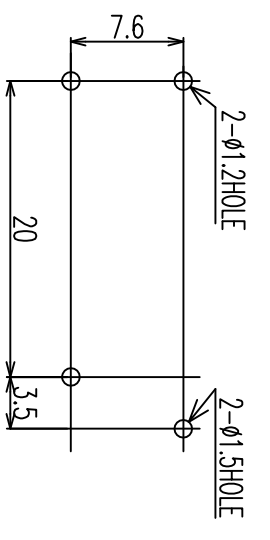

THIS DRAWING IS A CONTROLLED DOCUMENT.

DIMENSIONS: mm	TOLERANCES UNLESS OTHERWISE SPECIFIED:
	0 PLC ±
	1 PLC ±
	2 PLC ±
	3 PLC ±
	4 PLC ±
ANGLES	±
FINISH	±

DWN FU,BO

CHK ZHANG,XIAONING

APVD C.H.HSU

PRODUCT SPEC

APPLICATION SPEC

WEIGHT

CUSTOMER DRAWING



TE Connectivity

OMIT CUSTOMER DRAWING

NAME	SIZE	CAGE CODE	DRAWING NO	RESTRICTED TO
	A3	00779	G=9-1440000-6	
SCALE	SHEET	OF	REV	
4:1	1	2	F	

REVISED:	3	2	1
LOC	HB	DIST	-
REVISIONS			
P	LTR	DESCRIPTION	DATE
-	-	SEE SHEET 1	-
			DWN
			APVD

AS FOLLOING:

WEEK
YEAR
RANGE AS FOLLOING:

ZANCE	±0.1
mm	±0.2
	±0.3

ENSION IS NOT INCLUDING SOLDER TIP.
PLATING OF THE PINS:
DTH, THICKNESS AND DIAMETER.
NGTH.

48LM	48V	OMIT-SH-148LM
48DM	48V	OMIT-SH-148DM
24LM	24V	OMIT-SH-124LM
24DM	24V	OMIT-SH-124DM
12LM	12V	OMIT-SH-112LM
12DM	12V	OMIT-SH-112DM
9LM	9V	OMIT-SH-109LM
9DM	9V	OMIT-SH-109DM
6LM	6V	OMIT-SH-106LM
6DM	6V	OMIT-SH-106DM
5LM	5V	OMIT-SH-105LM
5DM	5V	OMIT-SH-105DM
ON	PART B	PART A

RELAY TYPE

THIS DRAWING IS A CONTROLLED DOCUMENT.

DIMENSIONS:	TOLERANCES UNLESS OTHERWISE SPECIFIED:
mm	0 PLC ±
	1 PLC ±
	2 PLC ±
	3 PLC ±
	4 PLC ±
	ANGLES ±
	FINISH ±

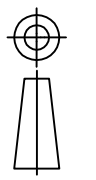

DWN

CHK FU,BO

ZHANG, XIAONING

APVD C.H.HSU

PRODUCT SPEC

APPLICATION SPEC

WEIGHT

CUSTOMER DRAWING

UL94 V-0	SOLDER DIP	UV RESIN	UV SEAL	16
CLASS E		EPOXY RESIN	SEAL	15
UL94 V-0		PBT	CASE	14
UL94 V-0		UEW	MAGNETIC WIRE	13
		PET	BASE	12
UL94 V-0		PBT	BOBBIN	11
	SOLDER DIP	CP WIRE	COIL TERMINAL	10
		PPS	CARD	9
		Ag ALLOY	MOVABLE CONTACT	8
		Ag ALLOY	STATIONARY CONTACT	7
		Cu ALLOY	HINGE SPRING	6
	SOLDER DIP	Cu ALLOY	STATIONARY TERMINAL	5
		STEEL	MOVABLE SPRING	4
		STEEL	CORE	3
		STEEL	ARMATURE	2
		STEEL	YOKE	1
INCOMBUSTIBILITY	TREATMENT	MATERIAL	DESCRIPTION	ITEM



TE Connectivity

OMIT CUSTOMER DRAWING

NAME	SIZE	CAGE CODE	DRAWING NO	RESTRICTED TO
A3	00779	9-1440000-6		

SCALE	4:1	SHEET	2	OF	2	REV	F
-------	-----	-------	---	----	---	-----	---

A

B

C

D

Looking for pricing, stock, or lifecycle information?

Click below to explore more details on WIN SOURCE:

[View OMIT-SH-112LM on WIN SOURCE](#)

[TE Connectivity Information](#)

Optimize Your Supply Chain with WIN SOURCE Solutions

- ✓ Global Sourcing Solution
- ✓ Obsolete Management
- ✓ Cost Control Management
- ✓ Shortage Management
- ✓ Alternative Solution
- ✓ Excess Inventory Management