



**THE DATASHEET OF
OJE-SS-112HMF**



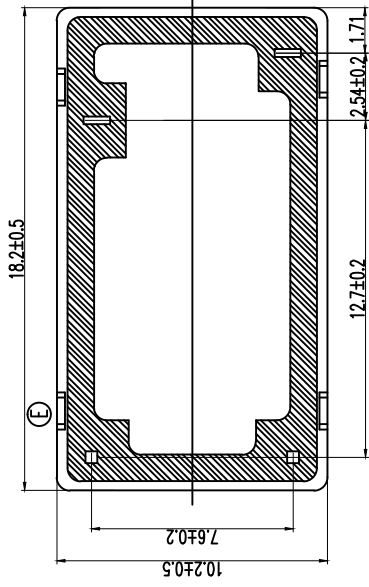
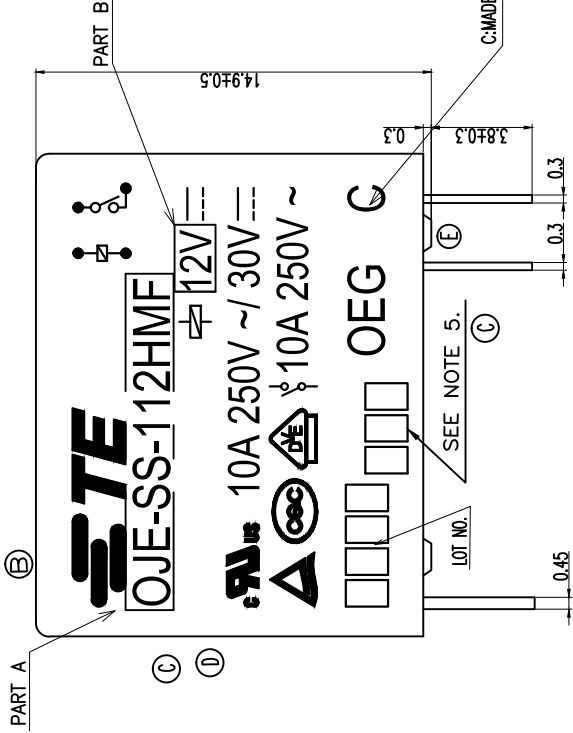
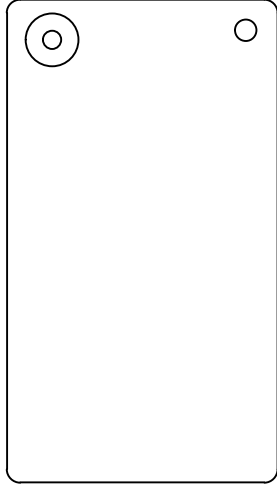

Diagram dimension	Tolerance
0.99mm max.	±0.1mm
1 - 2.99mm	±0.2mm
3mm min.	±0.3mm

FIGURE FOR PR (BOTTOM VIEW)

THIS DRAWING IS A CONTROLLED DOCUMENT.

DIMENSIONS:	TOLERANCES UNLESS OTHERWISE SPECIFIED:
mm	0 PLC ±
	1 PLC ±
	2 PLC ±
	3 PLC ±
	4 PLC ±
	ANGLES ±
MATERIAL	FINISH ±
	WEIGHT
	CUSTOMER DRAWING

DWN	FJUBO
CHK	XIAONING ZHANG
APVD	CHLSU
PRODUCT SPEC	
APPLICATION SPEC	
WEIGHT	
CUSTOMER DRAWING	

LOC	HB	DIST	-
		P	LTR
		-	SEESH

1721923-3	0JE-SS-148HMF	40W	0JE-SS-148HMF	f
6-1419128-6	0JE-SS-124HMF	24W	0JE-SS-124HMF	e
4-1419128-4	0JE-SS-112HMF	12W	0JE-SS-112HMF	d
3-1419128-6	0JE-SS-109HMF	9V	0JE-SS-109HMF	c
1721923-2	0JE-SS-106HMF	6V	0JE-SS-106HMF	b
1721923-1	0JE-SS-105HMF	5V	0JE-SS-105HMF	a
TE PART NO	TE TYPE NAME	PART B	PART A	ITEM

(A)

(B) NOTES:

1.LOT NO. SYSTEM AS FOLLOWING: (C)5.ADD LOT NO. SYSTEM AS FOLLOWING;

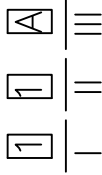
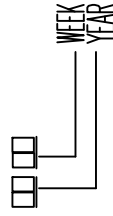

I, DIGITS FOR DAY OF THE WEEK
 1... MONDAY IN THIS WEEK;
 2... TUESDAY IN THIS WEEK;

.....
 7... SUNDAY IN THIS WEEK
 II, DIGITS FOR SHIFT OF THE DAY
 1... DAY SHIFT IN THIS DAY;
 2... NIGHT SHIFT IN THIS DAY;

III, ONE CHARACTER DISTINGUISH THE LINE
 IDENTITY,
 SUCH AS: A,B,.....Z

(C) 2.TERMINAL DIMENSION IS BEFORE SOLDER DIP;

(C) 3.FOR THE TIN-PLATING OF THE PINS:

+0.1mm FOR WIDTH, THICKENS AND DIAMETER.
 +0.5mm FOR LENGTH.

(D) (C) 4.MARKING FROM INK TO LASER AND USING WELDING CONTACT

THIS DRAWING IS A CONTROLLED DOCUMENT.		DWN	FUBO
		CHK	XIAOMING ZHANG
DIMENSIONS:		APVD	CHLSU
TOLERANCES UNLESS OTHERWISE SPECIFIED:		PRODUCT SPEC	
0 PLC ± .		APPLICATION SPEC	
1 PLC ± .		WEIGHT	
2 PLC ± .		CUSTOMER DRAWING	
3 PLC ± .			
4 PLC ± .			
ANGLES ± .			
FINISH			
MATERIAL			

Looking for pricing, stock, or lifecycle information?

Click below to explore more details on WIN SOURCE:

- ⊖ [View OJE-SS-112HMF](#) on WIN SOURCE
- ⊖ [TE Connectivity](#) Information

Optimize Your Supply Chain with WIN SOURCE Solutions

- ✓ Global Sourcing Solution
- ✓ Obsolete Management
- ✓ Cost Control Management
- ✓ Shortage Management
- ✓ Alternative Solution
- ✓ Excess Inventory Management