



**THE DATASHEET OF  
MF-NSMF110-2**





## Features

- Standard 1206 footprint
- Fast Time-to-Trip (TTT) to protect against overcurrent events
- Excellent solderability with ENIG terminal
- Symmetrical designs and low profile (0.7 mm ~ 1.6 mm)
- RoHS compliant\* and halogen free\*\*
- Agency recognition: cULus and TÜV
- TÜV approval to the following standards: IEC 62319-1, IEC 60738-1 and IEC 60730-1:2013 clause 15, clause 17 and Annex J

## MF-NSMF Series - PTC Resettable Fuses

### Electrical Characteristics

Model	V <sub>max.</sub>	I <sub>max.</sub>	I <sub>hold</sub>	I <sub>trip</sub>	Resistance***		Max. Time To Trip		Tripped Power Dissipation	Agency Recognition		AEC-Q200 Compliant/ Automotive Grade
					at 23 °C		at 23 °C		Watts at 23 °C	cUL	TÜV	
	Volts	Amps	Amps	R <sub>min.</sub>	R <sub>1max.</sub>	Amps	Sec.	Typ.	E174545	R 50256634		
MF-NSMF005/30X	30	40	0.05	0.15	2.80	20	0.5	1.5	0.6	✓	✓	✓
MF-NSMF005/60X	60	10	0.05	0.15	2.80	20	0.5	1.5	0.6	✓	✓	✓
MF-NSMF010/30X	30	40	0.10	0.25	1.35	15	0.5	1.5	0.6	✓	✓	✓
MF-NSMF010/60X	60	10	0.10	0.25	1.35	15	0.5	1.5	0.6	✓	✓	✓
MF-NSMF012	30	10	0.12	0.29	1.35	8.5	1.0	0.2	0.6	✓	✓	✓
MF-NSMF012/48X	48	10	0.12	0.29	1.00	6.5	1.0	0.2	0.6	✓	✓	✓
MF-NSMF016	30	10	0.16	0.37	0.70	6.0	1.0	0.3	0.6	✓	✓	✓
MF-NSMF016/48X	48	10	0.16	0.37	0.70	5.0	1.0	0.3	0.6	✓	✓	✓
MF-NSMF020	24	10	0.20	0.46	0.60	2.6	1.0	0.6	0.6	✓	✓	✓
MF-NSMF020X	30	60	0.20	0.40	0.60	3.3	1.0	0.6	0.6	✓	✓	✓
MF-NSMF025X	16	20	0.25	0.50	0.45	2.3	8.0	0.08	0.6	✓	✓	✓
MF-NSMF025/24X	24	80	0.25	0.50	0.45	2.3	8.0	0.05	0.6	✓	✓	✓
MF-NSMF025/30X	30	60	0.25	0.50	0.45	2.3	8.0	0.05	0.6	✓	✓	✓
MF-NSMF035	6	100	0.35	0.75	0.30	1.2	8.0	0.10	0.6	✓	✓	✓
MF-NSMF035X	16	20	0.35	0.75	0.30	1.4	3.5	0.14	0.6	✓	✓	✓
MF-NSMF035/24X	24	80	0.35	0.75	0.30	1.4	8.0	0.10	0.6	✓	✓	✓
MF-NSMF035/30X	30	60	0.35	0.75	0.30	1.4	8.0	0.10	0.6	✓	✓	✓
MF-NSMF050/8X	8	100	0.50	1.00	0.15	0.75	8.0	0.10	0.6	✓	✓	✓
MF-NSMF050	13.2	100	0.50	1.00	0.15	0.70	8.0	0.10	0.6	✓	✓	✓
MF-NSMF050/16X	16	100	0.50	1.00	0.15	0.75	8.0	0.10	0.6	✓	✓	✓
MF-NSMF050/24X	24	80	0.50	1.00	0.15	0.75	8.0	0.10	0.6	✓	✓	✓
MF-NSMF075	6	100	0.75	1.50	0.10	0.40	8.0	0.20	0.6	✓	✓	✓
MF-NSMF075/8X	8	100	0.75	1.50	0.09	0.35	8.0	0.10	0.6	✓	✓	✓
MF-NSMF075/13X	13.2	100	0.75	1.50	0.09	0.35	8.0	0.10	0.6	✓	✓	✓
MF-NSMF075/16X	16	100	0.75	1.50	0.09	0.35	8.0	0.10	0.6	✓	✓	✓

\*\*\*R<sub>1max.</sub>: measured 1 hour post reflow.

*continued*

### Additional Information

Click these links for more information:



**WARNING**  
Cancer and Reproductive Harm  
[www.P65Warnings.ca.gov](http://www.P65Warnings.ca.gov)

\* RoHS Directive 2015/863, Mar 31, 2015 and Annex.  
 \*\* Bourns considers a product to be "halogen free" if (a) the Bromine (Br) content is 900 ppm or less; (b) the Chlorine (Cl) content is 900 ppm or less; and (c) the total Bromine (Br) and Chlorine (Cl) content is 1500 ppm or less.  
 Specifications are subject to change without notice. Users should verify actual device performance in their specific applications. The products described herein and this document are subject to specific legal disclaimers as set forth on the last page of this document, and at [www.bourns.com/docs/legal/disclaimer.pdf](http://www.bourns.com/docs/legal/disclaimer.pdf).

## Applications

- USB & HDMI port protection
- Battery packs
- Tablet and laptop PCs
- Hard disk drives
- LCD / LED HDTVs
- Server and data center interfaces

## MF-NSMF Series - PTC Resettable Fuses

**BOURNS®**

### Electrical Characteristics (continued)

Model	V <sub>max.</sub>	I <sub>max.</sub>	I <sub>hold</sub>	I <sub>trip</sub>	Resistance****		Max. Time To Trip		Tripped Power Dissipation	Agency Recognition		AEC-Q200 Compliant/ Automotive Grade
			at 23 °C		Ohms at 23 °C		at 23 °C		Watts at 23 °C	cUL	TÜV	
	Volts	Amps	Amps	R <sub>min.</sub>	R <sub>1max.</sub>	Amps	Sec.	Typ.	E174545	R 50256634		
MF-NSMF110	6	100	1.10	2.20	0.06	0.20	8.0	0.10	0.6	✓	✓	✓
MF-NSMF110/6X	6	100	1.10	2.20	0.06	0.24	8.0	0.10	0.8	✓	✓	✓
MF-NSMF110/16X	16	100	1.10	2.20	0.06	0.23	8.0	0.10	0.8	✓	✓	✓
MF-NSMF125	6	100	1.25	2.50	0.05	0.14	8.0	0.20	0.6	✓	✓	✓
MF-NSMF125/8X	8	100	1.25	2.50	0.04	0.15	8.0	0.20	0.8	✓	✓	✓
MF-NSMF150	6	100	1.50	3.00	0.03	0.13	8.0	0.30	0.6	✓	✓	✓
MF-NSMF150/6X	6	100	1.50	3.00	0.03	0.12	8.0	0.30	0.8	✓	✓	✓
MF-NSMF175	6	100	1.75	3.50	0.02	0.085	8.0	1.0	0.7	✓	✓	✓
MF-NSMF200	6	100	2.00	4.00	0.02	0.085	8.0	1.0	0.7	✓	✓	✓

\*\*\*\*R<sub>1max.</sub>: measured 1 hour post reflow.

### Environmental Characteristics

Item	Condition	Criteria
Operating Temperature	-40 °C to +85 °C	
Recommended Storage	+40 °C max. / 70 % R.H. max.	
Passive Aging	+85 °C, 1000 hours	±5 % typical resistance change
Humidity Aging	+85 °C, 85 % R.H. 1000 hours	±5 % typical resistance change
Thermal Shock	-40 °C to +85 °C, 20 times	±10 % typical resistance change
Solvent Resistance	MIL-STD-202, Method 215	No change (marking still legible)
Vibration	MIL-STD-883C, Method 2007.1 Condition A	No change (R <sub>min</sub> < R < R <sub>1max</sub> )
Moisture Sensitivity Level (MSL)	<a href="#">See Note</a>	
ESD Classification	Class 6 (per AEC-Q200-2, HBM)	

### Test Procedures and Requirements

Item	Test Conditions	Accept/Reject Criteria
Visual/Mechanical	Verify dimensions and materials	Per MF physical description
Resistance	In still air @ 23 °C	R <sub>min</sub> ≤ R ≤ R <sub>max</sub>
Time to Trip	At specified current, V <sub>max.</sub> , 23 °C, still air	T ≤ max. time to trip (seconds)
Hold Current	30 min. at I <sub>hold</sub> , still air	No trip
Trip Cycle Life	V <sub>max.</sub> , I <sub>max.</sub> , 100 cycles	No arcing or burning
Trip Endurance	V <sub>max.</sub> , 48 hours	No arcing or burning
Solderability	245 °C ± 5 °C, 5 seconds	95 % min. coverage

Specifications are subject to change without notice.

Users should verify actual device performance in their specific applications.

The products described herein and this document are subject to specific legal disclaimers as set forth on the last page of this document, and at [www.bourns.com/docs/legal/disclaimer.pdf](http://www.bourns.com/docs/legal/disclaimer.pdf).

# MF-NSMF Series - PTC Resettable Fuses



Thermal Derating Table -  $I_{hold}$  (Amps)

Model	Ambient Operating Temperature								
	-40 °C	-20 °C	0 °C	23 °C	40 °C	50 °C	60 °C	70 °C	85 °C
MF-NSMF005/30X	0.076	0.068	0.060	0.050	0.043	0.039	0.034	0.030	0.023
MF-NSMF005/60X	0.076	0.068	0.060	0.050	0.043	0.039	0.034	0.030	0.023
MF-NSMF010/30X	0.15	0.14	0.12	0.10	0.08	0.07	0.06	0.05	0.04
MF-NSMF010/60X	0.15	0.14	0.12	0.10	0.08	0.07	0.06	0.05	0.04
MF-NSMF012	0.19	0.17	0.15	0.12	0.11	0.10	0.09	0.08	0.07
MF-NSMF012/48X	0.18	0.16	0.14	0.12	0.10	0.09	0.08	0.07	0.05
MF-NSMF016	0.21	0.20	0.18	0.16	0.14	0.13	0.12	0.11	0.09
MF-NSMF016/48X	0.22	0.20	0.18	0.16	0.14	0.12	0.10	0.09	0.08
MF-NSMF020	0.30	0.27	0.24	0.20	0.18	0.16	0.14	0.12	0.11
MF-NSMF020X	0.30	0.27	0.24	0.20	0.18	0.16	0.14	0.12	0.10
MF-NSMF025X	0.39	0.35	0.31	0.25	0.23	0.21	0.18	0.16	0.13
MF-NSMF025/24X	0.39	0.35	0.31	0.25	0.23	0.21	0.18	0.16	0.13
MF-NSMF025/30X	0.39	0.35	0.31	0.25	0.23	0.21	0.18	0.16	0.13
MF-NSMF035	0.51	0.46	0.40	0.35	0.30	0.27	0.24	0.22	0.18
MF-NSMF035X	0.51	0.46	0.40	0.35	0.30	0.27	0.24	0.22	0.18
MF-NSMF035/24X	0.51	0.46	0.40	0.35	0.30	0.27	0.24	0.22	0.18
MF-NSMF035/30X	0.51	0.46	0.40	0.35	0.30	0.27	0.24	0.22	0.18
MF-NSMF050/8X	0.76	0.68	0.59	0.50	0.44	0.40	0.35	0.32	0.26
MF-NSMF050	0.76	0.68	0.59	0.50	0.44	0.40	0.35	0.32	0.26
MF-NSMF050/16X	0.76	0.68	0.59	0.50	0.44	0.40	0.35	0.32	0.26
MF-NSMF050/24X	0.76	0.68	0.59	0.50	0.44	0.40	0.35	0.32	0.26
MF-NSMF075	1.11	1.00	0.85	0.75	0.67	0.61	0.52	0.50	0.42
MF-NSMF075/8X	1.11	1.00	0.85	0.75	0.67	0.61	0.52	0.50	0.42
MF-NSMF075/13X	1.11	1.00	0.85	0.75	0.67	0.61	0.52	0.50	0.42
MF-NSMF075/16X	1.11	1.00	0.85	0.75	0.67	0.61	0.52	0.50	0.42
MF-NSMF110	1.64	1.46	1.30	1.10	0.92	0.83	0.80	0.65	0.52
MF-NSMF110/6X	1.64	1.46	1.30	1.10	0.92	0.83	0.80	0.65	0.52
MF-NSMF110/16X	1.64	1.46	1.30	1.10	0.92	0.83	0.80	0.65	0.52
MF-NSMF125	1.84	1.66	1.47	1.25	1.11	1.02	0.91	0.82	0.69
MF-NSMF125/8X	1.84	1.66	1.47	1.25	1.11	1.02	0.91	0.82	0.69
MF-NSMF150	2.20	1.99	1.77	1.50	1.34	1.23	1.10	1.01	0.84
MF-NSMF150/6X	2.20	1.99	1.77	1.50	1.34	1.23	1.10	1.01	0.84
MF-NSMF175	2.52	2.28	1.99	1.75	1.57	1.45	1.32	1.21	1.04
MF-NSMF200	2.88	2.61	2.28	2.00	1.80	1.66	1.51	1.39	1.19

Specifications are subject to change without notice.

Users should verify actual device performance in their specific applications.

The products described herein and this document are subject to specific legal disclaimers as set forth on the last page of this document, and at [www.bourns.com/docs/legal/disclaimer.pdf](http://www.bourns.com/docs/legal/disclaimer.pdf).

# MF-NSMF Series - PTC Resettable Fuses



## Typical Time to Trip at 23 °C

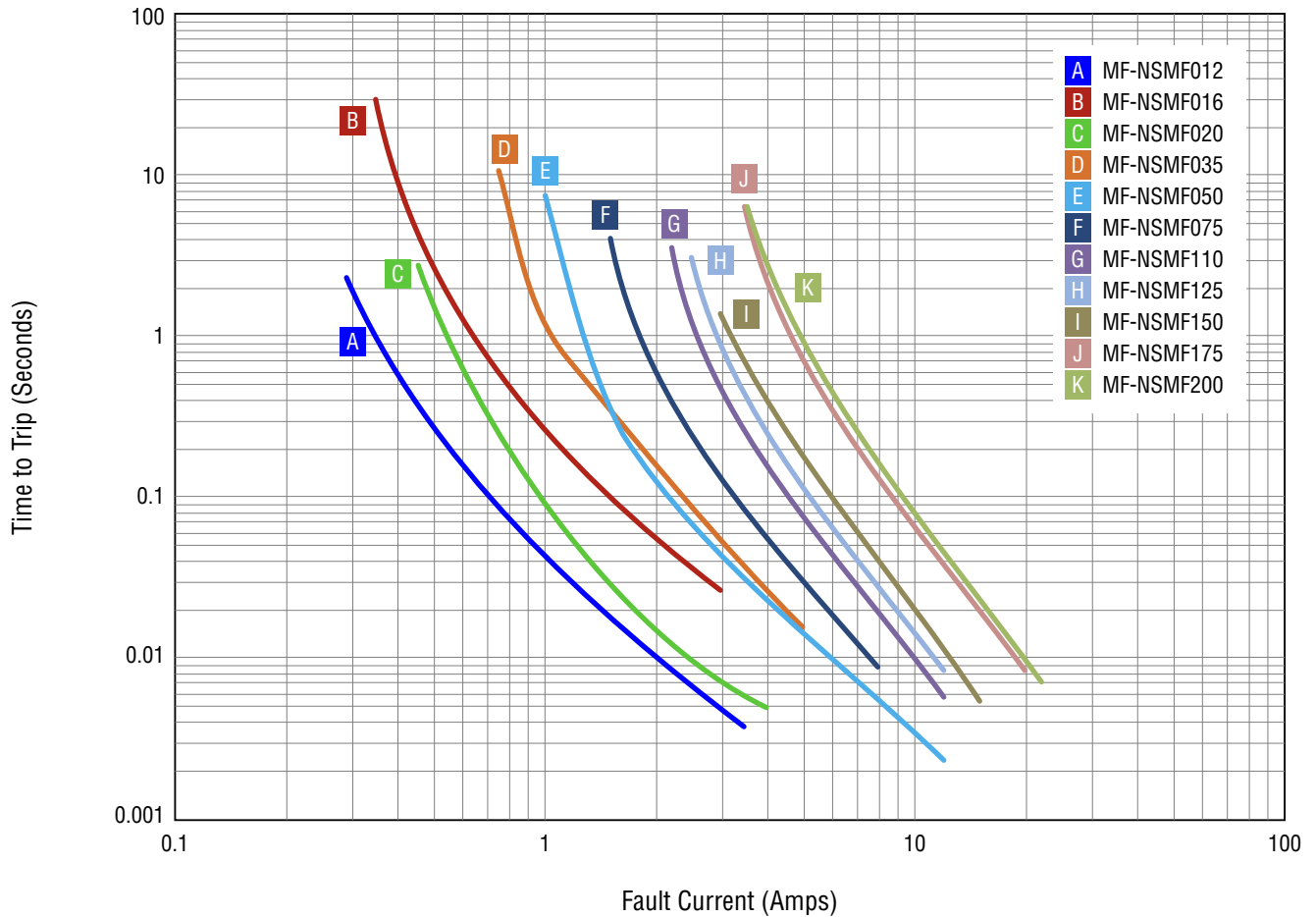

The Time to Trip curves represent typical performance of a device in a simulated application environment. Actual performance in specific customer applications may differ from these values due to the influence of other variables.

## Typical Time to Trip at 23 °C (continued)

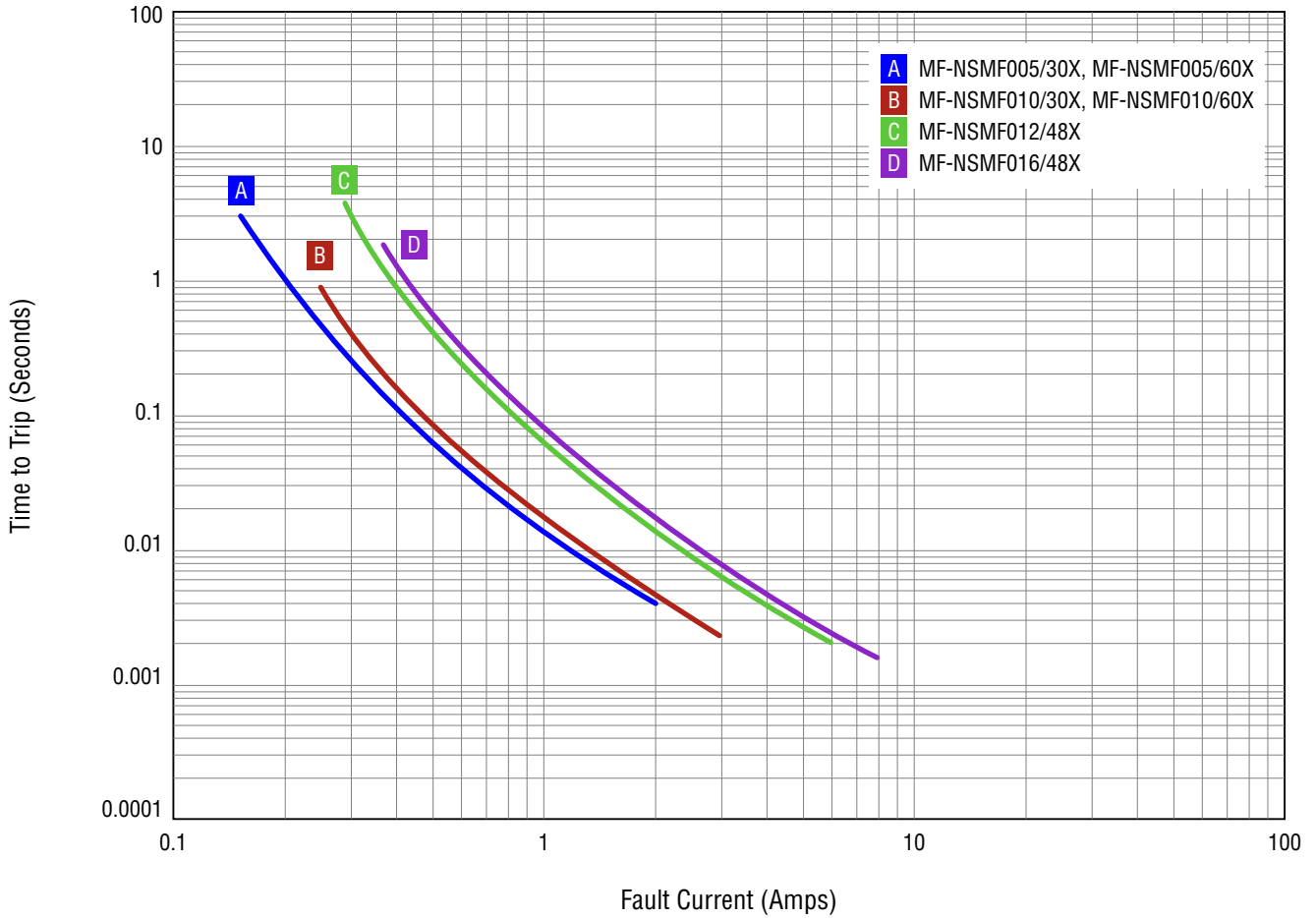

The Time to Trip curves represent typical performance of a device in a simulated application environment. Actual performance in specific customer applications may differ from these values due to the influence of other variables.

# MF-NSMF Series - PTC Resettable Fuses



## Typical Time to Trip at 23 °C

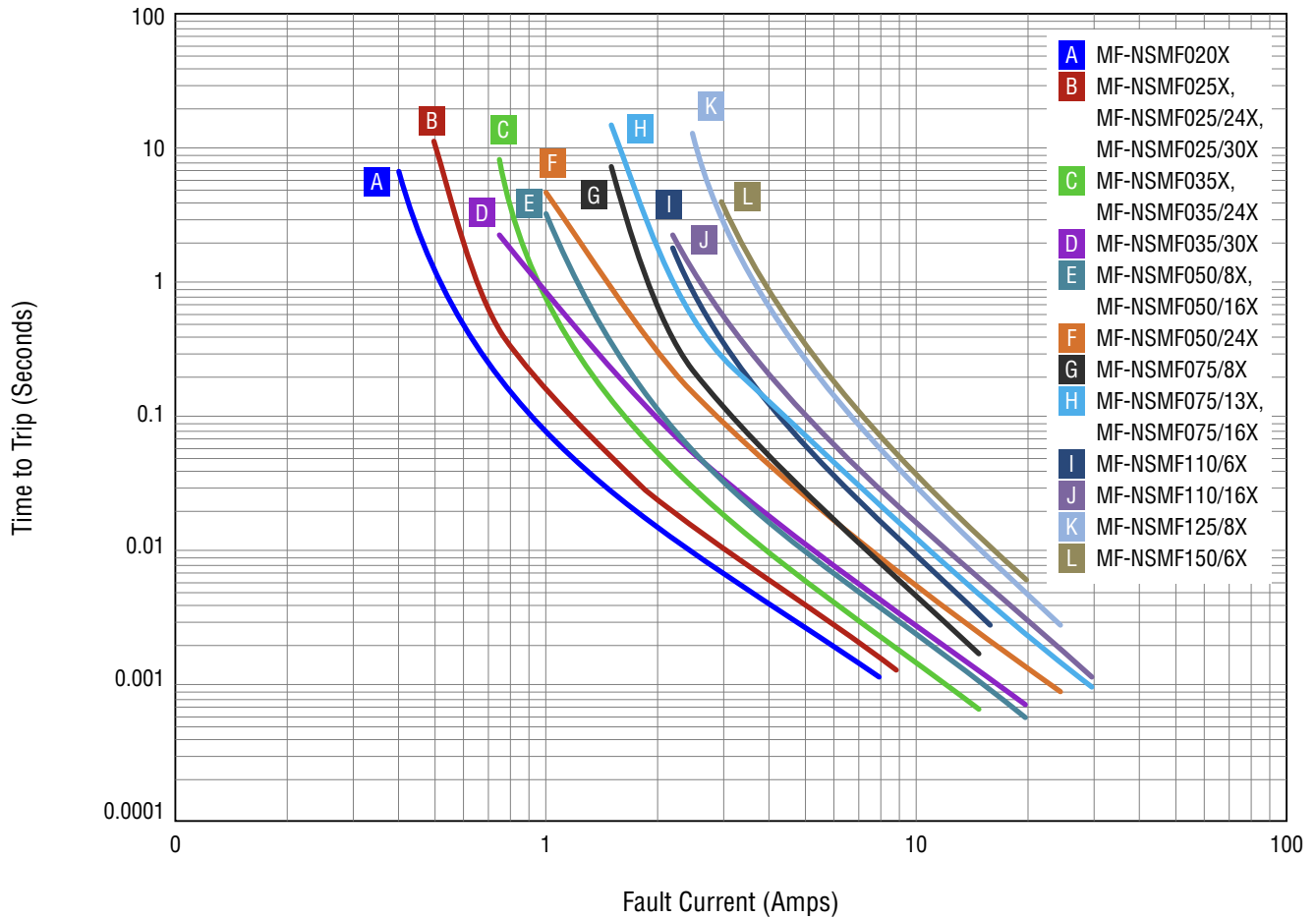

The Time to Trip curves represent typical performance of a device in a simulated application environment. Actual performance in specific customer applications may differ from these values due to the influence of other variables.

# MF-NSMF Series - PTC Resettable Fuses



## How to Order

MF - NSMF 025 / 30 X - 2

Multifuse® Product Designator \_\_\_\_\_

Series \_\_\_\_\_

NSMF = 1206 Surface Mount Component

Hold Current  $I_{hold}$  Indicator \_\_\_\_\_

005 ~ 200 (0.05 ~ 2.0 Amps)

Voltage Options \_\_\_\_\_

6 = 6 Voltage Rated      8 = 8 Voltage Rated  
 13 = 13.2 Voltage Rated    16 = 16 Voltage Rated  
 24 = 24 Voltage Rated      30 = 30 Voltage Rated  
 48 = 48 Voltage Rated      60 = 60 Voltage Rated

MultiFuse® Design Specific Code \_\_\_\_\_

X = MultiFuse® freeXpansion™ Design

Packaging \_\_\_\_\_

-2 = Tape and Reel Packaged per EIA 481

## Packaging Quantity

Model				Packaging Quantity
MF-NSMF005/30X MF-NSMF005/60X MF-NSMF010/30X MF-NSMF010/60X MF-NSMF012 MF-NSMF012/48X MF-NSMF016	MF-NSMF016/48X MF-NSMF020 MF-NSMF020X MF-NSMF025X MF-NSMF035 MF-NSMF035X MF-NSMF035/30X	MF-NSMF050 MF-NSMF050/24X MF-NSMF075 MF-NSMF075/13X MF-NSMF075X/16X MF-NSMF110 MF-NSMF110/16X	MF-NSMF125 MF-NSMF125/8X MF-NSMF150 MF-NSMF150/6X MF-NSMF175 MF-NSMF200	3,000 pcs. per reel
MF-NSMF025/24X MF-NSMF025/30	MF-NSMF035/24X MF-NSMF050/8X	MF-NSMF050/16X MF-NSMF075/8X	MF-NSMF110/6X	4,000 pcs. per reel

## Typical Part Marking

Represents total content. Layout may vary.

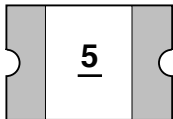

Style 1 part identification:

MF-NSMF012 = 0  
 MF-NSMF016 = 1  
 MF-NSMF020 = 2  
 MF-NSMF035 = 3  
 MF-NSMF050 = 4  
 MF-NSMF075 = 5  
 MF-NSMF110 = 6  
 MF-NSMF125 = 7  
 MF-NSMF150 = 8  
 MF-NSMF175 = 9  
 MF-NSMF200 = A

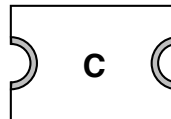

Style 2 part identification:

MF-NSMF005/30X, MF-NSMF005/60X = K  
 MF-NSMF010/30X, MF-NSMF010/60X = 0  
 MF-NSMF012/48X = X  
 MF-NSMF016/48X = 1  
 MF-NSMF020X = 2  
 MF-NSMF025X, MF-NSMF025/24X,  
 MF-NSMF025/30X = C  
 MF-NSMF035X, MF-NSMF035/24X = 3  
 MF-NSMF035/30X = P  
 MF-NSMF050/8X, MF-NSMF050/16X = 4  
 MF-NSMF050/24X = T  
 MF-NSMF075/8X = 5  
 MF-NSMF075/13X, MF-NSMF075X/16X = U  
 MF-NSMF110/6X = 6  
 MF-NSMF110/16X = V  
 MF-NSMF125/8X = 7  
 MF-NSMF150/6X = 8

A bi-weekly date code will appear on the package label: weeks 05-06 = C

Specifications are subject to change without notice.

Users should verify actual device performance in their specific applications.

The products described herein and this document are subject to specific legal disclaimers as set forth on the last page of this document, and at [www.bourns.com/docs/legal/disclaimer.pdf](http://www.bourns.com/docs/legal/disclaimer.pdf).

# MF-NSMF Series - PTC Resettable Fuses

**BOURNS®**

## Product Dimensions

### Style 1

Top and Bottom View

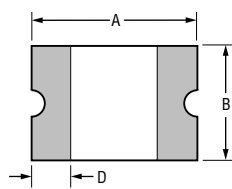

Side View

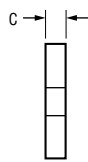

### Terminal material:

Electroless Ni under immersion Gold (ENIG)

DIMENSIONS:  $\frac{\text{MM}}{\text{(INCHES)}}$

### Recommended Pad Layout

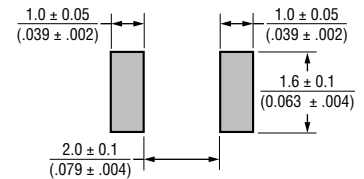

### Style 2

Top View

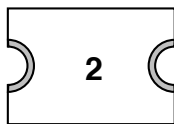

Bottom View

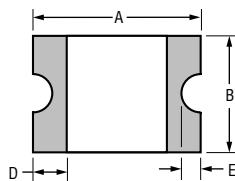

Side View

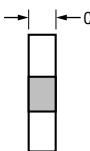

### Recommended Pad Layout

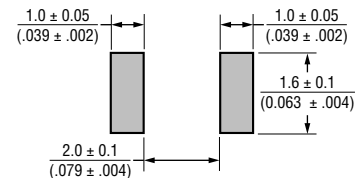

Model	A		B		C		D		E		Style
	Min.	Max.	Min.	Max.	Min.	Max.	Min.	Max.	Min.	Max.	
MF-NSMF005/30X	$\frac{3.00}{(0.118)}$	$\frac{3.40}{(0.134)}$	$\frac{1.40}{(0.055)}$	$\frac{1.80}{(0.071)}$	$\frac{0.60}{(0.024)}$	$\frac{1.10}{(0.043)}$	$\frac{0.25}{(0.010)}$	$\frac{1.0}{(0.039)}$	$\frac{0.05}{(0.002)}$	$\frac{0.35}{(0.014)}$	2
MF-NSMF005/60X	$\frac{3.00}{(0.118)}$	$\frac{3.40}{(0.134)}$	$\frac{1.40}{(0.055)}$	$\frac{1.80}{(0.071)}$	$\frac{0.60}{(0.024)}$	$\frac{1.10}{(0.043)}$	$\frac{0.25}{(0.010)}$	$\frac{1.0}{(0.039)}$	$\frac{0.05}{(0.002)}$	$\frac{0.35}{(0.014)}$	2
MF-NSMF010/30X	$\frac{3.00}{(0.118)}$	$\frac{3.40}{(0.134)}$	$\frac{1.40}{(0.055)}$	$\frac{1.80}{(0.071)}$	$\frac{0.60}{(0.024)}$	$\frac{1.10}{(0.043)}$	$\frac{0.25}{(0.010)}$	$\frac{1.0}{(0.039)}$	$\frac{0.05}{(0.002)}$	$\frac{0.35}{(0.014)}$	2
MF-NSMF010/60X	$\frac{3.00}{(0.118)}$	$\frac{3.40}{(0.134)}$	$\frac{1.40}{(0.055)}$	$\frac{1.80}{(0.071)}$	$\frac{0.60}{(0.024)}$	$\frac{1.10}{(0.043)}$	$\frac{0.25}{(0.010)}$	$\frac{1.0}{(0.039)}$	$\frac{0.05}{(0.002)}$	$\frac{0.35}{(0.014)}$	2
MF-NSMF012	$\frac{3.00}{(0.118)}$	$\frac{3.40}{(0.134)}$	$\frac{1.40}{(0.055)}$	$\frac{1.80}{(0.071)}$	$\frac{0.70}{(0.028)}$	$\frac{1.10}{(0.043)}$	$\frac{0.25}{(0.010)}$				1
MF-NSMF012/48X	$\frac{3.00}{(0.118)}$	$\frac{3.40}{(0.134)}$	$\frac{1.40}{(0.055)}$	$\frac{1.80}{(0.071)}$	$\frac{0.60}{(0.024)}$	$\frac{1.10}{(0.043)}$	$\frac{0.25}{(0.010)}$	$\frac{1.0}{(0.039)}$	$\frac{0.05}{(0.002)}$	$\frac{0.35}{(0.014)}$	2
MF-NSMF016	$\frac{3.00}{(0.118)}$	$\frac{3.40}{(0.134)}$	$\frac{1.40}{(0.055)}$	$\frac{1.80}{(0.071)}$	$\frac{0.48}{(0.019)}$	$\frac{0.85}{(0.033)}$	$\frac{0.25}{(0.010)}$				1
MF-NSMF016/48X	$\frac{3.00}{(0.118)}$	$\frac{3.40}{(0.134)}$	$\frac{1.40}{(0.055)}$	$\frac{1.80}{(0.071)}$	$\frac{0.60}{(0.024)}$	$\frac{1.10}{(0.043)}$	$\frac{0.25}{(0.010)}$	$\frac{1.0}{(0.039)}$	$\frac{0.05}{(0.002)}$	$\frac{0.35}{(0.014)}$	2
MF-NSMF020	$\frac{3.00}{(0.118)}$	$\frac{3.40}{(0.134)}$	$\frac{1.40}{(0.055)}$	$\frac{1.80}{(0.071)}$	$\frac{0.48}{(0.019)}$	$\frac{0.85}{(0.033)}$	$\frac{0.25}{(0.010)}$				1
MF-NSMF020X	$\frac{3.00}{(0.118)}$	$\frac{3.40}{(0.134)}$	$\frac{1.40}{(0.055)}$	$\frac{1.80}{(0.071)}$	$\frac{0.40}{(0.016)}$	$\frac{0.85}{(0.033)}$	$\frac{0.25}{(0.010)}$	$\frac{1.0}{(0.039)}$	$\frac{0.05}{(0.002)}$	$\frac{0.35}{(0.014)}$	2
MF-NSMF025X	$\frac{3.00}{(0.118)}$	$\frac{3.40}{(0.134)}$	$\frac{1.40}{(0.055)}$	$\frac{1.80}{(0.071)}$	$\frac{0.40}{(0.016)}$	$\frac{0.85}{(0.033)}$	$\frac{0.25}{(0.010)}$	$\frac{1.0}{(0.039)}$	$\frac{0.05}{(0.002)}$	$\frac{0.35}{(0.014)}$	2
MF-NSMF025/24X	$\frac{3.00}{(0.118)}$	$\frac{3.40}{(0.134)}$	$\frac{1.40}{(0.055)}$	$\frac{1.80}{(0.071)}$	$\frac{0.40}{(0.016)}$	$\frac{0.85}{(0.033)}$	$\frac{0.25}{(0.010)}$	$\frac{1.0}{(0.039)}$	$\frac{0.05}{(0.002)}$	$\frac{0.35}{(0.014)}$	2
MF-NSMF025/30X	$\frac{3.00}{(0.118)}$	$\frac{3.40}{(0.134)}$	$\frac{1.40}{(0.055)}$	$\frac{1.80}{(0.071)}$	$\frac{0.40}{(0.016)}$	$\frac{0.85}{(0.033)}$	$\frac{0.25}{(0.010)}$	$\frac{1.0}{(0.039)}$	$\frac{0.05}{(0.002)}$	$\frac{0.35}{(0.014)}$	2
MF-NSMF035	$\frac{3.00}{(0.118)}$	$\frac{3.40}{(0.134)}$	$\frac{1.40}{(0.055)}$	$\frac{1.80}{(0.071)}$	$\frac{0.48}{(0.019)}$	$\frac{0.85}{(0.033)}$	$\frac{0.25}{(0.010)}$				1

Specifications are subject to change without notice.

Users should verify actual device performance in their specific applications.

The products described herein and this document are subject to specific legal disclaimers as set forth on the last page of this document, and at [www.bourns.com/docs/legal/disclaimer.pdf](http://www.bourns.com/docs/legal/disclaimer.pdf).

# MF-NSMF Series - PTC Resettable Fuses

**BOURNS®**

## Product Dimensions (continued)

Model	A		B		C		D		E		Style
	Min.	Max.	Min.	Max.	Min.	Max.	Min.	Max.	Min.	Max.	
MF-NSMF035X	$\frac{3.00}{(0.118)}$	$\frac{3.40}{(0.134)}$	$\frac{1.40}{(0.055)}$	$\frac{1.80}{(0.071)}$	$\frac{0.40}{(0.016)}$	$\frac{0.85}{(0.033)}$	$\frac{0.25}{(0.010)}$	$\frac{1.0}{(0.039)}$	$\frac{0.05}{(0.002)}$	$\frac{0.35}{(0.014)}$	2
MF-NSMF035/24X	$\frac{3.00}{(0.118)}$	$\frac{3.40}{(0.134)}$	$\frac{1.40}{(0.055)}$	$\frac{1.80}{(0.071)}$	$\frac{0.40}{(0.016)}$	$\frac{0.85}{(0.033)}$	$\frac{0.25}{(0.010)}$	$\frac{1.0}{(0.039)}$	$\frac{0.05}{(0.002)}$	$\frac{0.35}{(0.014)}$	2
MF-NSMF035/30X	$\frac{3.00}{(0.118)}$	$\frac{3.40}{(0.134)}$	$\frac{1.40}{(0.055)}$	$\frac{1.80}{(0.071)}$	$\frac{0.75}{(0.030)}$	$\frac{1.25}{(0.049)}$	$\frac{0.25}{(0.010)}$	$\frac{1.0}{(0.039)}$	$\frac{0.05}{(0.002)}$	$\frac{0.35}{(0.014)}$	2
MF-NSMF050/8X	$\frac{3.00}{(0.118)}$	$\frac{3.40}{(0.134)}$	$\frac{1.40}{(0.055)}$	$\frac{1.80}{(0.071)}$	$\frac{0.40}{(0.016)}$	$\frac{0.85}{(0.033)}$	$\frac{0.25}{(0.010)}$	$\frac{1.0}{(0.039)}$	$\frac{0.05}{(0.002)}$	$\frac{0.35}{(0.014)}$	2
MF-NSMF050	$\frac{3.00}{(0.118)}$	$\frac{3.40}{(0.134)}$	$\frac{1.40}{(0.055)}$	$\frac{1.80}{(0.071)}$	$\frac{0.48}{(0.019)}$	$\frac{0.85}{(0.033)}$	$\frac{0.25}{(0.010)}$				1
MF-NSMF050/16X	$\frac{3.00}{(0.118)}$	$\frac{3.40}{(0.134)}$	$\frac{1.40}{(0.055)}$	$\frac{1.80}{(0.071)}$	$\frac{0.40}{(0.016)}$	$\frac{0.85}{(0.033)}$	$\frac{0.25}{(0.010)}$	$\frac{1.0}{(0.039)}$	$\frac{0.05}{(0.002)}$	$\frac{0.35}{(0.014)}$	2
MF-NSMF050/24X	$\frac{3.00}{(0.118)}$	$\frac{3.40}{(0.134)}$	$\frac{1.40}{(0.055)}$	$\frac{1.80}{(0.071)}$	$\frac{0.75}{(0.030)}$	$\frac{1.25}{(0.049)}$	$\frac{0.25}{(0.010)}$	$\frac{1.0}{(0.039)}$	$\frac{0.05}{(0.002)}$	$\frac{0.35}{(0.014)}$	2
MF-NSMF075	$\frac{3.00}{(0.118)}$	$\frac{3.40}{(0.134)}$	$\frac{1.40}{(0.055)}$	$\frac{1.80}{(0.071)}$	$\frac{0.40}{(0.016)}$	$\frac{0.70}{(0.028)}$	$\frac{0.25}{(0.010)}$				1
MF-NSMF075/8X	$\frac{3.00}{(0.118)}$	$\frac{3.40}{(0.134)}$	$\frac{1.40}{(0.055)}$	$\frac{1.80}{(0.071)}$	$\frac{0.35}{(0.014)}$	$\frac{0.80}{(0.031)}$	$\frac{0.25}{(0.010)}$	$\frac{1.0}{(0.039)}$	$\frac{0.05}{(0.002)}$	$\frac{0.35}{(0.014)}$	2
MF-NSMF075/13X	$\frac{3.00}{(0.118)}$	$\frac{3.40}{(0.134)}$	$\frac{1.40}{(0.055)}$	$\frac{1.80}{(0.071)}$	$\frac{0.70}{(0.028)}$	$\frac{1.20}{(0.047)}$	$\frac{0.25}{(0.010)}$	$\frac{1.0}{(0.039)}$	$\frac{0.05}{(0.002)}$	$\frac{0.35}{(0.014)}$	2
MF-NSMF075/16X	$\frac{3.00}{(0.118)}$	$\frac{3.40}{(0.134)}$	$\frac{1.40}{(0.055)}$	$\frac{1.80}{(0.071)}$	$\frac{0.70}{(0.028)}$	$\frac{1.20}{(0.047)}$	$\frac{0.25}{(0.010)}$	$\frac{1.0}{(0.039)}$	$\frac{0.05}{(0.002)}$	$\frac{0.35}{(0.014)}$	2
MF-NSMF110	$\frac{3.00}{(0.118)}$	$\frac{3.40}{(0.134)}$	$\frac{1.40}{(0.055)}$	$\frac{1.80}{(0.071)}$	$\frac{0.40}{(0.016)}$	$\frac{0.70}{(0.028)}$	$\frac{0.25}{(0.010)}$				1
MF-NSMF110/6X	$\frac{3.00}{(0.118)}$	$\frac{3.40}{(0.134)}$	$\frac{1.40}{(0.055)}$	$\frac{1.80}{(0.071)}$	$\frac{0.35}{(0.014)}$	$\frac{0.80}{(0.031)}$	$\frac{0.25}{(0.010)}$	$\frac{1.0}{(0.039)}$	$\frac{0.05}{(0.002)}$	$\frac{0.35}{(0.014)}$	2
MF-NSMF110/16X	$\frac{3.00}{(0.118)}$	$\frac{3.40}{(0.134)}$	$\frac{1.40}{(0.055)}$	$\frac{1.80}{(0.071)}$	$\frac{0.60}{(0.024)}$	$\frac{1.10}{(0.043)}$	$\frac{0.25}{(0.010)}$	$\frac{1.0}{(0.039)}$	$\frac{0.05}{(0.002)}$	$\frac{0.35}{(0.014)}$	2
MF-NSMF125	$\frac{3.00}{(0.118)}$	$\frac{3.40}{(0.134)}$	$\frac{1.40}{(0.055)}$	$\frac{1.80}{(0.071)}$	$\frac{0.40}{(0.016)}$	$\frac{0.70}{(0.028)}$	$\frac{0.25}{(0.010)}$				1
MF-NSMF125/8X	$\frac{3.00}{(0.118)}$	$\frac{3.40}{(0.134)}$	$\frac{1.40}{(0.055)}$	$\frac{1.80}{(0.071)}$	$\frac{0.60}{(0.024)}$	$\frac{1.10}{(0.043)}$	$\frac{0.25}{(0.010)}$	$\frac{1.0}{(0.039)}$	$\frac{0.05}{(0.002)}$	$\frac{0.35}{(0.014)}$	2
MF-NSMF150	$\frac{3.00}{(0.118)}$	$\frac{3.40}{(0.134)}$	$\frac{1.40}{(0.055)}$	$\frac{1.80}{(0.071)}$	$\frac{0.40}{(0.016)}$	$\frac{0.70}{(0.028)}$	$\frac{0.25}{(0.010)}$				1
MF-NSMF150/6X	$\frac{3.00}{(0.118)}$	$\frac{3.40}{(0.134)}$	$\frac{1.40}{(0.055)}$	$\frac{1.80}{(0.071)}$	$\frac{0.60}{(0.024)}$	$\frac{1.10}{(0.043)}$	$\frac{0.25}{(0.010)}$	$\frac{1.0}{(0.039)}$	$\frac{0.05}{(0.002)}$	$\frac{0.35}{(0.014)}$	2
MF-NSMF175	$\frac{3.00}{(0.118)}$	$\frac{3.50}{(0.138)}$	$\frac{1.40}{(0.055)}$	$\frac{1.80}{(0.071)}$	$\frac{0.70}{(0.028)}$	$\frac{1.60}{(0.063)}$	$\frac{0.25}{(0.010)}$				1
MF-NSMF200	$\frac{3.00}{(0.118)}$	$\frac{3.50}{(0.138)}$	$\frac{1.40}{(0.055)}$	$\frac{1.80}{(0.071)}$	$\frac{0.70}{(0.028)}$	$\frac{1.60}{(0.063)}$	$\frac{0.25}{(0.010)}$				1

DIMENSIONS:  $\frac{\text{MM}}{\text{(INCHES)}}$

Specifications are subject to change without notice.

Users should verify actual device performance in their specific applications.

The products described herein and this document are subject to specific legal disclaimers as set forth on the last page of this document, and at [www.bourns.com/docs/legal/disclaimer.pdf](http://www.bourns.com/docs/legal/disclaimer.pdf).

## Solder Reflow Recommendations

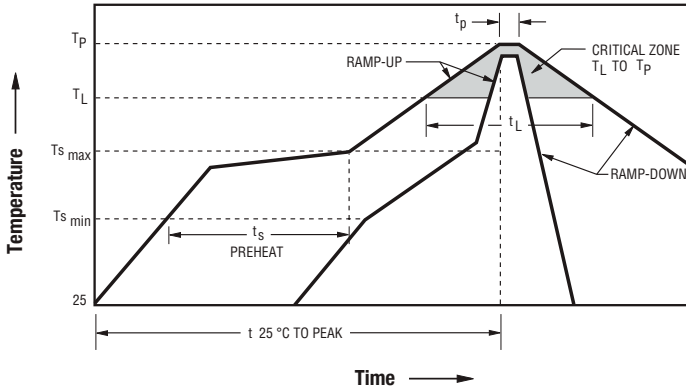

### Notes:

- MF-NSMF models are intended for reflow soldering (including, but not limited to heating plate, hot air, IR, nitrogen, and vapor phase).
- Wave soldering is permissible only if the device is on the top of the PCB, opposite the heat source.
- Hand soldering is not recommended for these devices.
- All temperatures refer to the topside of the device, measured on the device body surface.
- If reflow temperatures exceed the recommended profile, devices may not meet the published specifications.
- Compatible with Pb and Pb-free solder reflow profiles.
- Excess solder may cause a short circuit.
- Please refer to the [Multifuse® Polymer PTC Resettable Fuse Soldering Recommendations](#) for more details.

Profile Feature	Pb-Free Assembly
Average Ramp-Up Rate ( $T_{s_{max}}$ to $T_p$ )	3 °C / second max.
PREHEAT: Temperature Min. ( $T_{s_{min}}$ ) Temperature Max. ( $T_{s_{max}}$ ) Time ( $T_{s_{min}}$ to $T_{s_{max}}$ ) (ts)	150 °C 200 °C 60~180 seconds
TIME MAINTAINED ABOVE: Temperature ( $T_L$ ) Time ( $t_L$ )	217 °C 60~150 seconds
Peak Temperature ( $T_p$ )	260 °C
Time within 5 °C of Actual Peak Temperature ( $t_p$ )	20~40 seconds
Ramp-Down Rate	6 °C / second max.
Time 25 °C to Peak Temperature	8 minutes max.

Asia-Pacific: Tel: +886-2 2562-4117 • Email: [asiacus@bourns.com](mailto:asiacus@bourns.com)

Europe: Tel: +36 88 885 877 • Email: [eurocus@bourns.com](mailto:eurocus@bourns.com)

Mexico: Tel: +52 614 478 0400 • Email: [mexicus@bourns.com](mailto:mexicus@bourns.com)

The Americas: Tel: +1-951 781-5500 • Email: [americus@bourns.com](mailto:americus@bourns.com)

[www.bourns.com](http://www.bourns.com)

Specifications are subject to change without notice.

Users should verify actual device performance in their specific applications.

The products described herein and this document are subject to specific legal disclaimers as set forth on the last page of this document, and at [www.bourns.com/docs/legal/disclaimer.pdf](http://www.bourns.com/docs/legal/disclaimer.pdf).

## Tape and Reel Specifications

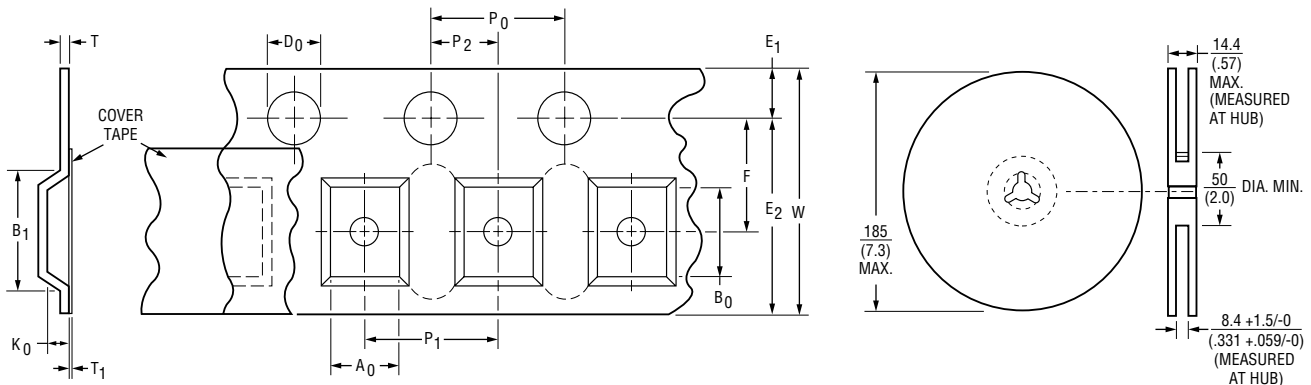

Tape Dimensions per EIA-481	MF-NSMF012 MF-NSMF175 MF-NSMF200	MF-NSMF016 MF-NSMF020 MF-NSMF035 MF-NSMF050	MF-NSMF075	MF-NSMF110 MF-NSMF125 MF-NSMF150
W	$8.00 \pm 0.30$ (.315 ± .012)			
P <sub>0</sub>	$4.00 \pm 0.10$ (.157 ± .004)			
10 P <sub>0</sub>	$40.0 \pm 0.20$ (1.575 ± .008)			
P <sub>1</sub>	$4.00 \pm 0.10$ (.157 ± .004)			
P <sub>2</sub>	$2.00 \pm 0.05$ (.079 ± .002)			
A <sub>0</sub>	$1.95 \pm 0.10$ (.077 ± .004)	$1.90 \pm 0.10$ (.075 ± .004)	$1.90 \pm 0.10$ (.075 ± .004)	$1.90 \pm 0.10$ (.075 ± .004)
B <sub>0</sub>	$3.55 \pm 0.10$ (.140 ± .004)	$3.45 \pm 0.10$ (.136 ± .004)	$3.50 \pm 0.10$ (.138 ± .004)	$3.45 \pm 0.10$ (.136 ± .004)
B <sub>1</sub> max	$4.35$ (.171)			
D <sub>0</sub>	$1.50 +0.10/-0$ (.059 +.004/-0)			
F	$3.50 \pm 0.05$ (.138 ± .002)			
E <sub>1</sub>	$1.75 \pm 0.10$ (.069 ± .004)			
E <sub>2</sub> typ	$6.25$ (.246)			
T max	$0.60$ (.024)			
T <sub>1</sub> max	$0.10$ (.004)			
K <sub>0</sub>	$1.35 \pm 0.10$ (.053 ± .004)	$1.04 \pm 0.10$ (.041 ± .004)	$0.85 \pm 0.10$ (.033 ± .004)	$0.85 \pm 0.10$ (.033 ± .004)
Leader min.	$390$ (15.4)			
Trailer min.	$160$ (6.3)			

Specifications are subject to change without notice.

Users should verify actual device performance in their specific applications.

The products described herein and this document are subject to specific legal disclaimers as set forth on the last page of this document, and at [www.bourns.com/docs/legal/disclaimer.pdf](http://www.bourns.com/docs/legal/disclaimer.pdf).

DIMENSIONS:  $\frac{\text{MM}}{\text{(INCHES)}}$

# MF-NSMF Series - PTC Resettable Fuses

**BOURNS®**

## Tape and Reel Specifications (continued)

Tape Dimensions per EIA-481	MF-NSMF005/30X MF-NSMF005/60X MF-NSMF010/30X MF-NSMF010/60X MF-NSMF012/48X MF-NSMF016/48X MF-NSMF110/16X MF-NSMF125/8X MF-NSMF150/6X	MF-NSMF020X MF-NSMF025X MF-NSMF025/24X MF-NSMF025/30X MF-NSMF035X MF-NSMF035/24X MF-NSMF050/8X MF-NSMF050/16X MF-NSMF075/8X MF-NSMF110/6X	MF-NSMF035/30X MF-NSMF050/24X	MF-NSMF075/13X MF-NSMF075X/16X
W	$\frac{8.00 \pm 0.30}{(.315 \pm .012)}$			
P <sub>0</sub>	$\frac{4.00 \pm 0.10}{(.157 \pm .004)}$			
10 P <sub>0</sub>	$\frac{40.0 \pm 0.20}{(1.575 \pm .008)}$			
P <sub>1</sub>	$\frac{4.00 \pm 0.10}{(.157 \pm .004)}$			
P <sub>2</sub>	$\frac{2.00 \pm 0.05}{(.079 \pm .002)}$			
A <sub>0</sub>	$\frac{1.90 \pm 0.10}{(.075 \pm .004)}$	$\frac{1.95 \pm 0.10}{(.077 \pm .004)}$	$\frac{1.95 \pm 0.10}{(.077 \pm .004)}$	$\frac{1.95 \pm 0.10}{(.077 \pm .004)}$
B <sub>0</sub>	$\frac{3.50 \pm 0.10}{(.138 \pm .004)}$	$\frac{3.55 \pm 0.10}{(.140 \pm .004)}$	$\frac{3.55 \pm 0.10}{(.140 \pm .004)}$	$\frac{3.50 \pm 0.10}{(.138 \pm .004)}$
B <sub>1 max</sub>	$\frac{4.35}{(.171)}$			
D <sub>0</sub>	$\frac{1.50 +0.10/-0}{(.059 +.004/-0)}$			
F	$\frac{3.50 \pm 0.05}{(.138 \pm .002)}$			
E <sub>1</sub>	$\frac{1.75 \pm 0.10}{(.069 \pm .004)}$			
E <sub>2 typ</sub>	$\frac{6.25}{(.246)}$			
T max	$\frac{0.60}{(.024)}$			
T <sub>1 max</sub>	$\frac{0.10}{(.004)}$			
K <sub>0</sub>	$\frac{1.04 \pm 0.10}{(.041 \pm .004)}$	$\frac{0.80 \pm 0.10}{(.031 \pm .004)}$	$\frac{1.35 \pm 0.10}{(.053 \pm .004)}$	$\frac{1.22 \pm 0.10}{(.048 \pm .004)}$
Leader min.	$\frac{390}{(15.4)}$			
Trailer min.	$\frac{160}{(6.3)}$			

DIMENSIONS:  $\frac{\text{MM}}{\text{(INCHES)}}$

MF-NSMF SERIES, REV. AD, 05/24

Specifications are subject to change without notice.

Users should verify actual device performance in their specific applications.

The products described herein and this document are subject to specific legal disclaimers as set forth on the last page of this document, and at [www.bourns.com/docs/legal/disclaimer.pdf](http://www.bourns.com/docs/legal/disclaimer.pdf).

**Application Notice**

- Users are responsible for independent and adequate evaluation of Bourns® Multifuse® Polymer PTC devices in the user's application, including the PPTC device characteristics stated in the applicable data sheet.
- Polymer PTC devices must not be allowed to operate beyond their stated maximum ratings. Operation in excess of such maximum ratings could result in damage to the PTC device and possibly lead to electrical arcing and/or fire. Circuits with inductance may generate a voltage above the rated voltage of the polymer PTC device and should be thoroughly evaluated within the user's application during the PTC selection and qualification process.
- Polymer PTC devices are intended to protect against adverse effects of temporary overcurrent or overtemperature conditions up to rated limits and are not intended to serve as protective devices where overcurrent or overvoltage conditions are expected to be repetitive or prolonged.
- In normal operation, polymer PTC devices experience thermal expansion under fault conditions. Thus, a polymer PTC device must be protected against mechanical stress, and must be given adequate clearance within the user's application to accommodate such thermal expansion. Rigid potting materials or fixed housings or coverings that do not provide adequate clearance should be thoroughly examined and tested by the user, as they may result in the malfunction of polymer PTC devices if the thermal expansion is inhibited.
- Exposure to lubricants, silicon-based oils, solvents, gels, electrolytes, acids, and other related or similar materials may adversely affect the performance of polymer PTC devices.
- Aggressive solvents may adversely affect the performance of polymer PTC devices. Conformal coating, encapsulating, potting, molding, and sealing materials may contain aggressive solvents including but not limited to xylene and toluene, which are known to cause adverse effects on the performance of polymer PTCs. Such aggressive solvents must be thoroughly cured or baked to ensure their complete removal from polymer PTCs to minimize the possible adverse effect on the device.
- Recommended storage conditions should be followed at all times. Such conditions can be found on the applicable data sheet and on the Multifuse® Polymer PTC Moisture/Reflow Sensitivity Classification (MSL) note:  
[https://www.bourns.com/docs/RoHS-MSL/msl\\_mf.pdf](https://www.bourns.com/docs/RoHS-MSL/msl_mf.pdf)

This legal disclaimer applies to purchasers and users of Bourns® products manufactured by or on behalf of Bourns, Inc. and its affiliates (collectively, "Bourns").

Unless otherwise expressly indicated in writing, Bourns® products and data sheets relating thereto are subject to change without notice. Users should check for and obtain the latest relevant information and verify that such information is current and complete before placing orders for Bourns® products.

The characteristics and parameters of a Bourns® product set forth in its data sheet are based on laboratory conditions, and statements regarding the suitability of products for certain types of applications are based on Bourns' knowledge of typical requirements in generic applications. The characteristics and parameters of a Bourns® product in a user application may vary from the data sheet characteristics and parameters due to (i) the combination of the Bourns® product with other components in the user's application, or (ii) the environment of the user application itself. The characteristics and parameters of a Bourns® product also can and do vary in different applications and actual performance may vary over time. Users should always verify the actual performance of the Bourns® product in their specific devices and applications, and make their own independent judgments regarding the amount of additional test margin to design into their device or application to compensate for differences between laboratory and real world conditions.

Unless Bourns has explicitly designated an individual Bourns® product as meeting the requirements of a particular industry standard (e.g., IATF 16949) or a particular qualification (e.g., UL listed or recognized), Bourns is not responsible for any failure of an individual Bourns® product to meet the requirements of such industry standard or particular qualification. Users of Bourns® products are responsible for ensuring compliance with safety-related requirements and standards applicable to their devices or applications.

Bourns® products are not recommended, authorized or intended for use in nuclear, lifesaving, life-critical or life-sustaining applications, nor in any other applications where failure or malfunction may result in personal injury, death, or severe property or environmental damage. Unless expressly and specifically approved in writing by two authorized Bourns representatives on a case-by-case basis, use of any Bourns® products in such unauthorized applications might not be safe and thus is at the user's sole risk. Life-critical applications include devices identified by the U.S. Food and Drug Administration as Class III devices and generally equivalent classifications outside of the United States.

Bourns expressly identifies those Bourns® standard products that are suitable for use in automotive applications on such products' data sheets in the section entitled "Applications." Unless expressly and specifically approved in writing by two authorized Bourns representatives on a case-by-case basis, use of any other Bourns® standard products in an automotive application might not be safe and thus is not recommended, authorized or intended and is at the user's sole risk. If Bourns expressly identifies a sub-category of automotive application in the data sheet for its standard products (such as infotainment or lighting), such identification means that Bourns has reviewed its standard product and has determined that if such Bourns® standard product is considered for potential use in automotive applications, it should only be used in such sub-category of automotive applications. Any reference to Bourns® standard product in the data sheet as compliant with the AEC-Q standard or "automotive grade" does not by itself mean that Bourns has approved such product for use in an automotive application.

Bourns® standard products are not tested to comply with United States Federal Aviation Administration standards generally or any other generally equivalent governmental organization standard applicable to products designed or manufactured for use in aircraft or space applications. Bourns expressly identifies Bourns® standard products that are suitable for use in aircraft or space applications on such products' data sheets in the section entitled "Applications." Unless expressly and specifically approved in writing by two authorized Bourns representatives on a case-by-case basis, use of any other Bourns® standard product in an aircraft or space application might not be safe and thus is not recommended, authorized or intended and is at the user's sole risk.

The use and level of testing applicable to Bourns® custom products shall be negotiated on a case-by-case basis by Bourns and the user for which such Bourns® custom products are specially designed. Absent a written agreement between Bourns and the user regarding the use and level of such testing, the above provisions applicable to Bourns® standard products shall also apply to such Bourns® custom products.

Users shall not sell, transfer, export or re-export any Bourns® products or technology for use in activities which involve the design, development, production, use or stockpiling of nuclear, chemical or biological weapons or missiles, nor shall they use Bourns® products or technology in any facility which engages in activities relating to such devices. The foregoing restrictions apply to all uses and applications that violate national or international prohibitions, including embargos or international regulations. Further, Bourns® products and Bourns technology and technical data may not under any circumstance be exported or re-exported to countries subject to international sanctions or embargoes. Bourns® products may not, without prior authorization from Bourns and/or the U.S. Government, be resold, transferred, or re-exported to any party not eligible to receive U.S. commodities, software, and technical data.

To the maximum extent permitted by applicable law, Bourns disclaims (i) any and all liability for special, punitive, consequential, incidental or indirect damages or lost revenues or lost profits, and (ii) any and all implied warranties, including implied warranties of fitness for particular purpose, non-infringement and merchantability.



*For your convenience, copies of this Legal Disclaimer Notice with German, Spanish, Japanese, Traditional Chinese and Simplified Chinese bilingual versions are available at:*

*Web Page:* <http://www.bourns.com/legal/disclaimers-terms-and-policies>



*PDF:* <http://www.bourns.com/docs/Legal/disclaimer.pdf>

## Looking for pricing, stock, or lifecycle information?

Click below to explore more details on WIN SOURCE:

-  [View MF-NSMF110-2 on WIN SOURCE](#)
-  [Bourns Inc. Information](#)

## Optimize Your Supply Chain with WIN SOURCE Solutions

-  Global Sourcing Solution
-  Obsolete Management
-  Cost Control Management
-  Shortage Management
-  Alternative Solution
-  Excess Inventory Management