



THE DATASHEET OF
618015231221



REVISIONS

P	LTR	DESCRIPTION	DATE	DWN	APVD
	H	REVISED PER CM-1754	17AUG1988	PKC	RS
	H1	REVISED PER ECN-23-233438	02OCT2023	WLS	VS

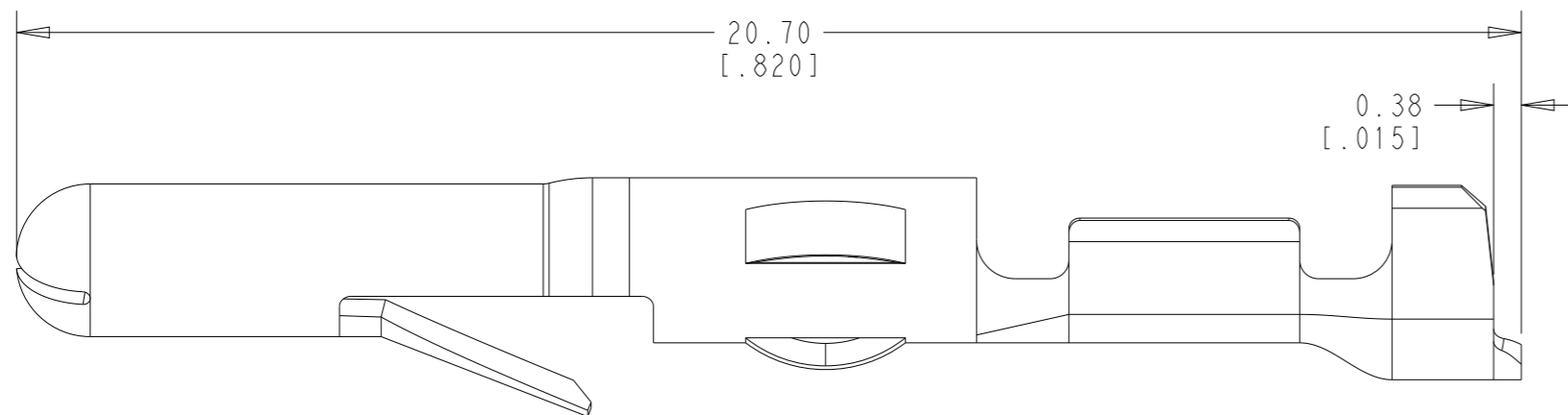

NOTES:

- FOR ADDITIONAL INFORMATION SEE DRAWING 350079.
- THIS TERMINAL TO BE SUPPLIED IN INDIVIDUAL FORM, NOT AS A CONTINUOUS STRIP.
- $\triangle 3$.000030 THK GOLD INSIDE OF WIRE BARREL & ON THE TIP OF PIN; REMINDER OF CONTACT IS NICKEL PLATED.
- DIMENSIONS IN BRACKETS ARE IN INCHES.

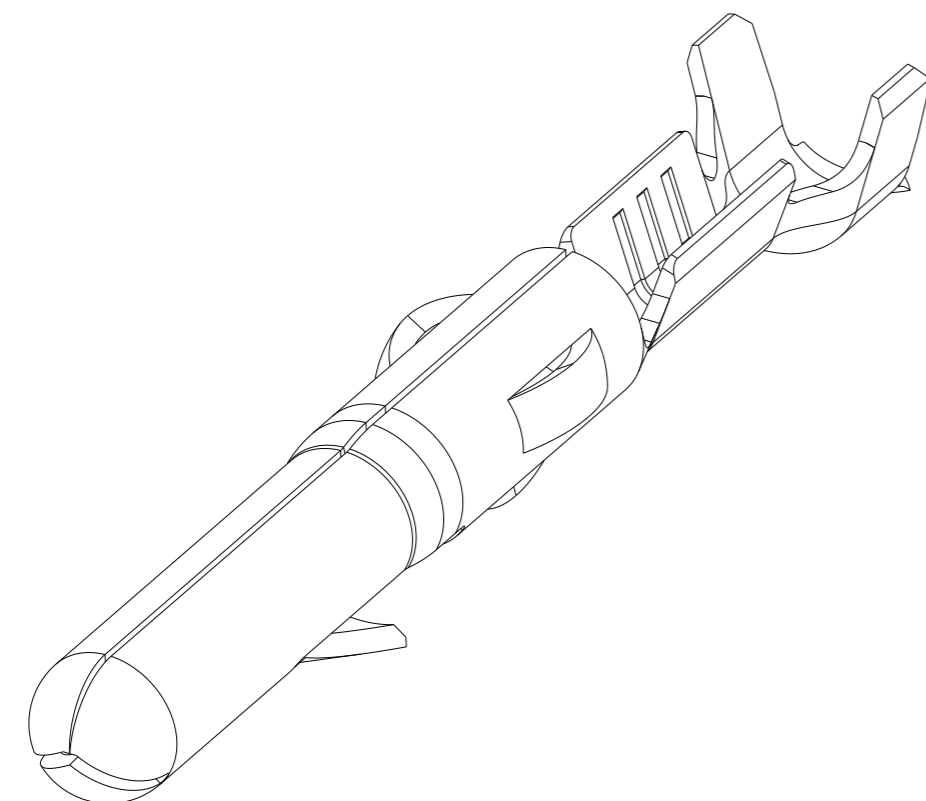

.040-.075 OR (2) .040 MAX	30-22	$\triangle 3$ GOLD	.012 BRASS	61174-5
.040-.075 OR (2) .040 MAX	30-22	TIN	.012 BRASS	61174-1
INSULATION RANGE	WIRE SIZE	FINISH	MATERIAL	PART NUMBER

THIS DRAWING IS A CONTROLLED DOCUMENT.		DWN J. R. KUNKLE 06APR1967	<p>TE Connectivity</p> <p>NAME PIN, LOOSE PIECE COMMERCIAL MATE-N-LOK</p>				
DIMENSIONS: mm [INCHES]		CHK J. R. KUNKLE 10APR1967				APVD W. PANYA 17APR1967	PRODUCT SPEC 108-1000
TOLERANCES UNLESS OTHERWISE SPECIFIED:		APPLICATION SPEC 114-1012				WEIGHT -	
0 PLC ±- 1 PLC ±- ±0.38 [.015] 2 PLC ±- 3 PLC ±- 4 PLC ±- ANGLES ±1°0'		MATERIAL SEE TABLE				FINISH SEE TABLE	
MATERIAL SEE TABLE		FINISH SEE TABLE		SIZE A3 CAGE CODE 00779 DRAWING NO. C-61174 RESTRICTED TO - CUSTOMER DRAWING SCALE 10:1 SHEET 1 OF 1 REV H1			

Looking for pricing, stock, or lifecycle information?

Click below to explore more details on WIN SOURCE:

 [View 618015231221 on WIN SOURCE](#)

 [Wurth Electronics Inc Information](#)

Optimize Your Supply Chain with WIN SOURCE Solutions

-  Global Sourcing Solution
-  Obsolete Management
-  Cost Control Management
-  Shortage Management
-  Alternative Solution
-  Excess Inventory Management