



**THE DATASHEET OF**  
**2171840001**



## Printed-circuit board connector - HSCH 1,5-2U/12 9005 - 2202233

Please be informed that the data shown in this PDF Document is generated from our Online Catalog. Please find the complete data in the user's documentation. Our General Terms of Use for Downloads are valid (<http://phoenixcontact.com/download>)



HSC header, touch-proof, 2 units, 12 connections, color: black

### Why buy this product

- ✓ Item is from the ME-IO product range
- ✓ Tool-free mounting
- ✓ Available in overall widths from 18.8 mm
- ✓ Inflammability class V0 according to UL 94
- ✓ Front push-in connection technology
- ✓ Can be mounted on the DIN rail
- ✓ Optional with bus connector for DIN rail mounting



### Key Commercial Data

Packing unit	1 STK
Minimum order quantity	50 STK
Custom tariff number	85366990
Country of origin	Germany

### Technical data

#### Dimensions

Length	16 mm
Pitch	3.45 mm
Width	12.45 mm
Pin dimensions	0,8 x 0,8 mm
Hole diameter	1.3 mm

# Printed-circuit board connector - HSCH 1,5-2U/12 9005 - 2202233

## Technical data

### General

Insulating material group	I
Rated surge voltage (III/3)	2.5 kV
Rated surge voltage (III/2)	2.5 kV
Rated surge voltage (II/2)	2.5 kV
Rated voltage (III/3)	63 V
Rated voltage (III/2)	320 V
Rated voltage (II/2)	320 V
Connection in acc. with standard	EN-VDE
Nominal current $I_N$	8 A
Insulating material	PA
Flammability rating according to UL 94	V0
Number of positions	12

### Standards and Regulations

Connection in acc. with standard	EN-VDE
Flammability rating according to UL 94	V0

## Drawings

Drilling diagram

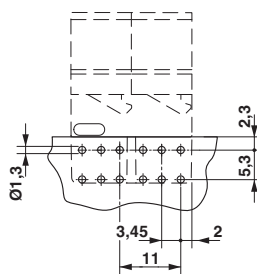

Diagram

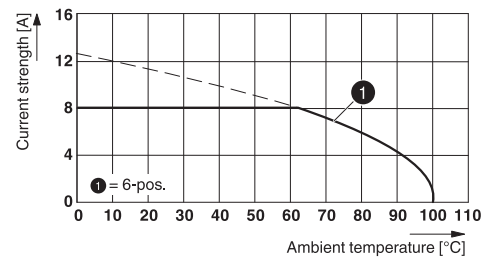

Type: HSCP-SP 1,5-1U/ 6 7035 with HSCH 1,5-2U/12 9005

## Classifications

eCl@ss

eCl@ss 5.1	27180506
eCl@ss 6.0	27180802
eCl@ss 8.0	27440402
eCl@ss 9.0	27440402

## Printed-circuit board connector - HSCH 1,5-2U/12 9005 - 2202233

### Classifications

ETIM

ETIM 5.0	EC002637
----------	----------

### Accessories

Accessories

Coding element

Coding profile - CP-DMC 1,5 NAT - 1790647



Coding profile, for insertion between the coding ribs of the connector and the header following the reflow soldering process, insulating material, color: natural

---

### Necessary add-on products

Printed-circuit board connector - HSCP-SP 1,5-1U/ 6 7035 - 2202234



HSC Push-in connector, for touch-proof HSC headers, 1 unit, with integrated test point, 6-pos., color: light gray

## Looking for pricing, stock, or lifecycle information?

Click below to explore more details on WIN SOURCE:

 [View 2171840001 on WIN SOURCE](#)

 [Molex, LLC Information](#)

## Optimize Your Supply Chain with WIN SOURCE Solutions

-  Global Sourcing Solution
-  Obsolete Management
-  Cost Control Management
-  Shortage Management
-  Alternative Solution
-  Excess Inventory Management