



## Flush-type connector - SACC-SQ-M12MS-5CON-25F/0,5 - 1440973

Please be informed that the data shown in this PDF Document is generated from our Online Catalog. Please find the complete data in the user's documentation. Our General Terms of Use for Downloads are valid (<http://download.phoenixcontact.com>)



Sensor/Actuator flush-type plug, 5-pos., M12, A-coded, front/square flange mounting, with 0.5 m TPE litz wire, 5 x 0.34 mm<sup>2</sup>

### Product Features

- ✓ 4 x fixing hole, 2.7 mm
- ✓ With form seal for M2.5 screws



### Key commercial data

|                                      |          |
|--------------------------------------|----------|
| Packing unit                         | 1 1      |
| Weight per Piece (excluding packing) | 26.2 GRM |
| Custom tariff number                 | 85444290 |
| Country of origin                    | Germany  |

### Technical data

#### Dimensions

|                 |       |
|-----------------|-------|
| Length of cable | 0.5 m |
|-----------------|-------|

#### Ambient conditions

|                                 |                                  |
|---------------------------------|----------------------------------|
| Ambient temperature (operation) | -25 °C ... 85 °C (Plug / socket) |
| Degree of protection            | IP67                             |

#### General

|                       |              |
|-----------------------|--------------|
| Rated current at 40°C | 4 A          |
| Rated voltage         | 60 V         |
| Number of positions   | 5            |
| Contact resistance    | ≤ 3 mΩ       |
| Insulation resistance | ≥ 100 MΩ     |
| Coding                | A - standard |

## Flush-type connector - SACC-SQ-M12MS-5CON-25F/0,5 - 1440973

### Technical data

#### General

|                        |                               |
|------------------------|-------------------------------|
| Standards/regulations  | M12 connector IEC 61076-2-101 |
| Status display         | No                            |
| Surge voltage category | II                            |
| Pollution degree       | 3                             |
| Test voltage           | 1.5 kV                        |
| Connection method      | Individual wires              |
| Mounting type          | Front mounting Square flange  |

#### Material

|   |                              |
|---|------------------------------|
| Inflammability class according to UL 94 | V0                           |
| Contact material                        | CuZn                         |
| Contact surface material                | Ni/Au                        |
| Contact carrier material                | PA 66                        |
| Material, knurls                        | Zinc die-cast, nickel-plated |
| Sealing material                        | NBR                          |

#### Cable

|                                 |  |
|---------------------------------|--|
| Cable type                      | TPE litz wire                                |
| Conductor cross section         | 0.34 mm <sup>2</sup>                         |
| AWG signal line                 | 22   |
| Wire colors                     | Brown, white, blue, black, gray              |
| Conductor material              | Tin-plated Cu litz wires                     |
| Ambient temperature (operation) | -25 °C ... 90 °C (cable, fixed installation) |

### Classifications

#### eCl@ss

|            |          |
|------------|----------|
| eCl@ss 4.0 | 27140815 |
| eCl@ss 4.1 | 27140815 |
| eCl@ss 5.0 | 27143423 |
| eCl@ss 5.1 | 27143423 |
| eCl@ss 6.0 | 27279220 |
| eCl@ss 7.0 | 27440103 |
| eCl@ss 8.0 | 27440103 |

#### ETIM

|          |          |
|----------|----------|
| ETIM 2.0 | EC001297 |
| ETIM 3.0 | EC002061 |

# Flush-type connector - SACC-SQ-M12MS-5CON-25F/0,5 - 1440973

## Classifications

### ETIM

|          |          |
|----------|----------|
| ETIM 4.0 | EC002061 |
| ETIM 5.0 | EC002061 |

### UNSPSC

|               |          |
|---------------|----------|
| UNSPSC 6.01   | 31251501 |
| UNSPSC 7.0901 | 31251501 |
| UNSPSC 11     | 31251501 |
| UNSPSC 12.01  | 31251501 |
| UNSPSC 13.2   | 39121413 |

## Approvals

### Approvals

---

#### Approvals

UL Recognized / GOST / GOST

---

#### Ex Approvals

---

#### Approvals submitted

---

## Approval details

|   |       |
|---|-------|
| UL Recognized  |       |
| mm <sup>2</sup> /AWG/kcmil  | 26-20 |
| Nominal current I <sub>N</sub>  | 4 A   |
| Nominal voltage U <sub>N</sub>  | 60 V  |

|  |
|--|
| GOST  |
|--|

# Flush-type connector - SACC-SQ-M12MS-5CON-25F/0,5 - 1440973

## Approvals



## Drawings

Schematic diagram

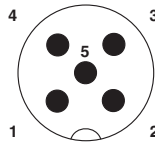

Pin assignment M12 male connector, 5-pos., A-coded, male side

Dimensioned drawing

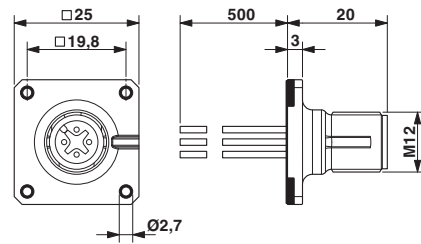

M12 flush-type plug

Circuit diagram



Contact assignment of the M12 plug and the M12 socket

## Looking for pricing, stock, or lifecycle information?

Click below to explore more details on WIN SOURCE:

 [View 1440119 on WIN SOURCE](#)

 [Phoenix Contact Information](#)

## Optimize Your Supply Chain with WIN SOURCE Solutions

-  Global Sourcing Solution
-  Obsolete Management
-  Cost Control Management
-  Shortage Management
-  Alternative Solution
-  Excess Inventory Management