



**THE DATASHEET OF**  
**3240142**



## Fork-type cable lug - C-FC 2,5/M3 - 3240142

Please be informed that the data shown in this PDF Document is generated from our Online Catalog. Please find the complete data in the user's documentation. Our General Terms of Use for Downloads are valid (<http://phoenixcontact.com/download>)



Fork-type cable lug, non-insulated, 1.1 - 2.5 mm<sup>2</sup>, M3

### Product Features

- ✓ The fork-type cable lugs without plastic sleeve feature a hard-soldered neck. In conjunction with the CRIMPFOX-RC ... and CRIMPFOX-RCI ... pliers they can be used to achieve maximum conductor pull-out forces
- ✓ The insulated versions are halogen-free and feature "EASY ENTRY" technology



### Key Commercial Data

Packing unit	1 pc
Minimum order quantity	100 pc
Weight per Piece (excluding packing)	0.61 g
Custom tariff number	85369010
Country of origin	China

### Technical data

#### Dimensions

Length (b)	16 mm
Width (a)	5.7 mm
Length of insulation sleeve (c)	4.8 mm
Inner dimension of the insulating collar (d)	2.5 mm
Inner diameter (f)	3.2 mm
Material thickness (g)	0.8 mm

#### Ambient conditions

Ambient temperature (operation)	110 °C
---------------------------------	--------

#### General

Color	silver
-------	--------

## Fork-type cable lug - C-FC 2,5/M3 - 3240142

### Technical data

#### General

Stripping length	8 mm
Components	Halogen-free
Material	Copper
Coating	Tin-plated

### Classifications

#### eCl@ss

eCl@ss 4.0	27060701
eCl@ss 4.1	27060701
eCl@ss 5.0	27400201
eCl@ss 5.1	27400201
eCl@ss 6.0	27400201
eCl@ss 7.0	27400201
eCl@ss 8.0	27400204

#### ETIM

ETIM 2.0	EC000005
ETIM 3.0	EC000005
ETIM 4.0	EC001052
ETIM 5.0	EC001052

#### UNSPSC

UNSPSC 6.01	30211923
UNSPSC 7.0901	27121703
UNSPSC 11	27121703
UNSPSC 12.01	27121703
UNSPSC 13.2	27121703

### Approvals

#### Approvals

---

Approvals

EAC / EAC

---

Ex Approvals

## Fork-type cable lug - C-FC 2,5/M3 - 3240142

### Approvals

---

Approvals submitted

---

### Approval details

EAC
-----

EAC
-----

### Drawings

Dimensional drawing

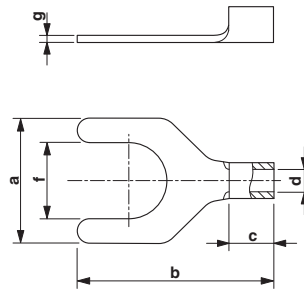

## Looking for pricing, stock, or lifecycle information?

Click below to explore more details on WIN SOURCE:

 [View 3240142 on WIN SOURCE](#)

 [Phoenix Contact Information](#)

## Optimize Your Supply Chain with WIN SOURCE Solutions

-  Global Sourcing Solution
-  Obsolete Management
-  Cost Control Management
-  Shortage Management
-  Alternative Solution
-  Excess Inventory Management