

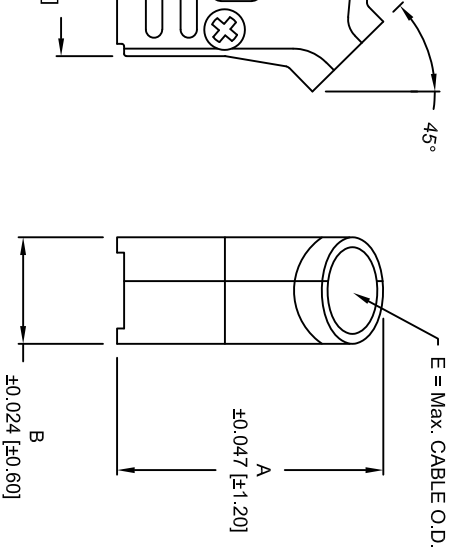

**THE DATASHEET OF**  
**954-009-030R121**





#4-40 THREADS\*

\*NORCOMP RECOMMENDS PURCHASING OUR SLIDE LOCK HARDWARE. MUST BE PURCHASED SEPARATELY.

**SPECIFICATION:**

BACKSHELL: ZINC, NICKEL PLATED,  
COPPER UNDER PLATE  
HOUSING SCREW: STEEL, ZINC PLATED  
COMPRESSION INSERT: ABS, UL94-HB  
OPERATING TEMPERATURE: -40°C TO +120°C

**BACKSHELL KIT INCLUDES:**

- (2) BACKSHELL HALVES
- (2) MOUNTING SCREWS
- (1) PLASTIC INSERTS TREE (4-SETS)
- DIAMETERS: 0.157 [4.00], 0.167 [5.00], 0.276 [7.00], 0.354 [9.00]

UNITS (in/mm)		
C	D	E
0.984	1.220	0.512
24.99	31.00	13.00
1.312	1.555	0.512
33.32	39.50	13.00
1.852	2.094	0.512
47.04	53.20	13.00
2.500	2.744	0.512
63.50	69.70	13.00

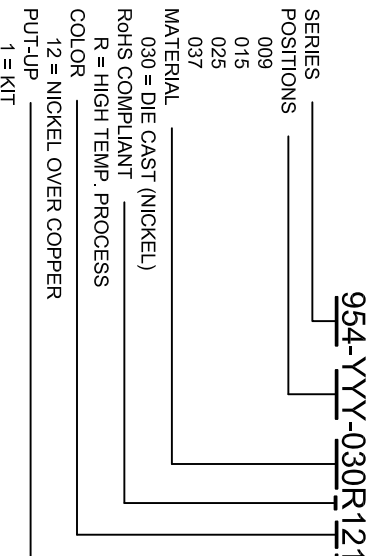

954-YYY-030R121

SERIES \_\_\_\_\_  
POSITIONS \_\_\_\_\_  
009 \_\_\_\_\_  
015 \_\_\_\_\_  
025 \_\_\_\_\_  
037 \_\_\_\_\_  
MATERIAL \_\_\_\_\_  
030 = DIE CAST (NICKEL)  
ROHS COMPLIANT \_\_\_\_\_  
R = HIGH TEMP. PROCESS  
COLOR \_\_\_\_\_  
PUT-UP \_\_\_\_\_  
12 = NICKEL OVER COPPER  
1 = KIT

IFICATIONS ARE  
AND SHALL NOT  
R USED AS THE  
RE OR SALE OF  
EN PERMISSION.

DRAWN:  
C. SMITH

DATE:  
03/30/2007

UNITS = inch [mm]

**NorComp**

DO NOT SCALE FROM DRAWING

SCALE: \_\_\_\_\_  
NTS \_\_\_\_\_

SHEET 1 OF 1

REV 3

DWG NO. 954-YYY-030R121

## Looking for pricing, stock, or lifecycle information?

Click below to explore more details on WIN SOURCE:

 [View 954-009-030R121 on WIN SOURCE](#)

 [NorComp Inc. Information](#)

## Optimize Your Supply Chain with WIN SOURCE Solutions

-  Global Sourcing Solution
-  Obsolete Management
-  Cost Control Management
-  Shortage Management
-  Alternative Solution
-  Excess Inventory Management