



**THE DATASHEET OF**  
**3563**



# "MINI" AUTOMOTIVE FUSE CLIPS & HOLDERS



For .110 (2.8) x .032 (.80) MINI BLADE FUSES

For Littelfuse Mini 297 or 997 series/Bussmann ATM series or equivalent

## VERTICAL FUSE ENTRY

### Thru Hole Mount



- Low Profile

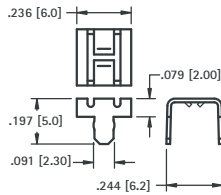

#### Mounting Detail For Two Clips

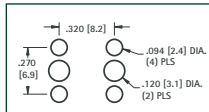

#### Pad Layout For Two Clips

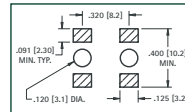

AVAILABLE ON TAPE AND REEL

### Surface Mount



- Low Profile

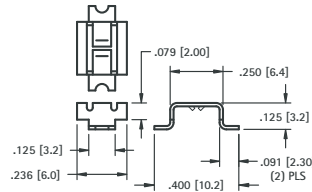

CAT. NO. 3563 (Bulk)

CAT. NO. 3563TR (Tape & Reel)

Tape & Reel Spec's: 24mm wide; 12mm pitch; 13 inch reel (1500 pieces per reel)

CAT. NO. 3564

## SPECIFICATIONS

Material: .012 (.30) Brass

Insulator: Nylon, UL Rated 94V-0

UL Temperature Rating: -58°F to +292°F (-50°C to +145°C)

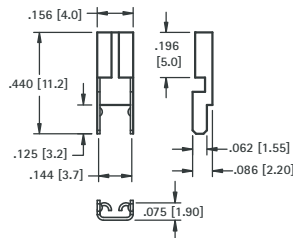

#### Mounting Detail For Two Clips

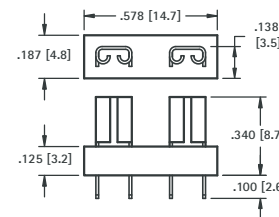
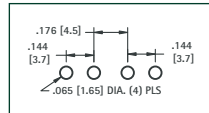

CAT. NO. 3544 Tin-Nickel Plate

UL Current Rating: 30 Amps @ 500V AC

UL Current Rating: 20 Amps @ 500V AC

CAT. NO. 3544-2 Tin Plate

## LOW PROFILE MINI FUSE HOLDER

For Littelfuse Low Profile Mini 897 series or equivalent

- Low insertion force
- Thru hole PC mountable, maintains position during wave soldering
- Fuse holder fully insulates clips to protect fuse from shorting
- Holder assures proper spacing and reduces assembly time

## SPECIFICATIONS

Contacts: .016 (.41) Brass, Tin-Nickel Plate

Insulator: Nylon 4/6, UL Rated 94V-0

UL Current Rating: 30 Amps @ 500V AC

UL Temperature Rating: -58°F to +292°F (-50°C to +145°C)

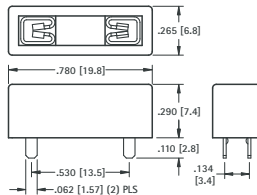

#### Mounting Detail

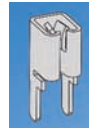
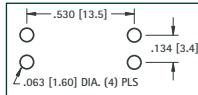

Refer to page 41 for Cat. No. 3557 Clip details

#### Mounting Detail

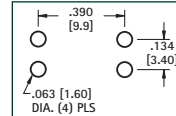

## MINI FUSE HOLDER

For Littelfuse Mini 297 or 997 series/Bussmann ATM or equivalents

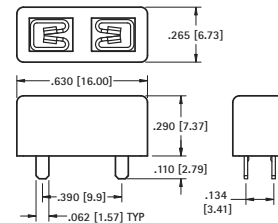

CAT. NO. 3557-2

CAT. NO. 3568

## HORIZONTAL FUSE ENTRY

For Littelfuse Mini 297 or 997 series/Bussmann ATM series or equivalent

## SPECIFICATIONS

Contacts: .012 (.30) Brass

Insulator: Nylon 6/6, UL Rated 94V-0

UL Temperature Rating: -58°F to +292°F (-50°C to +145°C)

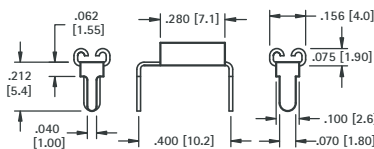

#### Mounting Detail For Two Clips

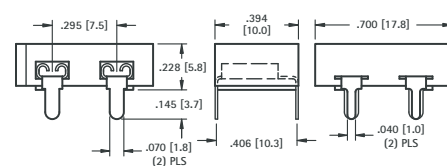
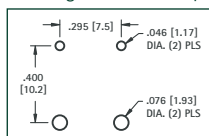

CAT. NO. 3549 Nickel Plate

UL Current Rating: 30 Amps @ 500V AC

UL Current Rating: 20 Amps @ 500V AC

CAT. NO. 3549-2 Tin Plate

"AUTO" FUSE CLIPS & HOLDERS



## Looking for pricing, stock, or lifecycle information?

Click below to explore more details on WIN SOURCE:

- ⊖ [View 3563 on WIN SOURCE](#)
- ⊖ [Keystone Electronics Information](#)

## Optimize Your Supply Chain with WIN SOURCE Solutions

- ✓ Global Sourcing Solution
- ✓ Obsolete Management
- ✓ Cost Control Management
- ✓ Shortage Management
- ✓ Alternative Solution
- ✓ Excess Inventory Management