



THE DATASHEET OF
971-037-030R121



CKSHELL

971-YYY-030R121

SERIES _____
POSITIONS _____

009 _____
015 _____
025 _____
037 _____

MATERIAL _____
030 = ZINC

COLOR: _____
12 = NICKEL OVER COPPER

PUT-UPS _____
1 = KIT

S
Ø0.354 [9.01]

CREW

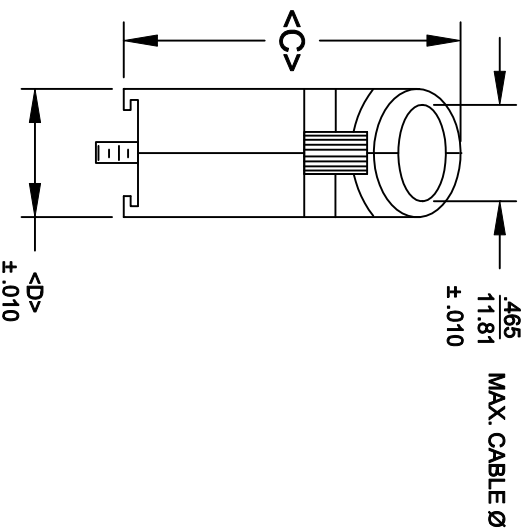
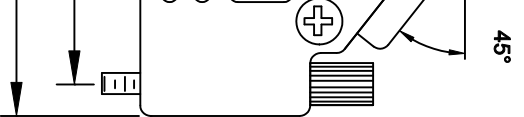

POS.	A	B	C	D
9	1.220 30.99	.984 24.99	1.496 38.00	570 14.48
15	1.595 40.51	1.312 33.32	1.618 41.10	.570 14.48
25	2.114 53.70	1.852 47.04	1.646 41.81	570 14.48
37	2.748 69.80	2.500 63.50	1.646 41.81	570 14.48

ROHS COMPLIANT



THESE DRAWINGS AND SPECIFICATIONS ARE THE PROPERTY OF NorComp AND SHALL NOT BE REPRODUCED, COPIED OR USED AS THE BASIS FOR THE MANUFACTURE OR SALE OF APPARATUS WITHOUT WRITTEN PERMISSION.

DRAWN: **PAM JENKINS** DATE: **6-10-05**

CHECKED: _____ DATE: _____

SCALE _____ SHEET **1** OF **1**

REV **8**

NorComp

DWG NO. **971-YYY-030R121**

Looking for pricing, stock, or lifecycle information?

Click below to explore more details on WIN SOURCE:

 [View 971-037-030R121 on WIN SOURCE](#)

 [NorComp Inc. Information](#)

Optimize Your Supply Chain with WIN SOURCE Solutions

-  Global Sourcing Solution
-  Obsolete Management
-  Cost Control Management
-  Shortage Management
-  Alternative Solution
-  Excess Inventory Management