

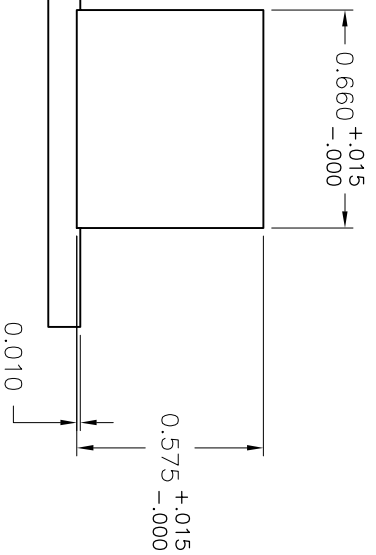

**THE DATASHEET OF**  
**1-6605832-1**

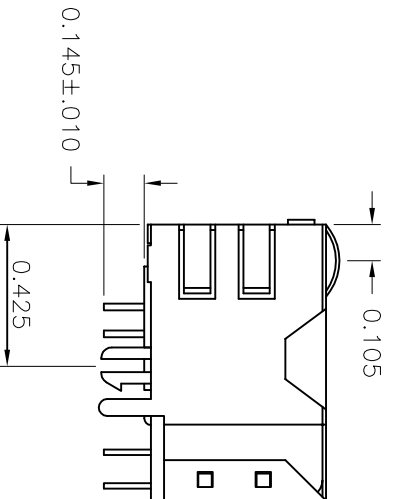

| LOG | REF | REVISIONS                 |           |    |       |
|-----|-----|---------------------------|-----------|----|-------|
| AA  | Z2  | DESCRIPTION               | DATE      | BY | APP'D |
|     | F   | DR                        |           |    |       |
|     | B1  | REvised PER ECO-11-005140 | 29MAR11   | RK | HMR   |
|     | C   | ECO-11-013901             | 30MAY2011 | EL | LR    |

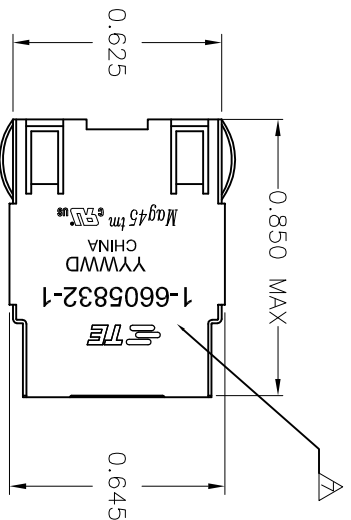

△ MATERIALS:

-HOUSING - THERMOPLASTIC PET POLYESTER FLAMMABILITY RATING UL 94V-0  
 -SHIELD - 0.010" THICK, (Z6800 BRASS PREPLATED WITH 30µINCH MIN SEMI-BRIGHT NICKEL, SOLDER TABS POST DIPPED WITH 100µINCH MIN SAC SOLDER  
 -MOD JACK CONTACTS - 0.0157" x 0.018" PHOSPHOR BRONZE, 50µINCH MIN OVERALL NICKEL UNDERPLATE, WITH SELECT 50µINCH MIN HARD GOLD FINISH PLATE.  
 -SOLDER TABS WITH 100µINCH MIN MATTE TIN AND/OR SAC SOLDER DIP.

△ RJ45 JACK CAVITY CONFORMS TO FCC RULES AND REGULATIONS PART 68, SUB PART F.

△ MAGNETICS

-IMPEDANCE: 100 OHMS  
 -TURNS RATIO (CHP: CABLE): TX = 1:1, RX = 1:1  
 -OPEN CIRCUIT INDUCTANCE (OCL): 350nH MIN @100kHz, 0.1VRMS,  
 8mADC BIAS FROM 0°C TO 70°C, TX AND RX  
 -POE CURRENT: 350mADC MAX  
 -PERFORMANCE @ 25°C:  
 INSERTION LOSS (IL): 1.1dB MAX FROM 0.5MHz TO 100MHz  
 RETURN LOSS (RL): 18dB MIN FROM 0.5MHz TO 30MHz  
 18-20LOG(F/30)DB MIN FROM 30.1MHz TO 60MHz  
 12dB MIN FROM 60.1MHz TO 80MHz

CROSSSTALK ATTENUATION: 35dB MIN FROM 0.5MHz TO 4.0MHz  
 33-20\*LOG(F/50)DB MIN FROM 4.01MHz TO 100MHz  
 COMMON MODE REFLECTION RATIO (CMRR): 30dB MIN FROM 0.5MHz TO 100MHz  
 -ISOLATION VOLTAGE:1500VAC (MAX) AT 60Hz FOR 60 SECS.

4. OPERATING TEMPERATURE: FROM 0° - +70°

△ LEDS WITH BUILT-IN RESISTOR

LEDS ARE DRIVEN WITH 5V VOLTAGE AND THE MAX OPERATING CURRENT IS 20mA.  
 LED COLOR : DOMINANT WAVELENGTH (λD): GREEN 568 nm TYP @ VF=5V  
 FORWARD CURRENT (IF): GREEN 12 mA TYP. @ VF=5V  
 DOMINANT WAVELENGTH (λD): YELLOW 588 nm TYP. @ VF=5V  
 FORWARD CURRENT (IF): YELLOW 13 mA TYP. @ VF=5V

△ INDICATED CONNECTIONS ARE FOR NIC CONFIGURATION. THE MAGNETICS ARE SYMMETRIC TO SUPPORT AUTO-MDI/MDIX.

△ THE CONNECTIVITY LOGO, THE CONNECTIVITY PART NUMBER, DATE CODE, COUNTRY OF ORIGIN AND AGENCY APPROVAL MARKING IN APPROXIMATE LOCATION SHOWN.

8. THE PART IS RECOMMENDED FOR WAVE SOLDERING PROCESS. PEAK WAVE SOLDERING TEMPERATURE IS 265°C MAX. 10 SECONDS MAX.

| DESCRIPTION | DATE | BY | APP'D |
|-------------|------|----|-------|
| GREEN LED1  |      |    |       |
| GREEN LED2  |      |    |       |
| 1-6605832-1 |      |    |       |

**STE** TE Connectivity

| DIMENSIONS: |             | OTHER REFERENCE: |         | MATERIAL  |         |
|-------------|-------------|------------------|---------|-----------|---------|
| INCHES      | MILLIMETERS | 0 RIG            | 1 RIG   | 2 RIG     | 3 RIG   |
| 0.660       | 16.76       | 0 RIG            | 1 RIG   | 2 RIG     | 3 RIG   |
| 0.575       | 14.61       | 1 RIG            | 2 RIG   | 3 RIG     | 4 RIG   |
| 0.105       | 2.67        | 2 RIG            | 3 RIG   | 4 RIG     | 5 RIG   |
| 0.010       | 0.25        | 3 RIG            | 4 RIG   | 5 RIG     | 6 RIG   |
|             |             | 4 RIG            | 5 RIG   | 6 RIG     | 7 RIG   |
|             |             | 5 RIG            | 6 RIG   | 7 RIG     | 8 RIG   |
|             |             | 6 RIG            | 7 RIG   | 8 RIG     | 9 RIG   |
|             |             | 7 RIG            | 8 RIG   | 9 RIG     | 10 RIG  |
|             |             | 8 RIG            | 9 RIG   | 10 RIG    | 11 RIG  |
|             |             | 9 RIG            | 10 RIG  | 11 RIG    | 12 RIG  |
|             |             | 10 RIG           | 11 RIG  | 12 RIG    | 13 RIG  |
|             |             | 11 RIG           | 12 RIG  | 13 RIG    | 14 RIG  |
|             |             | 12 RIG           | 13 RIG  | 14 RIG    | 15 RIG  |
|             |             | 13 RIG           | 14 RIG  | 15 RIG    | 16 RIG  |
|             |             | 14 RIG           | 15 RIG  | 16 RIG    | 17 RIG  |
|             |             | 15 RIG           | 16 RIG  | 17 RIG    | 18 RIG  |
|             |             | 16 RIG           | 17 RIG  | 18 RIG    | 19 RIG  |
|             |             | 17 RIG           | 18 RIG  | 19 RIG    | 20 RIG  |
|             |             | 18 RIG           | 19 RIG  | 20 RIG    | 21 RIG  |
|             |             | 19 RIG           | 20 RIG  | 21 RIG    | 22 RIG  |
|             |             | 20 RIG           | 21 RIG  | 22 RIG    | 23 RIG  |
|             |             | 21 RIG           | 22 RIG  | 23 RIG    | 24 RIG  |
|             |             | 22 RIG           | 23 RIG  | 24 RIG    | 25 RIG  |
|             |             | 23 RIG           | 24 RIG  | 25 RIG    | 26 RIG  |
|             |             | 24 RIG           | 25 RIG  | 26 RIG    | 27 RIG  |
|             |             | 25 RIG           | 26 RIG  | 27 RIG    | 28 RIG  |
|             |             | 26 RIG           | 27 RIG  | 28 RIG    | 29 RIG  |
|             |             | 27 RIG           | 28 RIG  | 29 RIG    | 30 RIG  |
|             |             | 28 RIG           | 29 RIG  | 30 RIG    | 31 RIG  |
|             |             | 29 RIG           | 30 RIG  | 31 RIG    | 32 RIG  |
|             |             | 30 RIG           | 31 RIG  | 32 RIG    | 33 RIG  |
|             |             | 31 RIG           | 32 RIG  | 33 RIG    | 34 RIG  |
|             |             | 32 RIG           | 33 RIG  | 34 RIG    | 35 RIG  |
|             |             | 33 RIG           | 34 RIG  | 35 RIG    | 36 RIG  |
|             |             | 34 RIG           | 35 RIG  | 36 RIG    | 37 RIG  |
|             |             | 35 RIG           | 36 RIG  | 37 RIG    | 38 RIG  |
|             |             | 36 RIG           | 37 RIG  | 38 RIG    | 39 RIG  |
|             |             | 37 RIG           | 38 RIG  | 39 RIG    | 40 RIG  |
|             |             | 38 RIG           | 39 RIG  | 40 RIG    | 41 RIG  |
|             |             | 39 RIG           | 40 RIG  | 41 RIG    | 42 RIG  |
|             |             | 40 RIG           | 41 RIG  | 42 RIG    | 43 RIG  |
|             |             | 41 RIG           | 42 RIG  | 43 RIG    | 44 RIG  |
|             |             | 42 RIG           | 43 RIG  | 44 RIG    | 45 RIG  |
|             |             | 43 RIG           | 44 RIG  | 45 RIG    | 46 RIG  |
|             |             | 44 RIG           | 45 RIG  | 46 RIG    | 47 RIG  |
|             |             | 45 RIG           | 46 RIG  | 47 RIG    | 48 RIG  |
|             |             | 46 RIG           | 47 RIG  | 48 RIG    | 49 RIG  |
|             |             | 47 RIG           | 48 RIG  | 49 RIG    | 50 RIG  |
|             |             | 48 RIG           | 49 RIG  | 50 RIG    | 51 RIG  |
|             |             | 49 RIG           | 50 RIG  | 51 RIG    | 52 RIG  |
|             |             | 50 RIG           | 51 RIG  | 52 RIG    | 53 RIG  |
|             |             | 51 RIG           | 52 RIG  | 53 RIG    | 54 RIG  |
|             |             | 52 RIG           | 53 RIG  | 54 RIG    | 55 RIG  |
|             |             | 53 RIG           | 54 RIG  | 55 RIG    | 56 RIG  |
|             |             | 54 RIG           | 55 RIG  | 56 RIG    | 57 RIG  |
|             |             | 55 RIG           | 56 RIG  | 57 RIG    | 58 RIG  |
|             |             | 56 RIG           | 57 RIG  | 58 RIG    | 59 RIG  |
|             |             | 57 RIG           | 58 RIG  | 59 RIG    | 60 RIG  |
|             |             | 58 RIG           | 59 RIG  | 60 RIG    | 61 RIG  |
|             |             | 59 RIG           | 60 RIG  | 61 RIG    | 62 RIG  |
|             |             | 60 RIG           | 61 RIG  | 62 RIG    | 63 RIG  |
|             |             | 61 RIG           | 62 RIG  | 63 RIG    | 64 RIG  |
|             |             | 62 RIG           | 63 RIG  | 64 RIG    | 65 RIG  |
|             |             | 63 RIG           | 64 RIG  | 65 RIG    | 66 RIG  |
|             |             | 64 RIG           | 65 RIG  | 66 RIG    | 67 RIG  |
|             |             | 65 RIG           | 66 RIG  | 67 RIG    | 68 RIG  |
|             |             | 66 RIG           | 67 RIG  | 68 RIG    | 69 RIG  |
|             |             | 67 RIG           | 68 RIG  | 69 RIG    | 70 RIG  |
|             |             | 68 RIG           | 69 RIG  | 70 RIG    | 71 RIG  |
|             |             | 69 RIG           | 70 RIG  | 71 RIG    | 72 RIG  |
|             |             | 70 RIG           | 71 RIG  | 72 RIG    | 73 RIG  |
|             |             | 71 RIG           | 72 RIG  | 73 RIG    | 74 RIG  |
|             |             | 72 RIG           | 73 RIG  | 74 RIG    | 75 RIG  |
|             |             | 73 RIG           | 74 RIG  | 75 RIG    | 76 RIG  |
|             |             | 74 RIG           | 75 RIG  | 76 RIG    | 77 RIG  |
|             |             | 75 RIG           | 76 RIG  | 77 RIG    | 78 RIG  |
|             |             | 76 RIG           | 77 RIG  | 78 RIG    | 79 RIG  |
|             |             | 77 RIG           | 78 RIG  | 79 RIG    | 80 RIG  |
|             |             | 78 RIG           | 79 RIG  | 80 RIG    | 81 RIG  |
|             |             | 79 RIG           | 80 RIG  | 81 RIG    | 82 RIG  |
|             |             | 80 RIG           | 81 RIG  | 82 RIG    | 83 RIG  |
|             |             | 81 RIG           | 82 RIG  | 83 RIG    | 84 RIG  |
|             |             | 82 RIG           | 83 RIG  | 84 RIG    | 85 RIG  |
|             |             | 83 RIG           | 84 RIG  | 85 RIG    | 86 RIG  |
|             |             | 84 RIG           | 85 RIG  | 86 RIG    | 87 RIG  |
|             |             | 85 RIG           | 86 RIG  | 87 RIG    | 88 RIG  |
|             |             | 86 RIG           | 87 RIG  | 88 RIG    | 89 RIG  |
|             |             | 87 RIG           | 88 RIG  | 89 RIG    | 90 RIG  |
|             |             | 88 RIG           | 89 RIG  | 90 RIG    | 91 RIG  |
|             |             | 89 RIG           | 90 RIG  | 91 RIG    | 92 RIG  |
|             |             | 90 RIG           | 91 RIG  | 92 RIG    | 93 RIG  |
|             |             | 91 RIG           | 92 RIG  | 93 RIG    | 94 RIG  |
|             |             | 92 RIG           | 93 RIG  | 94 RIG    | 95 RIG  |
|             |             | 93 RIG           | 94 RIG  | 95 RIG    | 96 RIG  |
|             |             | 94 RIG           | 95 RIG  | 96 RIG    | 97 RIG  |
|             |             | 95 RIG           | 96 RIG  | 97 RIG    | 98 RIG  |
|             |             | 96 RIG           | 97 RIG  | 98 RIG    | 99 RIG  |
|             |             | 97 RIG           | 98 RIG  | 99 RIG    | 100 RIG |
|             |             | 98 RIG           | 99 RIG  | 100 RIG   | 101 RIG |
|             |             | 99 RIG           | 100 RIG | 101 RIG   | 102 RIG |
|             |             | 100 RIG          | 101 RIG | 102 RIG   | 103 RIG |
|             |             | 101 RIG          | 102 RIG | 103 RIG   | 104 RIG |
|             |             | 102 RIG          | 103 RIG | 104 RIG   | 105 RIG |
|             |             | 103 RIG          | 104 RIG | 105 RIG   | 106 RIG |
|             |             | 104 RIG          | 105 RIG | 106 RIG   | 107 RIG |
|             |             | 105 RIG          | 106 RIG | 107 RIG   | 108 RIG |
|             |             | 106 RIG          | 107 RIG | 108 RIG   | 109 RIG |
|             |             | 107 RIG          | 108 RIG | 109 RIG   | 110 RIG |
|             |             | 108 RIG          | 109 RIG | 110 RIG   | 111 RIG |
|             |             | 109 RIG          | 110 RIG | 111 RIG   | 112 RIG |
|             |             | 110 RIG          | 111 RIG | 112 RIG   | 113 RIG |
|             |             | 111 RIG          | 112 RIG | 113 RIG   | 114 RIG |
|             |             | 112 RIG          | 113 RIG | 114 RIG   | 115 RIG |
|             |             | 113 RIG          | 114 RIG | 115 RIG   | 116 RIG |
|             |             | 114 RIG          | 115 RIG | 116 RIG   | 117 RIG |
|             |             | 115 RIG          | 116 RIG | 117 RIG   | 118 RIG |
|             |             | 116 RIG          | 117 RIG | 118 RIG   | 119 RIG |
|             |             | 117 RIG          | 118 RIG | 119 RIG   | 120 RIG |
|             |             | 118 RIG          | 119 RIG | 120 RIG   | 121 RIG |
|             |             | 119 RIG          | 120 RIG | 121 RIG   | 122 RIG |
|             |             | 120 RIG          | 121 RIG | 122 RIG   | 123 RIG |
|             |             | 121 RIG          | 122 RIG | 123 RIG   | 124 RIG |
|             |             | 122 RIG          | 123 RIG | 124 RIG   | 125 RIG |
|             |             | 123 RIG          | 124 RIG | 125 RIG   | 126 RIG |
|             |             | 124 RIG          | 125 RIG | 126 RIG   | 127 RIG |
|             |             | 125 RIG          | 126 RIG | 127 RIG   | 128 RIG |
|             |             | 126 RIG          | 127 RIG | 128 RIG   | 129 RIG |
|             |             | 127 RIG          | 128 RIG | 129 RIG   | 130 RIG |
|             |             | 128 RIG          | 129 RIG | 130 RIG   | 131 RIG |
|             |             | 129 RIG          | 130 RIG | 131 RIG   | 132 RIG |
|             |             | 130 RIG          | 131 RIG | 132 RIG   | 133 RIG |
|             |             | 131 RIG          | 132 RIG | 133 RIG   | 134 RIG |
|             |             | 132 RIG          | 133 RIG | 134 RIG   | 135 RIG |
|             |             | 133 RIG          | 134 RIG | 135 RIG   | 136 RIG |
|             |             | 134 RIG          | 135 RIG | 136 RIG   | 137 RIG |
|             |             | 135 RIG          | 136 RIG | 137 RIG   | 138 RIG |
|             |             | 136 RIG          | 137 RIG | 138 RIG   | 139 RIG |
|             |             | 137 RIG          | 138 RIG | 139 RIG   | 140 RIG |
|             |             | 138 RIG          | 139 RIG | 140 RIG   | 141 RIG |
|             |             | 139 RIG          | 140 RIG | 141 RIG   | 142 RIG |
|             |             | 140 RIG          | 141 RIG | 142 RIG   | 143 RIG |
|             |             | 141 RIG          | 142 RIG | 143 RIG   | 144 RIG |
|             |             | 142 RIG          | 143 RIG | 144 RIG   | 145 RIG |
|             |             | 143 RIG          | 144 RIG | 145 RIG   | 146 RIG |
|             |             | 144 RIG          | 145 RIG | 146 RIG   | 147 RIG |
|             |             | 145 RIG          | 146 RIG | 147 RIG   | 148 RIG |
|             |             | 146 RIG          | 147 RIG | 148 RIG   | 149 RIG |
|             |             | 147 RIG          | 148 RIG | 149 RIG   | 150 RIG |
|             |             | 148 RIG          | 149 RIG | 150 RIG   | 151 RIG |
|             |             | 149 RIG          | 150 RIG | 151 RIG   | 152 RIG |
|             |             | 150 RIG          | 151 RIG | 152 RIG   | 153 RIG |
|             |             | 151 RIG          | 152 RIG | 153 RIG   | 154 RIG |
|             |             | 152 RIG          | 153 RIG | 154 RIG   | 155 RIG |
|             |             | 153 RIG          | 154 RIG | 155 RIG   | 156 RIG |
|             |             | 154 RIG          | 155 RIG | 156 RIG   | 157 RIG |
|             |             | 155 RIG          | 156 RIG | 157 RIG   | 158 RIG |
|             |             | 156 RIG          | 157 RIG | 158 RIG   | 159 RIG |
|             |             | 157 RIG          | 158 RIG | 159 RIG   | 160 RIG |
|             |             | 158 RIG          | 159 RIG | 160 RIG   | 161 RIG |
|             |             | 159 RIG          | 160 RIG | 161 RIG   | 162 RIG |
|             |             | 160 RIG          | 161 RIG | 162 RIG   | 163 RIG |
|             |             | 161 RIG          | 162 RIG | 163 RIG   | 164 RIG |
|             |             | 162 RIG          | 163 RIG | 164 RIG   | 165 RIG |
|             |             | 163 RIG          | 164 RIG | 165 RIG   | 166 RIG |
|             |             | 164 RIG          | 165 RIG | 166 RIG   | 167 RIG |
|             |             | 165 RIG          | 166 RIG | 167 RIG   | 168 RIG |
|             |             | 166 RIG          | 167 RIG | 168 RIG   | 169 RIG |
|             |             | 167 RIG          | 168 RIG | 169 RIG   | 170 RIG |
|             |             | 168 RIG          | 169 RIG | 170 RIG   | 171 RIG |
|             |             | 169 RIG          | 170 RIG | 171 RIG   | 172 RIG |
|             |             | 170 RIG          | 171 RIG | 172 RIG   | 173 RIG |
|             |             | 171 RIG          | 172 RIG | 173 RIG   | 174 RIG |
|             |             | 172 RIG          | 173 RIG | 174 RIG</ |         |

| REV ISONS |      | DATE        | REV  | APPD |
|-----------|------|-------------|------|------|
| P         | LINE | DESCRIPTION | DATE | REV  |
| -         | 1    | SEE SHEET 1 | -    | -    |

3

2

1

ACUIT

⑧ T3CT  
⑨ UP7/8  
⑩ UP4/5

TXN RJ-2  
TXP RJ-1

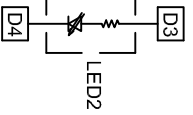

SHIELD

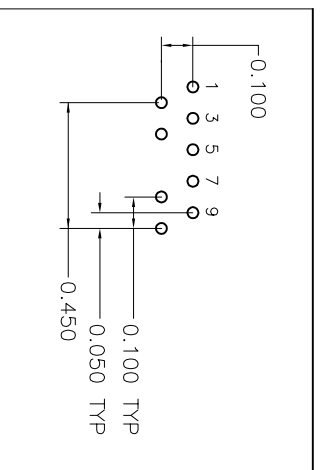
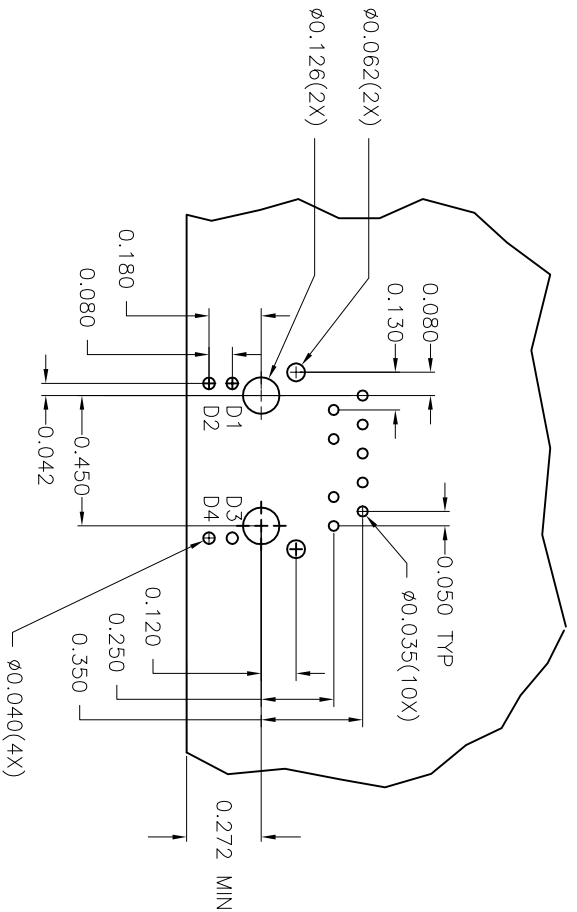

Suggested Footprint

|  |  |     |                  |      |            |
|--|--|-----|------------------|------|------------|
| THIS DRAWING IS A CONTROLLED DOCUMENT. |  | REV | VARIELA - DOKKIS | DATE | 04/23/2018 |
| DIMENSIONS:                            |  | REV | D. FAROLE        | DATE | 04/23/2018 |
| INCHES                                 |  | REV | DAVIDE           | DATE | 04/23/2018 |
| MILLIMETERS                            |  | REV | DAVIDE           | DATE | 04/23/2018 |
| TOLERANCES UNLESS OTHERWISE SPECIFIED: |  | REV | DAVIDE           | DATE | 04/23/2018 |
| FRACTIONS                              |  | REV | DAVIDE           | DATE | 04/23/2018 |
| DECIMALS                               |  | REV | DAVIDE           | DATE | 04/23/2018 |
| ANGLES                                 |  | REV | DAVIDE           | DATE | 04/23/2018 |
| HATCH                                  |  | REV | DAVIDE           | DATE | 04/23/2018 |
| MATERIAL                               |  | REV | DAVIDE           | DATE | 04/23/2018 |
| CUSTOMER DRAWING                       |  | REV | DAVIDE           | DATE | 04/23/2018 |
| SIZE                                   |  | REV | DAVIDE           | DATE | 04/23/2018 |
| SCALE                                  |  | REV | DAVIDE           | DATE | 04/23/2018 |
| SHEET                                  |  | REV | DAVIDE           | DATE | 04/23/2018 |
| RESTRICTED TO                          |  | REV | DAVIDE           | DATE | 04/23/2018 |

**STE** TE Connectivity

1x1, MAC45(TM), 10/100, 7V15 CIRCUIT, TAB UP, W RESISTOR LED, NO CAPACITOR

A2 00779 6605832

SCALE NTS SHEET 2 OF 2 REV C

## Looking for pricing, stock, or lifecycle information?

Click below to explore more details on WIN SOURCE:

 [View 1-6605832-1 on WIN SOURCE](#)

 [TE Connectivity](#) Information

## Optimize Your Supply Chain with WIN SOURCE Solutions

-  Global Sourcing Solution
-  Obsolete Management
-  Cost Control Management
-  Shortage Management
-  Alternative Solution
-  Excess Inventory Management