



THE DATASHEET OF
994-009-030R121



MATERIAL:
 BACKSHELL: NICKEL PLATED DIE-CAST ZINC ALLOY
 HARDWARE: NICKEL PLATED STEEL
 OPERATION TEMPERATURE: -40°C to 120°C

BACKSHELL KIT INCLUDES:
 (2x) BACKSHELL HALVES
 (2x) HOUSING SCREWS
 (2x) HOUSING NUTS
 (2x) STRAIN RELIEF CLAMPS
 (2x) STRAIN RELIEF SCREWS

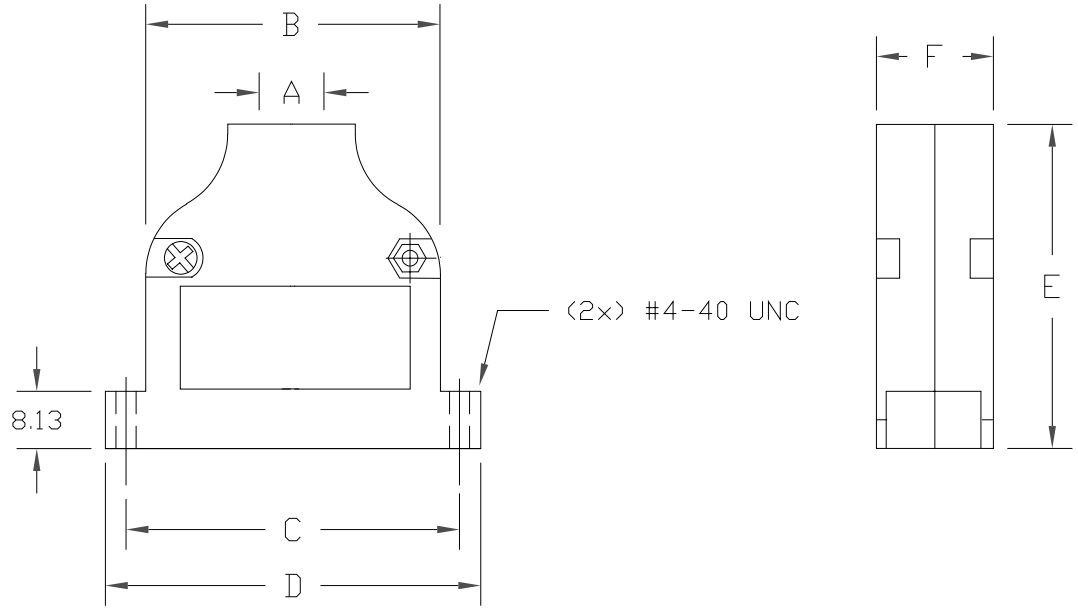

DIMENSIONS(mm) [All tolerances ±0.5mm]

SIZE	A	B	C	D	E	F
9	11.00	20.07	24.99	31.80	46.00	16.00
15	11.00	28.83	33.32	40.00	46.00	16.90
25	11.00	41.66	47.04	53.50	46.00	16.10

994-YYY-030R121

SERIES _____
 POSITIONS _____

009
 015
 025

RoHS COMPLIANT



THESE DRAWINGS AND SPECIFICATIONS ARE THE PROPERTY OF NorComp AND SHALL NOT BE REPRODUCED, COPIED OR USED AS THE BASIS FOR THE MANUFACTURE OR SALE OF APPARATUS WITHOUT WRITTEN PERMISSION.

DRAWN: P. JENKINS
 DATE: 09/15/2005

UNITS = mm

DO NOT SCALE FROM DRAWING

NorComp

SCALE: NTS SHEET 1 OF 1 REV 6
 DWG NO. 994-0YY-030R121

Looking for pricing, stock, or lifecycle information?

Click below to explore more details on WIN SOURCE:

 [View 994-009-030R121 on WIN SOURCE](#)

 [NorComp Inc. Information](#)

Optimize Your Supply Chain with WIN SOURCE Solutions

-  Global Sourcing Solution
-  Obsolete Management
-  Cost Control Management
-  Shortage Management
-  Alternative Solution
-  Excess Inventory Management