



THE DATASHEET OF
971-015-020R121



KSHELL

971-YYY-020R121

SERIES _____
POSITIONS _____

009
015
025
037

MATERIAL _____
020 = METALIZED PLASTIC

COLOR: _____
12 = NICKEL OVER COPPER

PUT-UPS _____
1 = KIT

S , Ø0.354 [9.0]

CREW

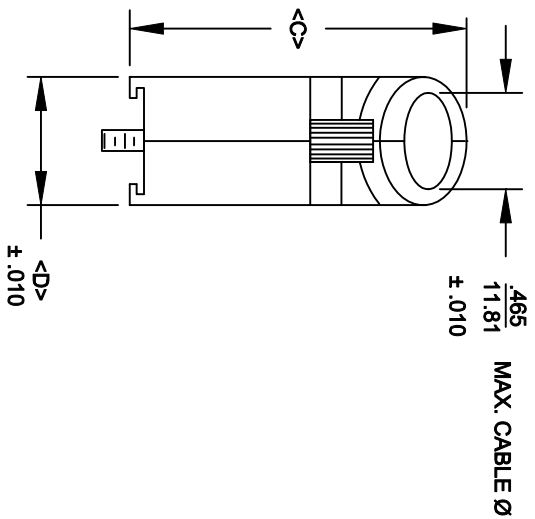

POS.	A B C D			
	9	1.220 30.99	.984 24.99	1.496 38.00
15	1.595 40.51	1.312 33.32	1.618 41.10	614 15.60
25	2.114 53.70	1.852 47.04	1.646 41.81	614 15.60
37	2.748 69.80	2.500 63.50	1.646 41.81	614 15.60

D - UL 94-HB



THESE DRAWINGS AND SPECIFICATIONS ARE THE PROPERTY OF NorComp AND SHALL NOT BE REPRODUCED, COPIED OR USED AS THE BASIS FOR THE MANUFACTURE OR SALE OF APPARATUS WITHOUT WRITTEN PERMISSION.

DRAWN: PAM JENKINS
DATE: 6-10-05

CHECKED: _____
DATE: _____

SCALE SHEET 1 OF 1 REV 8

NorComp

DWG NO. 971-YYY-020R121

Looking for pricing, stock, or lifecycle information?

Click below to explore more details on WIN SOURCE:

 [View 971-015-020R121 on WIN SOURCE](#)

 [NorComp Inc. Information](#)

Optimize Your Supply Chain with WIN SOURCE Solutions

-  Global Sourcing Solution
-  Obsolete Management
-  Cost Control Management
-  Shortage Management
-  Alternative Solution
-  Excess Inventory Management