



**THE DATASHEET OF
RJADK25S7080811**



N FEMALE D-SUB - PLASTIC & METALIZED PLASTIC

MATERIAL:

HOOD: ABS UL 94V-0HB

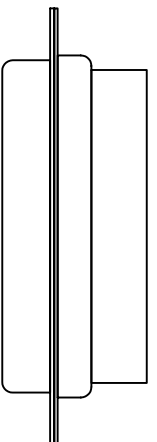
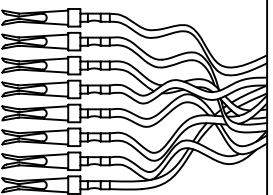
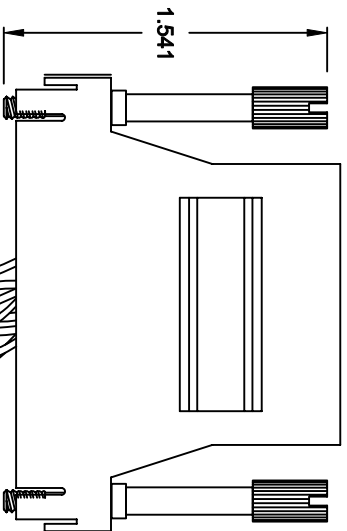
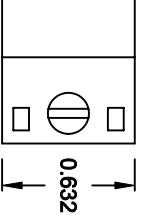

RJADK25S70808Y1

SERIES _____
 POSITIONS 25
 GENDER S = FEMALE
 D-SUB TERMINALS 7 = CRIMP & POKE (CONTACTS PRE-CRIMPED)
 MODULAR POSITIONS 08
 MODULAR POSITIONS LOADED _____
 COLOR 08
 1 = BLACK
 2 = METALIZED (SHIELD RATING: 60DB)
 3 = GRAY
 D-SUB CONTACT PLATING _____
 1 = GOLD FLASH

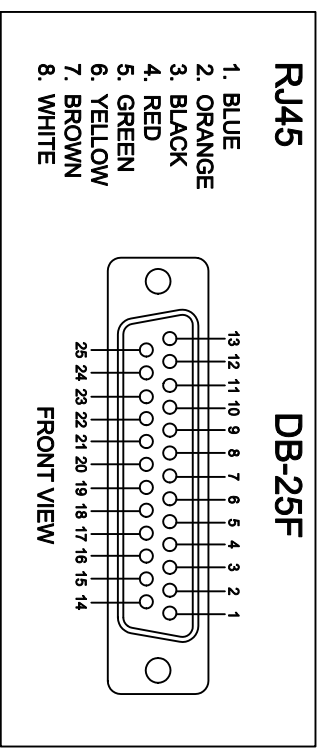

1. BLUE
2. ORANGE
3. BLACK
4. RED
5. GREEN
6. YELLOW
7. BROWN
8. WHITE

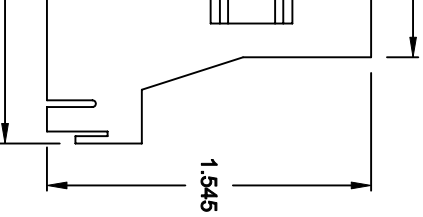
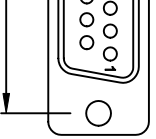

FROM DRAWING

N THESE DRAWINGS AND SPECIFICATIONS ARE THE PROPERTY OF NorComp AND SHALL NOT BE REPRODUCED, COPIED OR USED AS THE BASIS FOR THE MANUFACTURE OF SALE OF APPARATUS WITHOUT WRITTEN PERMISSION.

DRAWN: **C. SMITH** DATE: **05-14-07**

CHECKED: _____ DATE: _____

SCALE: **N.T.S.** SHEET **1** OF **1** REV **1**

NorComp

DWG NO. **RJADK25S70808Y1**

COMPLIANT

Looking for pricing, stock, or lifecycle information?

Click below to explore more details on WIN SOURCE:

 [View RJADK25S7080811 on WIN SOURCE](#)

 [NorComp Inc. Information](#)

Optimize Your Supply Chain with WIN SOURCE Solutions

-  Global Sourcing Solution
-  Obsolete Management
-  Cost Control Management
-  Shortage Management
-  Alternative Solution
-  Excess Inventory Management