

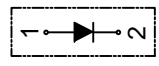

**THE DATASHEET OF
MPC8-2RD12V**

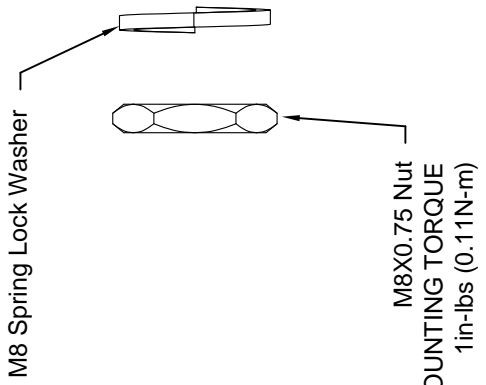

REV.	
A	Engineering Release
B	Engineering Update

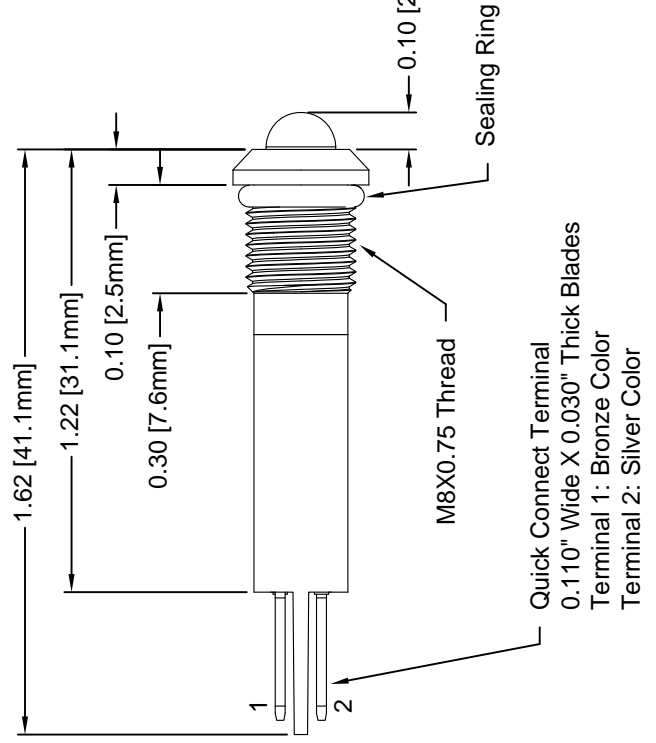

RECOMMENDED MOUNTING TORQUE
 1 in-lbs (0.11N-m)

RECOMMENDED MOUNTING TORQUE
 1 in-lbs (0.11N-m)

RECOMMENDED MOUNTING TORQUE
 1 in-lbs (0.11N-m)

RECOMMENDED MOUNTING TORQUE
 1 in-lbs (0.11N-m)

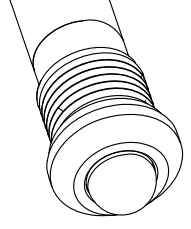
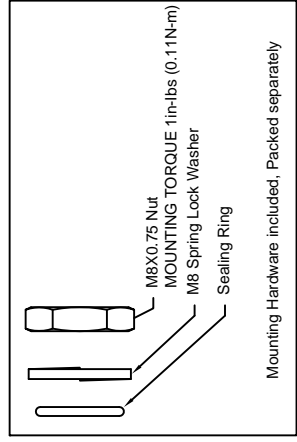
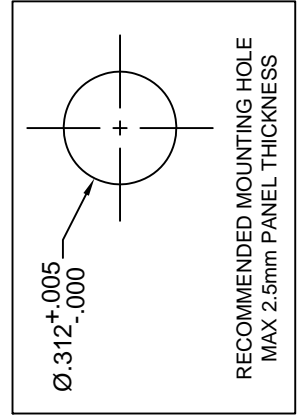

STANDARD TOLERANCES (UNLESS OTHERWISE SPECIFIED)	
DECIMALS	ANGLES
.X ±.1	X°
.XX ±.02	
.XXX ±.010	
DESIGNED:	DATE:
M. Doan	08/1/
CHECKED:	DATE:
B. Oliver	08/1/

- NOTES:**
1. SEALED TO IP54 RATING
 2. VOLTAGE INPUT OPTIONS: 12V/24V/110V/220V
 3. ROHS COMPLIANT
 4. MOUNTING HARDWARE PACKED SEPARATELY NON-ASSEMBLED
 5. INSERT SEALING RING ON PANEL MOUNT ASSEMBLY PRIOR TO PANEL INSTALLATION

Part Number	Dominant Wave Length λ d(nm)	Emitted Color	Lens Appearance	Voltage
MPC8-2RD12V	625	Red	Diffused	12V
MPC8-2GD12V	515	Green	Diffused	12V
MPC8-2YD12V	590	Yellow	Diffused	12V
MPC8-2BWD12V	470	Blue	Diffused	12V
MPC8-2WD12V	x=0.36, y=0.32	White	Diffused	12V
MPC8-2RD24V	625	Red	Diffused	24V
MPC8-2GD24V	515	Green	Diffused	24V
MPC8-2YD24V	590	Yellow	Diffused	24V
MPC8-2BWD24V	470	Blue	Diffused	24V
MPC8-2WD24V	x=0.36, y=0.32	White	Diffused	24V
MPC8-2RD110V	625	Red	Diffused	110V
MPC8-2GD110V	515	Green	Diffused	110V
MPC8-2YD110V	590	Yellow	Diffused	110V
MPC8-2BWD110V	470	Blue	Diffused	110V
MPC8-2WD110V	x=0.36, y=0.32	White	Diffused	110V
MPC8-2RD220V	625	Red	Diffused	220V
MPC8-2GD220V	515	Green	Diffused	220V
MPC8-2YD220V	590	Yellow	Diffused	220V
MPC8-2BWD220V	470	Blue	Diffused	220V
MPC8-2WD220V	x=0.36, y=0.32	White	Diffused	220V

ABSOLUTE MAXIMUM RATINGS (Ta = 25°C)

POWER INPUT _____ 0.5W MAX
 OPERATING TEMPERATURE RANGE _____ -40°C ~ 80°C
 STORAGE TEMPERATURE _____ -40°C ~ 80°C
 TERMINAL SOLDERING TEMPERATURE _____ 260°C, 5s

STANDARD TOLERANCES
 (UNLESS OTHERWISE SPECIFIED)
 DECIMALS ANGLES



DESIGNED BY:

M. Doan

DATE:

08/1

CHECKED BY:

B. Oliver

DATE:

08/1

Looking for pricing, stock, or lifecycle information?

Click below to explore more details on WIN SOURCE:

 [View MPC8-2RD12V on WIN SOURCE](#)

 [Bivar Inc. Information](#)

Optimize Your Supply Chain with WIN SOURCE Solutions

-  Global Sourcing Solution
-  Obsolete Management
-  Cost Control Management
-  Shortage Management
-  Alternative Solution
-  Excess Inventory Management