



**THE DATASHEET OF  
POM-3046P-R**



## SPECIFICATIONS

PARAMETERS	VALUES	UNIT
DIRECTIVITY	OMINI	-
SENSITIVITY	-46 ± 3	dB
STANDARD OPERATING VOLTAGE	2	Vdc
MAX OPERATING VOLTAGE	10	Vdc
CURRENT CONSUMPTION (MAX)	0.5	mA
IMPEDANCE	2.2	KOhm
SIGNAL TO NOISE RATIO (MIN.)	60	dB
TERMINAL	PIN	-
INTERNAL CAPACITOR	N/A	pF

THIS DOCUMENT CONTAINS DATA PROPRIETARY TO PROJECTS UNLIMITED, INC. ANY USE OR REPRODUCTION, IN ANY FORM, WITHOUT PRIOR WRITTEN PERMISSION OF PROJECTS UNLIMITED, INC. IS PROHIBITED.

©2003, Projects Unlimited Inc.

LTR	DESCRIPTION	REVISION HIST
-	RELEASED FROM ENGINEERING	
A	ADDED TERMINAL POLARITY	
B	REVISED TERMINAL POLARITY	
C	REVISED TO INVENTOR 3-D DRAWING TEMPLATE	

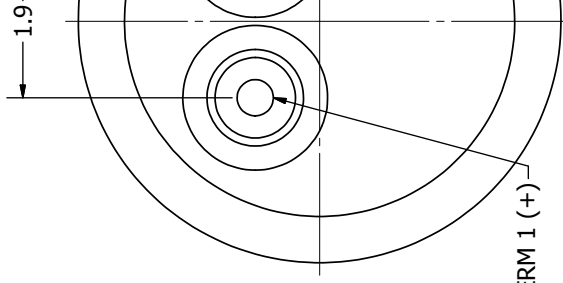
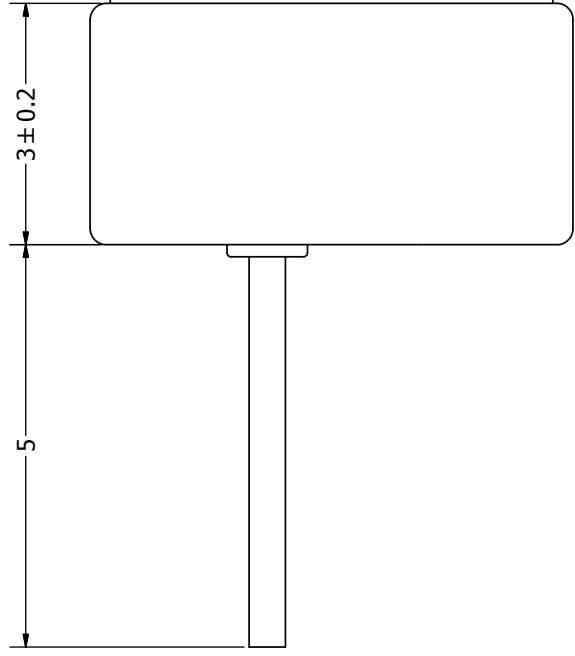
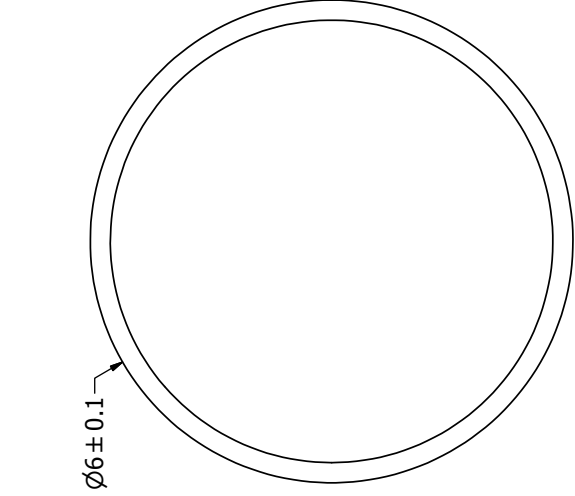

### NOTES:

1. ALL DIMENSIONS ARE IN MILLIMETERS.
2. SPECIFICATIONS SUBJECT TO CHANGE OR WITHDRAWAL WITHOUT NOTICE.
3. THIS PART IS RoHS 2002/95/EC COMPLIANT.

UNLESS OTHERWISE SPECIFIED:

DIMENSIONS ARE IN MILLIMETERS,

TOLERANCES ARE ±0.5 AND ANGLES ARE ±3°.

POM-3046P-R.idw

SIZE

A3

Designed by

J.A.F.

Date

1/30/2006

Checked by

E.P.

Date

1/30/06



**pui audio**  
inc

a projects unlimited company

Mic

## Looking for pricing, stock, or lifecycle information?

Click below to explore more details on WIN SOURCE:

 [View POM-3046P-R on WIN SOURCE](#)

 [PUI Audio, Inc. Information](#)

## Optimize Your Supply Chain with WIN SOURCE Solutions

-  Global Sourcing Solution
-  Obsolete Management
-  Cost Control Management
-  Shortage Management
-  Alternative Solution
-  Excess Inventory Management