

Features

Regulated Converter

- 85 to 305Vac input / OVC III
- Full load output power up to 75°C
- 15.4mm low profile
- -40°C to 85°C operating temperature
- <75mW no load power use
- EN55032 class “B” with floating output



RAC03E-K/277

3 Watt
1.45” x 0.95”
Single Output



Description

The cost-efficient RAC03E-K/277 AC/DC converter series has an input range of nominal 100VAC to an enhanced 277V, certified to OVC III overvoltage category; delivering an uncompromising 3 watts of output power with tightly regulated outputs from 3.3V to 24VDC. These low profile, encapsulated print-mountable modules in an industry-standard pinout deliver full output power from -40°C to +75°C and are certified for operation up to +85°C air ambient with output power reduced to 1.8W. This series of AC/DC modules holds international safety certifications for industrial, domestic, ITE, and household use. With 4kVAC input to output isolation, they are suitable for worldwide applications in automation control, industry 4.0, IoT and household automation. Due to their LPS (Limited Power Source) and reinforced class II installation rating for floating outputs and their significantly wide margin to class B EMC compliance without external components, these are the easiest to use, versatile power modules in the industry.

Selection Guide

Part Number	Input Voltage Range [VAC]	Output Voltage [VDC]	Output Current [mA]	Efficiency typ. ⁽¹⁾ [%]
RAC03E-3.3SK/277	85-305	3.3	900	68
RAC03E-05SK/277	85-305	5	600	73
RAC03E-12SK/277	85-305	12	250	75
RAC03E-15SK/277	85-305	15	200	77
RAC03E-24SK/277	85-305	24	125	79

Notes:

Note1: Efficiency is tested at nominal input and full load at +25°C ambient

Model Numbering



Specifications (measured @ Ta= 25°C, nom. Vin, full load and after warm-up unless otherwise stated)

BASIC CHARACTERISTICS					
Parameter	Condition		Min.	Typ.	Max.
Nominal Input Voltage	50/60Hz		100VAC		277VAC
Input Voltage Range ^(2,3)	47-63Hz DC		85VAC 120VDC	277VAC	305VAC 430VDC
Input Current	115VAC 230VAC 277VAC				70mA 50mA 40mA
Inrush Current	cold start at 25°C	115VAC 230VAC 277VAC			10A 20A 25A
No load Power Consumption					75mW
ErP Standby Mode Conformity (Maximum output power available for stated maximum input power)	Module Input Power=		0.5W 1.0W		0.32W 0.68W
Notes:					
Note2: The products were submitted for safety files at AC-Input operation (90-305VAC)					
Note3: Refer to “Derating Graph ⁽⁷⁾ ”					
continued on next page					

YOU MAY ALSO LIKE
 Please consider this alternatives:

RAC03-K

- UL/IEC/EN62368-1 certified
- CAN/CSA C22.2 No. 62368-1 certified
- EN60335-1 certified
- EN62233 certified
- IEC/EN61558-1/2-16 certified
- EN55032/EN55035 compliant
- EN55014-1/-2 compliant
- EN61204-3 compliant
- FCC Part 15 compliant
- CB Report

Specifications (measured @ Ta= 25°C, nom. Vin, full load and after warm-up unless otherwise stated)

BASIC CHARACTERISTICS

Parameter	Condition		Min.	Typ.	Max.
Input Frequency Range	AC Input		47Hz		63Hz
Minimum Load			0%		
Power Factor	115VAC		0.55		
	230VAC		0.45		
	277VAC		0.40		
Start-up Time				15ms	
Rise Time				10ms	
Hold-up Time	115VAC			15ms	
	230VAC			80ms	
	277VAC			120ms	
Internal Operating Frequency	100% load at nominal Vin				132kHz
Output Ripple and Noise ⁽⁴⁾	20MHz BW	3.3, 5Vout others			120mVp-p 1% of Vout

Notes:

Note4: Measurements are made with a 0.1µF MLCC & 10µF E-cap in parallel across output. (low ESR)

Efficiency vs. Load

RAC03E-3.3SK/277

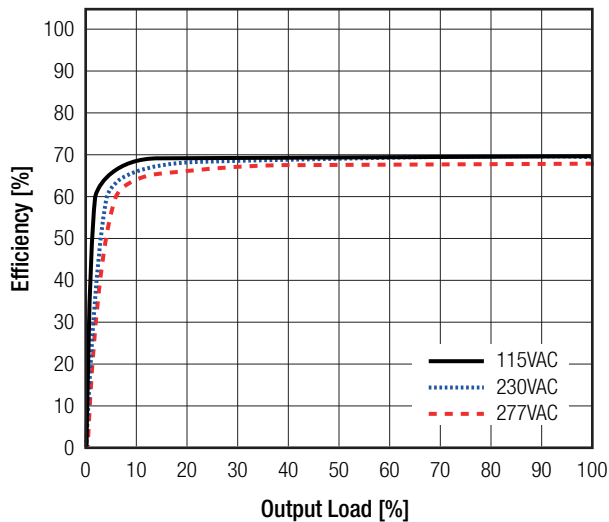

RAC03E-05SK/277

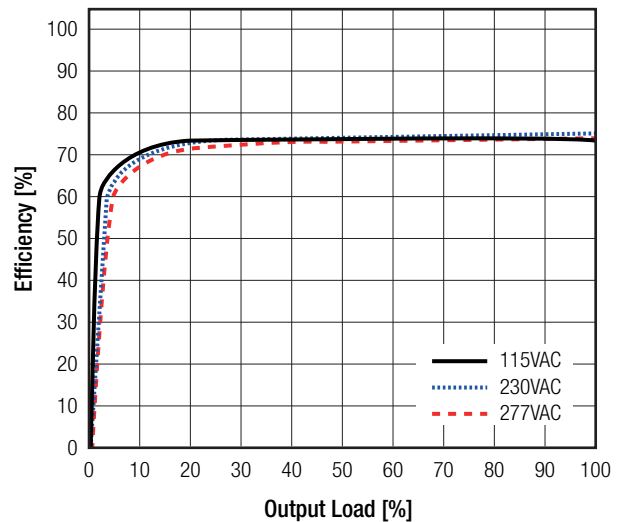

RAC03E-12SK/277 / RAC03E-24SK/277

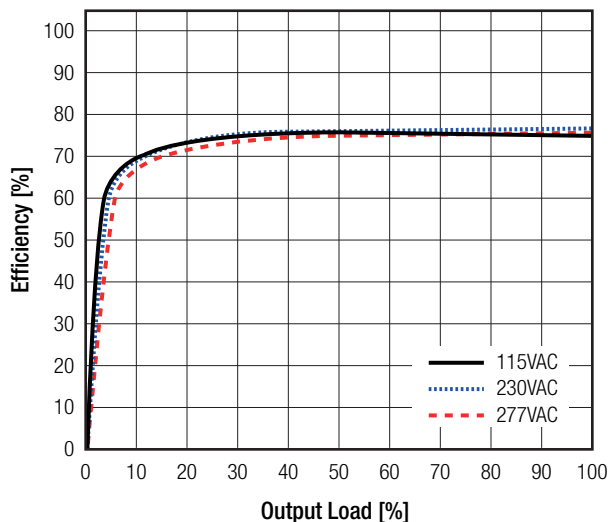

RAC03E-15SK/277

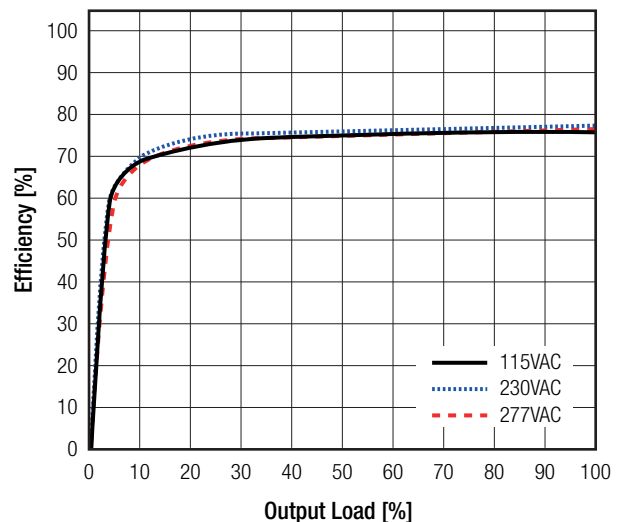

continued on next page

Specifications (measured @ Ta= 25°C, nom. Vin, full load and after warm-up unless otherwise stated)

REGULATIONS

Parameter	Condition	Value
Output Accuracy		±1.0% max.
Line Regulation	low line to high line, full load	±0.5% typ.
Load Regulation ⁽⁵⁾	10% to 100% load	0.5% typ.
Transient Response	10% load step change recovery time	6.0% max. 350µs typ.

Notes:

Note5: Operation below 10% load will not harm the converter, but specifications may not be met

Deviation vs. Load

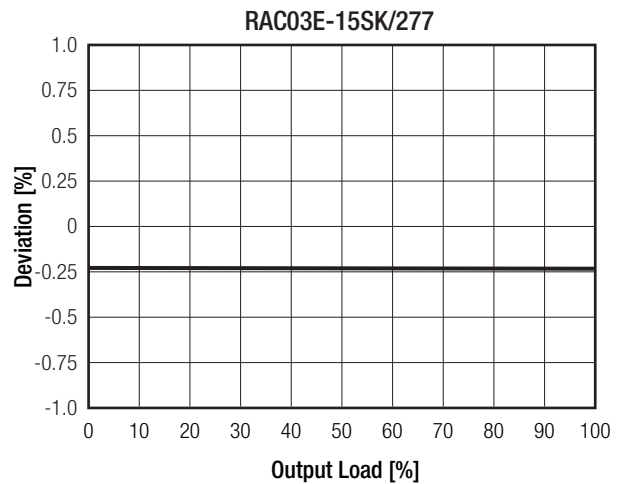
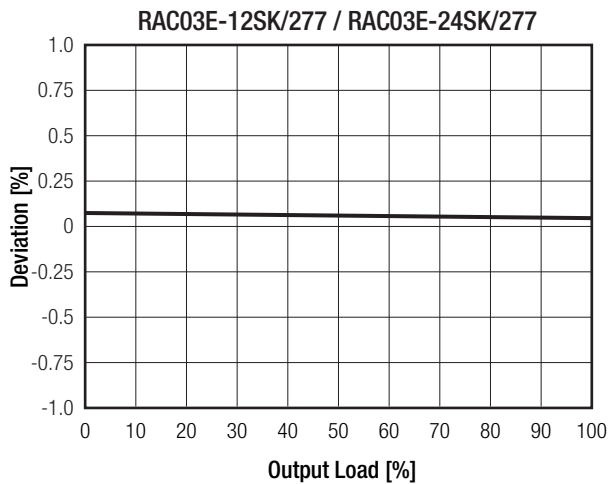
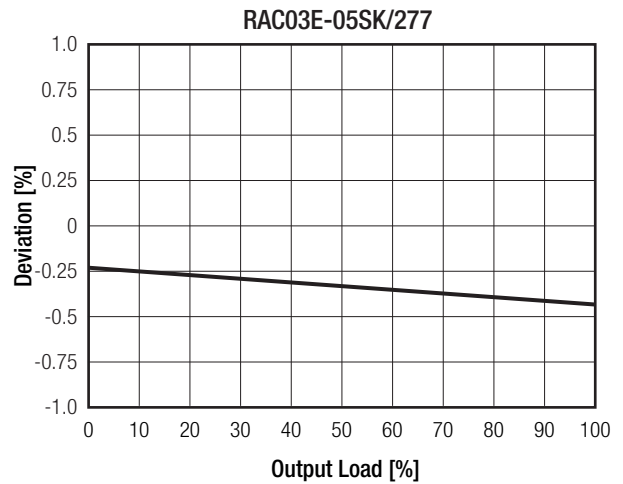
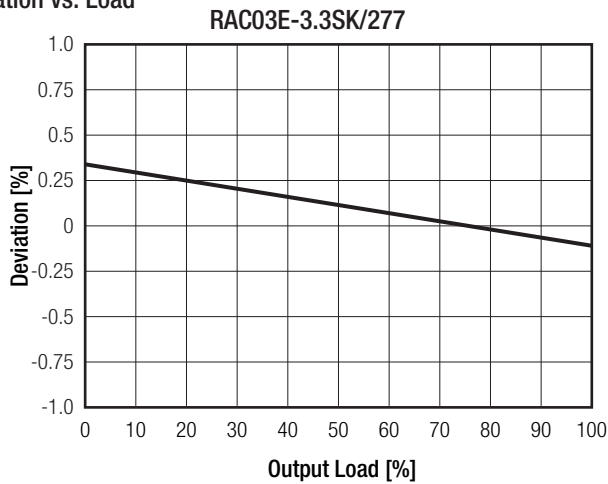

PROTECTIONS

Parameter	Type/Condition	Value
Input Fuse	internal	fusible resistor
Short Circuit Protection (SCP)		Hiccup mode, auto recovery
Over Voltage Protection (OVP)		120% - 260%, hiccup mode
Over Current Protection (OCP)		120% - 300%, hiccup mode
Over Voltage Category (OVC)		OVCII OVCIII
Isolation Voltage ⁽⁶⁾	I/P to O/P	1 minute 4kVAC

Notes:

Note6: For repeat Hi-Pot testing, reduce the time and/or the test voltage

continued on next page

Specifications (measured @ Ta= 25°C, nom. Vin, full load and after warm-up unless otherwise stated)

PROTECTIONS

Parameter	Condition	Value
Isolation Resistance	I/P to O/P, Isolation Voltage 500VDC	1GΩ min.
Isolation Capacitance	I/P to O/P, 100KHz/0.1V	100pF max.
Leakage Current	@ 277VAC	0.25mA max.
Insulation Grade		reinforced

ENVIRONMENTAL

Parameter	Condition		Value
Operating Temperature Range	@ natural convection 0.1m/s	refer to "Derating Graph (7)"	-40°C to +85°C
Maximum Case Temperature			+95°C
Temperature Coefficient			±0.03%/K
Operating Altitude			2000m
Operating Humidity	non-condensing		20% - 90% RH max.
Pollution Degree			PD2
Vibration			10-500Hz, 2G10min./1cycle, period 60min. each along x,y,z axes
MTBF	according to MIL-HDBK-217F, G.B.	+25°C +40°C	2260 x 10 ³ hours 2040 x 10 ³ hours
Design Lifetime	230VAC/60Hz and full load +50°C		>30 x 10 ³ hours

Derating Graph (7)

(@ Chamber and natural convection 0.1 m/s)

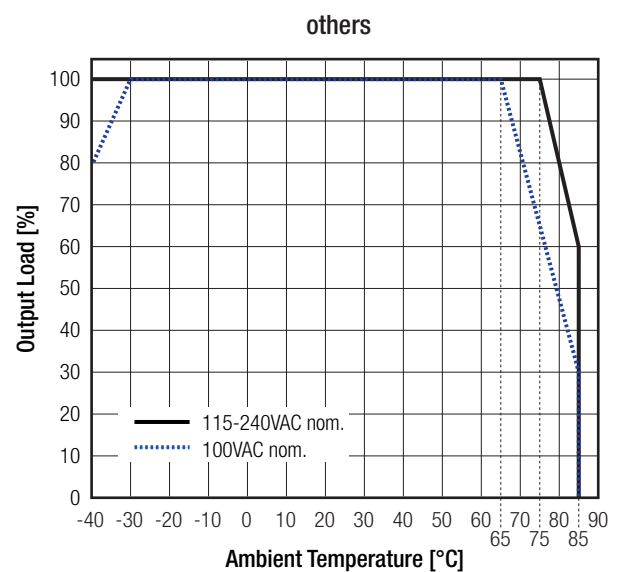
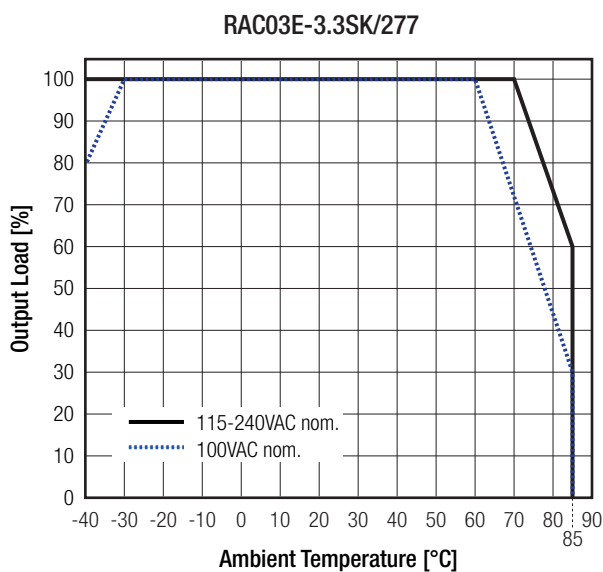

Notes:

Note7: Output power derating for Line-input of less than 90VAC (de-rate linearly from 100% at 90VAC to 85% at 85VAC)

Specifications (measured @ Ta= 25°C, nom. Vin, full load and after warm-up unless otherwise stated)

SAFETY AND CERTIFICATION		
Certificate Type (Safety)	Report Number	Standard
Audio/Video, information and communication technology equipment - Part 1: Safety requirements	E491408-A6014-UL	UL62368-1:2019 3rd Edition CAN/CSA-C22.2 No. 62368-1:2019
Audio/Video, information and communication technology equipment - Part1: Safety requirements (CB Scheme)	200703001-1	IEC62368-1:2018 3rd Edition
Audio/Video, information and communication technology equipment - Part1: Safety requirements (LVD)		EN IEC 62368-1:2020+A11:2020
Audio/Video, information and communication technology equipment - Part1: Safety requirements (LVD)	200703001-3	EN62368-1:2014+A11:2017
Household and similar electrical appliances – Safety – Part 1: General requirements (LVD)		EN60335-1:2012+A2:2019
Measurement methods for electromagnetic fields of household appliances and similar apparatus with regard to human exposure	60413198001	EN62233:2008
Safety of power transformers, power supplies, reactors and similar products for supply voltages up to 1100 V (CB Scheme)	60394453 001	IEC61558-1:2005 2nd Edition + A1:2009
Safety of power transformers, power supplies, reactors and similar products for supply voltages up to 1100 V	60394454 001	EN61558-1:2005 + A1:2009
Safety of power transformers, power supplies, reactors and similar products for supply voltages up to 1100 V Part 2: Particular requirements (CB Scheme)	60394453 001	IEC61558-2-16:2009 1st Edition + A1:2013
Safety of power transformers, power supplies, reactors and similar products for supply voltages up to 1100 V Part 2: Particular requirements	60394454 001	EN61558-2-16:2009 + A1:2013
Safety of power transformers, power supplies, reactors and similar products for supply voltages up to 1100 V	CN21HNQK001	IEC61558-1:2017
	CN21ZHJ6001	EN IEC 61558-1:2019
Safety of power transformers, power supplies, reactors and similar products for supply voltages up to 1100 V Part 2: Particular requirements	CN21HNQK001	IEC61558-2-16:2009 1st Edition + A1:2013
	CN21ZHJ6001	EN61558-2-16:2009 + A1:2013
RoHS2		RoHS 2011/65/EU + AM2015/863
EMC Compliance		
	Condition	Standard / Criterion
Electromagnetic compatibility of multimedia equipment – Emission Requirements		EN55032:2015, Class B
Electromagnetic compatibility of multimedia equipment – Immunity requirements		EN55035:2017
Low voltage power supplies, d.c. output Part 3: Electromagnetic compatibility		EN IEC 61204-3:2018
Information technology equipment - Immunity characteristics - Limits and methods of measurement		EN55014-2:2015
Electromagnetic compatibility of multimedia equipment – Emission Requirements		EN55014-1:2017
Limitations on the amount of electromagnetic interference allowed from digital and electronic devices		FCC 47 CFR Part 15 Subpart B
ESD Electrostatic discharge immunity test	Air: ±2, 4, 8kV Contact: ±4kV	IEC61000-4-2:2008 , Criteria A EN61000-4-2:2009, Criteria A
Radiated, radio-frequency, electromagnetic field immunity test	3V/m: 80-1000MHz, 1800MHz, 2600MHz, 3500MHz, 5000MHz 1V/m: 2000-2700MHz	IEC/EN61000-4-3:2006 + A2:2010, Criteria A
Fast Transient and Burst Immunity	AC Port: ±1kV	IEC/EN61000-4-4:2012, Criteria A
Surge Immunity	AC Port: ±0.5, 1kV	IEC/EN61000-4-5:2014, Criteria A
Immunity to conducted disturbances, induced by radio-frequency fields	3Vrms: 0.15-230MHz 3-1Vrms: 10-30MHz 1Vrms: 30-80MHz	IEC61000-4-6:2013/EN6100-4-6:2014, Criteria A IEC61000-4-6:2013/EN6100-4-6:2014, Criteria A IEC61000-4-6:2013/EN6100-4-6:2014, Criteria A
Voltage Dips and Interruptions		IEC/EN61004-11:2004
Limits of Harmonic Current Emissions		IEC/EN61000-3-2:2019
Limits of Voltage Fluctuations & Flicker	Clause 5	EN61000-3-3:2013+A1

Specifications (measured @ Ta= 25°C, nom. Vin, full load and after warm-up unless otherwise stated)

DIMENSION AND PHYSICAL CHARACTERISTICS

Parameter	Type	Value
Material	case/baseplate potting PCB	black plastic (UL94V-0) silicone (UL94V-0) FR4 (UL94V-0)
Dimension (LxWxH)		37.0 x 24.0 x 15.4mm
Weight		22.8g typ.

Dimension Drawing (mm)

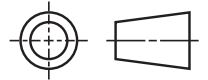
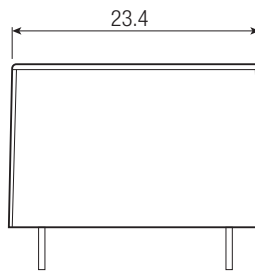
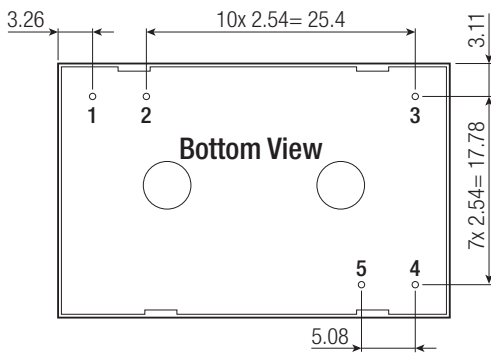
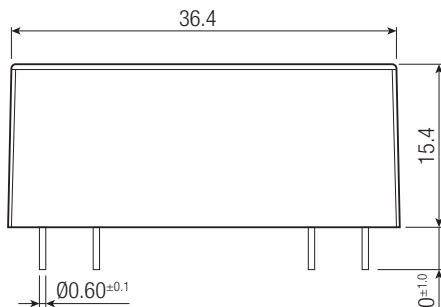
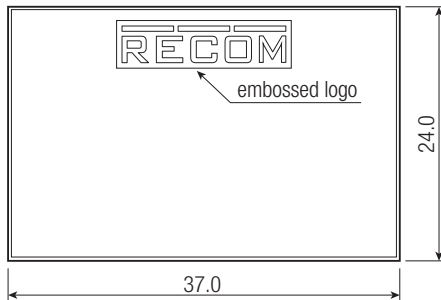

General tolerances according to ISO 2768-m
(table for reference only)

Dimension range	Tolerances
0.5 - 6 mm	±0.1 mm
6 - 30 mm	±0.2 mm
30 - 120 mm	±0.3 mm
120 - 400 mm	±0.5 mm

Pinning Information

Pin #	Single
1	VAC in (L)
2	VAC in (N)
3	NC
4	-Vout
5	+Vout

NC= no connection

Recommended Footprint Details

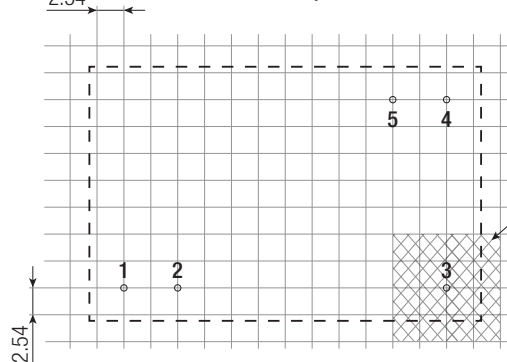

Restricted Area:
Pin be considered
secondary side referenced



PACKAGING INFORMATION

Parameter	Type	Value
Packaging Dimension (LxWxH)	tube	490.0 x 26.6 x 25.3mm
Packaging Quantity		12pcs
Storage Temperature Range		-40°C to +85°C
Storage Humidity	non-condensing	95% RH max.

The product information and specifications may be subject to changes even without prior written notice. The product has been designed for various applications; its suitability lies in the responsibility of each customer. The products are not authorized for use in safety-critical applications without RECOM's explicit written consent. A safety-critical application is an application where a failure may reasonably be expected to endanger or cause loss of life, inflict bodily harm or damage property. The applicant shall indemnify and hold harmless RECOM, its affiliated companies and its representatives against any damage claims in connection with the unauthorized use of RECOM products in such safety-critical applications.

Looking for pricing, stock, or lifecycle information?

Click below to explore more details on WIN SOURCE:

-  [View RAC03E-12SK/277 on WIN SOURCE](#)
-  [Recom Power Information](#)

Optimize Your Supply Chain with WIN SOURCE Solutions

-  Global Sourcing Solution
-  Obsolete Management
-  Cost Control Management
-  Shortage Management
-  Alternative Solution
-  Excess Inventory Management