



**THE DATASHEET OF
1307-0000-XX**



cell type: Li-Ion
cell size: 18650
built-in cell: LG INR18650M26

Conditions

nominal voltage: 3.6 V

capacity
 nominal: 2600 mAh discharge at 0.2C
 minimum: 2500 mAh discharge at 0.2C
 2350 mAh discharge at 1C
 ta: 20°C; EV(Discharge End Voltage): 2.5V

discharge
 max. continuous discharge current: 10 A ta: 0...45°C
important: avoid cell temperature above 60°C

discharge end voltage: ≥ 2.75 V (recommended)
important: avoid long time deep discharge

charge
 charging method: CC - CV (Constant Current - Constant Voltage)

initial charge current: 520 mA at standard charge
 2500 mA at fast charge

charge end voltage: 4.2 V ± 0.05 V

charge cut off by time: 6 h at standard charge
 1.6...1.8 h at fast charge

by current drop: 50 mA (0.02C) end current cut-off

internal resistance: ≤ 80 mOhms at 1kHz, sine wave measurement according to IEC 896-2

energy: 9.36 Wh

safety board protection functions
 overcharge cut off voltage: 4.275 V ± 0.075 V
 deep disch.cut off voltage: 2.5 V ± 0.2 V
 overload cut off current: 16 A ± 4 A

life time expectance
 (C>70% of min. capacity) ≥ 300 cycles at 0.5C charge/discharge rate

self discharge:
 ≤ 2 %/month at 20°C
 ≤ 5 %/month at 30°C
 ≤ 10 %/month at 40°C

ambient temperature range:
 0...45 °C charge
 - 20...60 °C discharge
 - 20...25 °C storage max. 1year
 - 20...45 °C storage max. 3months

recommended SOC: 30...50 % for long-time storage
 (SOC = state of charge)

mechanical specifications

cell dimensions (incl. sleeve)
 diameter d1: 18.7 ± 0.3 mm
 diameter d2: 6 ± 0.5 mm
 height h1: 69.6 ± 0.5 mm
 height h2: 1.35 ± 0.2 mm
 weight: 46 ± 3 g

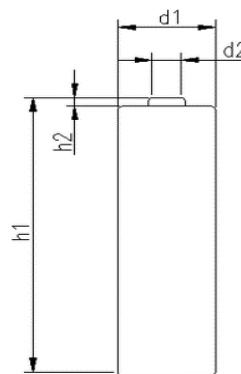

	ANSMANN Specifications for model:	Li - Ion Battery 3.6V 2600mAh with inside Protection Board (PCB)
	data sheet no. / part no.	
	s.n.	704507
	author / date	TG / 18.10.2023

Looking for pricing, stock, or lifecycle information?

Click below to explore more details on WIN SOURCE:

- [View 1307-0000-XX on WIN SOURCE](#)
- [ANSMANN \(Huizhou\) Trading CO., LTD Information](#)

Optimize Your Supply Chain with WIN SOURCE Solutions

- ✓ Global Sourcing Solution
- ✓ Obsolete Management
- ✓ Cost Control Management
- ✓ Shortage Management
- ✓ Alternative Solution
- ✓ Excess Inventory Management