



**THE DATASHEET OF**  
**1307-0003-XX**



**cell type:** Li-Ion  
**cell size:** 18650  
**built-in cell:** LG INR 18650 F1L 3350mAh

**Conditions**

**nominal voltage:** 3.6 V

**capacity**

nominal: 3400 mAh discharge at 0.2C  
 minimum: 3250 mAh discharge at 0.2C  
 3000 mAh discharge at 1C  
 ta: 20°C; EV(Discharge End Voltage): 2.50V

**discharge**

max. continuous discharge current: 4875 mA ta: 0...45°C  
**important:** avoid cell temperature above 60°C  
 discharge end voltage: ≥ 2.5 V (recommended)

**external charge (at +/- poles)**

charging method: CC - CV (Constant Current - Constant Voltage)

charge current: 650 mA at standard charge  
 max. charge current: 1625 mA at rapid charge  
 charge end voltage: 4.2 V ± 50mV

**charge cut off**

by time: 5...6 h at standard charge  
 2.75...3.25 h at rapid charge  
 by current drop: 50 mA end current - cut off

**charge via type-C connector (with USB charger)**

supply voltage: 5 V ± 0.25V  
 charge current: ≤ 1150 mA  
 charge time: ≤ 4 h at 1A charge

**internal resistance:** ≤ 100 mΩ at 1kHz, sine wave measurement according to IEC 896-2

energy: 12.24 Wh

**protection functions**

overcharge cut off voltage: 4.3 V ± 0.05V  
 deep disch.cut off voltage: 2.5 V ± 0.1V  
 overload cut off current: 16 A ± 4A

**LED charge indicator**

(w. type-C charge) lights red during charge  
 lights green end of charge; battery fully charged

LED charge indicator

**life time expectance**

(C>75% of min. capacity) ≥ 300 cycles at 0.5C charge/discharge rate

**self discharge:**

≤ 2 %/month at 20°C  
 ≤ 5 %/month at 30°C  
 ≤ 10 %/month at 40°C

**ambient temperature range:**

0...45 °C charge  
 - 20...60 °C discharge  
 - 20...25 °C storage max. 1year  
 - 20...45 °C storage max. 3months

recommended SOC:

(SOC = state of charge) 30...50 % for long-time stoarge

**mechanical specifications**

cell dimensions (incl. sleeve)

diameter d1: 18.5 - 0.3 mm  
 diameter d2: 6 ± 1 mm  
 height h1: 70.2 ± 0.3 mm  
 height h2: 0.9 ± 0.3 mm  
 weight: 49 ± 3 g

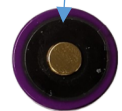
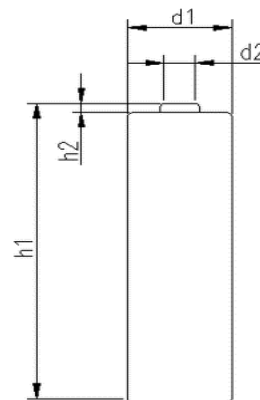

<b>ANSMANN Specifications for model:</b>	<b>Protected 18650 Li-Ion Battery 3.6V 3400mAh w. Type-C Charge</b>
data sheet no. / part no.	
s.n.	704507
author / date	TG / 13.01.2025

## Looking for pricing, stock, or lifecycle information?

Click below to explore more details on WIN SOURCE:

- [View 1307-0003-XX on WIN SOURCE](#)
- [ANSMANN \(Huizhou\) Trading CO., LTD Information](#)

## Optimize Your Supply Chain with WIN SOURCE Solutions

- ✓ Global Sourcing Solution
- ✓ Obsolete Management
- ✓ Cost Control Management
- ✓ Shortage Management
- ✓ Alternative Solution
- ✓ Excess Inventory Management