



THE DATASHEET OF
1516-0004-XX



battery type: Lithium Button Cell (X-type)
battery size: CR1632
chemical system: Lithium Manganese Dioxide

Conditions

nominal voltage: 3.0 V
open circuit voltage: 3.0...3.4 V (new battery)
 2.9...3.4 V (after 1 year storage at 20°C)

all measurements at 22 ± 2°C ambient

capacity rated: 120 mAh (continuous discharge at 15kΩ load; 24hours/day End Voltage (EV): 2.0V)
minimum: 114 mAh (continuous discharge at 15kΩ load; 24hours/day EV: 2.0V)

standard discharge time minimum: 150 h (at 3.9kΩ load (for QC measurement) EV: 2.0V)

discharge currents standard: 0.2 mA
 max. recommended current under continuous discharge: 3 mA
 max. recommended current under pulse discharge: 8 mA

discharge diagrams:

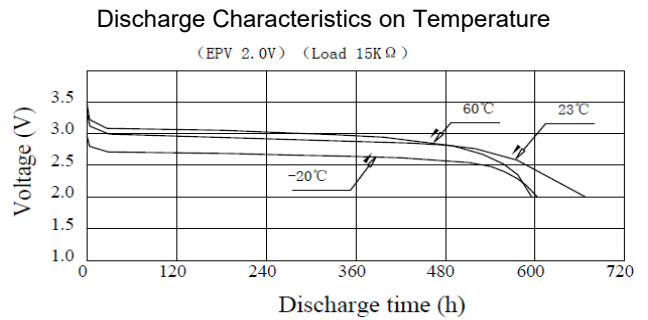
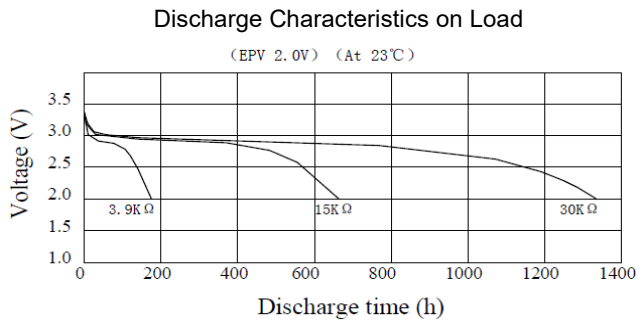

shelf life: 10 years (under proper storage conditions (ta: ≤ 22°C; RH: 60 ± 15%))
self-discharge: ≤ 2 % (per year (at 20°C ambient temperature))

operating temperature range: - 30...65 °C
storage temperature: 0...30 °C (recommended)

mechanical specifications:

outer battery dimensions
 diameter: 16.0mm +0/-0.3mm
 height: 3.2mm +0/-0.3mm

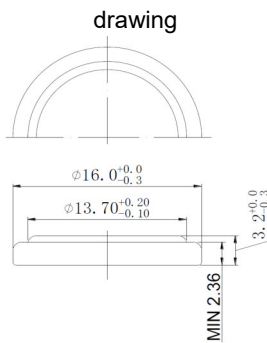

nominal weight: 2.0 g (approx.)

	ANSMANN Specifications for model: Lithium Button Cell CR1632
	data sheet no. / part no.
	s.n. 704245
	author / date TG / 11.09.2023

Looking for pricing, stock, or lifecycle information?

Click below to explore more details on WIN SOURCE:

- [View 1516-0004-XX on WIN SOURCE](#)
- [ANSMANN \(Huizhou\) Trading CO., LTD Information](#)

Optimize Your Supply Chain with WIN SOURCE Solutions

- ✓ Global Sourcing Solution
- ✓ Obsolete Management
- ✓ Cost Control Management
- ✓ Shortage Management
- ✓ Alternative Solution
- ✓ Excess Inventory Management