



**THE DATASHEET OF
5030912-XX**



| | | Conditions | |
|--|--------------|--|-------------|
| cell type: | NiMH | | |
| cell size: | C | | |
| nominal voltage: | 1.2 V | | |
| max. charge voltage: | 1.5 V | at standard charge (0.1C / 20°C) | |
| capacity | | | |
| nominal: | 2500 mAh | discharge at 0.2C | |
| minimum: | 2500 mAh | discharge at 0.2C | |
| | 2250 mAh | discharge at 1C | |
| | | 1.0V end discharge voltage | |
| | | ta: 20°C | |
| max. continuous discharge current: | 5000 mA | ta: 0...45°C | |
| charge | | current | time |
| standard charge: | 250 mA | 750 mA | 14....16hrs |
| quick charge: | 750 mA | 2500 mA | 4hrs |
| fast charge: | 2500 mA | | 1.1hrs |
| recommended charge termination control parameters: | 0...5 mV | - ΔV (-deltaV) | |
| | 0.8...1 °C | temperature rise per minute | |
| | 45...50 °C | TCO (temperature cut off) | |
| trickle charge current: | 25...75 mA | (recommended) | |
| continuous overcharge: (less than 1 year) | ≤ 250 mA | no conspicuous deformation no leakage | |
| internal resistance: (impedance) | ≤ 30 mΩ | at 1KHz battery fully charged | |
| life expectancy: | ≥ 500 cycles | acc. IEC standard | |
| self discharge | | | |
| charge retention: | ≥ 80 % | after 12 months storage at 20°C | |
| initial capacity: | ≥ 1700 mAh | within 30 days after delivery discharge at 0.2C | |
| ambient temperature range: | | | |
| | 0...45 °C | standard charge | |
| | 10...40 °C | fast charge | |
| | - 20...65 °C | discharge | |
| | - 20...50 °C | storage (≤3months) | |
| | - 20...40 °C | storage (≤6months) | |
| | - 20...30 °C | storage (≤24months) | |

QCT1: 20/2350/30
QCT2: 30/2200/35

| mechanical specifications | | | |
|---------------------------|------|------------|----|
| cell dimensions | | | |
| diameter d1: | | 25.6 - 1.0 | mm |
| diameter d2: | max. | 7.5 | mm |
| height h1: | | 50.0 - 2.0 | mm |
| height h2: | min. | 1.5 | mm |
| weight: | | 60 ± 4 | g |

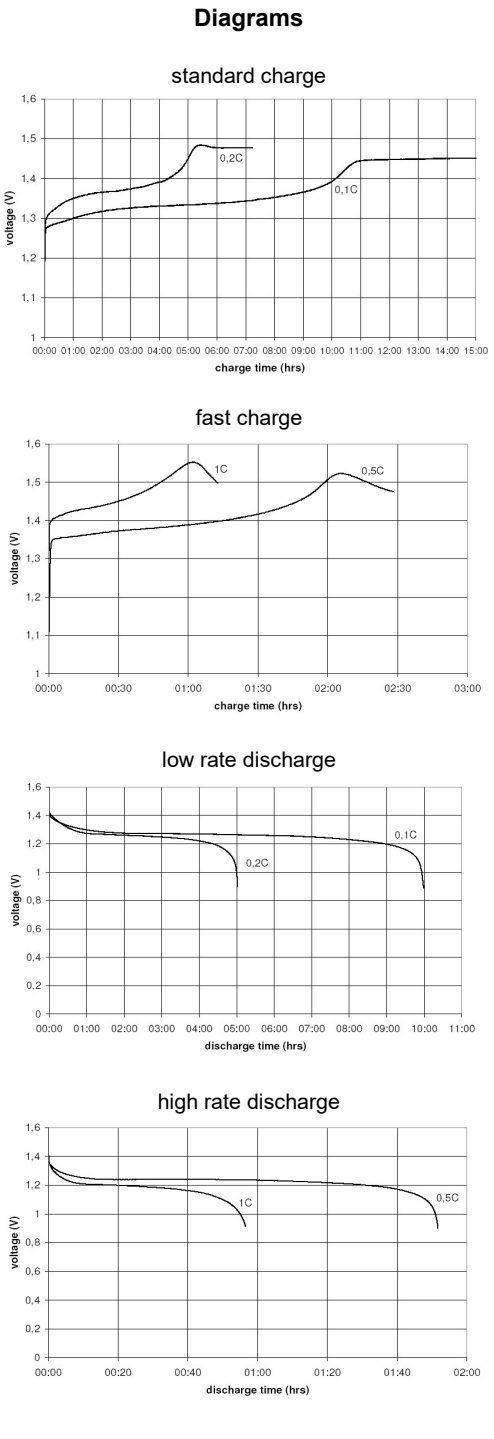
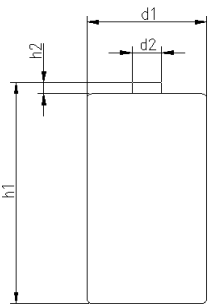

| | | |
|--|--|--|
| | ANSMANN Specifications for model: | C - 2500mAh low self discharge 2pcs blister package |
| | data sheet no. / part no. | 5030912 |
| | s.n. | 702069 |
| | author / date | TG / 18.06.2024 |

Manufacturer reserves the right to alter or amend the design, model and specification without prior notice

Looking for pricing, stock, or lifecycle information?

Click below to explore more details on WIN SOURCE:

- [View 5030912-XX on WIN SOURCE](#)
- [ANSMANN \(Huizhou\) Trading CO., LTD Information](#)

Optimize Your Supply Chain with WIN SOURCE Solutions

- ✓ Global Sourcing Solution
- ✓ Obsolete Management
- ✓ Cost Control Management
- ✓ Shortage Management
- ✓ Alternative Solution
- ✓ Excess Inventory Management