

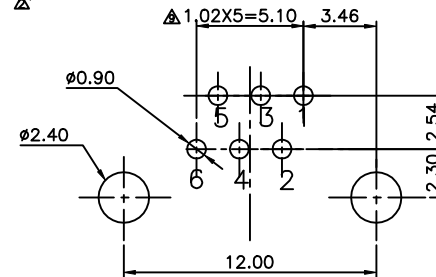

**THE DATASHEET OF
E5566-60L023-L**

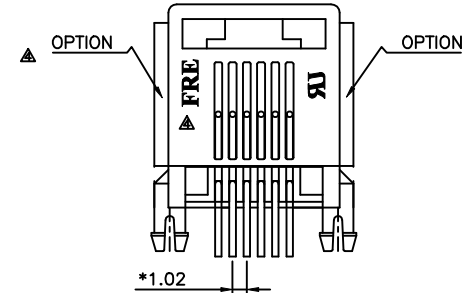

		REVISION RECORD			
REV	ECO	DESCRIPTION	DRFT	CHKD	
△		MODIFY DRAWING	02/21/04		
△		ADD NEW P/N	4/19/04		
△		ADD NEW P/N	6/03/04		
△		ADD NEW P/N	02/28/06		
△		DELETE ROSH P/N	04/01/05		
△		MODIFY PART NO	4/25/00		
△		MODIFY DRAWING	7/14/00		
△		ADD PART NO	5/13/02		
△		ADD PART NO	9/21/02		
△		MODIFY DRAWING	10/28/02		

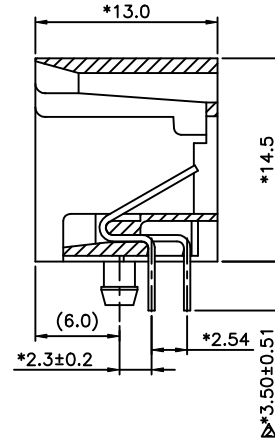
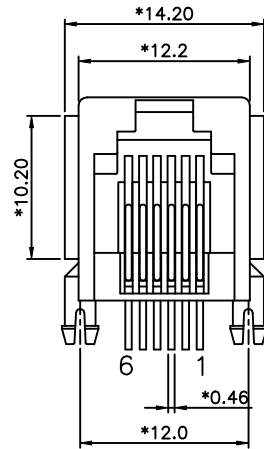
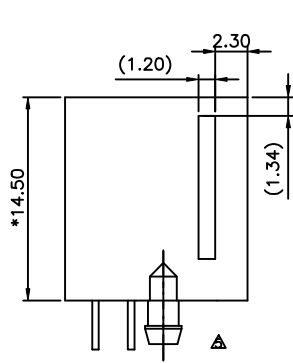

△ PC Board Layout Component Side Shown

NOTES:

ELECTRICAL:

- VOLTAGE RATING : 125 VAC RMS.
- CURRENT RATING : 1.5 AMP.
- CONTACT RESISTANCE : 30 MILLIOHMS MAX.
- INSULATION RESISTANCE: 1000MEGOHMS MIN @ 500 VDC.
- DIELECTRIC STRENGTH : 1000 VAC RMS 60Hz, 1MIN.

MECHANICAL:

- HOUSING MATERIAL : GLASS FILLED POLYESTER UL94V-0.
- CONTACT MATERIAL : PHOSPHOR BRONZE Ø0.46mm.
- PLATING : GOLD PLATING OVER NICKEL.
- OPERATING LIFE : 750 CYCLES MIN.
- PCB RETENTION PRE-SOLDER : 1 LB MIN.
- PCB RETENTION POST-SOLDER: 10 LBS MIN.

ENVIRONMENTAL:

- STORAGE : -40°C TO +85°C.
- OPERATION: 0°C TO 70°C.

MATES WITH MODULAR PLUG CONFORMING TO FCC PART 68, SUBPART F.

CUL FILE NO. E163191

PART NUMBER: E556X-60LXXX

NO.OF CONTACT	1-3u"	2-6u"	F-Gold Flash
2-2C	3-15u"	4-30u"	
4-4C	5-50u"	6-Pd 20u"	
6-6C	1-W/ PANEL STOP SPLIT POST W/O FRE LOGO		
	1- A06-0100 BK		
	1- A06-0110 GY		
	2-A06-0160 IV		
	△F-A06-0520 OYSTER YELLOW		
	△G- A06-0650 GY-WT		
	P-A06-1040 GY		
	R-A06-1320 GY		
	△4- BK-FR50(A05-0040)		
	△K- GY-FR50(A05-0220)		
	△L- LIGHT BLUE-FR50(A05-0230)		

MM (INCH)		DFTO BOTON	DATE
TOLERANCES EXCEPT AS NOTED		CHKDQIANFU	DATE2005/4/2
		MFO	DATE
		APPVLLUSHENG	DATE2005/4/4
		MATERIAL :	
		QT'Y :	
		FINISH :	
		SCALE : 3:1	

FULL RISE ELECTRONIC CO., LTD			
TITLE MINI L/P PCB JACK 6P			
DRAWING NO. GE553013		SIZE	REV
/PART NO. SEE NOTE		A3	10
DO NOT SCALE DRAWING		SHEET X	OF Y

Looking for pricing, stock, or lifecycle information?

Click below to explore more details on WIN SOURCE:

 [View E5566-60L023-L on WIN SOURCE](#)

 [Pulse Information](#)

Optimize Your Supply Chain with WIN SOURCE Solutions

-  Global Sourcing Solution
-  Obsolete Management
-  Cost Control Management
-  Shortage Management
-  Alternative Solution
-  Excess Inventory Management