

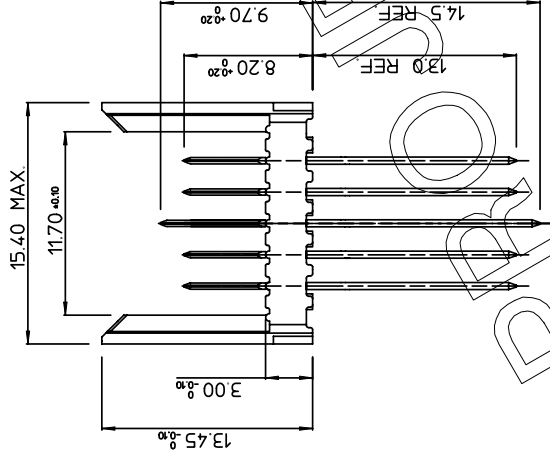

**THE DATASHEET OF
HM2P08PMF190GF**



2.00^{+0.05}

48.0 (24 X 2.0)

0.50^{+0.10} x 45°8.0
(4 X 2.0)2.00^{+0.05}

50.0 MAX.

NOTES:

1. THIS PRODUCT IS CSA APPROVED
2. THIS PRODUCT IS UL RECOGNIZED
3. MATERIAL CONTACT: PHOSPHOR BRONZE HOUSING; POLYESTER HOUSING
4. CONNECTOR PRINTED WITH P/N/REV
5. FOR ACTUAL CONTACT LOADING MATING SIDE
6. SHAPE OF CONNECTOR HOUSING DEPENDING ON PRODUCTION LOT
7. THE PRODUCT (LF) MEETS EUROPEAN REGULATIONS AS DESCRIBED IN IEC 60320
8. FOR RECOMMENDED PTH DIMENSIONS

MALE SIGNAL STRAIGHT

WITH	
1DEC ±0.2	APPR.
2DEC ±0.1	DRAFT
ANGLES ±1°	CHECKED
WE RESERVE THE RIGHT TO CHANGE THIS PRODUCT WITHOUT NOTICE.	PROD. MGR
ALL DIMENSIONS IN MM	PR. MGT. MGR
REFER:	



IT IS OUR POLICY TO EXCLUDE LIABILITY FOR DAMAGES OF ANY KIND, INCLUDING CONSEQUENTIAL DAMAGES, ARISING OUT OF OR RELATING TO THE USE OF THIS PRODUCT. THIS POLICY IS SUBJECT TO THE TERMS AND CONDITIONS OF THE PURCHASE ORDER.

THIS IS OUR EXCLUSIVE PROPERTY. IT IS NOT TO BE COPIED, REPRODUCED, OR USED IN ANY MANNER WITHOUT OUR WRITTEN CONSENT. ANY UNAUTHORIZED USE OR REPRODUCTION OF THIS DOCUMENT IS PROHIBITED AND WILL BE PUNISHED TO THE FULL EXTENT OF THE LAW.

IT IS OUR POLICY TO EXCLUDE LIABILITY FOR DAMAGES OF ANY KIND, INCLUDING CONSEQUENTIAL DAMAGES, ARISING OUT OF OR RELATING TO THE USE OF THIS PRODUCT. THIS POLICY IS SUBJECT TO THE TERMS AND CONDITIONS OF THE PURCHASE ORDER.

THIS IS OUR EXCLUSIVE PROPERTY. IT IS NOT TO BE COPIED, REPRODUCED, OR USED IN ANY MANNER WITHOUT OUR WRITTEN CONSENT. ANY UNAUTHORIZED USE OR REPRODUCTION OF THIS DOCUMENT IS PROHIBITED AND WILL BE PUNISHED TO THE FULL EXTENT OF THE LAW.

Looking for pricing, stock, or lifecycle information?

Click below to explore more details on WIN SOURCE:

- [View HM2P08PMF190GF on WIN SOURCE](#)
- [Amphenol FCI Information](#)

Optimize Your Supply Chain with WIN SOURCE Solutions

- ✓ Global Sourcing Solution
- ✓ Obsolete Management
- ✓ Cost Control Management
- ✓ Shortage Management
- ✓ Alternative Solution
- ✓ Excess Inventory Management