

13 12 11 10 9 8 7 6 5 4

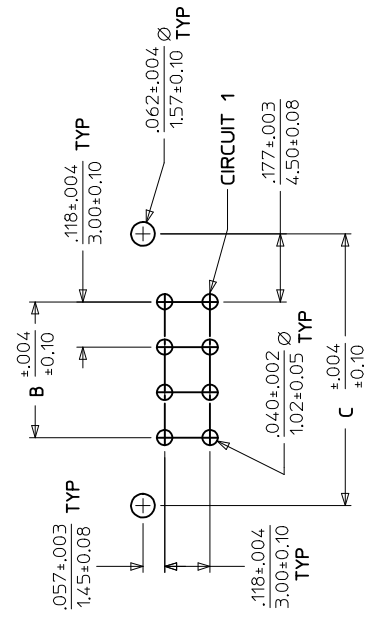
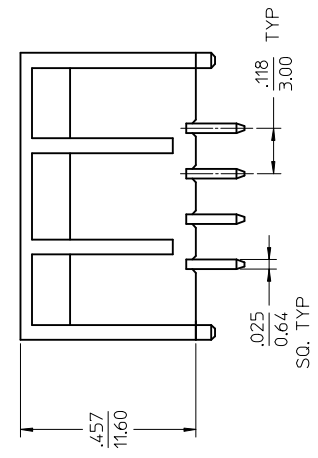
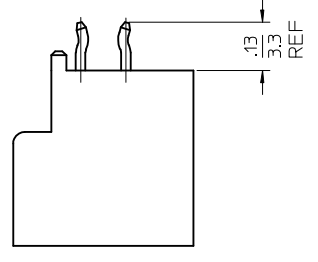
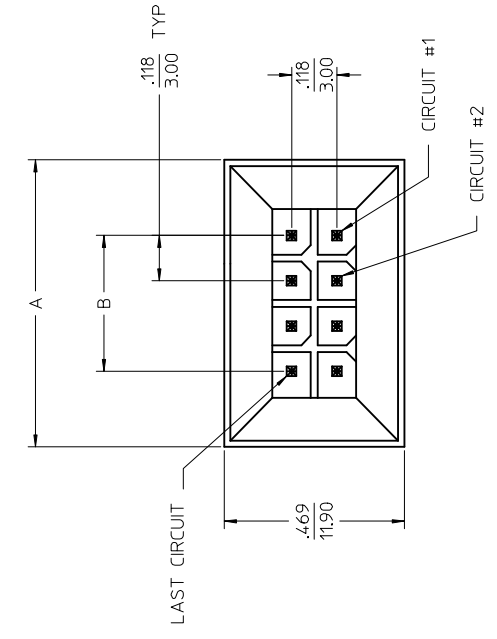

NOTES :

- MATERIALS -
HOUSING : NYLON , GLASS-FILLED, UL94V-0 COLOR - BLACK
TERMINAL : BRASS ALLOY
- FINISH:
A = .000200/(0.00508) MIN. TIN OVER .000050/(0.00127) MIN. NICKEL.
B = .000015/(0.00038) MIN. SELECT GOLD IN CONTACT AREA;
.000100/(0.00254) MIN. SELECT TIN ON SOLDER TAILS;
BOTH OVER .000050/(0.00127) MIN. NICKEL.
C = .000030/(0.00076) MIN. SELECT GOLD IN CONTACT AREA;
.000100/(0.00254) MIN. SELECT TIN ON SOLDER TAILS;
BOTH OVER .000050/(0.00127) MIN. NICKEL.
- PRODUCT SPECIFICATION : PS-44300-001
- PACKAGING SPECIFICATION : PK-44432-001
- THIS ASSEMBLY MATES WITH MOLEX BMI PANEL MOUNT RECEPTACLE (SEE DRAWING SD-44133-001) & FEMALE CRIMP TERMINAL (SEE DRAWING SD-43030-*****)
- SEE SHEET 2 FOR PART NUMBER CHART.
- THIS PART CONFORMS TO CLASS B REQUIREMENTS OF COSMETIC SPECIFICATION PS-45499-002

**PCB LAYOUT: COMPONENT SIDE
RECOMMENDED PCB THICKNESS .062/157**

APP:FSM11H 2016/04/13	DESCRIPTION	QUALITY SYMBOLS	GENERAL TOLERANCES (UNLESS SPECIFIED)	DIMENSION STYLE IN/MM
CH:D:JDFOX 2016/04/13		▽=0	4 PLACES ± --- INCH	DRAWN BY DATE MUELLER 1999/11/29
DRW:CSLAFTR 2016/04/13		▽=0	3 PLACES ± --- ±.010	CHECKED BY DATE MUELLER 1999/11/29
FC NO: UCP206-3971		▽=0	2 PLACES ±.025 ±.015	APPROVED BY DATE FSM11H 2016/04/13
ADD REFERENCE DIM			0 PLACE ± --- ±.010	MATERIAL NO. SEE CHART
D2			ANGULAR ±1/2°	SIZE THIS DRAWING CONTAINED AND SH
			DRAFT WHERE APPLICABLE MUST REMAIN WITHIN DIMENSIONS	

12 11 10 9 8 7 6 5 4

MATERIAL NUMBER	NUMBER OF POSITIONS	PLATING OPTION
44432-0401	04	A
44432-0402	04	B
44432-0403	04	C
44432-0601	06	A
44432-0602	06	B
44432-0603	06	C
44432-0801	08	A
44432-0802	08	B
44432-0803	08	C
44432-1001	10	A
44432-1002	10	B
44432-1003	10	C
44432-1201	12	A
44432-1202	12	B
44432-1203	12	C
44432-1401	14	A
44432-1402	14	B
44432-1403	14	C
44432-1601	16	A
44432-1602	16	B
44432-1603	16	C
44432-1801	18	A
44432-1802	18	B
44432-1803	18	C
44432-2001	20	A
44432-2002	20	B
44432-2003	20	C
44432-2201	22	A
44432-2202	22	B
44432-2203	22	C
44432-2401	24	A
44432-2402	24	B
44432-2403	24	C

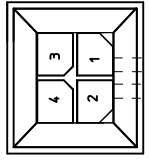

4 CIRCUIT

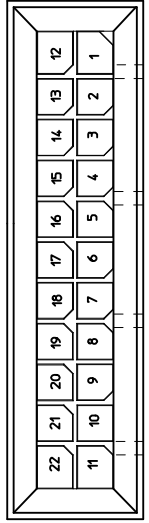

22 CIRCUIT

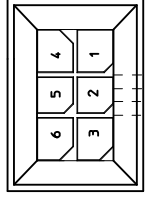

6 CIRCUIT

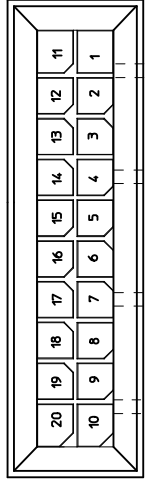

20 CIRCUIT

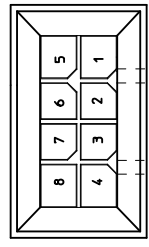

8 CIRCUIT

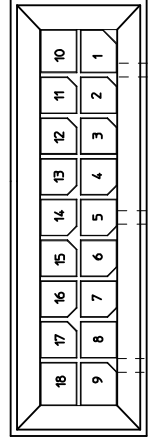

18 CIRCUIT

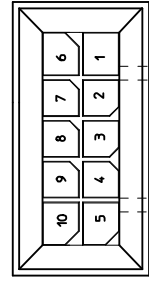

10 CIRCUIT

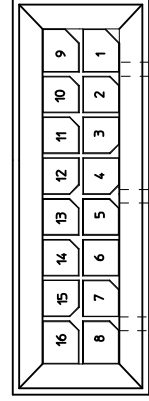

16 CIRCUIT

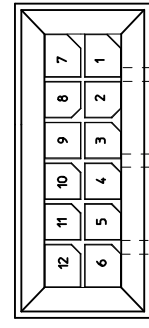

12 CIRCUIT

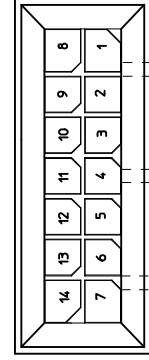

14 CIRCUIT

QUALITY SYMBOLS = 0 = 0 = 0	GENERAL TOLERANCES (UNLESS SPECIFIED) 4 PLACES ± --- INCH 3 PLACES ± --- ±.010 2 PLACES ±.025 ±.015 1 PLACE ±0.38 ± --- 0 PLACE ± --- ± ---	DIMENSION STYLE IN/MM DRAWN BY MUELLER CHECKED BY MUELLER APPROVED BY FSMITH MATERIAL NO. SEE CHART THIS DRAWING CONTAINS INCORPORATED AND S	DATE 1999/11/29
			DATE 1999/11/29
			DATE 2016/04/13
			DATE 2016/04/13
DESCRIPTION APPR:FSMITH CHKD:JDFOX 2016/04/13 DRWN:CSLAFTER 2016/04/13 EC NO: UCP2016-3971 SEE SHEET 1	REV D2	DRAFT WHERE APPLICABLE MUST REMAIN WITHIN DIMENSIONS	ANGLE ±1/2°

Looking for pricing, stock, or lifecycle information?

Click below to explore more details on WIN SOURCE:

 [View 44432-0401 on WIN SOURCE](#)

 [Molex, LLC Information](#)

Optimize Your Supply Chain with WIN SOURCE Solutions

-  Global Sourcing Solution
-  Obsolete Management
-  Cost Control Management
-  Shortage Management
-  Alternative Solution
-  Excess Inventory Management