

SERIES 400B SWITCHES

ROCKER SWITCHES - SMT SUBMINIATURE

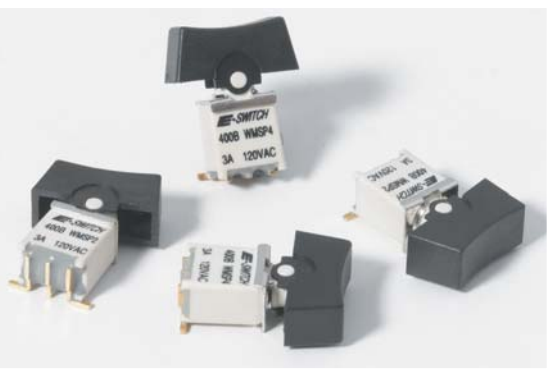

FEATURES & BENEFITS

- ▶ Variety of switching functions
- ▶ Sub-miniature
- ▶ Surface mount
- ▶ Sealed to IP67

APPLICATIONS/MARKETS

- ▶ Telecommunications
- ▶ Instrumentation
- ▶ Test equipment
- ▶ Networking
- ▶ Computer peripherals

SPECIFICATIONS

Contact Rating:	Silver - 3A @ 120VAC or 28VDC
	Gold - 0.4 VA @ 20VAC or VDC
Life Expectancy:	50,000 make-and-break cycles at full load
Contact Resistance:	20mΩmax. initial @ 2-4 VDC 100 mA
Insulation Resistance:	1000MΩ min.
Dielectric Strength:	1,000 V RMS @ sea level
Operating Temperature:	-30° C to 85° C
Packaging:	Tape & Reel

MATERIALS

Case & Bushing:	High temp material, glass filled 4/6 Nylon, flame retardant, heat stabilized (UL94-V0)
Actuator:	Brass, chrome plated with internal O-ring seal standard
Switch Support:	Brass/Steel, tin or tin-lead plated
Contacts / Terminals:	Silver or gold plate over nickel plated copper alloy
Terminal Seal:	Epoxy

HOW TO ORDER

SERIES	MODEL NO.	ACTUATOR	ACTUATOR COLOR	TERMINATION	CONTACT MATERIAL	SEAL
400B	□ □ □ □ □	□ □	□ □ □	□ □ □	□	□
	WMSP1 WMSP2 WMSP3 WMSP4 WMSP5	R2 = Std.	BLK = Black	SM6	Q = Silver R = Gold	E = Epoxy Sealed at Base of Terminal

Model No.	POS 1	POS 2	POS 3
WMSP-1	ON	NONE	ON
WMSP-2	ON	NONE	(ON)
WMSP-3	ON	OFF	ON
WMSP-4	(ON)	OFF	(ON)
WMSP-5	ON	OFF	(ON)
Term. Comm.	2-3	OPEN	2-1

() = Momentary

Example Ordering Number

400B-WMSP1-R2-BLK-SM6-Q-E

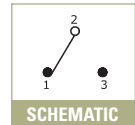
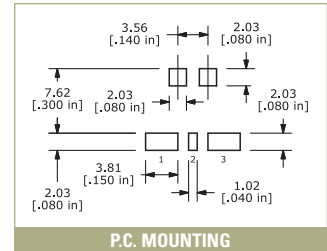
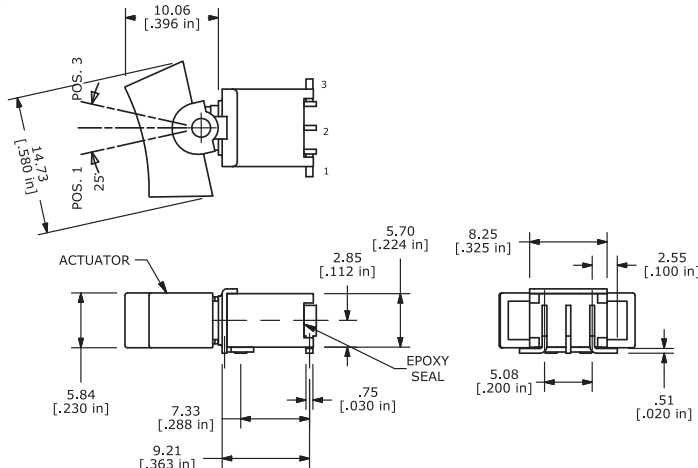

Specifications subject to change without notice.10.9.2020

400B









Looking for pricing, stock, or lifecycle information?

Click below to explore more details on WIN SOURCE:

-  [View 400BWMSP1R2BLKSM6QE on WIN SOURCE](#)
-  [E-Switch Information](#)

Optimize Your Supply Chain with WIN SOURCE Solutions

-  Global Sourcing Solution
-  Obsolete Management
-  Cost Control Management
-  Shortage Management
-  Alternative Solution
-  Excess Inventory Management