

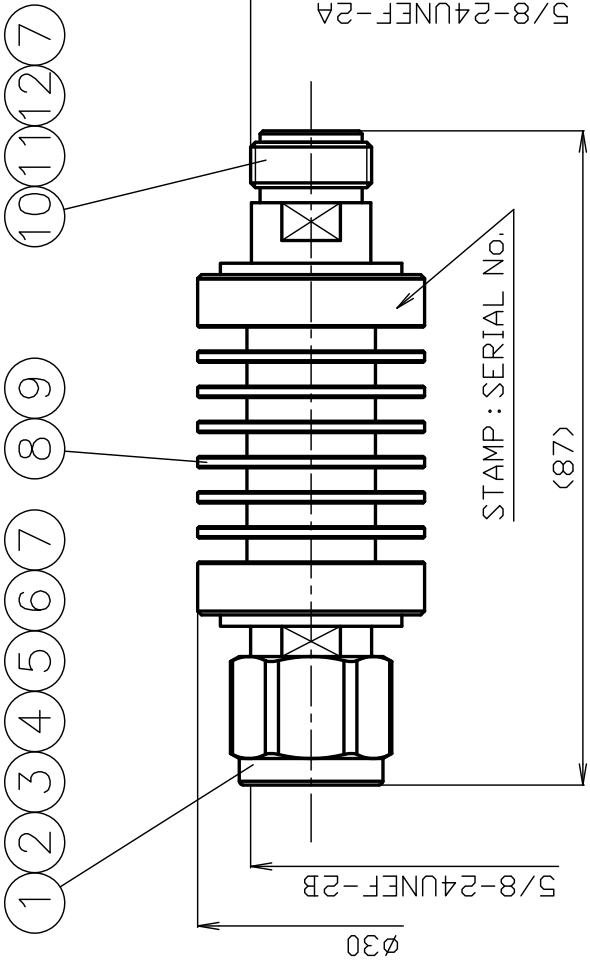

**THE DATASHEET OF  
NPJ50AT6G10W-6DB**

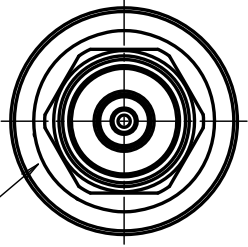

STAMP : 10W TYC 6dB IN



- \* 1 : TERNARY PLATING
- \* 2 : ANODIZING<BLACK>
- \* 3 : STAINLESS STEEL
- \* 4 : PHOSPHOR BRONZE

12	INSULATOR B	PTFE	1	--	
11	CENTER PIN B	* 4	1	Au	
10	BODY B	BRASS	1	* 1	
9	ATTENUATION TERMINAL	--	1	--	
8	HEAT SINK	ALUMINUM	1	* 2	
7	O-RING	SILICONE	2	--	
6	INSULATOR A	PTFE	1	--	
5	CENTER PIN A	* 4	1	Au	
4	GASKET	SILICONE	1	--	
3	BODY A	BRASS	1	* 1	
2	HOLDING RING	* 3	1	--	
1	COUPLING NUT	BRASS	1	* 1	
NO.	DESCRIPTION	MATERIAL	Q'TY	FINISH	REMARK

SCALE 1/1

UNIT mm

DATE 2023.12.18

DRAWN 井出

'23.12.18

INSPECTED 檜澤

'23.12.18

APPR

'23.12.18

PROJECTION



株式会社

70-

# PRODUCT SPECIFICATIONS

Part No. NPJ50AT6G10W-6dB

No. 0592338

DWG No. W-0595937

Nominal 1 Standard JIS C 5411  
 2 Power handling 10W  
 3 Frequency range 6GHz  
 4 Impedance 50Ω  
 5 [OPR]Temp-Range -45°C~+85°C



		Test Items	Procedures/Test method	Requirements
DESIGN	1	Design & construction	Specified on relevant product drawing	No defects or abnormalities
	2	Materials	(DWG No. W-0595937)	
	3	Finishes		
ELECTRICAL	4	Attenuation	DC~6GHz	6±0.68dB
	5	V. S. W. R	DC~3GHz 3~6GHz	1.2 (Max.) 1.3 (Max.)
	6	Compatibility	Connecting with a standard-compliant connector	No defects or abnormalities
MECHANICAL	7	Tensile strength of coupling mechanism	At axial tensile force 300N	No defects or abnormalities
	8	Connection nut tightening torque	0.9~1.7N·m	No defects or abnormalities
	9	Waterproof	IPX7	No water ingress inside the connector

	Remarks	Date
1		
2		
3		

Checked	Approved	Inspected	Prepared
 三村 21.11.22	 山本 21.11.22	 樽澤 21.11.22	 渡邊 21.11.22 直弘

## Looking for pricing, stock, or lifecycle information?

Click below to explore more details on WIN SOURCE:

- ⊖ [View NPJ50AT6G10W-6dB on WIN SOURCE](#)
- ⊖ [TYCLON Information](#)

## Optimize Your Supply Chain with WIN SOURCE Solutions

- ✓ Global Sourcing Solution
- ✓ Obsolete Management
- ✓ Cost Control Management
- ✓ Shortage Management
- ✓ Alternative Solution
- ✓ Excess Inventory Management