

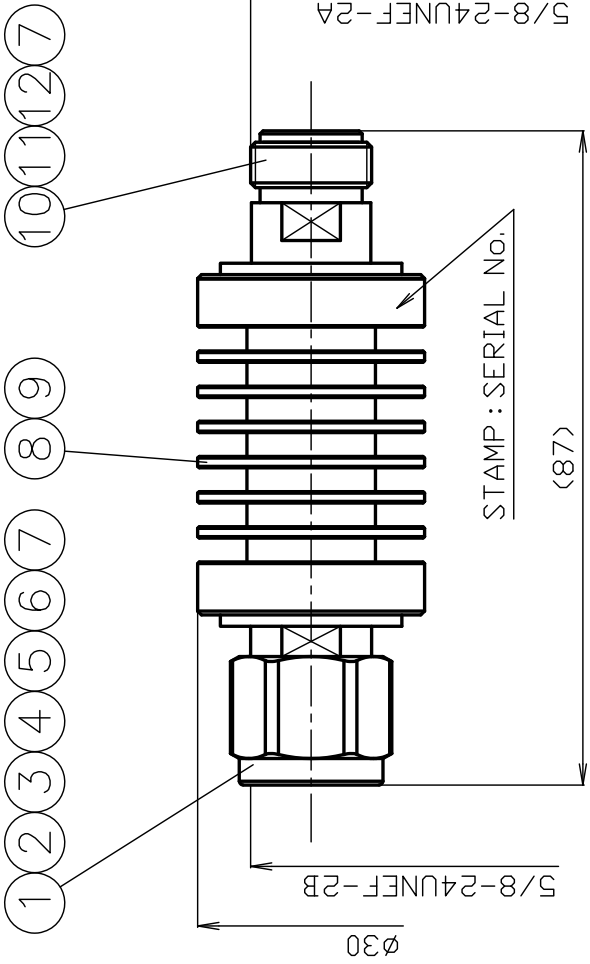

**THE DATASHEET OF
NPJ50AT6G10W-10DB**

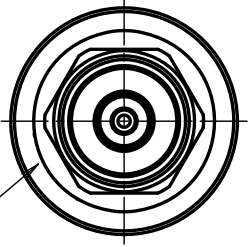

STAMP : 10W TYC 10dB IN



- * 1 : TERNARY PLATING
- * 2 : ANODIZING<BLACK>
- * 3 : STAINLESS STEEL
- * 4 : PHOSPHOR BRONZE

12	INSULATOR B	PTFE	1	--																
11	CENTER PIN B	* 4	1	Au																
10	BODY B	BRASS	1	* 1																
9	ATTENUATION TERMINAL	--	1	--																
8	HEAT SINK	ALUMINUM	1	* 2																
7	O-RING	SILICONE	2	--																
6	INSULATOR A	PTFE	1	--																
5	CENTER PIN A	* 4	1	Au																
4	GASKET	SILICONE	1	--																
3	BODY A	BRASS	1	* 1																
2	HOLDING RING	* 3	1	--																
1	COUPLING NUT	BRASS	1	* 1																
NO.	DESCRIPTION	MATERIAL	Q'TY	FINISH																

SCALE 1/1

UNIT mm

DATE 2023.12.15

DRAWN

井出

'23.12.15

PROJECTION

2023.12.15

INSPECTED

檜澤

'23.12.15

株式会社

70-

APPR

井出

'23.12.15

株式会社

70-

PRODUCT SPECIFICATIONS

Part No. NPJ50AT6G10W-10dB

No. 0592342





DWG No. W-0595941

Nominal 1 Standard JIS C 5411
 2 Power handling 10W
 3 Frequency range 6GHz
 4 Impedance 50Ω
 5 [OPR]Temp-Range -45°C~+85°C





		Test Items	Procedures/Test method	Requirements
1 2 3	DESIGN	Design & construction	Specified on relevant product drawing (DWG No. W-0595941)	No defects or abnormalities
		Materials		
		Finishes		
4 5	ELECTRICAL	Attenuation	DC~6GHz	10±0.8dB
		V. S. W. R	DC~3GHz	1.2 (Max.)
			3~6GHz	1.3 (Max.)
6 7 8	MECHANICAL	Compatibility	Connecting with a standard-compliant connector	No defects or abnormalities
		Tensile strength of coupling mechanism	At axial tensile force 300N	No defects or abnormalities
		Connection nut tightening torque	0.9~1.7N·m	No defects or abnormalities
9	ENVIRONMENTAL	Waterproof	IPX7	No water ingress inside the connector

	Remarks	Date
1		
2		
3		

Checked	Approved	Inspected	Prepared
 三村 21.11.22	 山本 21.11.22	 樽澤 21.11.22	 渡邊直弘 21.11.22

Looking for pricing, stock, or lifecycle information?

Click below to explore more details on WIN SOURCE:

-  [View NPJ50AT6G10W-10dB on WIN SOURCE](#)
-  [TYCLON Information](#)

Optimize Your Supply Chain with WIN SOURCE Solutions

-  Global Sourcing Solution
-  Obsolete Management
-  Cost Control Management
-  Shortage Management
-  Alternative Solution
-  Excess Inventory Management