



THE DATASHEET OF N-PA-PJ



1 2 3 4 5 6

7

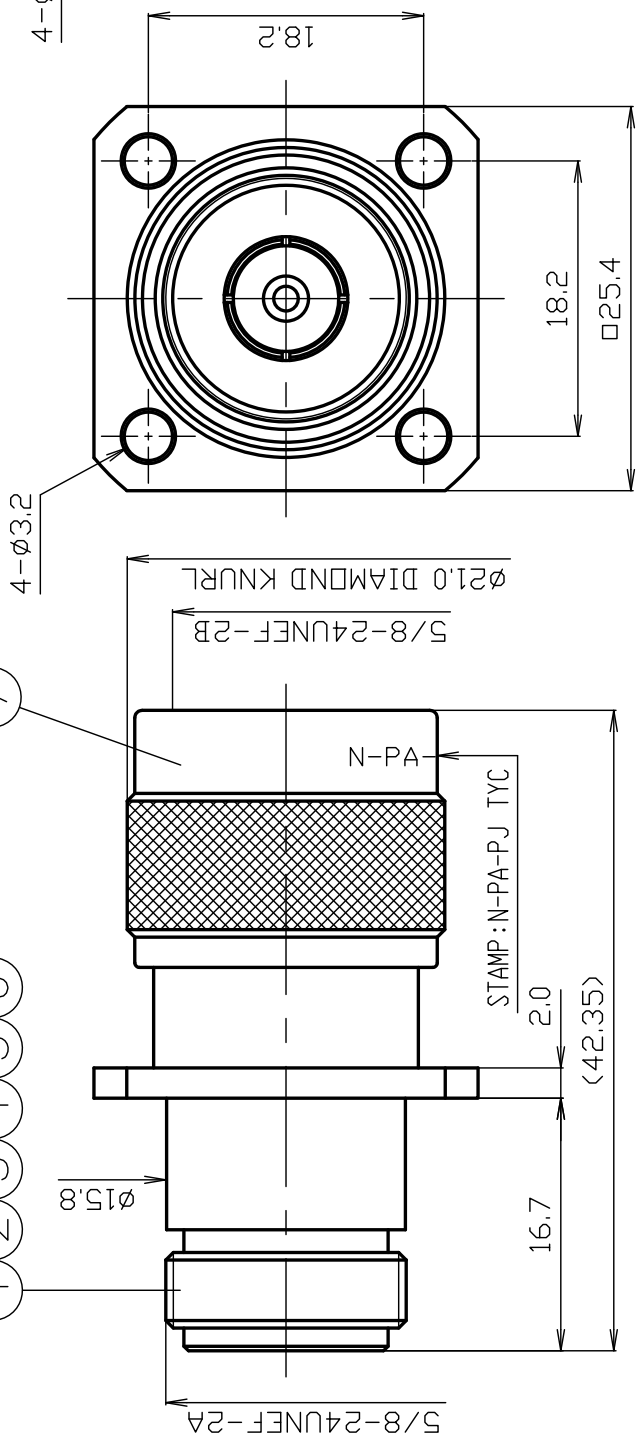

*1: PHOSPHOR BRONZE

NO.	DESCRIPTION	MATERIAL	Q'TY	FINISH	REMARK
7	COUPLING NUT	BRASS	1	Ni	
6	GASKET	SILICONE	1	--	
5	OUTER CONTACT	BRASS	1	Ni	
4	HOLDING RING	*1	1	--	
3	INSULATOR	PTFE	2	--	
2	BODY	BRASS	1	Ni	
1	CENTER PIN	*1	1	Au	

SCALE	2/1
UNIT	mm
DATE	2023.12.06

DRAWN	INSPECTED	APPR
渡邊 直弘 '23,12,06	檜 澤 '23,12,06	'23,12,06

PROJECTION	LOGO	70
◎	◎	◎

PRODUCT SPECIFICATION

Part number : N-PA-PJ

No. 0541352

Drawing number : X-0573657

Nominal 1 Standard JIS C 5411
 2 Voltage rating AC 500V
 3 Frequency range 10GHz
 4 Impedance 50Ω
 5 Operating Temperature Range -40°C ~ +85°C
 6 Operating Humidity Range 95%RH(Max.) ※No condensation



	Test Items	Test Method/Value	Remarks	
1	E L E C T R I C A L	Insulation Resistance	1000MΩ(Min.) at DC 500V	
2		Withstand voltage	1 minute at AC 1000V	
3		Contact resistance	3mΩ(Max.)	
4		V.S.W.R	DC~3.5GHz : 1.2(Max.) 3.5GHz~10GHz : 1.3(Max.)	
5	M E C H A N I C A L	Compatibility	No defects or abnormalities	Mating with connector complying with the standard
6		Center contact retaining force	0.98N(Min.)	With a standard pin gauge
7		Tensile strength of coupling mechanism	300N	At axial tensile force
	O T H E R S			

※The structural shape is shown in the attached drawing (Drawing number:X-0573657)



	REVISIONS	DATE
1		
2		
3		

Checked	Approved	Inspected	Preparation
三 23.12.06 村	山 23.12.06 本	檜 23.12.06 澤	渡邊 '23,12,06 直弘

GKQM-24

Looking for pricing, stock, or lifecycle information?

Click below to explore more details on WIN SOURCE:

-  [View N-PA-PJ on WIN SOURCE](#)
-  [TYCLON Information](#)

Optimize Your Supply Chain with WIN SOURCE Solutions

-  Global Sourcing Solution
-  Obsolete Management
-  Cost Control Management
-  Shortage Management
-  Alternative Solution
-  Excess Inventory Management