

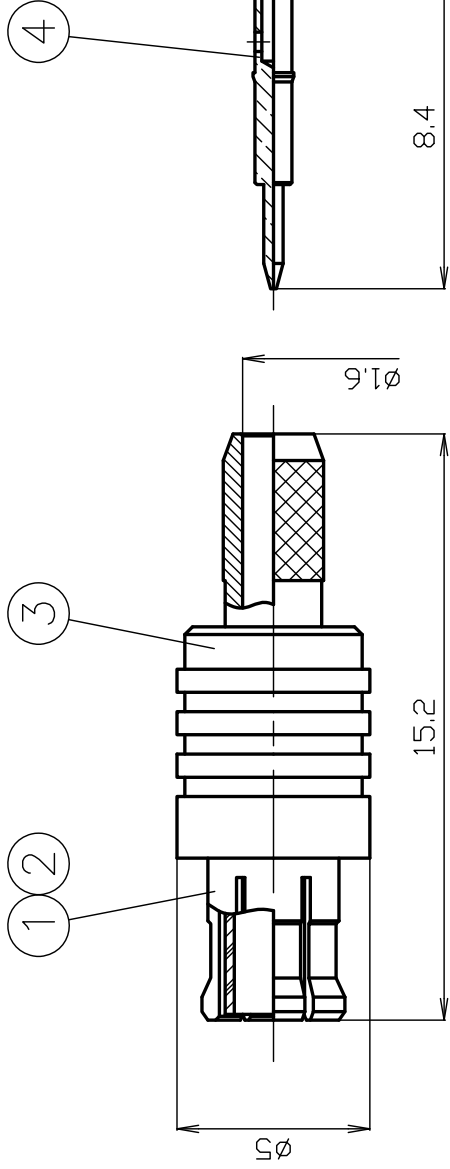

# THE DATASHEET OF MCX-P-316





RECOMMENDED CABLE STRIPPING DIMENSIONS

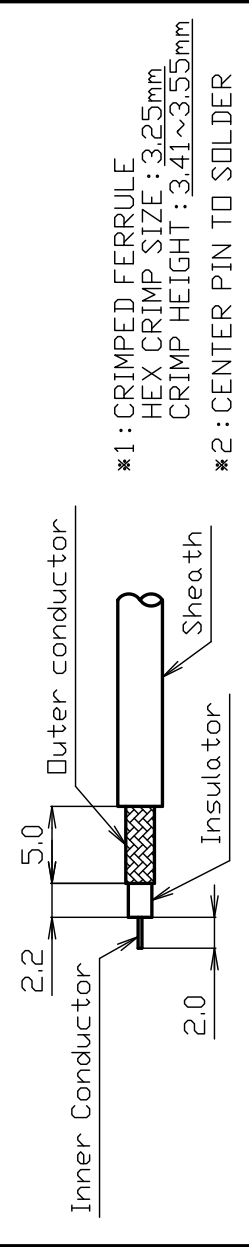

\*1: BERYLLIUM COPPER

NO.	DESCRIPTION	MATERIAL	Q'TY	FINISH	REMARK	DATE	UNIT	SCALE	DRAWN	CHECKED	APPR
7						2023.10.24	mm	5/1	渡邊 直弘	檜 澤	'23
6											
5	FERRULE	BRASS	1	Au							
4	CENTER PIN	BRASS	1	Au							
3	BODY	BRASS	1	Au							
2	INSULATOR	PTFE	1	--							
1	OUTER CONTACT	*1	1	Au							



# PRODUCT SPECIFICATION

Part number: MCX-P-316

No. 1011780

Drawing number: Y-1014726





Nominal 1 Frequency range 6GHz  
 2 Impedance 50Ω  
 3 Operating Temperature Range -40°C~+85°C  
 4 Operating Humidity Range 95%RH(Max.)  
 ※No condensation



Test Items		Test Method/Value	Remarks	
E L E C T R I C A L	1	Insulation Resistance	1000MΩ(Min.) at DC 500V	
	2	Withstand voltage	1 minute at DC 1000V	
	3	Contact resistance	Inner conductor:5mΩ (Max.) Outer conductor:2.5mΩ(Max.)	DC 0.2V, At 1A
	4	V.S.W.R	DC~3GHz : 1.3(Max.) 3~6GHz : 1.5(Max.)	
M E C H A N I C A L	5	Compatibility	No defects or abnormalities	Mating with connector complying with the standard
	6	Force to Engage/Disengage	63N(Max.) / 8~20N	
	7	Cable tensile strength	44.48N(Min.)	At axial tensile force
O T H E R S	8	Cable group	RG-316/U、RG-174/U	

※The structural shape is shown in the attached drawing (Drawing number:Y-1014726)



	REVISIONS	DATE
1		
2		
3		

Checked	Approved	Proof mark	Prepared
 三 23.10.24 村	 山 23.10.24 本	 檜 23.10.24 澤	 渡邊 '23.10.24 直弘

GKQM-7

## Looking for pricing, stock, or lifecycle information?

Click below to explore more details on WIN SOURCE:

-  [View MCX-P-316 on WIN SOURCE](#)
-  [TYCLON Information](#)

## Optimize Your Supply Chain with WIN SOURCE Solutions

-  Global Sourcing Solution
-  Obsolete Management
-  Cost Control Management
-  Shortage Management
-  Alternative Solution
-  Excess Inventory Management