

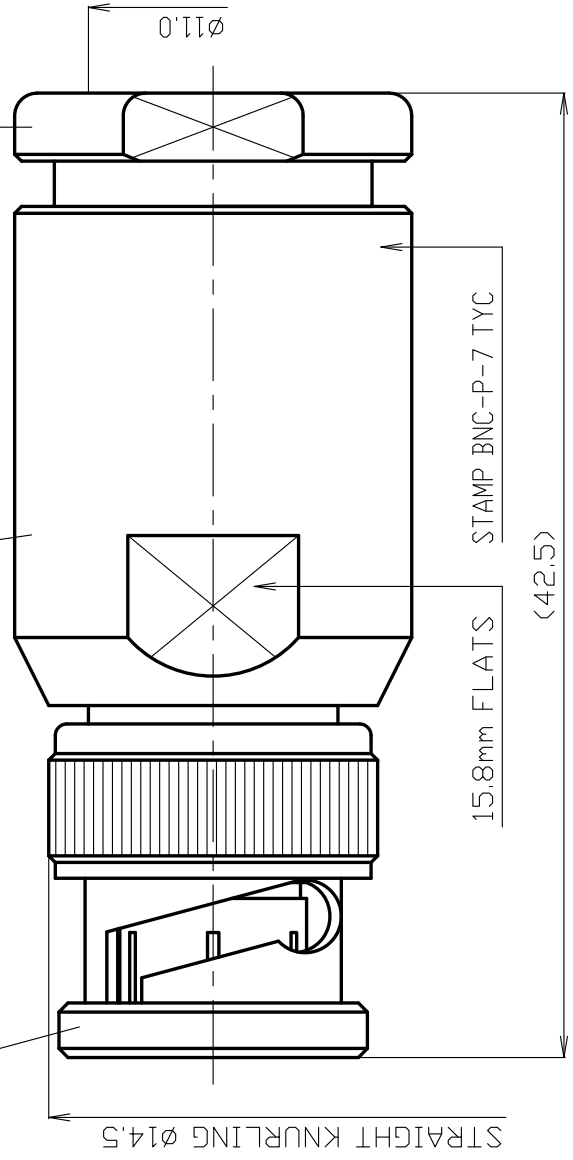

# THE DATASHEET OF BNCP-7



①②③④⑤⑥⑦ ⑧⑨⑩⑪⑫⑬



13	CLAMP NUT	BRASS	1	NICKEL
12	BODY	BRASS	1	NICKEL
11	WASHER	BRASS	1	NICKEL
10	GASKET	SILICONE	1	--
9	CLAMP	BRASS	1	NICKEL
8	BUSHING	BRASS	1	NICKEL
7	FLAT WASHER	BRASS	1	NICKEL
6	WAVE WASHER	BERYLLIUM COPPER	2	--
5	HALF FLAT WASHER	BRASS	2	NICKEL
4	GASKET	SILICONE	1	--
3	CENTER PIN	BRASS	1	GOLD I.D Ø2.4
2	INSULATOR	PTFE	1	--
1	SHELL	BRASS	1	NICKEL
NO.	NAME	MATERIAL	Q'TY	FINISH
				REMARK

SCALE 3/1  
UNIT mm  
DATE APR 01,1998

DRAWING CHECKED APPR

渡邊 直弘 '16.12.08  
樽澤 '16.12.08

株式会社 70-

# PRODUCT SPECIFICATION

Part Number                   BNCP-7  
 Drawing Number            S-0310936  
 Ratings of Nominal        1. STANDARD CROSS REFERENCE   JIS C5412  
   2. VOLTAGE RATING                    AC 500V  
   3. RATING OF NOMINAL FREQUENCY  4GHz  
   4. NOMINAL IMPEDANCE              50Ω

No. 0310202

**TO-CONNE CO., LTD. (TYC)**

Approved	Checked	Prepared
山 16.12.08 本	檜 16.12.08 澤	渡邊 '16.12.08 直弘

NO.	Test Items	Procedures / Test Method	Requirements	
1	S T R U C T U R E	Design and Dimensions	No Defects Or Abnormalities	
2	Materials	Drawing Number: S-0310936		
3	Finish and Marking			
4	E L E C T R I C A L		Insulation Resistance	At DC 500V
5	Withstanding Voltage	AC 1500V / 1 Minute	No Defects Or Abnormalities	
6	Contact Resistance	The method of which, the voltage drop of the contact duration should not exceed about 1-kHz AC or 1mV DC	3mΩ max	
7	M E C H A N I C A L	Compatibility	To connect with industrial standard connectors	Should be connected without any abnormalities
8	Cable Withdrawal Force	Axial Tensile Force: 25kgf {about250N} max	No Defects Or Abnormalities	
9	Coupling Nut Retention Force	Axial tensile force: 25kgf {about 250N} max., when 25kgf cm of torque is applied to the coupling nut	Coupling nut should have no abnormalities	
10	Mating	After 5,000 times	After 5,000 times, the contact resistance should be 10mΩ Or under	
11	Compatible cable	7C-2V, 7C-FB, S-7C-FB, RG-8/U, RG-11/U, EM-7C-2E		

REVISIONS	DATE

# BNCP-7 Assembly Instructions

Cable group

7C-2V, 7C-FB, S-7C-FB

Drawing No.

S-0310936

All parts of the connector as shown

CENTER

Drawing	Approved
渡邊 '16.12.08 直弘	山本 '16.12.08

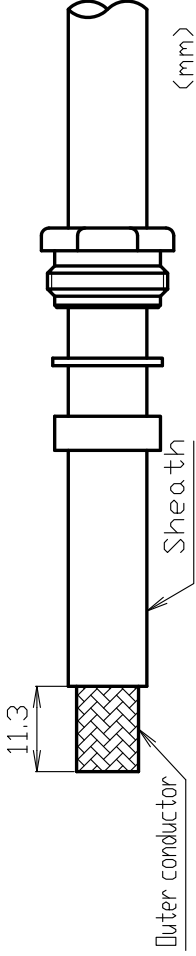
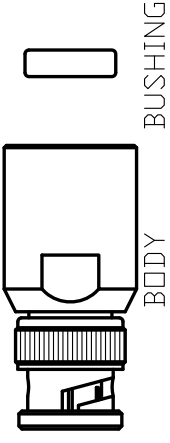

- 1 Insert cable into in order as shown Strip the sheath as shown in the

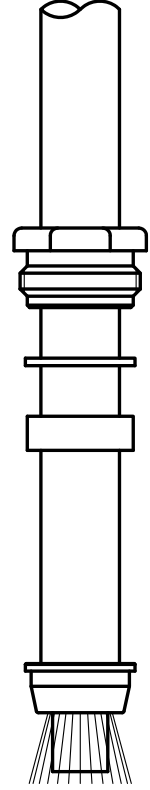

- 2 Put the clamp on the braid wire.

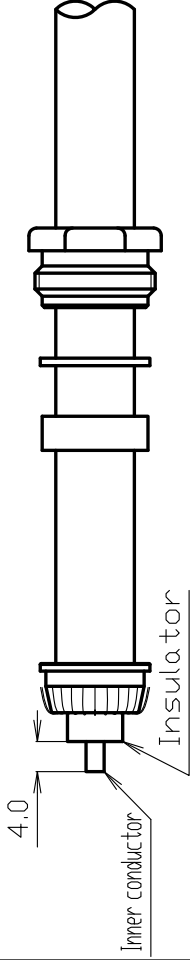

- 3 Fold back the braid same length. Cut dimensions shown

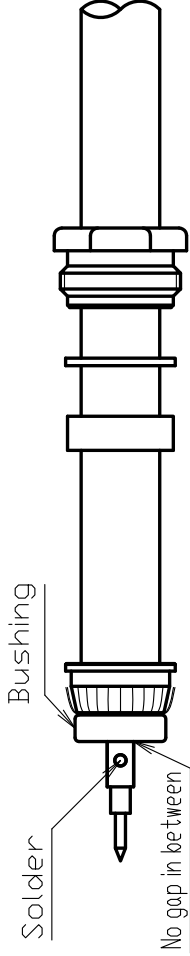

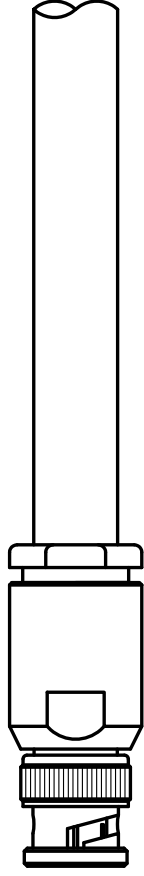

- 4 Attach center pin to cable and solder. The insulator. Do not put there is no gap in between when soldering. Attach center pin to make



- 5 Place the body on a wrench.

## Looking for pricing, stock, or lifecycle information?

Click below to explore more details on WIN SOURCE:

-  [View BNCP-7 on WIN SOURCE](#)
-  [TYCLON Information](#)

## Optimize Your Supply Chain with WIN SOURCE Solutions

-  Global Sourcing Solution
-  Obsolete Management
-  Cost Control Management
-  Shortage Management
-  Alternative Solution
-  Excess Inventory Management