

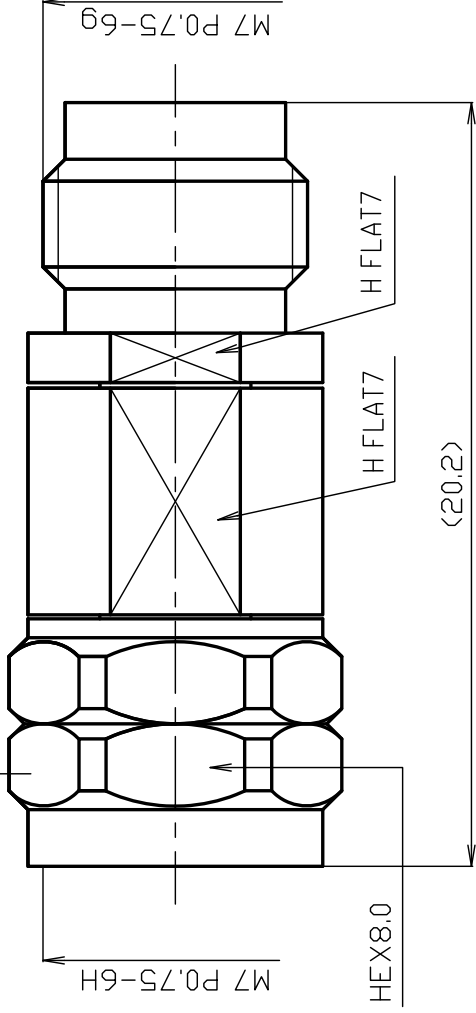

**THE DATASHEET OF
1.85-A-PJ**



1 2 3 4 5 6 7
VIEW A



STAMP : 1.8

VIEW A

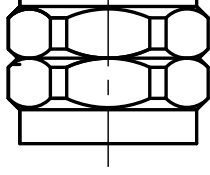

VIEW B

STAMP :

- * 1 PASSIVATE
- * 2 STAINLESS STEEL
- * 3 BERYLLIUM COPPER
- * 4 PHOSPHOR BRONZE

VIEW B

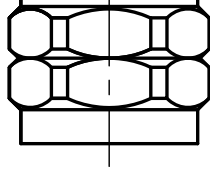

7	NUT	* 2	1	* 1		SCALE	5/1	DRAWN	上領	'24.06.17	INSPECTED	上澤	'24.06.17	APPR	
6	INSULATOR	PEI	1	--											
5	CENTER PIN	* 3	1	Au											
4	BODY D	* 4	1	Au											
3	BODY C	* 2	1	* 1		UNIT	mm								
2	BODY B	* 2	1	* 1		DATE	2024.06.17								
1	BODY A	* 2	1	* 1											
NO.	DESCRIPTION	MATERIAL	Q'TY	FINISH	REMARK										



株式会社 70-

PRODUCT SPECIFICATIONS

Part number: 1.85-A-PJ

No. 1042574

Drawing number: V-1046395

Nominal 1 Standard	IEC 61169-32
2 Voltage rating	AC 160V
3 Rated frequency	67GHz
4 Impedance	50Ω
5 Operating temperature range	-55°C~+105°C



		Test Items	Test Method/Value	Remarks
1	E L E C T R I C A L	Insulation resistance	5000MΩ(Min.) at DC 500V	
2		Withstanding voltage	1 minute at AC 500V	
3		Contact resistance	Inner conductor : 4.0mΩ(Max.) Outer conductor : 2.5mΩ(Max.)	
4		V.S.W.R	DC~67GHz : 1.35(Max.)	
5	M E C H A N I C A L	Compatibility	No defects or abnormalities	Connecting with a standard-compliant connector
6		Tensile strength of coupling mechanism	447N	At axial tensile force
7		Center contact retaining force	0.25N(Min.)	With a standard pin gauge
8		Coupling torque	0.8~1.1N·m	
9				
10	O T H E R S			
11				

※The structural shape is shown in the attached drawing (Drawing numberV-1046395)

	REVISIONS	DATE
1		
2		
3		

Checked	Approved	Inspected	Prepared
 24.06.17 村	 24.06.17 山本	 24.06.17 澤	 24.06.17 上領

GKQM-24

Looking for pricing, stock, or lifecycle information?

Click below to explore more details on WIN SOURCE:

- [View 1.85-A-PJ on WIN SOURCE](#)
- [TYCLON Information](#)

Optimize Your Supply Chain with WIN SOURCE Solutions

- ✓ Global Sourcing Solution
- ✓ Obsolete Management
- ✓ Cost Control Management
- ✓ Shortage Management
- ✓ Alternative Solution
- ✓ Excess Inventory Management