



**THE DATASHEET OF
ESS-3535UVC275**



Jiangsu Everstar Electronics Co., Ltd.

Address:No.6 Xiangshan Rd, Tianmuhu Industry Park, Liyang City, Jiangsu Province, China

TEL: +86-519-87557772

FAX: +86-519-87557773

Http: www.everstarelect.com

DATA SHEET

ESL NO.. : ESS-3535UVC275

CUS NO. :

REV : A / 0

Producer: _____

Eden

Auditor: _____

Approver: _____

Jack

CUSTOMER'S APPROVAL : _____

DCC : _____

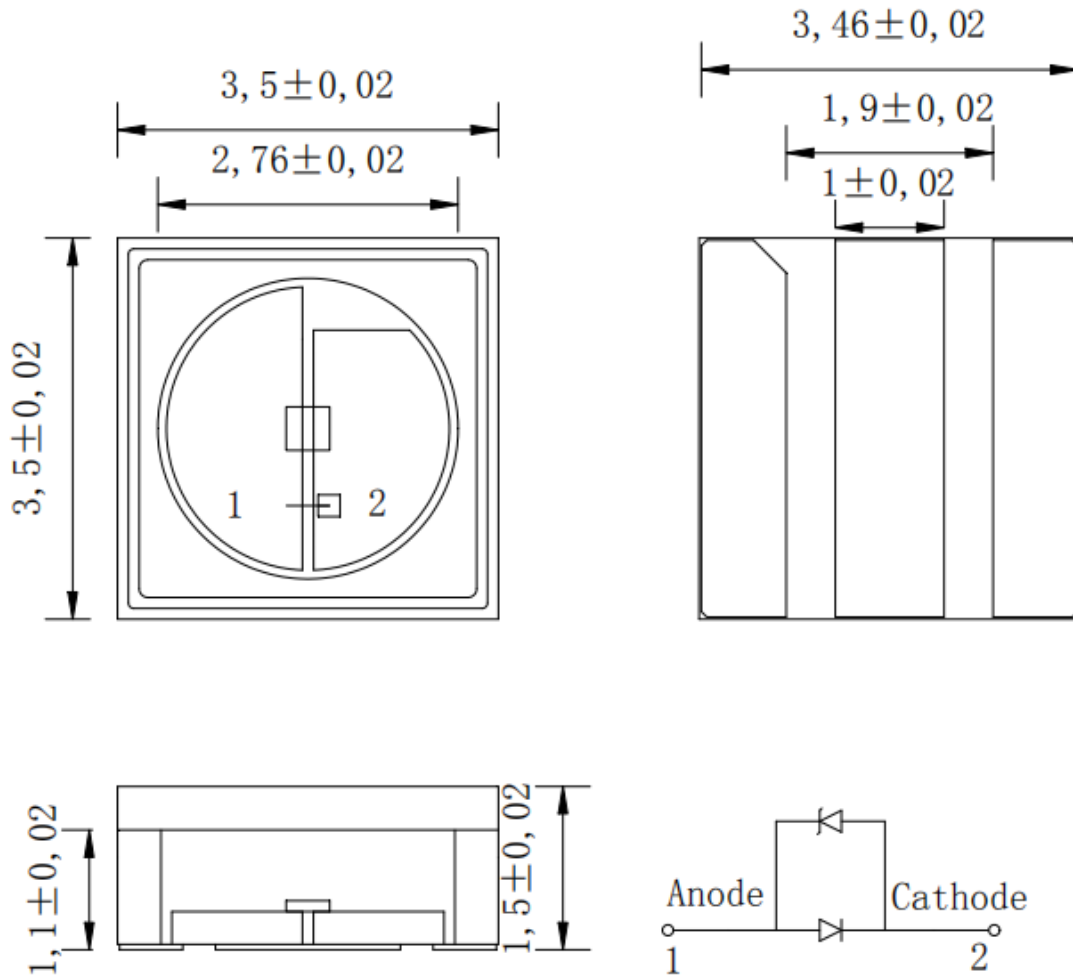

Note:

1. All Dimensions are in millimeters.
2. Heat sink bottom need to use the solder paste welding

3535 SMD LED

ESS-3535UVC275

REV:A /0

FEATURES

- * 3535 SMD LED
- * High reliability
- * Low operating voltage
- * Silicone Packaging
- * PB Free products (Compliant with EU's RoHS)

Application

- * Disinfection / Sterilization
- * Bio-Analysis / Detection
- * Fluorescent Spectroscopy

ABSOLUTE MAXIMUM RATING : (Ta = 25°C)

Symbol	Parameter	Rated	Unit
IFM	Forward Current	100	mA
VR	Reverse Voltage	5	V
PM	Power Consumption	700	mW
Top	Operating Temperature Range	-40~85	°C
Tstg	Storage Temperature Range	-40~85	°C

ELECTRO-OPTICAL CHARACTERISTICS : (Ta = 25°C)

SYMBOL	PARAMETER	TEST CONDITION	Rated	UNIT
λ_p	Peak Wavelength	IF = 40mA	275	nm
Φ_e [3]	Radiant Flux		2-5	mW
VF	Forward Voltage		5-8	v
Δ	Spectrum Half Width		12	nm
2 θ 1/2	View Angle		120	deg

3535 SMD LED

ESS-3535UVC275

REV:A /0

Fig.1 Relative Flux vs.Forward Current

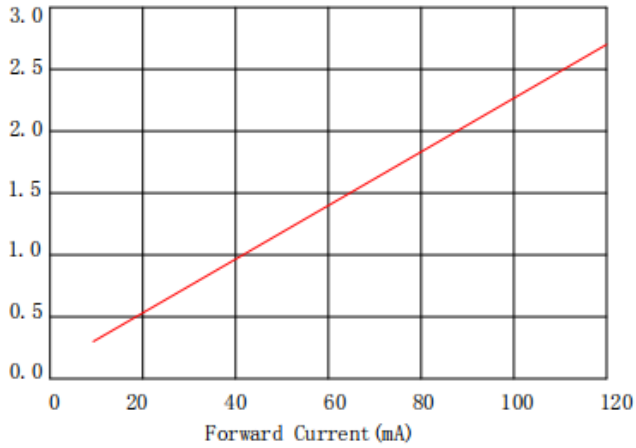

Fig.2 Forward Voltage vs.Forward Current

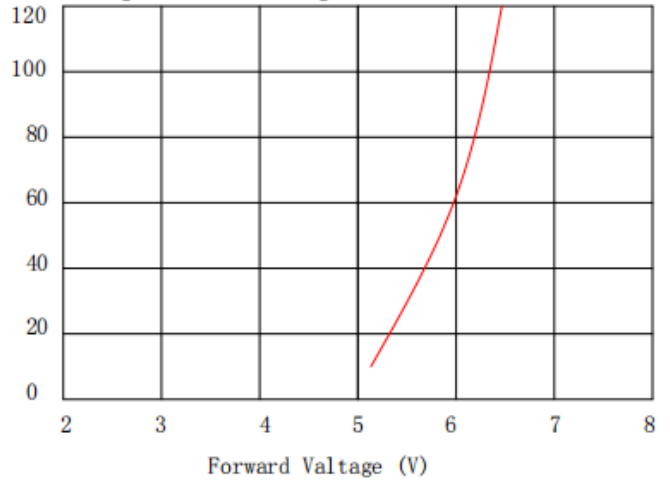

Fig.3 Peak Wavelength vs.Forward Current

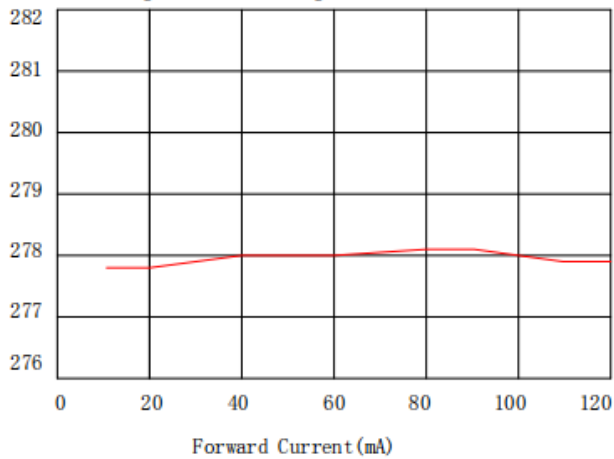
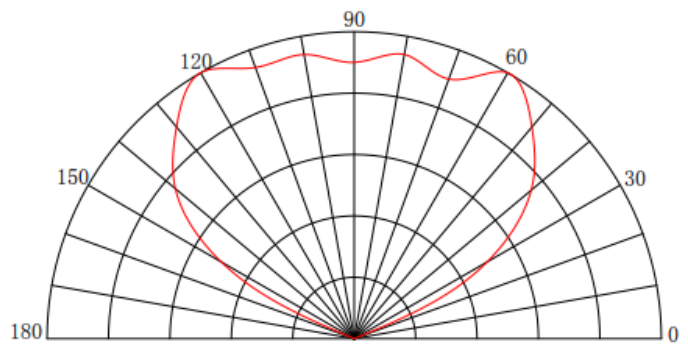
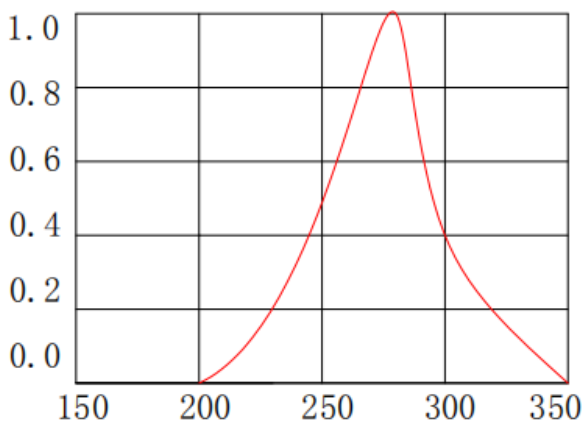
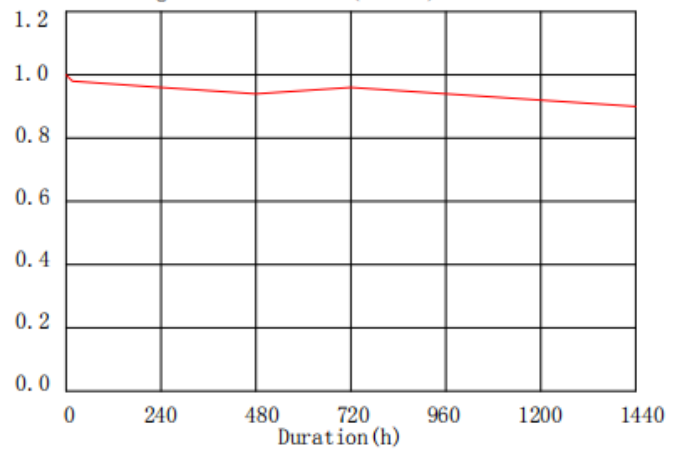

Fig.4 Relative Flux(@100mA) vs.Duration



Peak Wavelength (nm)

Radiation Characteristics

3535 SMD LED

ESS-3535UVC275

REV:A / 0

※ Package Tape Specifications: (1000pcs/Reel)

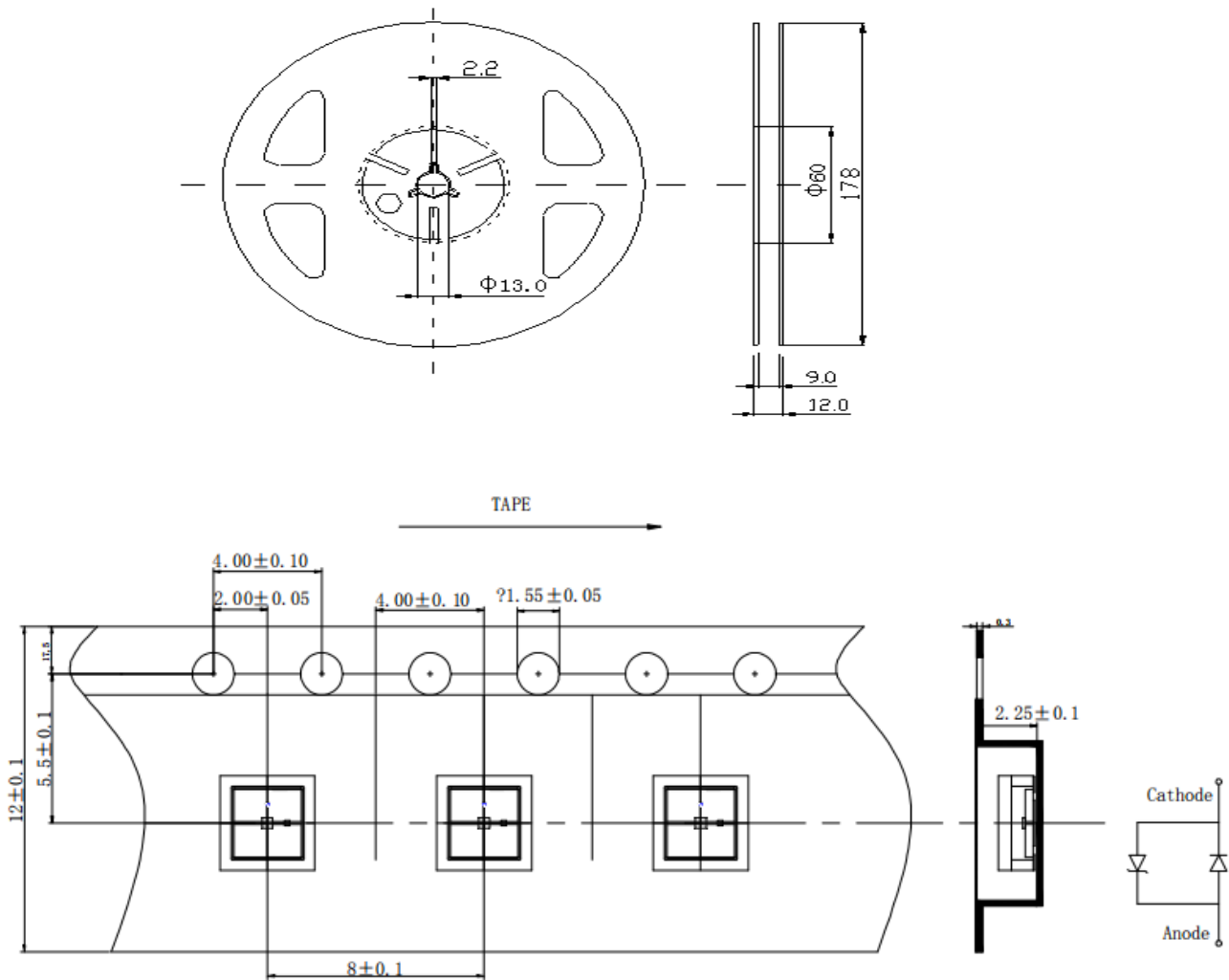

3535 SMD LED

ESS-3535UVC275

REV:A /0

※ Precautions for use :

- 1) Customer must apply the current limiting resistor in the circuit so as to drive the LEDs within the rated current. Otherwise slight voltage shift maybe will cause big current change and burn out will happen.
- 2) Also, caution should be taken not to overload the LEDs with instantaneous high voltage at the turning ON and OFF of the circuit.
- 3) Storage:
 - a) 3.1 Don't open the moisture proof bag before ready to use the LEDs.
 - b) 3.2 The LEDs should be kept at 30°C or less and 60%RH or less before opening the package. The max. storage period before opening the package is 1 year.
 - c) 3.3 After opening the package, the LEDs should be kept at 30°C/35%RH or less, and it should be used within 7 days.
 - d) 3.4 If the LEDs be kept over the conditions of 3.4, baking is required before mounting. Baking condition as below: 60±5°C for 12 hrs.
- 4) Soldering condition:

4.1 Lead Solder:

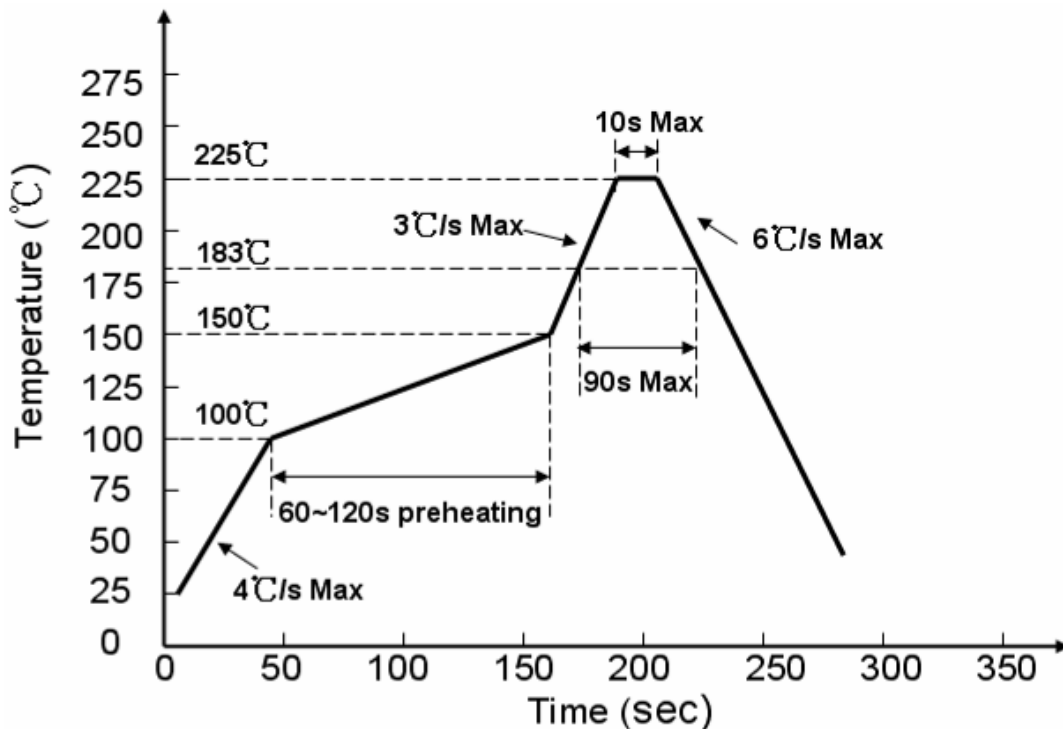

	3535 SMD LED	
	ESS-3535UVC275	REV:A /0

4.2 Lead Free Solder:

Note:

- a) 1.Reflow soldering should not be done more than two times.
- b) 2. Don't put stress on the LEDs when soldering.
- c) 3.Don't warp the circuit board before it have been returned to normal ambient conditions after soldering

Looking for pricing, stock, or lifecycle information?

Click below to explore more details on WIN SOURCE:

- [View ESS-3535UVC275 on WIN SOURCE](#)
- [Shanghai Everstar Electronics Co., Ltd. Information](#)

Optimize Your Supply Chain with WIN SOURCE Solutions

- ✓ Global Sourcing Solution
- ✓ Obsolete Management
- ✓ Cost Control Management
- ✓ Shortage Management
- ✓ Alternative Solution
- ✓ Excess Inventory Management