



**THE DATASHEET OF  
ESS-235A2V112Z1**



Jiangsu Everstar Electronics Co., Ltd.

**Address:**No.6 Xiangshan Rd, Tianmuhu Industry Park, Liyang City, Jiangsu Province, China

**TEL:** +86-519-87557772

**FAX:** +86-519-87557773

**Http:** [www.everstarelect.com](http://www.everstarelect.com)

## DATA SHEET

ESL NO.. : ESS-235A2V112Z1

CUS NO. :

REV : A / 0

Producer: \_\_\_\_\_



Auditor: \_\_\_\_\_

Approver: \_\_\_\_\_



CUSTOMER'S APPROVAL : \_\_\_\_\_

DCC : \_\_\_\_\_

# 3737 SMD LED

ESS-235A2V112Z1

REV:A/0

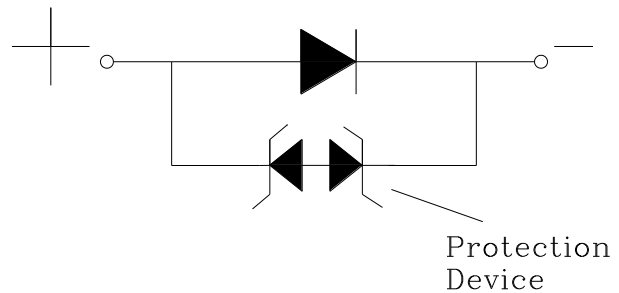
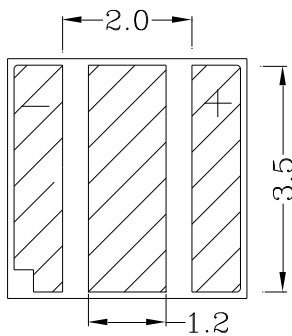
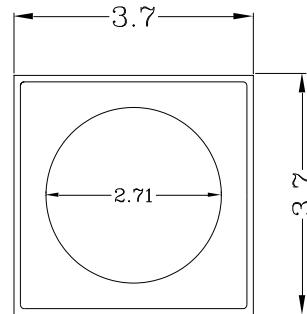
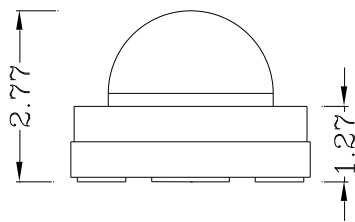

## Note:

1. All Dimensions are in millimeters.
2. This tolerances of drawer are for reference
3. Heat sink bottom need to use the solder paste welding

## Caution:

1. Don't suggest several welding
2. Can lead to reflow Don't expert welding

# 3737 SMD LED

ESS-235A2V112Z1

REV:A /0

## FEATURES

- \* 3737 SMD LED
- \* High reliability
- \* Low operating voltage
- \* Silicone Packaging
- \* PB Free products (Compliant with EU's RoHS)

## Application

- \* UV solidify
- \* Air purge
- \* Medical treatment

## ABSOLUTE MAXIMUM RATING : ( Ta = 25°C )

Symbol	Parameter	Rated	Unit
IFM	Forward Current	1250	mA
IFPM	Pulse Forward Current	1500	mA
VR	Reverse Voltage	5	V
Top	Operating Temperature Range	- 10~85	° C
Tstg	Storage Temperature Range	- 40~100	° C

\* Positive pulse current (Duty-0.1,1KHZ)

## ELECTRO-OPTICAL CHARACTERISTICS : ( Ta = 25°C )

SYMBOL	PARAMETER	TEST CONDITION	MIN.	TYP.	MAX.	UNIT
V <sub>F</sub>	Forward Voltage	I <sub>F</sub> = 1000mA	3.4		3.9	V
I <sub>R</sub>	Reverse Current	V <sub>R</sub> = 5V			5	μA
2θ <sub>1/2</sub>	Half Intensity Angle	I <sub>F</sub> = 1000mA		45		deg
Φ <sub>e</sub>	Radiation flux	I <sub>F</sub> = 1000mA	1400		1800	mW
λ <sub>D</sub>	Dominant Wavelength	I <sub>F</sub> =1000mA	380		390	nm

# 3737 SMD LED

ESS-235A2V112Z1

REV:A /0

WLD	Forward Voltage	Radiation flux	
		1400-1600	1600-1800
380-385	3.4-3.5	A2001	A2002
	3.5-3.6	A2005	A2006
	3.6-3.7	A2009	A2010
	3.7-3.8	A2013	A2014
	3.8-3.9	A2017	A2018
385-390	3.4-3.5	A2033	A2034
	3.5-3.6	A2037	A2038
	3.6-3.7	A2041	A2042
	3.7-3.8	A2045	A2046
	3.8-3.9	A2049	A2050

# 3737 SMD LED

## ESS-235A2V112Z1

REV:A /0

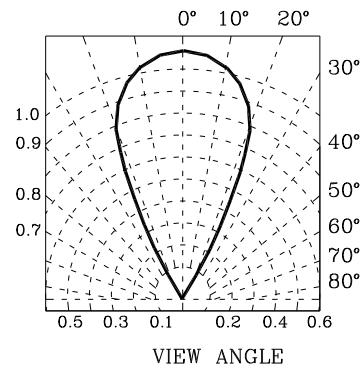
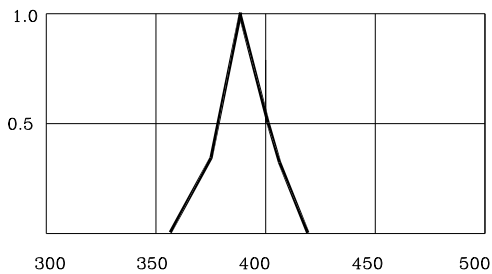
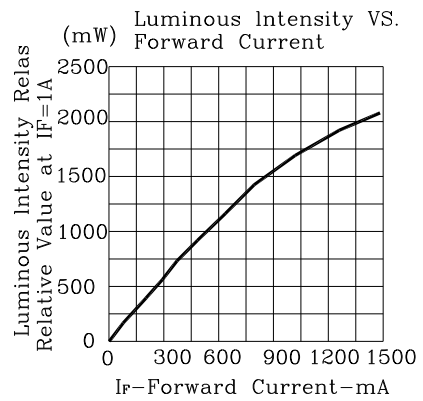
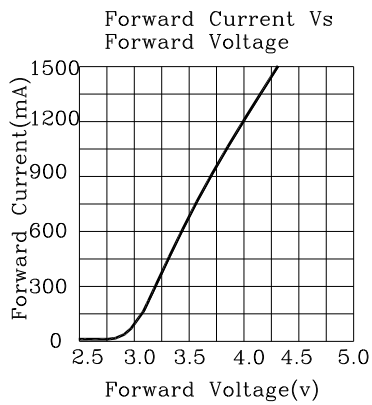

# 3737 SMD LED

ESS-235A2V112Z1

REV:A /0

## ※ Precautions for use :

- 1) Customer must apply the current limiting resistor in the circuit so as to drive the LEDs within the rated current. Otherwise slight voltage shift maybe will cause big current change and burn out will happen.
- 2) Also, caution should be taken not to overload the LEDs with instantaneous high voltage at the turning ON and OFF of the circuit.
- 3) Storage:
  - a) 3.1 Don't open the moisture proof bag before ready to use the LEDs.
  - b) 3.2 The LEDs should be kept at 30°C or less and 60%RH or less before opening the package. The max. storage period before opening the package is 1 year.
  - c) 3.3 After opening the package, the LEDs should be kept at 30°C/35%RH or less, and it should be used within 7 days.
  - d) 3.4 If the LEDs be kept over the conditions of 3.4, baking is required before mounting. Baking condition as below:  $60 \pm 5^\circ\text{C}$  for 12 hrs.
- 4) Soldering condition:

### 4.1 Lead Solder:

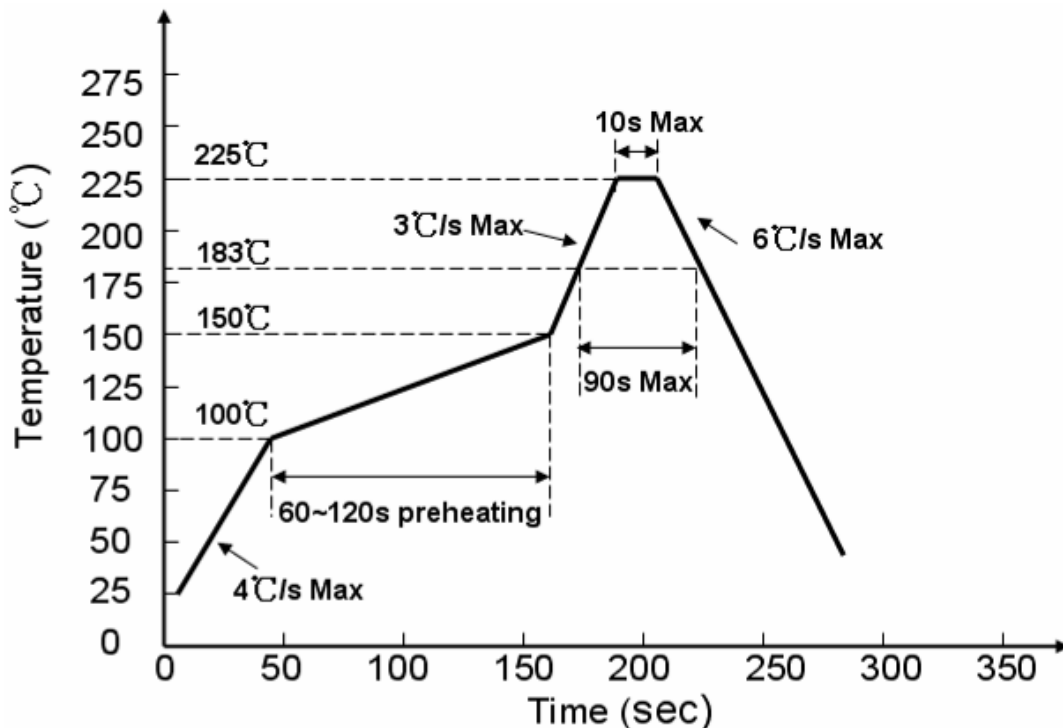

3737 SMD LED

ESS-235A2V112Z1

REV:A /0

**4.2 Lead Free Solder:**

**Note:**

- a) 1.Reflow soldering should not be done more than two times.
- b) 2. Don't put stress on the LEDs when soldering.
- c) 3.Don't warp the circuit board before it have been returned to normal ambient conditions after soldering

## Looking for pricing, stock, or lifecycle information?

Click below to explore more details on WIN SOURCE:

- ⊖ [View ESS-235A2V112Z1 on WIN SOURCE](#)
- ⊖ [Shanghai Everstar Electronics Co., Ltd. Information](#)

## Optimize Your Supply Chain with WIN SOURCE Solutions

- ✓ Global Sourcing Solution
- ✓ Obsolete Management
- ✓ Cost Control Management
- ✓ Shortage Management
- ✓ Alternative Solution
- ✓ Excess Inventory Management