



**THE DATASHEET OF
ESS-3535RGB-L**





Jiangsu Everstar Electronics Co., Ltd.
Address: No.111 Tianmu Rd, Tianmuhu Town, Liyang City, Jiangsu Province, China
TEL: +86-519-87557772 FAX: +86-519-87557773
Http: www.everstarelect.com

DATA SHEET

ESL NO.. :ESS-3535RGB-L

CUSNO.. :

REV : A / 0

Producer: Eden

Auditor: _____

Approver: Jack

CUSTOMER'S APPROVAL : _____

DCC : _____



3535 RGB SMD LED

ESS-3535RGB-L

REV:A / 0

※ **Features**

- 1.Ceramics wafer encapsulated with lens, height 2.01mm
- 2.Low Thermal Resistance
- 3.Super Energy Efficiency
- 4.High reliability
- 5.Half Angle ($2\Theta_{1/2}$):120°
- 6.RoHS Compliant.
- 7.Moisture sensitivity level: Level 3

※ **Applications**

- 1.Advertisement
- 2.Architectural Lighting
- 3.Street Lamps
- 4.Other Lighting

※ Package Outline Dimension:

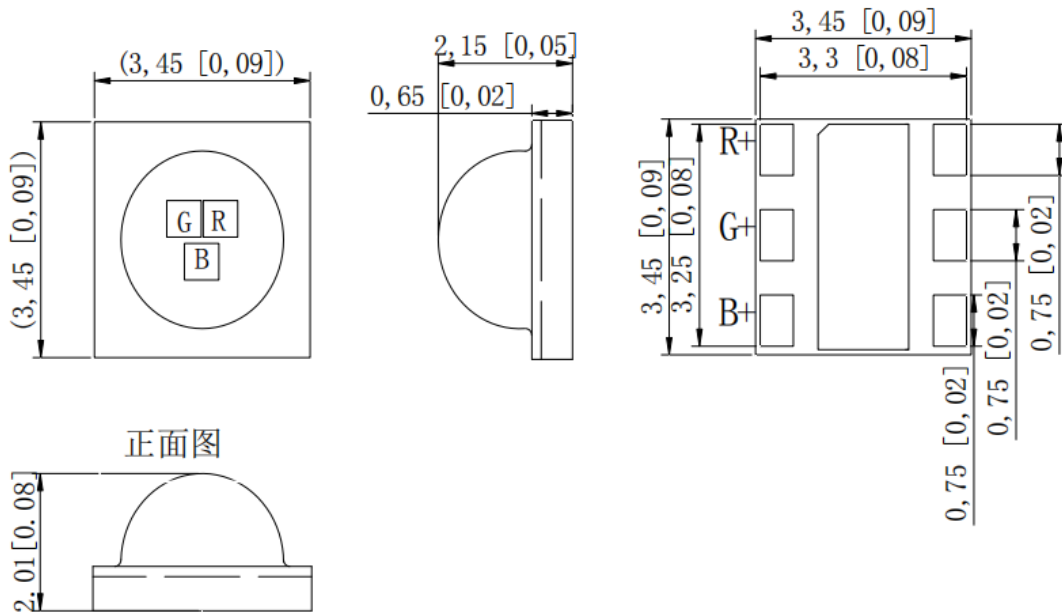

Recommended Solder Pad

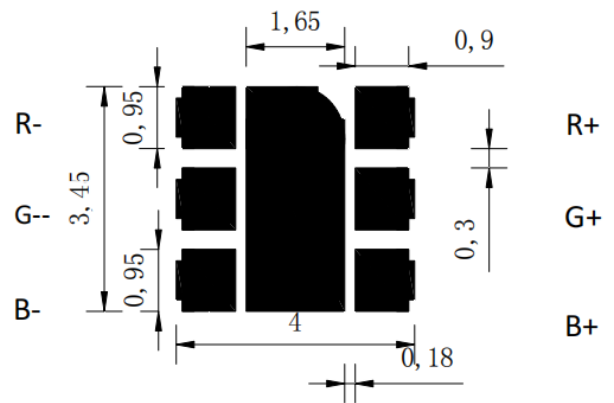
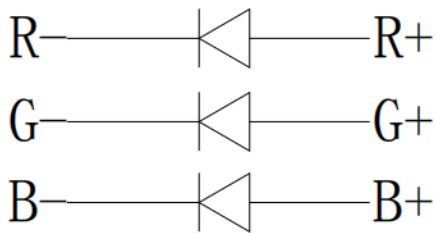

Note:

All Dimensions are in millimeters.



3535 RGB SMD LED

ESS-3535RGB-L

REV:A / 0

※ Absolute Maximum Ratings(Ta=25°C)

Symbol	Parameter	Red	Green	Blue	UNIT
PAD	Power Dissipation	1	1	1	W
VR	Reverse Voltage	5	5	5	V
IF	Average Forward Current(Duty-0.1,1KHZ)	400	500	500	mA
Topr	Operating Temperature Range	-45°C to 85°C			
Tstg	Storage Temperature Range	-40°C to 90°C			
Tsol	Solder temperature	3 seconds under 260 °C			



3535 RGB SMD LED

ESS-3535RGB-L

REV:A / 0

※ Electrical-optical characteristics(Ta=25°C)

SYMBOL	DESCRIPTION	TEST CONDITION	MIN.	TYP.	MAX.	UNIT	
Vf	Forward Voltage	IF=350mA	Green	2.9		3.4	V
			Blue	2.9		3.4	
			Red	2.0		2.4	
IR	Reverse Current	VR=5 V	Green			5	μ A
			Blue			5	
			Red			5	
λD	Dominant Wavelength	IF=350mA	Green	520		530	nm
			Blue	455		465	
			Red	620		630	
2 θ 1/2	Half Intensity Angle	IF=350mA	G/R/B		120	deg	
IV	Luminous Intensity	IF=350mA	Green	100		120	lm
			Blue	20		30	
			Red	40		60	



3535 RGB SMD LED

ESS-3535RGB-L

REV:A / 0

※ Typical Electro-Optical Characteristics Curves

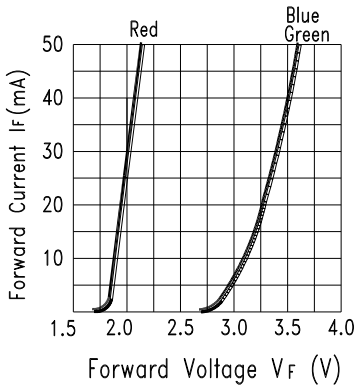
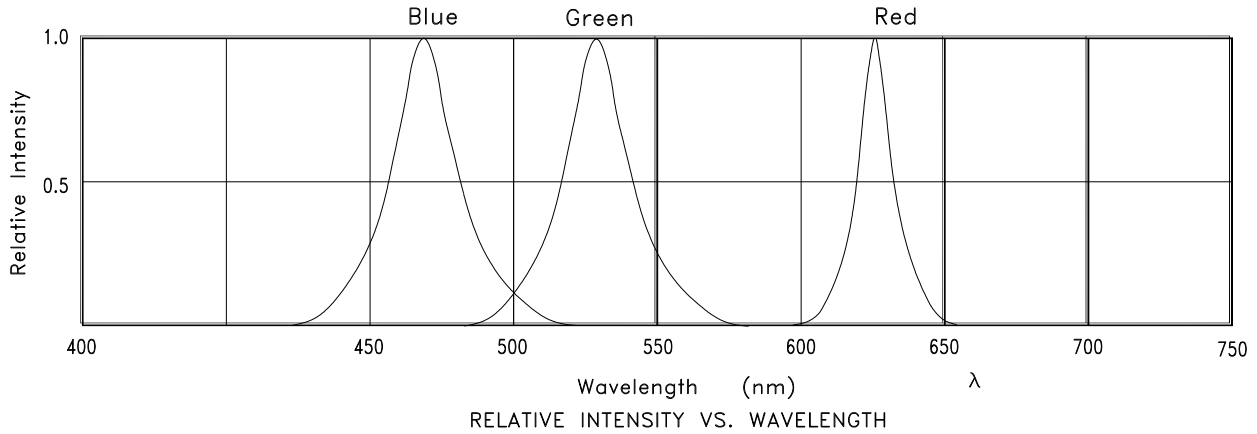

Fig.2 Forward Current vs. Forward Voltage

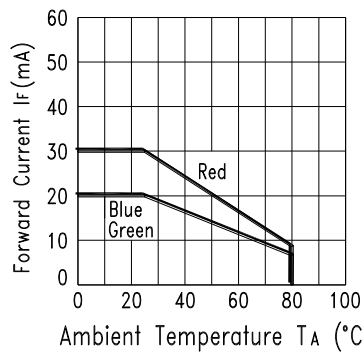

Fig.3 Forward Current Derating Curve

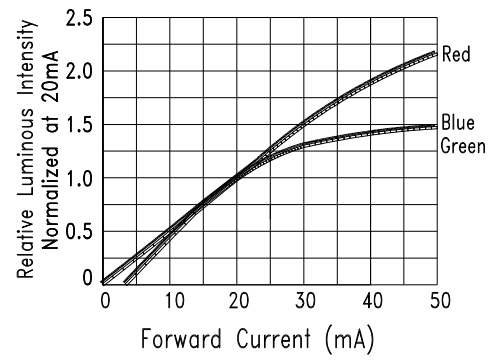

Fig.4 Relative Luminous Intensity vs. Forward Current

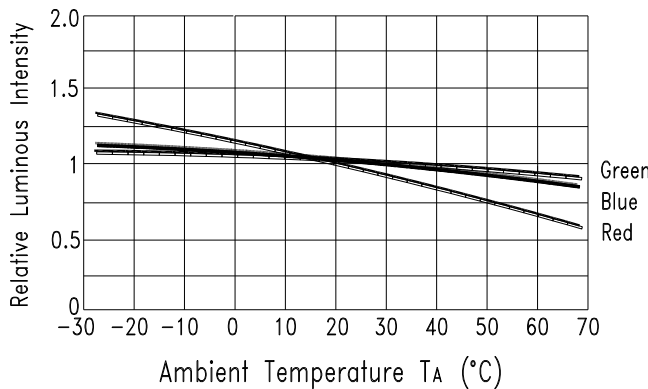

Fig.5 Luminous Intensity vs. Ambient Temperature

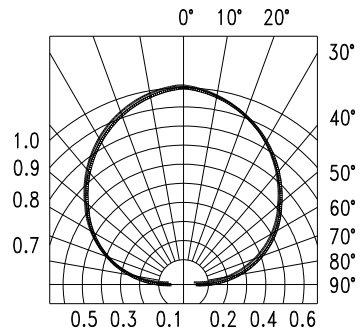
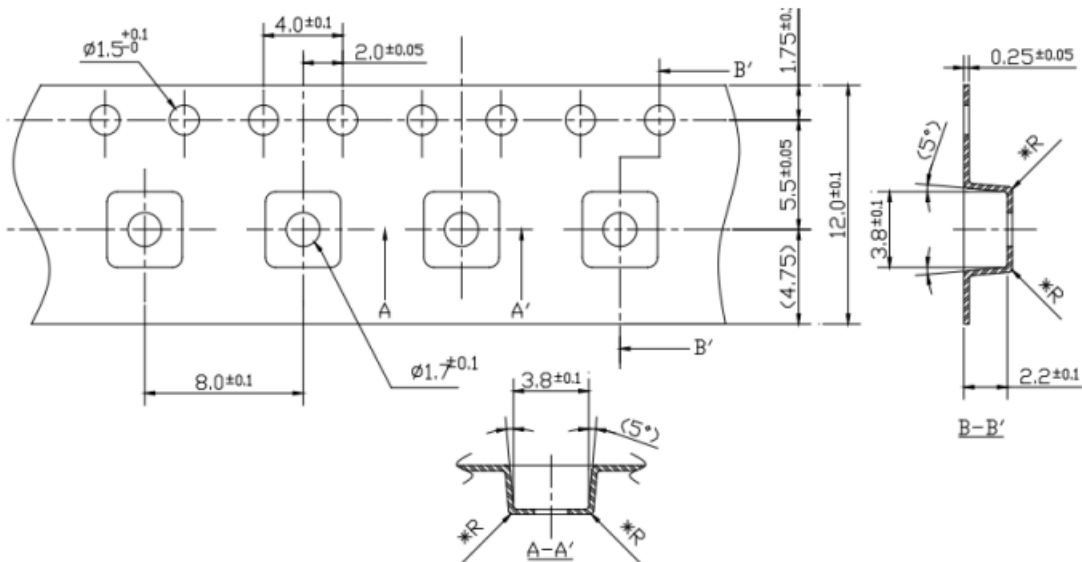
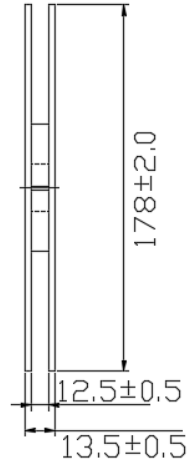
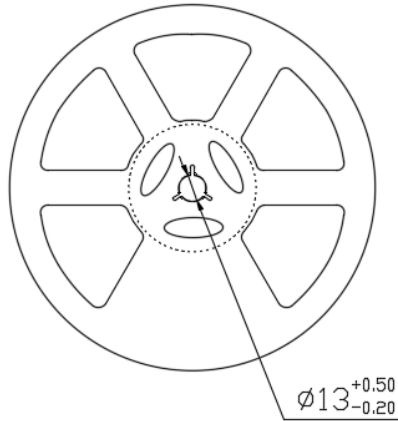

Fig.6 Spatial Distribution

※ Reel Dimensions(1000 pcs/Reel)





3535 RGB SMD LED

ESS-3535RGB-L

REV:A / 0

※ Precautions for use :

1. Customer must apply the current limiting resistor in the circuit so as to drive the LEDs within the rated current. Otherwise slight voltage shift maybe will cause big current change and burn out will happen.
2. Also, caution should be taken not to overload the LEDs with instantaneous high voltage at the turning ON and OFF of the circuit.
3. Storage:
 - 3.1 Don't open the moisture proof bag before ready to use the LEDs.
 - 3.2 The LEDs should be kept at 30°C or less and 60%RH or less before opening the package. The max. storage period before opening the package is 1 year.
 - 3.3 After opening the package, the LEDs should be kept at 30°C/35%RH or less, and it should be used within 7 days.
 - 3.4 If the LEDs be kept over the conditions of 3.4, baking is required before mounting. Baking condition as below: 60±5°C for 12 hrs.
4. Soldering condition:

4.1 Lead Solder:

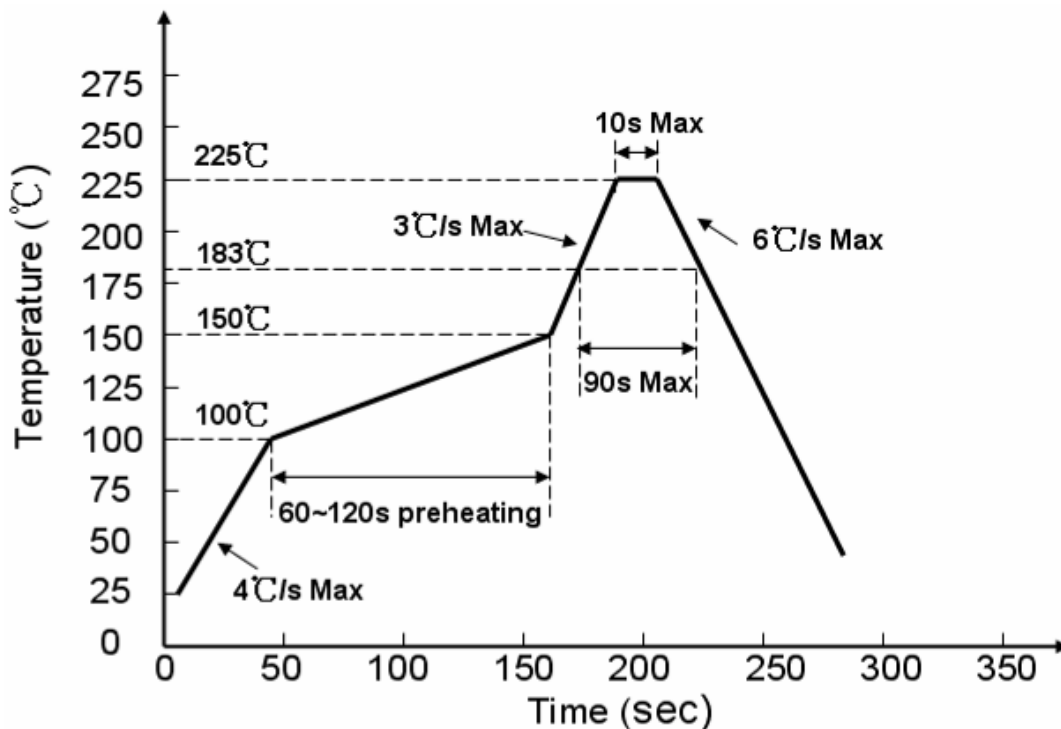



3535 RGB SMD LED

ESS-3535RGB-L

REV:A / 0

4.2 Lead Free Solder:

Note:

- 1.Reflow soldering should not be done more than two times.
- 2. Don' t put stress on the LEDs when soldering.
- 3.Don' t warp the circuit board before it have been returned to normal ambient conditions after soldering

Looking for pricing, stock, or lifecycle information?

Click below to explore more details on WIN SOURCE:

- [View ESS-3535RGB-L on WIN SOURCE](#)
- [Shanghai Everstar Electronics Co., Ltd. Information](#)

Optimize Your Supply Chain with WIN SOURCE Solutions

- ✓ Global Sourcing Solution
- ✓ Obsolete Management
- ✓ Cost Control Management
- ✓ Shortage Management
- ✓ Alternative Solution
- ✓ Excess Inventory Management