

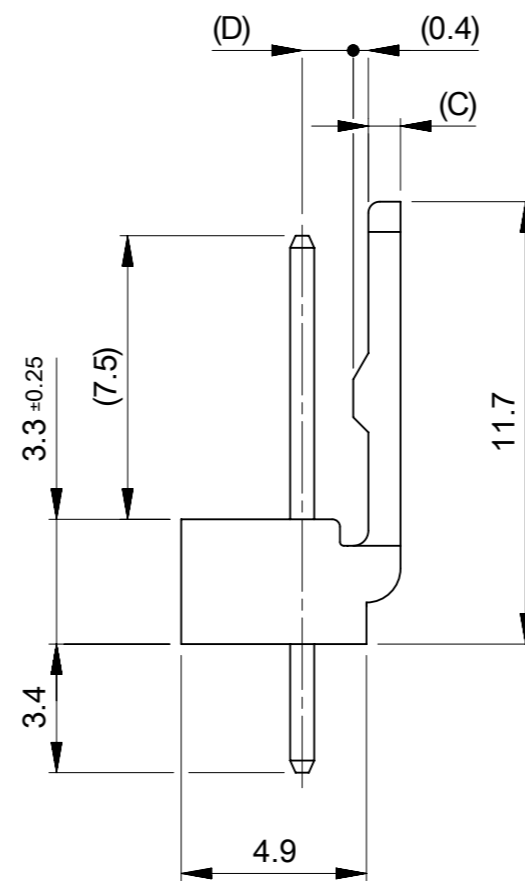

**THE DATASHEET OF**  
**0022041101**

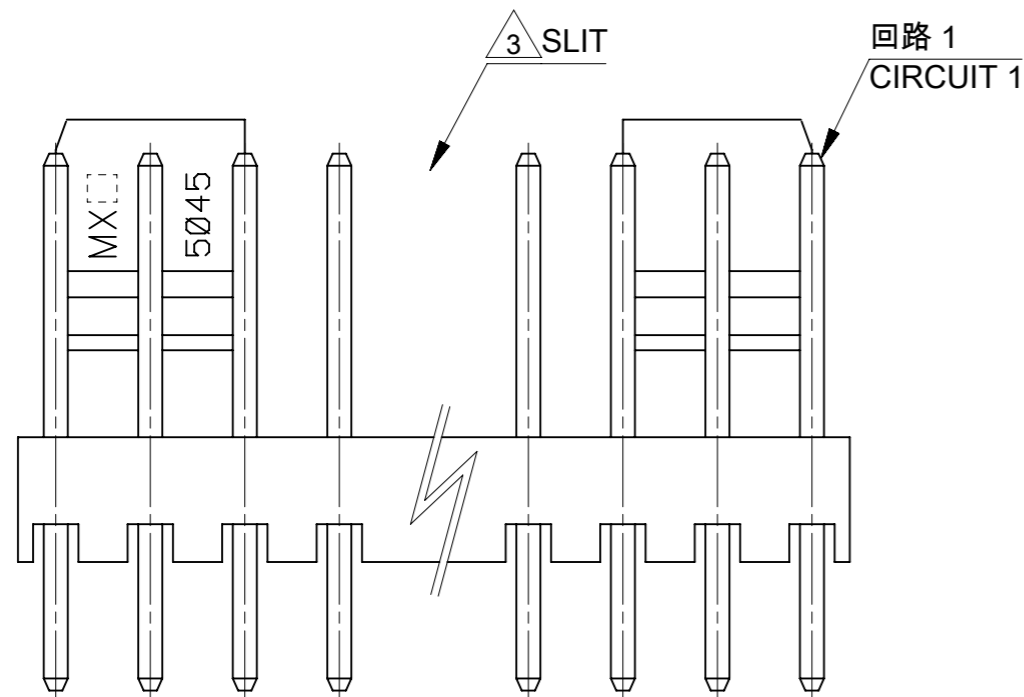

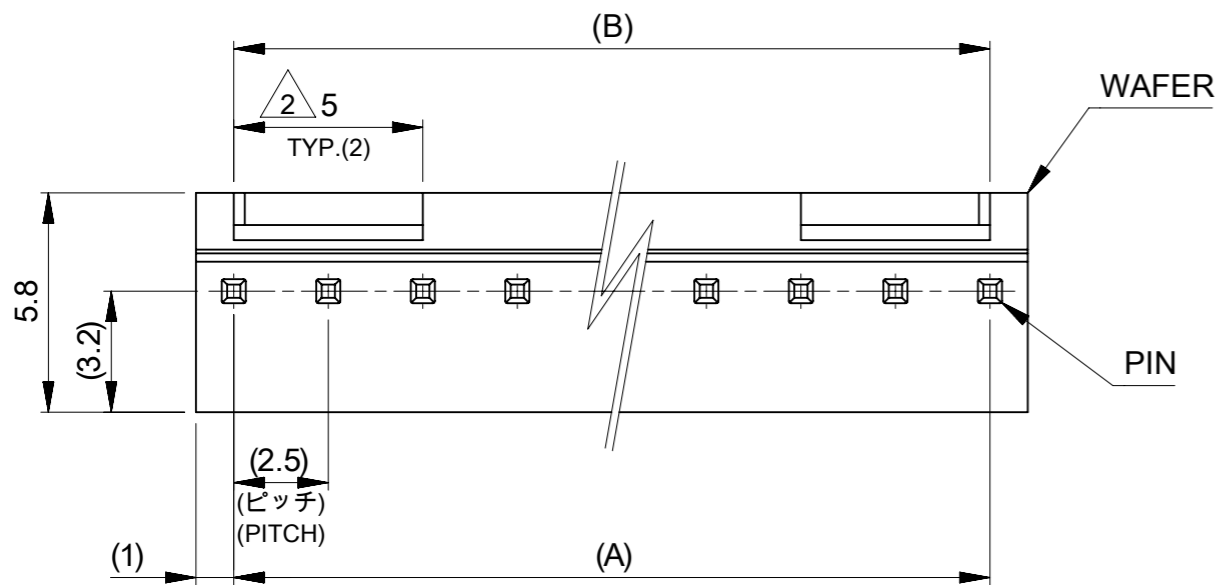

注記  
NOTES:

- 材料(MATERIAL)  
 ウェハー : ポリアミド, UL94V-0 (色: アイボリー)  
 WAFER: POLYAMIDE, UL94V-0 (COLOR: IVORY)  
 ピン: □0.635 黄銅、銅下地錫めっき  
 PIN: □0.635 BRASS, TIN OVER COPPER PLATING  
 △2 6極以上に適合。  
 TO BE APPLIED FOR 6 CKT. AND ABOVE.  
 △3 5極以下はロック部スリットなし。  
 NO SLIT IS PROVIDED FOR 5 CKT. AND LESS THAN 5 CKT.

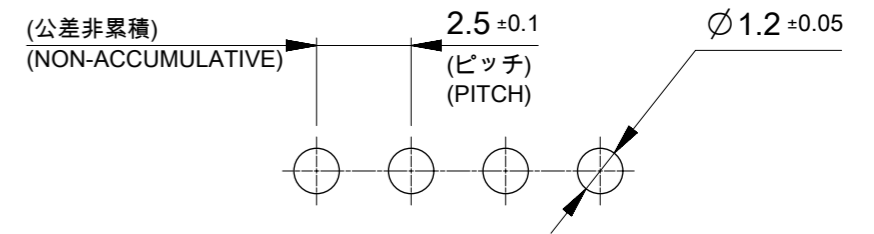

基板取付穴推奨寸法  
RECOMMENDED P.C. BOARD HOLE DIM.

1.35	0.85	35	35	22041151	5045-15A	15
1.35	0.85	32.5	32.5	22041141	5045-14A	14
1.35	0.85	30	30	22041131	5045-13A	13
1.35	0.85	27.5	27.5	22041121	5045-12A	12
1.35	0.85	25	25	22041111	5045-11A	11
1.35	0.85	22.5	22.5	22041101	5045-10A	10
1.35	0.85	20	20	22041091	5045-09A	9
1.35	0.85	17.5	17.5	22041081	5045-08A	8
1.35	0.85	15	15	22041071	5045-07A	7
1.35	0.85	12.5	12.5	22041061	5045-06A	6
1.35	0.85	10	10	22041051	5045-05A	5
1.35	0.85	7.5	7.5	22041041	5045-04A	4
1.2	1	5	5	22041031	5045-03A	3
1.2	1	2.5	2.5	22041021	5045-02A	2
(D)	(C)	(B)	(A)	ORDER NO.	ENG. NO.	CKT.

THIS DRAWING CONTAINS INFORMATION THAT IS PROPRIETARY TO MOLEX ELECTRONIC TECHNOLOGIES, LLC AND SHOULD NOT BE USED WITHOUT WRITTEN PERMISSION

DIMENSION UNITS	SCALE	CURRENT REV DESC: REVISED		<b>molex</b>		
mm	5:1					
GENERAL TOLERANCES (UNLESS SPECIFIED)				MINI-LATCH 2.5 HEADER ASSEMBLY VT WITH LOCK TIN PLATING		
ANGULAR TOL ± 3.0°				PRODUCT CUSTOMER DRAWING		
4 PLACES	± 0.4	EC NO: 758980	2023/07/18	DOCUMENT NUMBER		
3 PLACES	± 0.4	DRWN: HHUSSIN	2024/03/13	DOC TYPE DOC PART REVISION		
2 PLACES	± 0.4	CHK'D: SAKIYAMA	2024/03/14	SD-5045-NA		
1 PLACE	± 0.4	APPR: AIDA	2024/03/14	PSD 001 N		
0 PLACES	± 0.4	INITIAL REVISION:		MATERIAL NUMBER		
DRAFT WHERE APPLICABLE MUST REMAIN WITHIN DIMENSIONS		DRWN: KKOHAMA	2000/03/27	CUSTOMER		
THIRD ANGLE PROJECTION		APPR: NUKITA	2013/06/13	GENERAL MARKET		
DRAWING		SERIES		SHEET NUMBER		
A3-SIZE		5045		1 OF 1		

## Looking for pricing, stock, or lifecycle information?

Click below to explore more details on WIN SOURCE:

 [View 0022041101 on WIN SOURCE](#)

 [Molex, LLC Information](#)

## Optimize Your Supply Chain with WIN SOURCE Solutions

-  Global Sourcing Solution
-  Obsolete Management
-  Cost Control Management
-  Shortage Management
-  Alternative Solution
-  Excess Inventory Management