

3M™ Mini D Ribbon (MDR) Connectors

.050" Plastic Shielded Junction Shell for Round Cable

103 Series



- Durable one piece plastic over two piece metal junction shell for straight round cable (compatible with 101XX-6000 EC plug)
- Quick release latching
- MDR digital LCD Interface as a 20 or 26 contact connector
- Contacts: 14, 20, 26, 36, 40, 50 and 68
- RoHS* compliant

Date Modified: January 31, 2006

TS-0571-07
Sheet 1 of 2

Physical

Outer Shell

Material: ABS
Flammability: UL 94V-0
Color: Beige, Medium Gray, and Black

Inner Shell

Material: Steel, .020" [0.5 mm] Thick
Plating: Nickel
Marking: 3M Logo and Part Number

"RoHS compliant" means that the product or part does not contain any of the following substances in excess of the following maximum concentration values in any homogeneous material, unless the substance is in an application that is exempt under RoHS: (a) 0.1% (by weight) for lead, mercury, hexavalent chromium, polybrominated biphenyls or polybrominated diphenyl ethers; or (b) 0.01% (by weight) for cadmium. Unless otherwise stated by 3M in writing, this information represents 3M's knowledge and belief based upon information provided by third party suppliers to 3M.

3M™ Mini D Ribbon (MDR) Connectors

.050" Plastic Shielded Junction Shell for Round Cable

103 Series

Contact Quantity	Dimensions						
	A	B	C	D	E	F	G
14	.76 [19.4]	1.15 [29.3]	1.02 [25.9]	1.30 [33.0]	.57 [14.5]	.25 [6.3]	.67 [17.1]
20	.91 [23.2]	1.15 [29.3]	1.17 [29.7]	1.30 [33.0]	.57 [14.5]	.26 [6.7]	.82 [20.9]
26	1.06 [27.0]	1.15 [29.3]	1.32 [33.5]	1.30 [33.0]	.57 [14.5]	.28 [7.1]	.97 [24.8]
36	1.31 [33.3]	1.01 [25.6]	1.57 [39.8]	1.26 [32.0]	.63 [16.0]	.32 [8.1]	1.22 [31.1]
40	1.41 [35.8]	.98 [24.8]	1.67 [42.4]	1.26 [32.0]	.63 [16.0]	.32 [8.2]	1.32 [33.6]
50	1.66 [42.2]	.98 [24.8]	1.92 [48.7]	1.26 [32.0]	.63 [16.0]	.34 [8.7]	1.57 [40.0]
68	2.11 [53.6]	.98 [24.8]	2.37 [60.1]	1.26 [32.0]	.71 [18.0]	.36 [9.1]	2.02 [51.4]

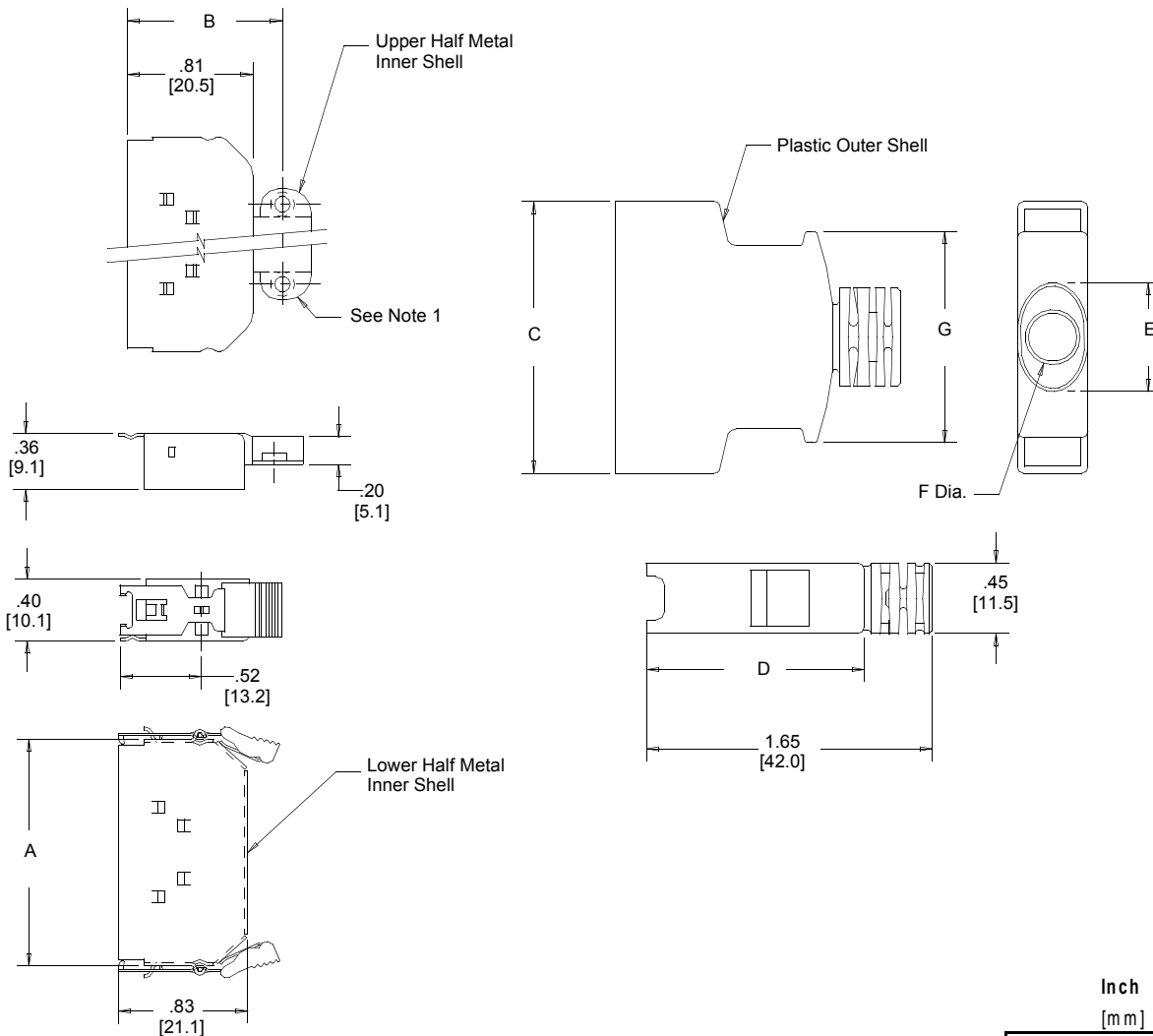

Notes:

1. Part number includes a cable clamp and 2X M2.6 screws. These parts are not shown.
2. Panel thickness including washers must be less than 2.0 mm.

Inch [mm]			
Tolerance Unless Noted			
	.0	.00	.000
inch	±.1	±.01	±.005

[] Dimensions for Reference Only

Ordering Information

103XX-3210-00X

Contact Quantity
(See Table)

Color Code:
0 = Beige (Standard)
3 = Medium Gray (Special)
6 = Black (Special)

TS-0571-07
Sheet 2 of 2

Important Notice

All statements, technical information, and recommendations related to 3M's products are based on information believed to be reliable, but the accuracy or completeness is not guaranteed. Before using this product, you must evaluate it and determine if it is suitable for your intended application. You assume all risks and liability associated with such use. Any statements related to the product which are not contained in 3M's current publications, or any contrary statements contained on your purchase order shall have no force or effect unless expressly agreed upon, in writing, by an authorized officer of 3M.



3M Electronics

6801 River Place Blvd.
Austin, TX 78726-9000
800/225-5373
www.3M.com/electronics

Warranty; Limited Remedy; Limited Liability.

This product will be free from defects in material and manufacture for a period of one (1) year from the time of purchase. **3M MAKES NO OTHER WARRANTIES INCLUDING, BUT NOT LIMITED TO, ANY IMPLIED WARRANTY OF MERCHANTABILITY OR FITNESS FOR A PARTICULAR PURPOSE.** If this product is defective within the warranty period stated above, your exclusive remedy shall be, at 3M's option, to replace or repair the 3M product or refund the purchase price of the 3M product. **Except where prohibited by law, 3M will not be liable for any indirect, special, incidental or consequential loss or damage arising from this 3M product, regardless of the legal theory asserted.**



Minimum 10%
Post-Consumer Fiber

Printed in USA.

© 3M 2006

Looking for pricing, stock, or lifecycle information?

Click below to explore more details on WIN SOURCE:

 [View 10314-3210-006 on WIN SOURCE](#)

 [3M Information](#)

Optimize Your Supply Chain with WIN SOURCE Solutions

-  Global Sourcing Solution
-  Obsolete Management
-  Cost Control Management
-  Shortage Management
-  Alternative Solution
-  Excess Inventory Management