



**THE DATASHEET OF
10131934-210ULF**



PRODUCT DESCRIPTION CODE :

10131934-YXXXLF

PLATING :
 ———— R_oHS COMPATIBLE, SEE NOTE 3
 ———— PACKAGING : "U" : TUBE
 ———— TOTAL NUMBER OF POSITIONS 02 TO 25

1 = 0.76 μm GOLD ON CONTACT AREA
 2.54μm MIN MATTE TIN ON TAIL

2 = 0.38μm GOLD ON CONTACT AREA
 2.54μm MIN MATTE TIN ON TAIL

3 = 0.20μm GOLD ON CONTACT AREA
 2.54μm MIN MATTE TIN ON TAIL

4 = 0.76 μm GXT ON CONTACT AREA
 2.54μm MIN MATTE TIN ON TAIL

5 = 0.38μm GXT ON CONTACT AREA
 2.54μm MIN MATTE TIN ON TAIL

6 = 0.20μm GXT ON CONTACT AREA
 2.54μm MIN MATTE TIN ON TAIL

9 = 2.54μm MIN MATTE TIN FULL PLATED
 1.27μm NICKEL MIN UNDERLAYER

NOTES :

1 - MATERIAL
 HOUSING : HIGH TEMPERATURE GLASS FILLED FLAME
 RETARDANT PER UL 94 V-0
 TERMINAL: COPPER ALLOY

2- TO DETERMINE DIMENSIONS :
 N = NUMBER OF POSITIONS PER ROW
 EXAMPLE : 8 POS N x 2 = 16mm
 UP TO N = 12 TOLERANCE : 0
 -0.10
 FROM N = 13 TOLERANCE : 0.05
 -0.10

3 - R_oHS COMPATIBLE PRODUCT SPECIFICATIONS
 a - PLATING :
 "LF" MEANS THE PRODUCT IS LEAD-FREE, 2μm MINIMUM MATTE TIN
 OVER 1.27μm MINIMUM NICKEL UNDERPLATE
 b - MANUFACTURING PROCESS COMPATIBILITY
 THE HOUSING WILL WITHSTAND EXPOSURE TO 260°C ±5°C SOLDER BATH
 TEMPERATURE FOR 5 SECONDS IN A WAVE SOLDER APPLICATION WITH A
 1.6mm MIN THICK CIRCUIT BOARD.

c - LABELLING :
 MEETS PACKAGING SPECS AS PER GS-14-920
 d - LEGAL STATEMENT : SEE GS-47-0004

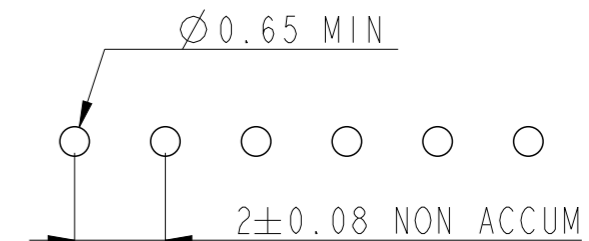

RECOMMENDED HOLE PATTERN

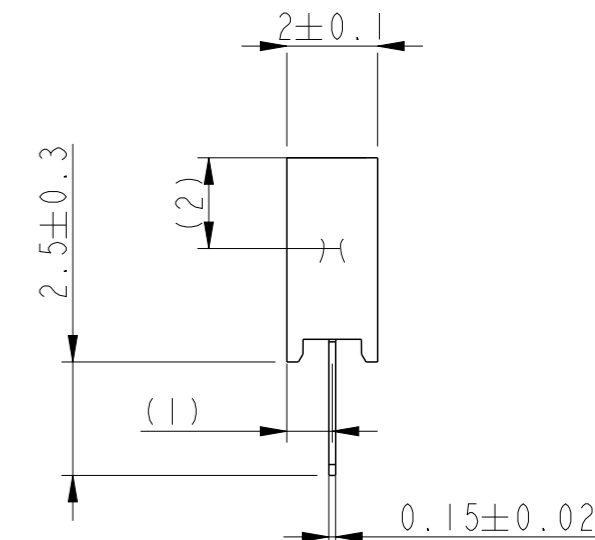
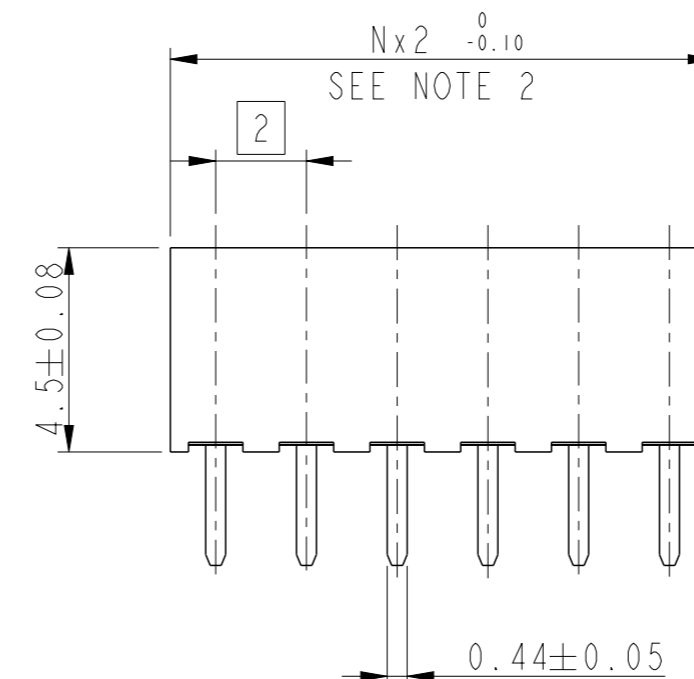
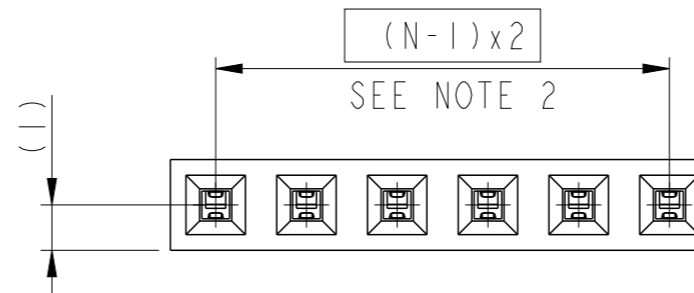

PRELIMINARY

spec ref	GS-12-1326	dr	Cyril Jeune	2014/12/02	projection	mm	size	A3	scale	6:1
tolerance std	ISO 406 ISO 1101	eng	Benoit Vernier	2015/11/16			ecn no	-	rel level	Preliminary
TOLERANCES UNLESS OTHERWISE SPECIFIED		chr	-	-						
surface	ISO 1302	appr	-	-	product family	-	dwg no	10131934	rev	2
	linear				MINITEK RECEPTACLE 2MM					
	angular				ASSEMBLY VCC SR TMT					
	0.X ±	www.fci.com		cat. no.	-	Product - Customer Drw	sheet 1 of 1			
	0.XX ±									
	0.XXX ±									
	0° ±									



Copyright FCI.

Looking for pricing, stock, or lifecycle information?

Click below to explore more details on WIN SOURCE:

 [View 10131934-210ULF on WIN SOURCE](#)

 [Amphenol FCI Information](#)

Optimize Your Supply Chain with WIN SOURCE Solutions

-  Global Sourcing Solution
-  Obsolete Management
-  Cost Control Management
-  Shortage Management
-  Alternative Solution
-  Excess Inventory Management