



**THE DATASHEET OF
10057542-1111FLF**



NOTES:

- 1. MATERIAL: PHOSPHOR BRONZE
CONTACT: UL 94V-0 PBT, 30%GF
BASE: UL 94V-0 LCP, 50%GF (ONLY FOR 10057542-1311XLF)
COVER: UL 94V-0 PBT, 30%GF
COVER: UL 94V-0 LCP, 50%GF (ONLY FOR 10057542-1311XLF)
- 2. PLATING:
GOLD PLATING:SEE PART NUMBER DEFINITION.
120u" MATTE PURE TIN IN SOLDER TAIL AREA;
50u" NICKEL UNDERPLATE OVER ALL SURFACES.
- 3. THIS PRODUCT MEETS EUROPEAN UNION DIRECTIVES AND OTHER COUNTRY REGULATIONS AS DESCRIBED IN GS-22-008.
- 4. GENERAL TOLERANCE: 0 mm TO 10 mm: ±0.15 mm
10 mm TO 30 mm: ±0.20 mm
30 mm TO 60 mm: ±0.3 mm
>60 mm: ±0.5 mm
- 5. FLATNESS CONTROL WITHIN 0.25mm MAX.
- 6. THE HOUSING WILL WITHSTAND EXPOSURE TO 260 °C PECK TEMPERATURE FOR 10 SECONDS IN A WAVE SOLDER APPLICATION WITH A 1.6mm MINIMUM THICK CIRCUIT BOARD USE PROTECTIVE ADHESIVE TAPE (KAPTON OR TEFLON) OR PROTECTIVE METALLIC DEVICES ON THE AREAS WHICH ARE DIRECTLY EXPOSED TO WAVE SOLDERING AS IT IS USED IN CLASSICAL LEADED WAVE SOLDERING
- 7. CUSTOMER CAN FREE CHOOSE THE TWO HOLES ACCORDING TO THEIR REQUIREMENT

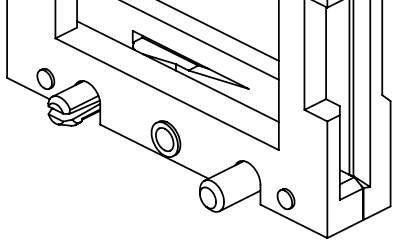

Copyright FCI.

PART NUMBER SCHEME:
10057542-XXXXXLF

- SENSOR TYPE:
F: BLADE CONTACTS N
A: BLADE CONTACTS N
GOLD PLATING THICKN
1: 0.4um.
2: 0.8um.
NUMBER OF CONTACTS
1: 8
PROFILE TYPE:
1: STANDARD PROFILE(I
2: LOW PROFILE(HEIGHT
3: DIFFERENT FOOTS FC
COVER COLOR:
1: BLACK.

D

www.ficconnect.com

Dr	AILEI ZHANG	06/22/05
Eng	AILEI ZHANG	06/22/05
Chr	AILEI ZHANG	06/22/05
Appr	JASON ZHOU	06/22/05

FCI SMART CART

catalog no

rev	ecn no	dr	date
G	NI0-0242	SH	2010-12-27
-	-	-	-
-	-	-	-
-	-	-	-
-	-	-	-

REV F - 2008-04-17

PDM: Rev: C

PRODUCT NUMBER
10057542-111XXLF

CRIMPING PART TO USE
WITH A THICKNESS PCB
OF 1.6 HOLES $\phi=3.2\pm0.06$

ϕ 0.05 | A | B

$\phi 3\pm0.2$

ϕ 0.05 | A | B

22.16

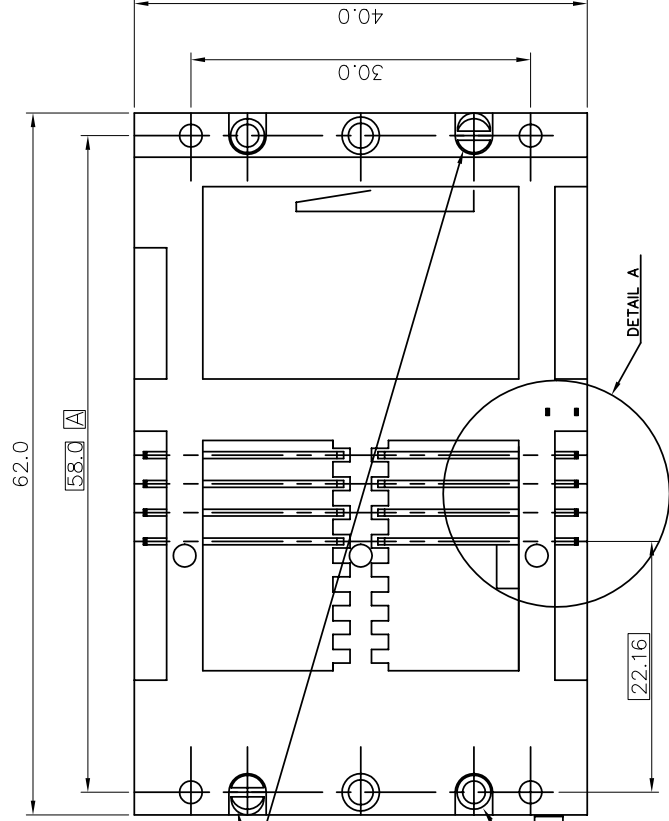

4- $\phi 3.2\pm0.06$
 ϕ 0.05

Note 8 $\phi 2-\phi 2.2$



C

Copyright FCI.

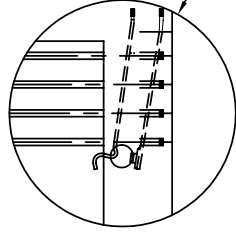
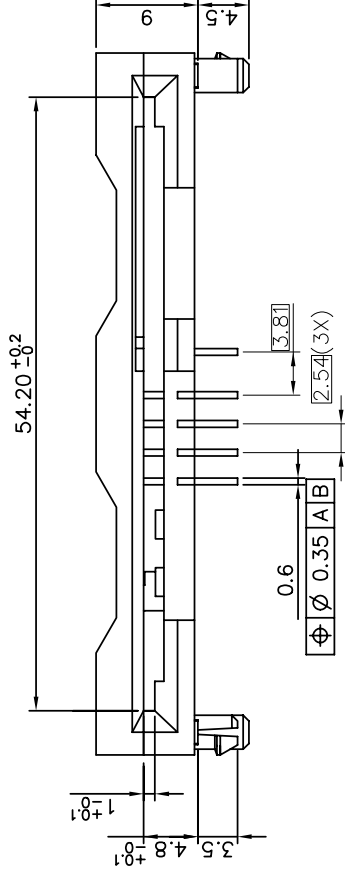

SENSOR TYPE:
A: BLADE CONTACTS NORMALLY OPEN.

REV: F - 2006-04-17

1

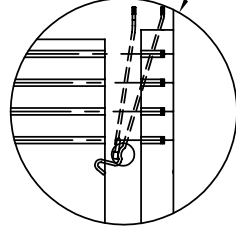

SENSOR TYPE:
F: BLADE CONTACTS NORMALLY CLOSED.

2

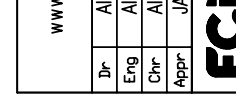

SMART CART

catalog no

www.fciconnect.com

Dr	AILEI ZHANG	06/22/05
Eng	AILEI ZHANG	06/22/05
Chr	AILEI ZHANG	06/22/05
Appr	JASON ZHOU	06/22/05

PDM: Rev: C

3

2

1

A

B

D

PRODUCT NUMBER
10057542-121XXLF

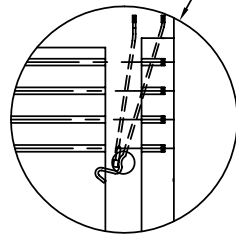
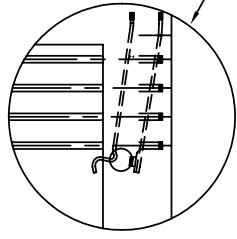
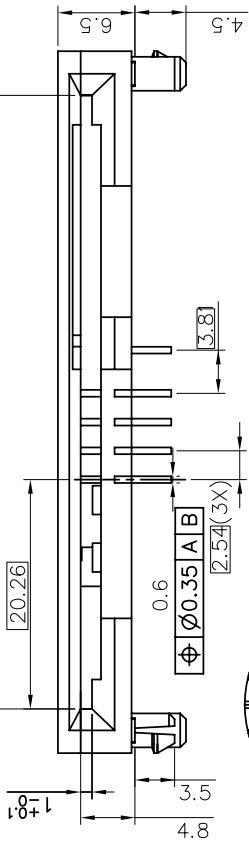
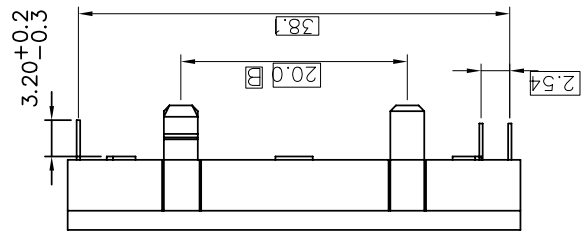
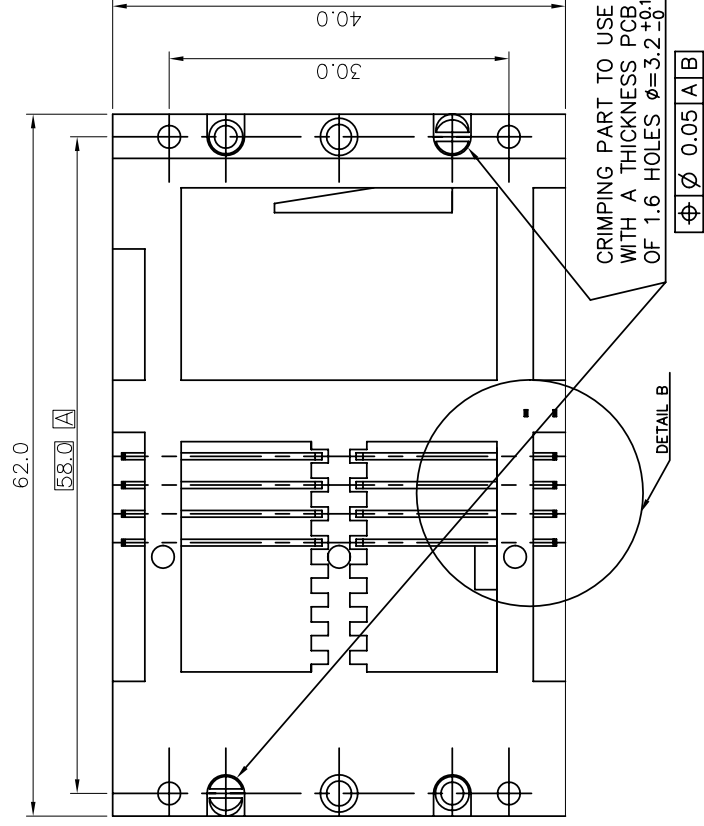

SENSOR TYPE:
A: BLADE CONTACTS NORMALLY OPEN.

SENSOR TYPE:
F: BLADE CONTACTS NORMALLY CLOSED.

www.fciconnect.com

Dr	AILEI ZHANG	06/22/05
Eng	AILEI ZHANG	06/22/05
Chr	AILEI ZHANG	06/22/05
Appr	JASON ZHOU	06/22/05

FCI SMART CART
catalog no

REV F - 2005-04-17

1

2

3

PDM: Rev: C

Copyright FCI.

PRODUCT NUMBER
10057542-131XXLF

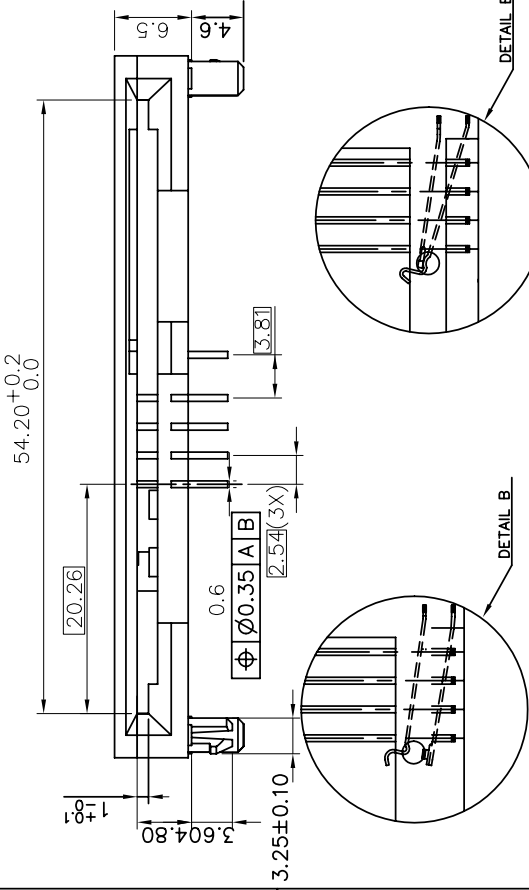
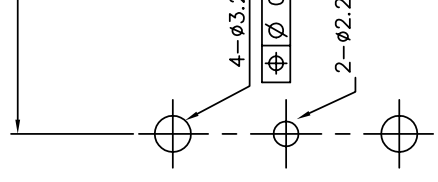
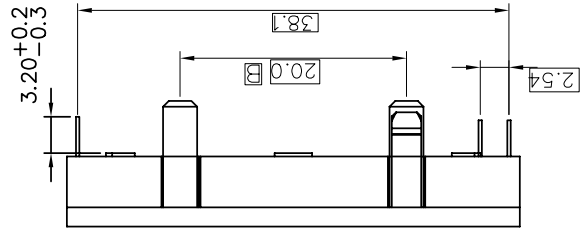
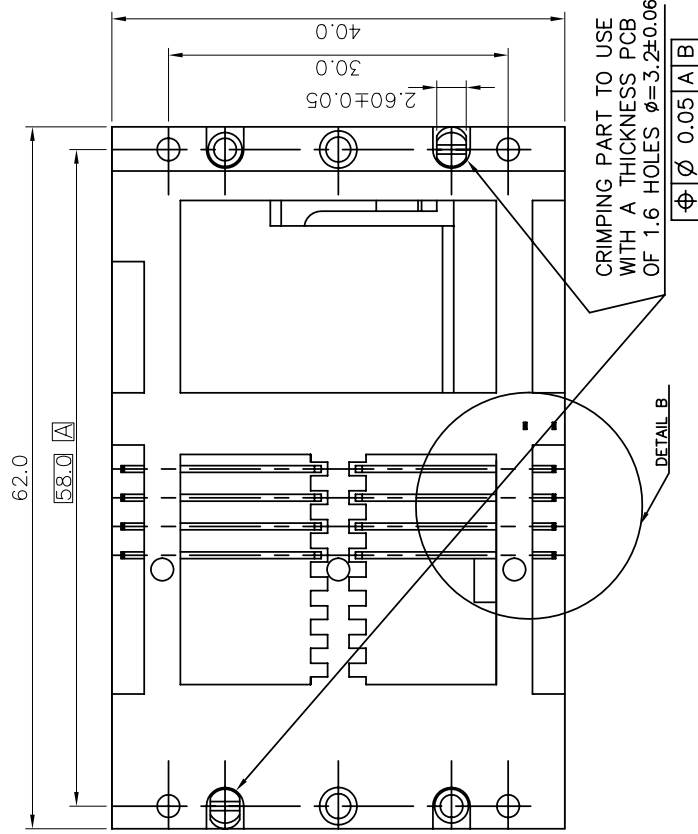

SENSOR TYPE:
A: BLADE CONTACTS NORMALLY OPEN.

SENSOR TYPE:
F: BLADE CONTACTS NORMALLY CLOSED.

www.fciconnect.com

Dr	AILEI ZHANG	06/22/05
Eng	AILEI ZHANG	06/22/05
Chr	AILEI ZHANG	06/22/05
Appr	JASON ZHOU	06/22/05

FCI

SMART CART

catalog no

REV F - 2005-04-17

1

2

1



3

PDM: Rev: C

Copyright FCI.

Looking for pricing, stock, or lifecycle information?

Click below to explore more details on WIN SOURCE:

-  [View 10057542-1111FLF on WIN SOURCE](#)
-  [Amphenol Information](#)

Optimize Your Supply Chain with WIN SOURCE Solutions

-  Global Sourcing Solution
-  Obsolete Management
-  Cost Control Management
-  Shortage Management
-  Alternative Solution
-  Excess Inventory Management