

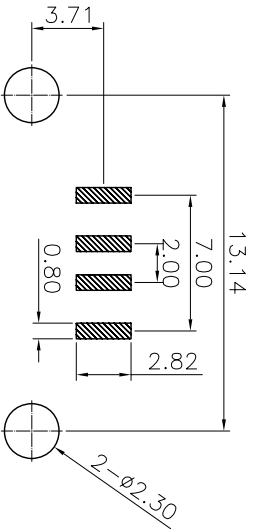

THE DATASHEET OF
1002-002-01100

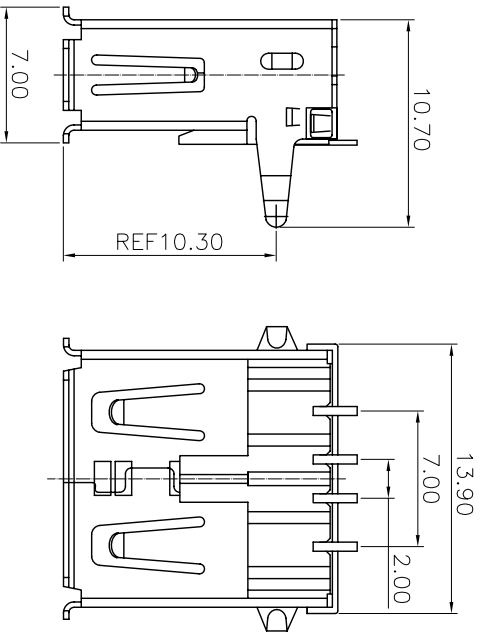



1. MATERIAL:
CONTACTS: PHOSPHOR BRONZE
INSULATOR: LCP+30% G.F. UL 94V-0
SHELL: BRASS
2. MECHANICAL:
MATING: 35N MAX.
WITHDRAWAL FORCE: 10N MIN
DURABILITY: 1500 CYCLES MIN
3. ELECTRICAL:
CURRENT-MAX[AMPS] 1.5A
VOLTAGE-MAX[VOLTS] 30V
WITHSTANDING VOLTAGE 500V AC
CONTACT RESISTANCE[OHMS] 30milliohms max
INSULATION RESISTANCE [OHMS] 1000 MEGOHMS MIN
4. PLATING:
CONTACTS: GOLD FLASH AND TIN OVER NICKEL PLATED
SHELL: NICKEL OVER ALL PLATING
5. ENVIRONMENTAL
TEMPERATURE RANGE: -55°C+50°C

| | | | | | |
|----------|-------|---------|-------------|------|------|
| 09/12/17 | ING | | NEW DWG | | A1 |
| DATE | DR.BY | ECN.NO. | DESCRIPTION | MARK | VER. |

CnC Tech, LLC

*TOLERANCES-
UNLESS OTHERWISE SPECIFIED
公差參考表



TITLE: USB 4P A/F SMT 5U"成品

| | | | | | | | | | |
|-------|-------|--------|-------|--------|----------------------------|-------|------|------|------|
| X.X | ±0.38 | X.X° | ±2° | APPD: | PRODUCT NO: 1002-002-01100 | | | | |
| X.XX | ±0.25 | X.XX° | ±1° | CHECK: | DATE | SCALE | UNIT | TYPE | PAGE |
| X.XXX | ±0.13 | X.XXX° | ±0.5° | DRAW: | 2009.12.17 | 1:1 | mm | Z | 1/1 |

RECOMMENDED P.C.B. PATTERN LAYOUT

4 5 6 7 8 9 10

Looking for pricing, stock, or lifecycle information?

Click below to explore more details on WIN SOURCE:

- [View 1002-002-01100 on WIN SOURCE](#)
- [CNC Tech Information](#)

Optimize Your Supply Chain with WIN SOURCE Solutions

- ✓ Global Sourcing Solution
- ✓ Obsolete Management
- ✓ Cost Control Management
- ✓ Shortage Management
- ✓ Alternative Solution
- ✓ Excess Inventory Management