

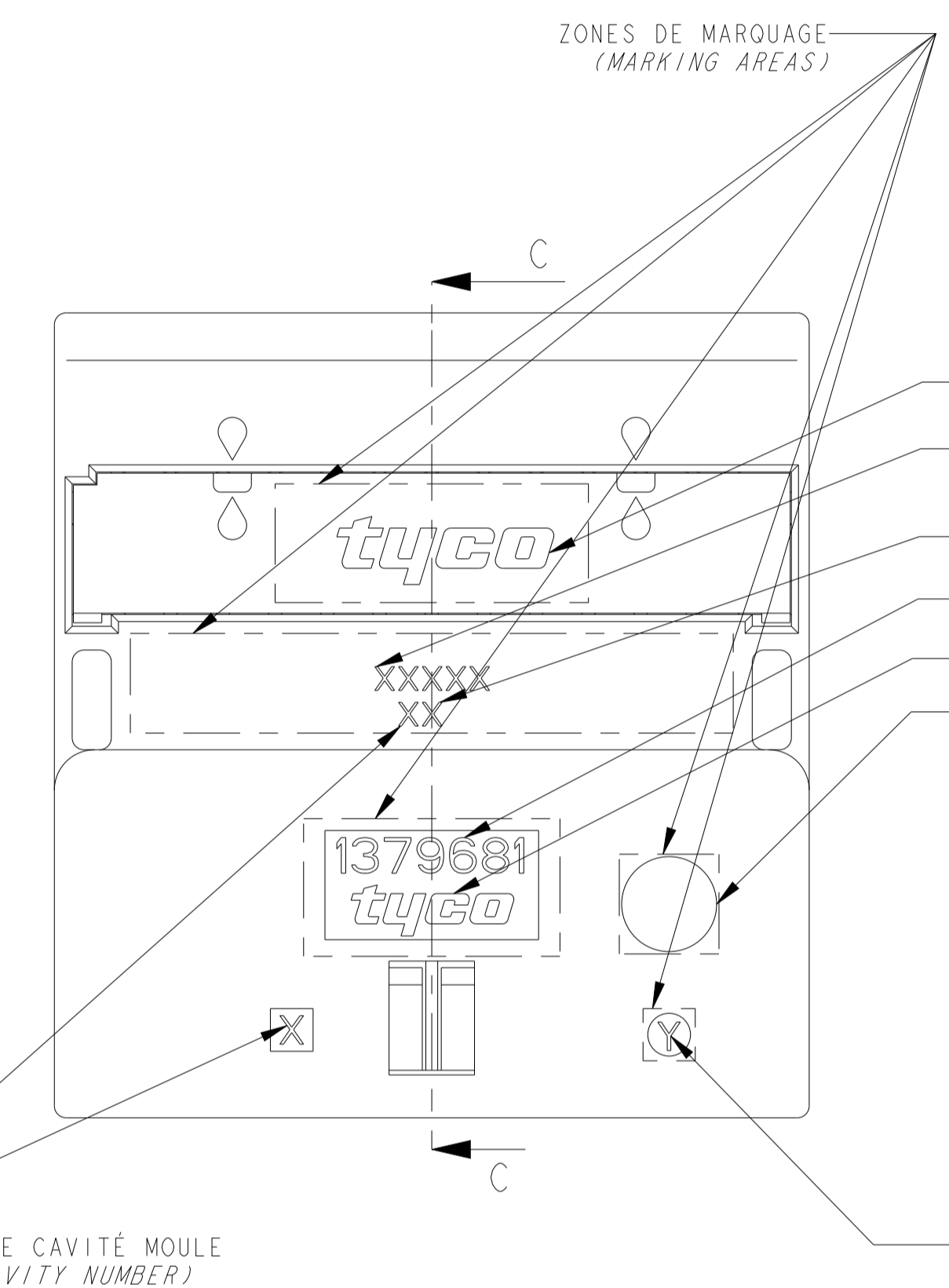

THE DATASHEET OF
1379681-1

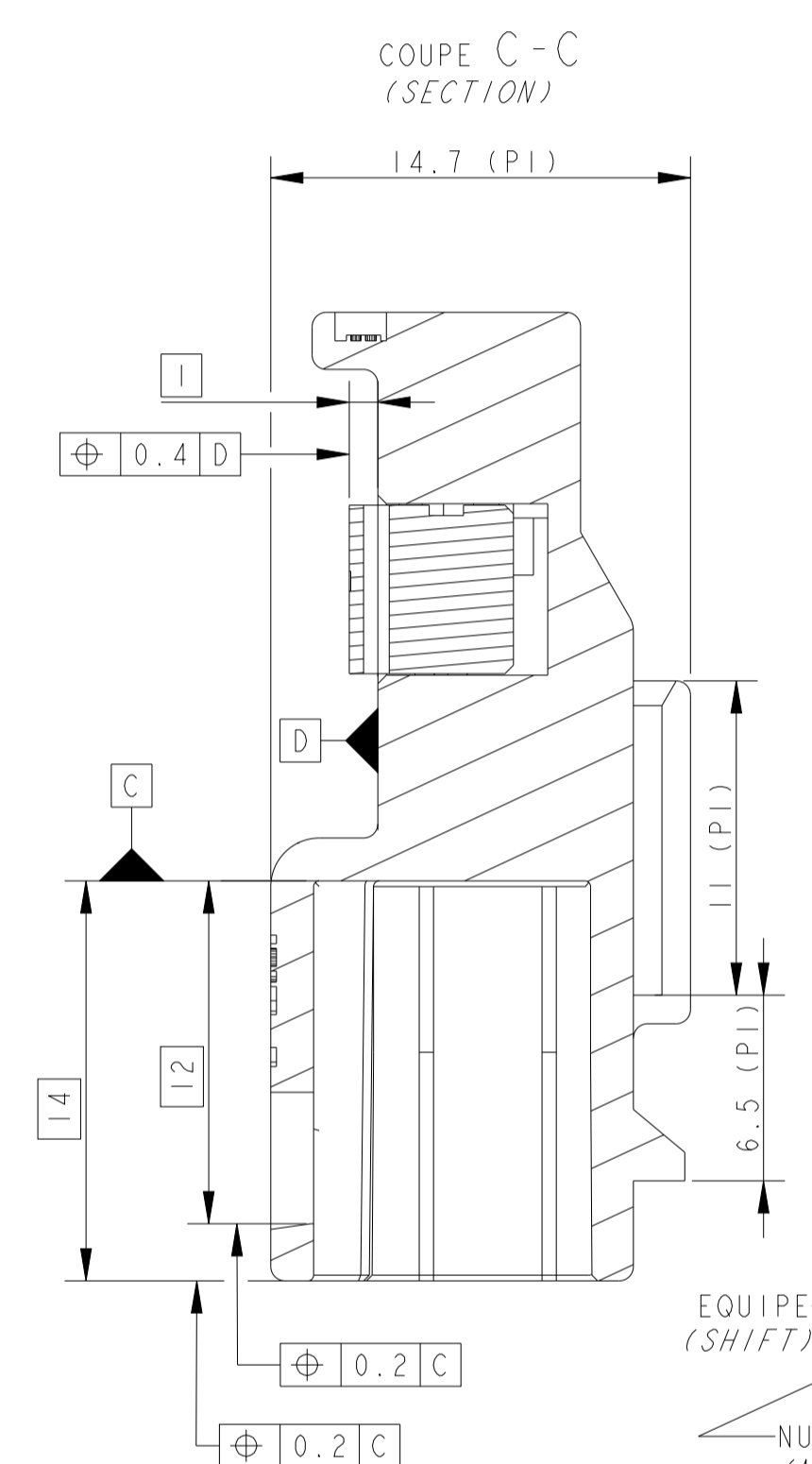

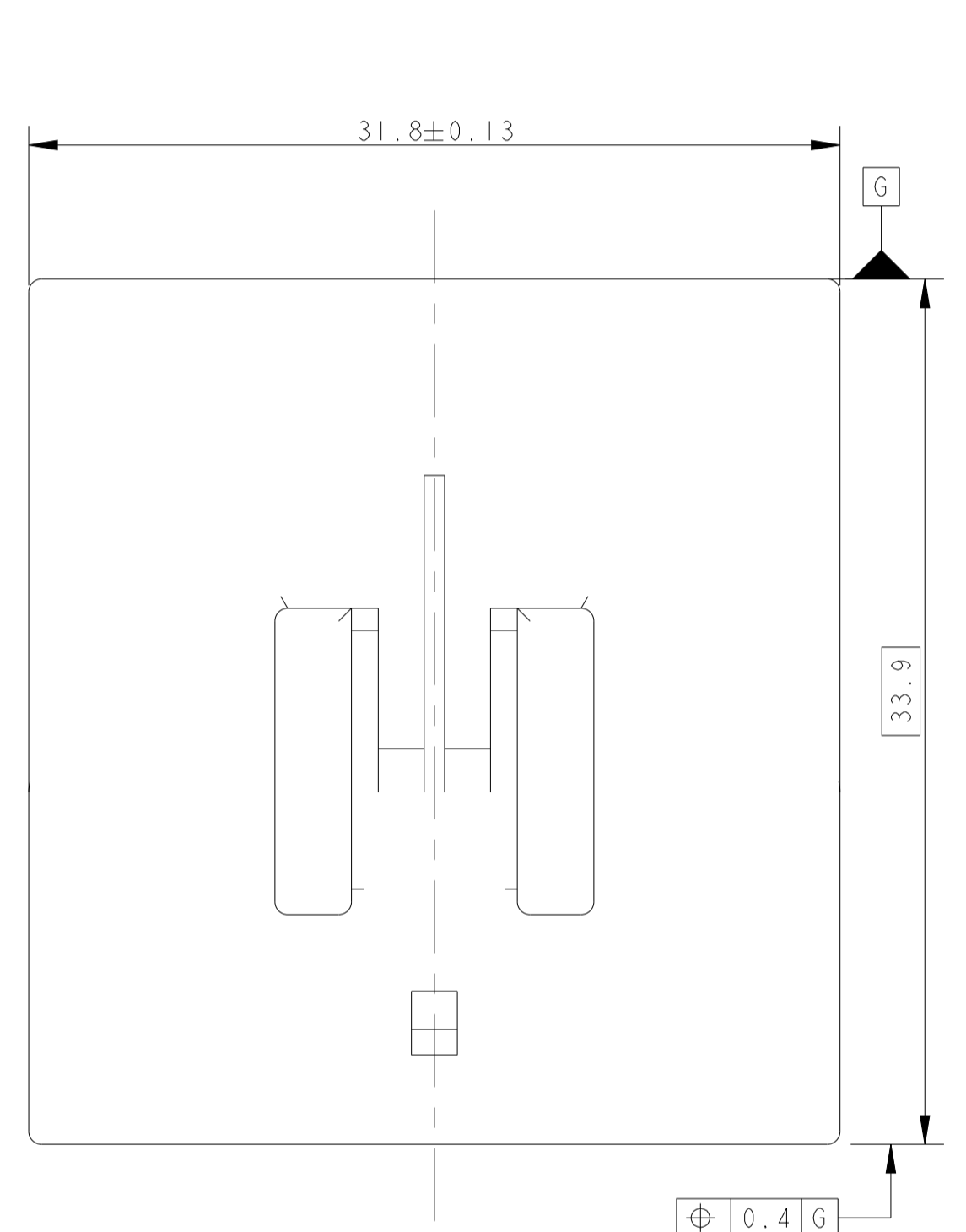
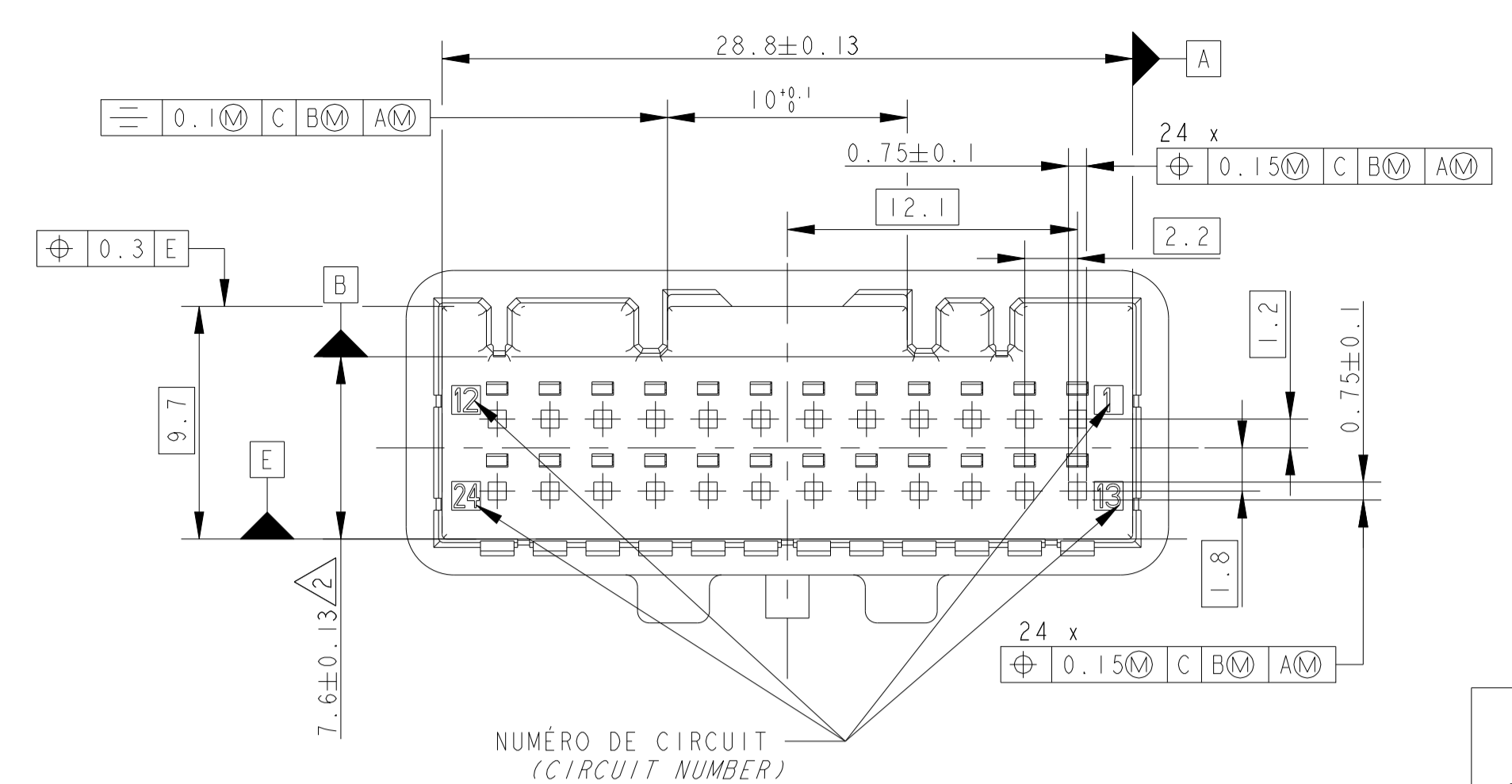
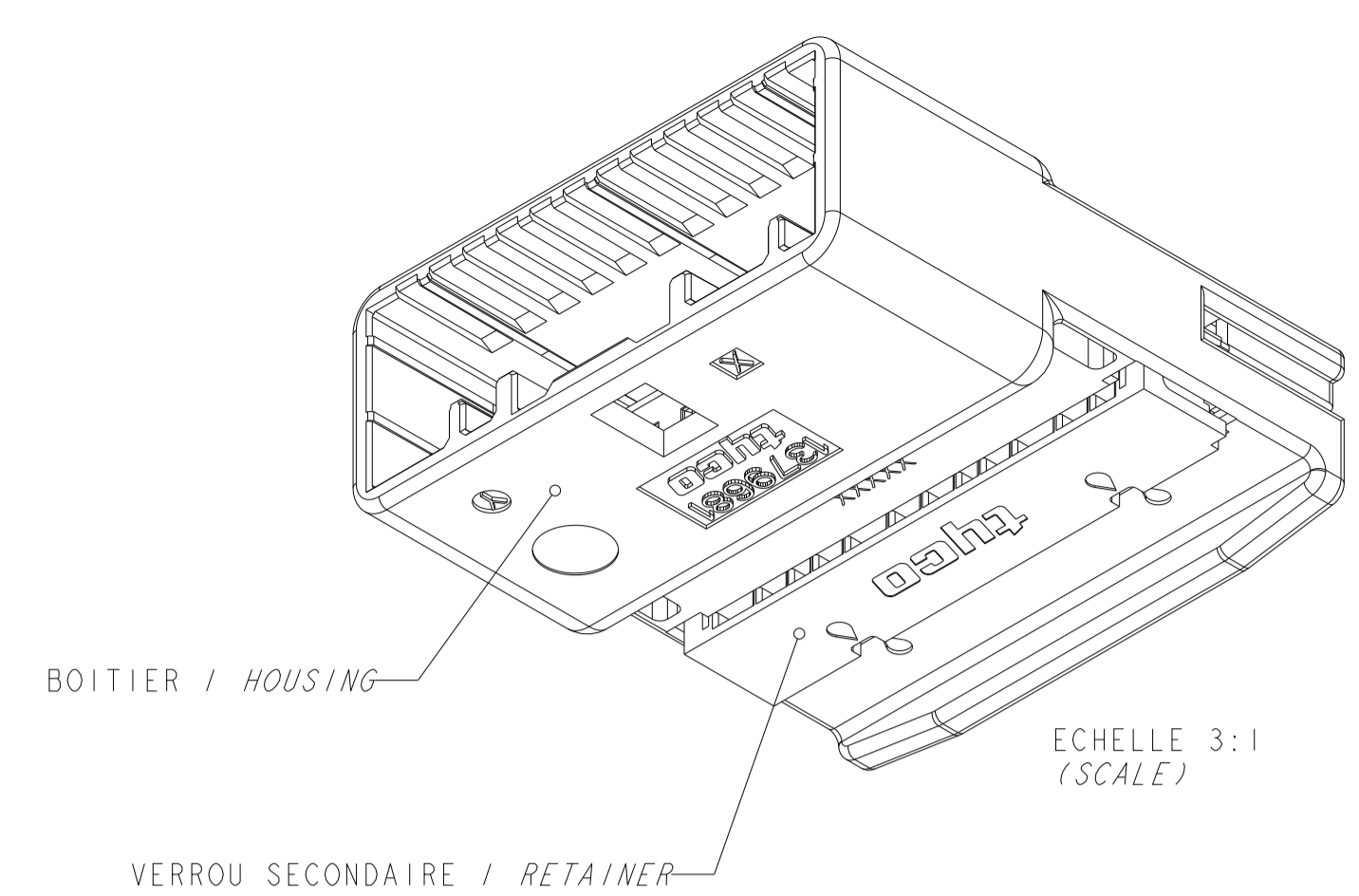

NOTES : LES NOTES LOCALES SONT ENTRE <-> SPECIFICATIONS DE REFERENCE :
 2 SPECIFICATION TE : 108-15299
 4 PLAN D'INTERFACE TE : 1379778
 NOTES COMPLEMENTAIRES :
 12 CAHIER DE PRECONISATION : 411-15672
 13 REFERENCE REPRESENTEE : 1379681-1
 14 VERROU SECONDAIRE PREVERROUILLE (POSITION PREFERENTIELLE DE LIVRAISON). SI LE VERROU N'EST PAS DANS CETTE POSITION, SUIVRE LES INSTRUCTIONS DE LA NOTICE TECHNIQUE TE 411-15672 §8.2
 P1 POUR INFORMATION

LOCALE NOTES ARE BETWEEN <-> APPLICABLE SPECIFICATION :
 TE SPECIFICATION (SEE BEFORE)
 TE INTERFACE DRAWING (SEE BEFORE)
 ADDITIONAL NOTES :
 INSTRUCTION SHEET : (SEE BEFORE)
 PART NUMBER SHOWN (SEE BEFORE)
 SECONDARY LOCK IN PRELOCKED POSITION (PREFERRED DELIVERY POSITION). IF SECONDARY LOCKING IS NOT IN THIS POSITION, FOLLOW INSTRUCTIONS OF TE SPECIFICATION 411-15672 §8.2
 FOR REFERENCE ONLY

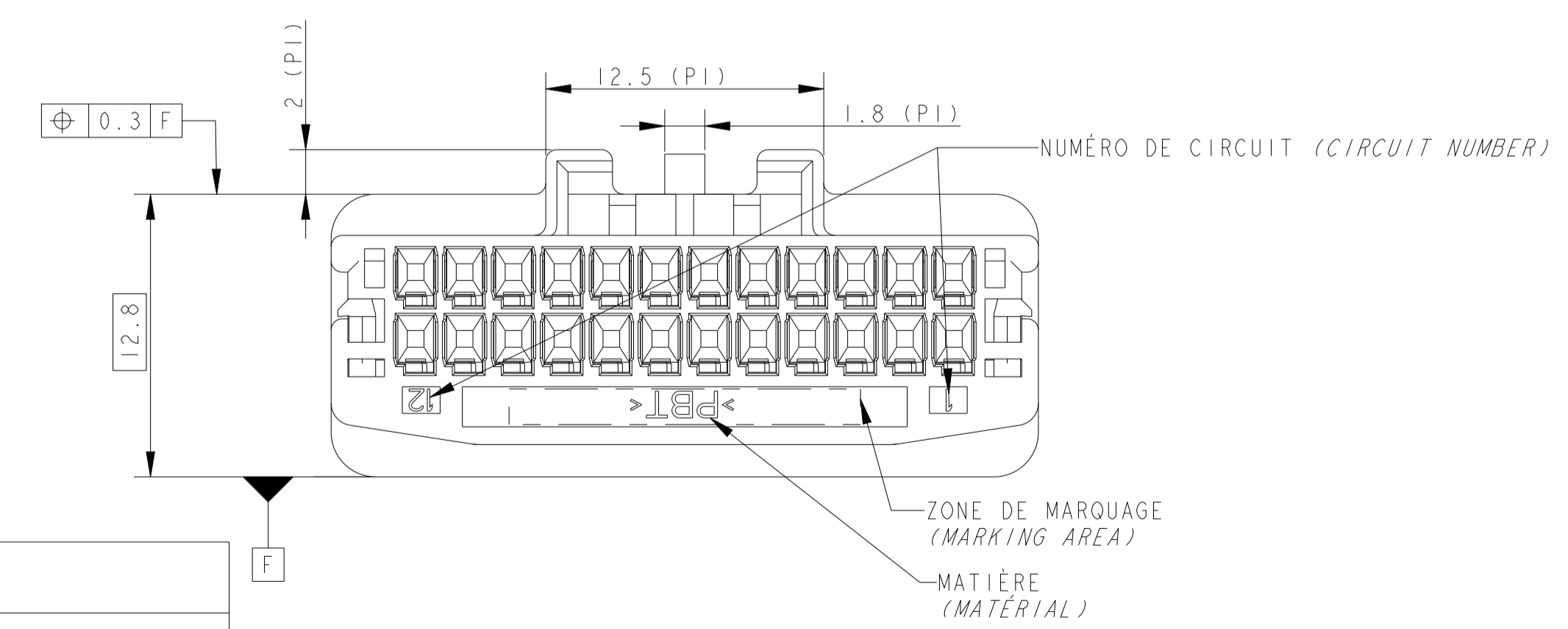
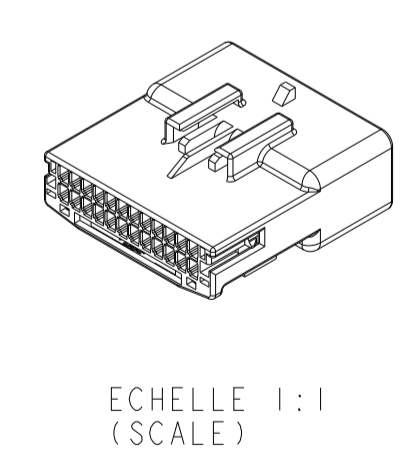
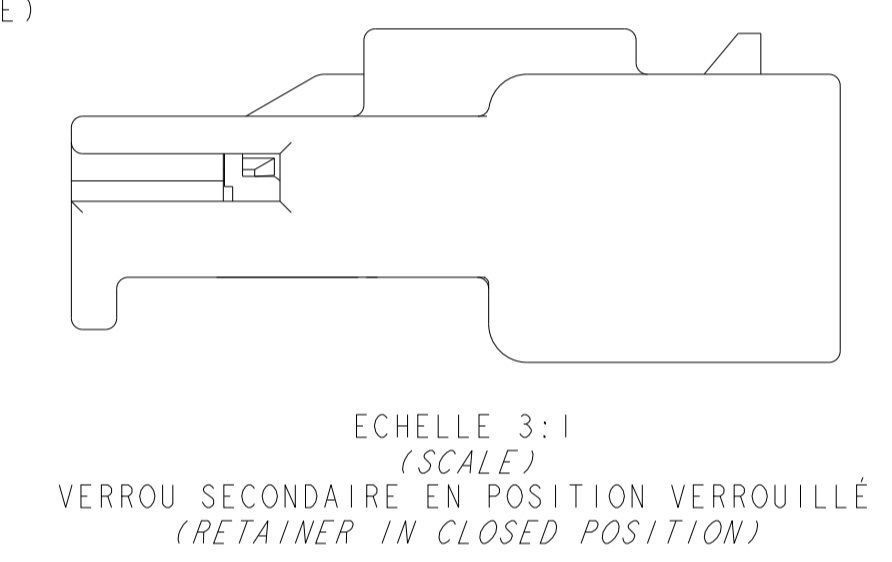

CONTACTS ASSOCIES (APPLIED CONTACTS)			
REF TE / (TE PN)	FINITION (FINISH)	DESIGNATION (DESIGNATION)	LOCALISATION PRODUCTION (PRODUCTION LOCALIZATION)
1802190-1	ETAME (TINNED)	LANGUETTE .635 (.635 TAB) 0.22 A 0.5 MM ² (SQMM)	EUROPE
1674742-1			ASIA

REF TE / (TE PN)	DESCRIPTION / DESCRIPTION	CODAGE / KEYING	MATIERE BOITIER - MATIERE VERROU SECONDAIRE / HOUSING MATERIAL - RETAINER MATERIAL	COULEUR BOITIER - COULEUR VERROU SECONDAIRE / HOUSING COLOR - RETAINER COLOR	REVISION ASSEMBLAGE / ASSEMBLY REVISION CODE
-	- / -	- / -	-	-	-
1379681-5	CONNECTEUR 24 VOIES / 24 WAY CONNECTOR	NEUTRE / NEUTRAL	PBT-PBT / PBT-PBT	NATUREL-NATUREL / NATURAL-NATURAL	A
1379681-2	CONNECTEUR 24 VOIES / 24 WAY CONNECTOR	2 / 2	PBT-PBT / PBT-PBT	GRIS-NATUREL / GREY-NATURAL	A
1379681-1	CONNECTEUR 24 VOIES / 24 WAY CONNECTOR	1 / 1	PBT-PBT / PBT-PBT	NOIR-NATUREL / BLACK-NATURAL	A

THIS DRAWING IS A CONTROLLED DOCUMENT. CE PLAN EST UN DOCUMENT CONTRÔLÉ PAR TYCO ELECTRONICS. IL EST SPÉCIFIQUE À CE PRODUIT. CONTACTER LE SERVICE TECHNIQUE DE TYCO ELECTRONICS POUR OBTENIR LA DERNIÈRE RÉVISION.

DWN / DRESSINE : 29NOV2002
 G. ROUZE
 CHK / PREPARE : 02DEC2002
 B. DUPONT

APVD / APPROVE : 04DEC2002
 JP. PICHAUD
 PRODUCT SPEC
 SPEC. PRODUCT
 SEE TABLE
 APPLICATION SPEC
 SPEC. APPLICATION
 SEE TABLE

NAME / TITRE : 025 TH 24 POS TAB HOUSING

SIZE / FORMAT : A1
 CAGE CODE / DRAWING NO. / N° PLAN : - / - / 1379681

RESTRICTED TO RESERVE A

WEIGHT / MASSE APPROX. : 5.9g

Customer Drawing / PLAN CLIENT

UNIDRAWN / UNIDRAWN

SCALE / ECHELLE : 4:1

SHEET / FEUILLE : 1 OF 2

REV / REV : G

REVISIONS						
P	LTN	REV	DESCRIPTION MODIFICATIONS	DATE	DWN DESS.	APVD APP.
-	-	-	SEE SHEET 1	-	-	-

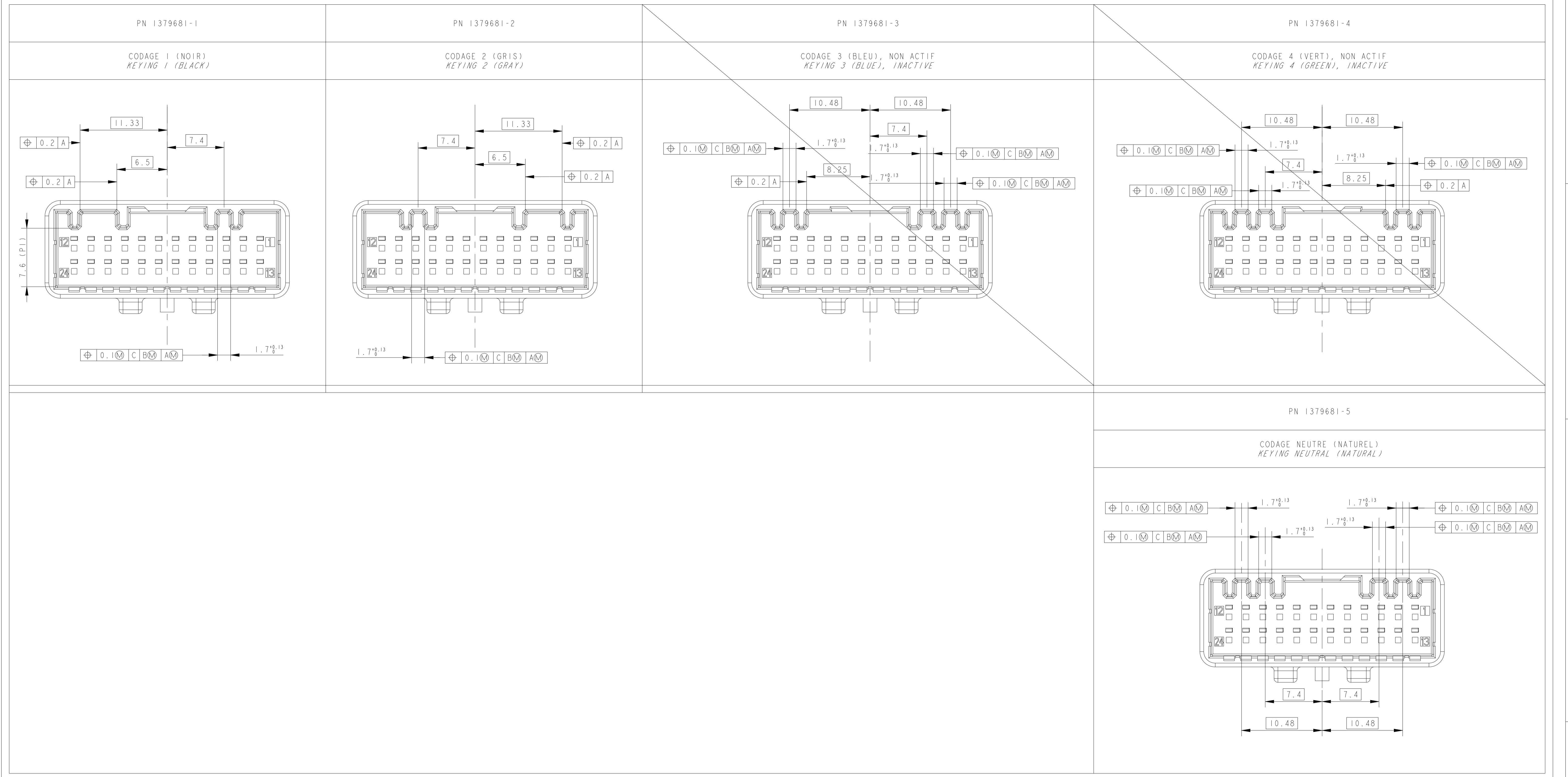

THIS DRAWING IS A CONTROLLED DOCUMENT. CE PLAN EST UN DOCUMENT CONTRÔLÉ PAR TUXO ELECTRONICS - IL EST SENSIBLE À TOUTE FAUSSE COPIE. LE SERVICE TECHNIQUE DE TUXO ELECTRONICS POUR OBTENIR LA DERNIÈRE RÉVISION.		DWN / REVISION: 29NOV2002 C. ROUZE CHK / VERIFIE: 02DEC2002 B. DUPONT	TE Connectivity
DIMENSIONS: mm	TOLERANCES UNLESS OTHERWISE SPECIFIED: (S'IL Y A DE DÉCIMALES): 0 P.L.C./DEC: ±0.2 1 P.L.C./DEC: ±0.2 2 P.L.C./DEC: ±0.2 3 P.L.C./DEC: ±0.2 4 P.L.C./DEC: ±0.2 ANGLES: ±5° FINISH / FINITION: -	APVD / APPROUVE: 04DEC2002 JP. PICAUD PRODUCT SPEC: SPEC. PRODUCT: SEE TABLE APPLICATION SPEC: SPEC. APPLICATION: SEE TABLE	
MATERIAL / MATIERE: SEE TABLE	WEIGHT: 5.9g MASSE APPROX.: 5.9g	CUSTOMER DRAWING / PLAN CLIENT UNIFORMITY: - SCALE: 4:1 SHEET: 2 OF: 2 REV: G	RESTRICTED TO RESERVE A

Looking for pricing, stock, or lifecycle information?

Click below to explore more details on WIN SOURCE:

 [View 1379681-1](#) on WIN SOURCE

 [TE Connectivity](#) Information

Optimize Your Supply Chain with WIN SOURCE Solutions

-  Global Sourcing Solution
-  Obsolete Management
-  Cost Control Management
-  Shortage Management
-  Alternative Solution
-  Excess Inventory Management