



**THE DATASHEET OF  
SWR25X-NRTC-S02-RB-BA**



**PART NUMBER CODING**

SWR25X-NRTC-S--R--BA

- TERMINATION TYPE
- A= RIGHT ANGLE BENT, TYPE2
- B= RIGHT ANGLE BENT, TYPE1
- NUMBER OF POSITIONS  
(CONTACTS PER ROW)

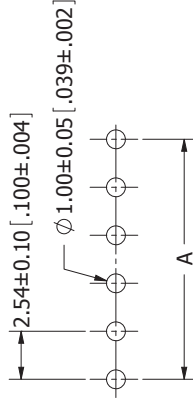
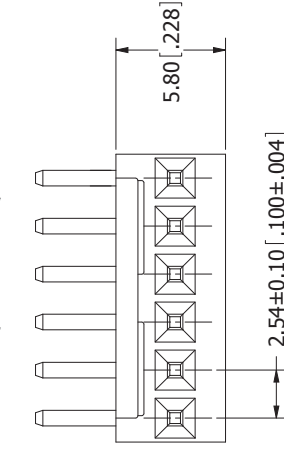

**RECOMMENDED PCB LAYOUT**  
P.C. BOARD THICKNESS: 1.6mm [.063"]

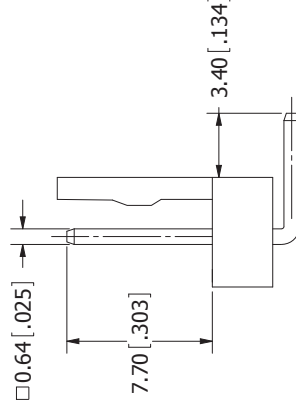
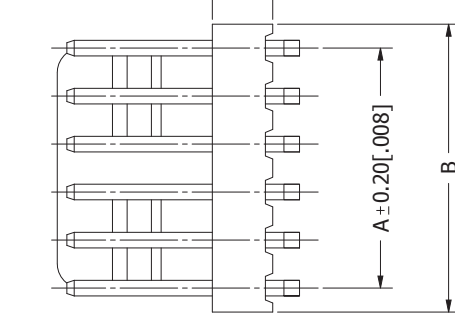
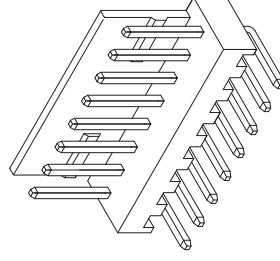

**P/N: SWR25X-NRTC-S--RB-BA**  
(TYPE 1)

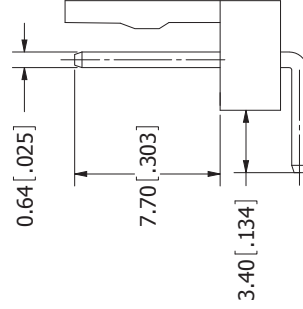

**P/N: SWR25X-NRTC-S--RA-BA**  
(TYPE 2)

- NOTES:**
1. INSULATOR MATERIAL: NYLON 66, UL94V-2, COLOR: BEIGE.
  2. CONTACT MATERIAL: BRASS.
  3. CONTACT PLATING: .000020" MIN. NICKEL UNDERPLATE, PURE TIN, BRIGHT OVERALL.
  4. CURRENT RATING: 5 AMPS PER CONTACT.
  5. VOLTAGE RATING: 250V AC/DC.
  6. INSULATOR RESISTANCE: 1000 MEGOHMS MIN.
  7. CONTACT RESISTANCE: 20 MILLIOHMS MAX.
  8. DIELECTRIC WITHSTANDING VOLTAGE: 1000V AC.
  9. OPERATING TEMPERATURE: -25° C TO +85° C.
  10. MATES WITH SWH25X SERIES SINGLE ROW HOUSING.



**RoHS COMPLIANT**

UNLESS OTHERWISE SPECIFIED:  
DIMENSIONS ARE IN MILLIMETERS

TOLERANCES: ANGULAR:  
X° ± 0.3 [01]  
XX° ± 0.30 [012]

INTERPRET DIMENSIONS AND  
TOLERANCING  
PER: ASME Y14.5M-2009

DRAWN	DATE	REV
	05/23/2011	1

THE INFORMATION HEREIN CONTAINS PROPRIETARY INFORMATION AND IS UNCLASSIFIED TO BE REPRODUCED, USED, DISCLOSED TO OTHERS OR FOR ANY OTHER PURPOSE WITHOUT THE AUTHORIZATION IN WRITING BY THE OFFICER OF SILLING ELECTRONICS

Part Number	Positions/ Contacts	MPL	
		MI	ML
SWR25X-NRTC-S02-R--BA	02/02	2.5	2.5
SWR25X-NRTC-S03-R--BA	03/03	5.0	5.0
SWR25X-NRTC-S04-R--BA	04/04	7.6	7.6
SWR25X-NRTC-S05-R--BA	05/05	10.0	10.0
SWR25X-NRTC-S06-R--BA	06/06	12.0	12.0
SWR25X-NRTC-S07-R--BA	07/07	15.0	15.0
SWR25X-NRTC-S08-R--BA	08/08	17.0	17.0
SWR25X-NRTC-S09-R--BA	09/09	20.0	20.0
SWR25X-NRTC-S10-R--BA	10/10	22.0	22.0
SWR25X-NRTC-S11-R--BA	11/11	25.0	25.0
SWR25X-NRTC-S12-R--BA	12/12	27.0	27.0
SWR25X-NRTC-S13-R--BA	13/13	30.0	30.0
SWR25X-NRTC-S14-R--BA	14/14	33.0	33.0
SWR25X-NRTC-S15-R--BA	15/15	35.0	35.0
SWR25X-NRTC-S16-R--BA	16/16	38.0	38.0
SWR25X-NRTC-S17-R--BA	17/17	40.0	40.0
SWR25X-NRTC-S18-R--BA	18/18	43.0	43.0
SWR25X-NRTC-S19-R--BA	19/19	45.0	45.0
SWR25X-NRTC-S20-R--BA	20/20	48.0	48.0

**P/N: SWR25X-NRTC-S--RA-BA**  
(TYPE 2)

P/N:

## Looking for pricing, stock, or lifecycle information?

Click below to explore more details on WIN SOURCE:

- ⊖ [View SWR25X-NRTC-S02-RB-BA on WIN SOURCE](#)
- ⊖ [Sullins Connector Solutions Information](#)

## Optimize Your Supply Chain with WIN SOURCE Solutions

- ✓ Global Sourcing Solution
- ✓ Obsolete Management
- ✓ Cost Control Management
- ✓ Shortage Management
- ✓ Alternative Solution
- ✓ Excess Inventory Management