

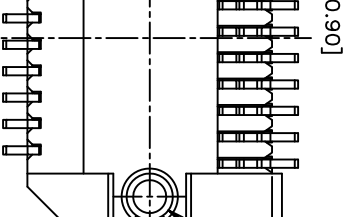

**THE DATASHEET OF
UE75-A20-3000T**

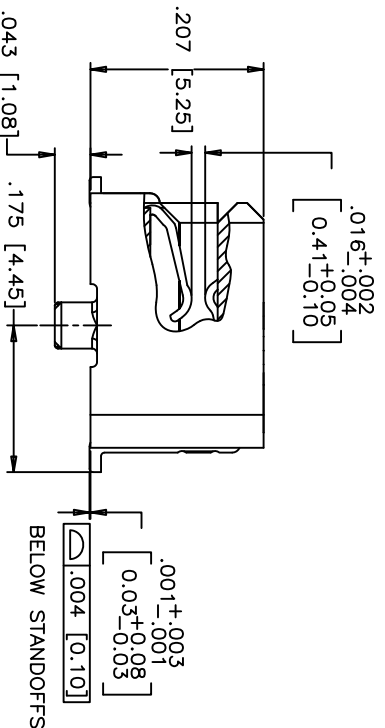

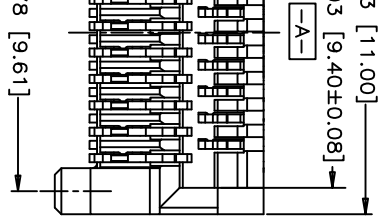
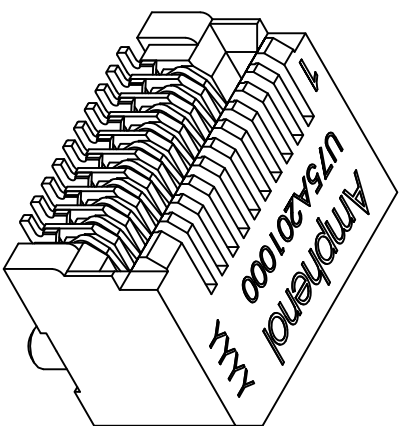
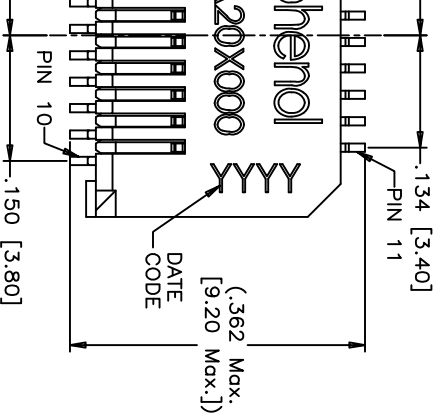

AMPHENOL PART NUMBER CONFIGURATION

UX75 - A 20 - X 0 0 X T

SFP RECEPTACLE
 U75 = NON-ROHS
 U75 = ROHS COMPLIANT

LUBRICANT OPTION ON MATING AREA
 0 = NO
 1 = YES

(FOR U75 NON-ROHS)
 1 = PLATING OPTION 1 (SEE MATERIAL NOTES)
 4 = PLATING OPTION 4 (SEE MATERIAL NOTES)
 (FOR U75 ROHS)
 2 = PLATING OPTION 2 (SEE MATERIAL NOTES)
 3 = PLATING OPTION 3 (SEE MATERIAL NOTES)
 5 = PLATING OPTION 5 (SEE MATERIAL NOTES)
 6 = PLATING OPTION 6 (SEE MATERIAL NOTES)

REVISIONS			
SYM ZONE	ECN, ERN NO.	DATE	APPRD.
K	UPDATED MATERIAL FOR HOUSING	MAR29/07	J.S.
L	UPDATED	APR16/08	A.G.
M	UPDATED	MAR 14/11	J.S.
N	UPDATED	NOV 21/11	J.S.
P	UPDATED	JUL 16/12	J.S.

THIS IS A CAD DRAWING. DO NOT MANUALLY REVISE.

MATERIAL NOTES:
 PLASTIC HOUSING:
 HIGH TEMPERATURE LCP
 FLAMMABILITY RATING UL94V-0.

CONTACTS:
 PHOSPHOR BRONZE

PLATING OPTION 1: (U75 ONLY)
 30µ" [0.76 µm] MIN. GOLD ON MATING AREA AND 150-300 µ" (3.81-7.62 µm) MIN. TIN/LEAD (90/10) PLATING ON TERMINATION OVER 50µ" [1.27 µm] MIN. NICKEL UNDER LAYER.

PLATING OPTION 2: (ROHS FOR U75 ONLY)
 30µ" [0.76 µm] MIN. GOLD ON MATING AREA AND 2 µ" (0.05 µm) GOLD FLASH PLATING ON TERMINATION OVER 50µ" [1.27 µm] MIN. NICKEL UNDER LAYER.

PLATING OPTION 3: (ROHS FOR U75 ONLY)
 30µ" [0.76 µm] MIN. GOLD ON MATING AREA AND 150-300 µ" (3.81-7.62 µm) MIN. LOW WHISKER MATTE TIN PLATING ON TERMINATION OVER 50µ" [1.27 µm] MIN. NICKEL UNDER LAYER.

PLATING OPTION 4: (FOR U75 ONLY)
 15µ" [0.38 µm] MIN. GOLD ON MATING AREA AND 150-300 µ" (3.81-7.62 µm) MIN. TIN/LEAD (90/10) PLATING ON TERMINATION OVER 50µ" [1.27 µm] MIN. NICKEL UNDER LAYER.

PLATING OPTION 5: (ROHS FOR U75 ONLY)
 15µ" [0.38 µm] MIN. GOLD ON MATING AREA AND 2 µ" (0.05 µm) GOLD FLASH PLATING ON TERMINATION OVER 50µ" [1.27 µm] MIN. NICKEL UNDER LAYER.

PLATING OPTION 6: (ROHS FOR U75 ONLY)
 15µ" [0.38 µm] MIN. GOLD ON MATING AREA AND 150-300 µ" (3.81-7.62 µm) MIN. LOW WHISKER MATTE TIN PLATING ON TERMINATION OVER 50µ" [1.27 µm] MIN. NICKEL UNDER LAYER.

LUBRICANT OPTION: LUBRICANT CAN BE ADDED ON THE CONTACTS MATING AREA (SEE P/N FOR THE OPTION)

PACKAGING:
 TAPE AND REEL.
 TEMPERATURE RANGE:
 -40°C TO +85°C

DRAWING		DATE	
DESIGNED	J.S/I	2002/02/08	
CHECKED X		X	
I. E. APPRD.			
Q. A. APPRD.			
GENERAL TOLERANCES			
INCH	MILLIMETERS		
XXX±0.010	X.X± 0.25		
XXXXXXXX.008XXXX	0.15		
DECIMALS			
X.X±.1			
ANGLES	X.X±0.5		
DIMENSIONS ARE IN INCHES [mm]		CODE ID. NO.	
		X	03554
TITLE		DWG	SCALE
SFP 20 POSITION HIGH SPEED CONNECTOR RECEPTACLE FIXED BOARD, RIGHT ANGLE SMT OPTIONAL PLATING AND LUBRICANT ON MATING		A	4/1
Amphenol Canada Corp.		DWG NO.	WT.
P-UX75-A20-X00XX			SURF.
		REV.	SHEET 1 of 3

FOR ANY PURPOSE OR USED FOR MANUFACTURING ONLY FROM AMPHENOL CANADA CORP.

REVISIONS				
SYM	ZONE	ECN, ERN NO.	DATE	APPRD.
K		UPDATED MATERIAL FOR HOUSING	MAR29/07	J.S.
L		UPDATED	APR16/08	A.G.
M		UPDATED	MAR 14/11	J.S.
N		UPDATED	NOV 21/11	J.S.
P		UPDATED	JUL 18/12	J.S.

THIS IS A CAD DRAWING. DO NOT MANUALLY REVISE.

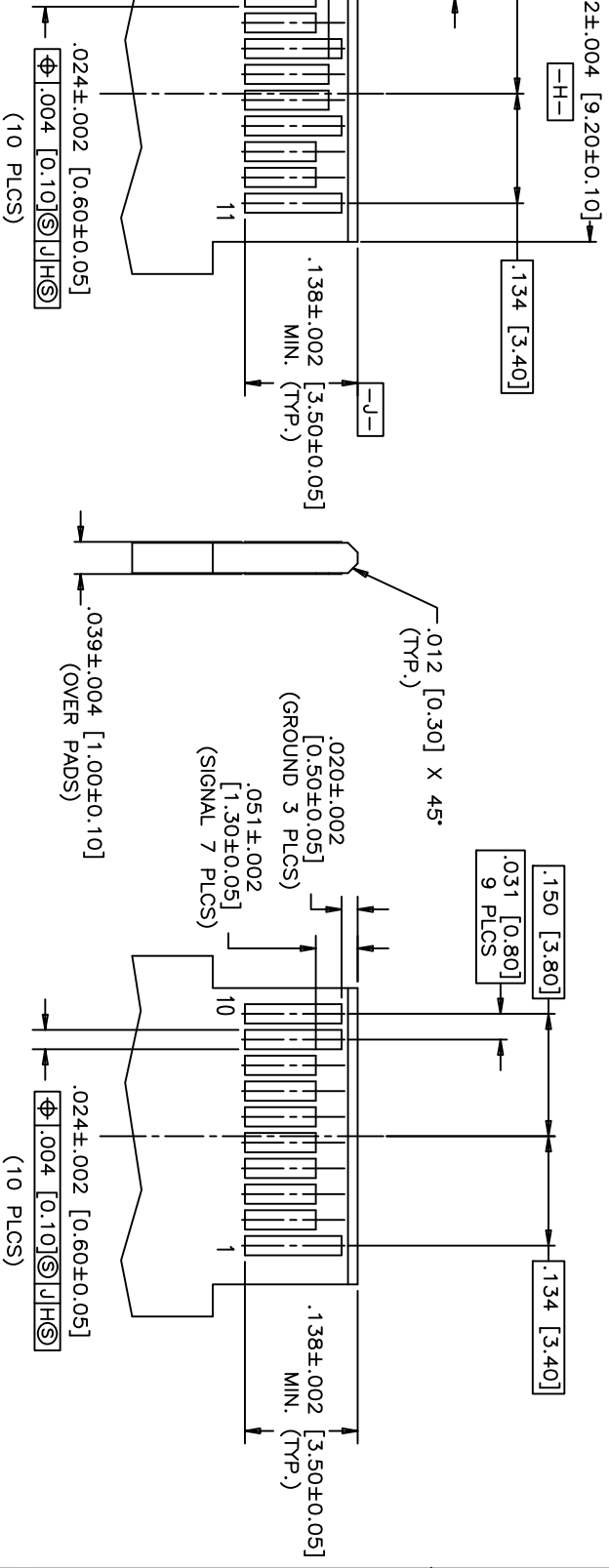

VIEW OF BOARD

BOTTOM VIEW OF BOARD

RECOMMENDED LAYOUT DETAIL
MATING TRANSCIEVER PCB

ALL INFORMATION AND SUCH INFORMATION
FOR ANY PURPOSE OR USED FOR MANUFACTURING
ONLY FROM AMPHENOL CANADA CORP.

GENERAL TOLERANCES		INCH		MILLIMETERS		DWG. APPRD.	
DRAWN	J.S/	DATE	2009/03/09				
DESIGNED	J.S/		2009/03/09				
CHECKED	X						
DECIMALS				X.XX±0.010	X.X±0.25	X.XX±0.008	X.XX±0.15
ANGLES				X°±1'		X°±0.5'	
DIMENSIONS ARE IN				INCHES	[mm]	CODE ID. NO.	03554
SCALE				4:1	WT.	SURF.	SHEET 3 of 3
Amphenol Canada Corp. TITLE: SFP 20 POSITION HIGH SPEED CONNECTOR RECEPTACLE FIXED BOARD, RIGHT ANGLE SMT OPTIONAL PLATING AND LUBRICANT ON MATING DWG. DRAWING NO. P-UX75-A20-X00XX REV. P							

Looking for pricing, stock, or lifecycle information?

Click below to explore more details on WIN SOURCE:

 [View UE75-A20-3000T](#) on WIN SOURCE

 [Amphenol](#) Information

Optimize Your Supply Chain with WIN SOURCE Solutions

-  Global Sourcing Solution
-  Obsolete Management
-  Cost Control Management
-  Shortage Management
-  Alternative Solution
-  Excess Inventory Management