

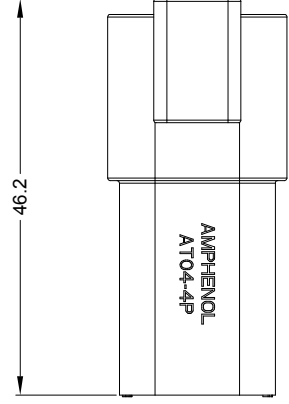

**THE DATASHEET OF
AT04-4P-RD01**





REV	EC
A3	
A4	C05
A5	

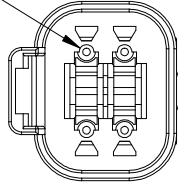
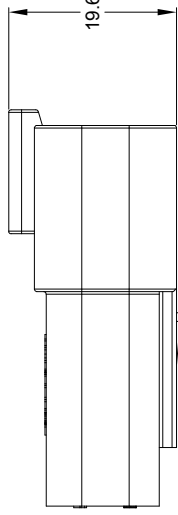
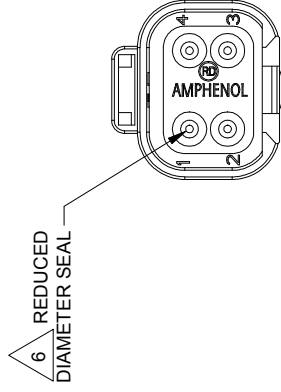

NOTES: UNLESS OTHERWISE SPECIFIED

1. MATERIAL:
HOUSING: THERMOPLASTIC
SEAL: SILICONE RUBBER
2. MODIFICATIONS: REDUCED DIAMETER WIRE SEAL
3. SPECIFICATIONS:
3.1 CURRENT RATING: 13 AMPS
3.2 OPERATING TEMPERATURE: -55°C TO +125°C
3.3 DIELECTRIC WITHSTANDING VOLTAGE: LESS THAN 2 MILLIAMPS CURRENT LEAKAGE @ 1500 VOLTS AC.
3.4 INSULATION RESISTANCE: 1000 MEGOHMS MIN @ 25°C.
3.5 MOISTURE RESISTANCE:
IP68(1M OF WATER FOR A PERIOD OF 24 HOURS, MATED CONDITION)
IP69K(MATED CONDITION)
3.6 MATING CYCLE DURABILITY: 100 CYCLES
3.7 RoHS COMPLIANT
4. MATING PART: AT06-4S* PLUG
(* = MODIFICATIONS AND COLORS)
5. ALL DIMENSIONS ARE FOR REFERENCE USE ONLY.

CONTACT SIZE	MIN. INSUL O.D.		MAX. INSUL O.D.		TYPICAL WIRE RANGE
	MIN.	MAX.	MIN.	MAX.	
16	1.35 mm (.053 in)	3.05 mm (.120 in)	3.05 mm (.120 in)	3.05 mm (.120 in)	14 - 20 AWG (2.0-0.5mm ²)

PART NUMBER CHART	
COLOR	PART NUMBER
GREY	AT04-4P-RD01
BLACK	AT04-4P-RD01BLK
BLUE	AT04-4P-RD01BLU
BROWN	AT04-4P-RD01BRN
GREEN	AT04-4P-RD01GRN
RED	AT04-4P-RD01RED
WHITE	AT04-4P-RD01WHT
YELLOW	AT04-4P-RD01YEL
ORANGE	AT04-4P-RD01ORG

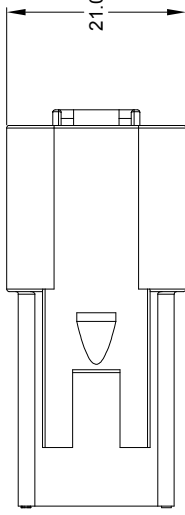

SEE PART NUMBER	PART NUMBER
QUANTITY	UNLESS OTHERWISE SPECIFIED
	1) All dimensions are in metric (mm).
	2) Tolerances are as follows:
	3 PL DEC 20.75
	4 PL DEC 20.75
	5 PL DEC 20.75
	6 PL DEC 20.75
	7 PL DEC 20.75
	8 PL DEC 20.75
	9 PL DEC 20.75
	10 PL DEC 20.75
	11 PL DEC 20.75
	12 PL DEC 20.75
	13 PL DEC 20.75
	14 PL DEC 20.75
	15 PL DEC 20.75
	16 PL DEC 20.75
	17 PL DEC 20.75
	18 PL DEC 20.75
	19 PL DEC 20.75
	20 PL DEC 20.75
	21 PL DEC 20.75
	22 PL DEC 20.75
	23 PL DEC 20.75
	24 PL DEC 20.75
	25 PL DEC 20.75
	26 PL DEC 20.75
	27 PL DEC 20.75
	28 PL DEC 20.75
	29 PL DEC 20.75
	30 PL DEC 20.75
	31 PL DEC 20.75
	32 PL DEC 20.75
	33 PL DEC 20.75
	34 PL DEC 20.75
	35 PL DEC 20.75
	36 PL DEC 20.75
	37 PL DEC 20.75
	38 PL DEC 20.75
	39 PL DEC 20.75
	40 PL DEC 20.75
	41 PL DEC 20.75
	42 PL DEC 20.75
	43 PL DEC 20.75
	44 PL DEC 20.75
	45 PL DEC 20.75
	46 PL DEC 20.75
	47 PL DEC 20.75
	48 PL DEC 20.75
	49 PL DEC 20.75
	50 PL DEC 20.75
	51 PL DEC 20.75
	52 PL DEC 20.75
	53 PL DEC 20.75
	54 PL DEC 20.75
	55 PL DEC 20.75
	56 PL DEC 20.75
	57 PL DEC 20.75
	58 PL DEC 20.75
	59 PL DEC 20.75
	60 PL DEC 20.75
	61 PL DEC 20.75
	62 PL DEC 20.75
	63 PL DEC 20.75
	64 PL DEC 20.75
	65 PL DEC 20.75
	66 PL DEC 20.75
	67 PL DEC 20.75
	68 PL DEC 20.75
	69 PL DEC 20.75
	70 PL DEC 20.75
	71 PL DEC 20.75
	72 PL DEC 20.75
	73 PL DEC 20.75
	74 PL DEC 20.75
	75 PL DEC 20.75
	76 PL DEC 20.75
	77 PL DEC 20.75
	78 PL DEC 20.75
	79 PL DEC 20.75
	80 PL DEC 20.75
	81 PL DEC 20.75
	82 PL DEC 20.75
	83 PL DEC 20.75
	84 PL DEC 20.75
	85 PL DEC 20.75
	86 PL DEC 20.75
	87 PL DEC 20.75
	88 PL DEC 20.75
	89 PL DEC 20.75
	90 PL DEC 20.75
	91 PL DEC 20.75
	92 PL DEC 20.75
	93 PL DEC 20.75
	94 PL DEC 20.75
	95 PL DEC 20.75
	96 PL DEC 20.75
	97 PL DEC 20.75
	98 PL DEC 20.75
	99 PL DEC 20.75
	100 PL DEC 20.75
	101 PL DEC 20.75
	102 PL DEC 20.75
	103 PL DEC 20.75
	104 PL DEC 20.75
	105 PL DEC 20.75
	106 PL DEC 20.75
	107 PL DEC 20.75
	108 PL DEC 20.75
	109 PL DEC 20.75
	110 PL DEC 20.75
	111 PL DEC 20.75
	112 PL DEC 20.75
	113 PL DEC 20.75
	114 PL DEC 20.75
	115 PL DEC 20.75
	116 PL DEC 20.75
	117 PL DEC 20.75
	118 PL DEC 20.75
	119 PL DEC 20.75
	120 PL DEC 20.75
	121 PL DEC 20.75
	122 PL DEC 20.75
	123 PL DEC 20.75
	124 PL DEC 20.75
	125 PL DEC 20.75
	126 PL DEC 20.75
	127 PL DEC 20.75
	128 PL DEC 20.75
	129 PL DEC 20.75
	130 PL DEC 20.75
	131 PL DEC 20.75
	132 PL DEC 20.75
	133 PL DEC 20.75
	134 PL DEC 20.75
	135 PL DEC 20.75
	136 PL DEC 20.75
	137 PL DEC 20.75
	138 PL DEC 20.75
	139 PL DEC 20.75
	140 PL DEC 20.75
	141 PL DEC 20.75
	142 PL DEC 20.75
	143 PL DEC 20.75
	144 PL DEC 20.75
	145 PL DEC 20.75
	146 PL DEC 20.75
	147 PL DEC 20.75
	148 PL DEC 20.75
	149 PL DEC 20.75
	150 PL DEC 20.75
	151 PL DEC 20.75
	152 PL DEC 20.75
	153 PL DEC 20.75
	154 PL DEC 20.75
	155 PL DEC 20.75
	156 PL DEC 20.75
	157 PL DEC 20.75
	158 PL DEC 20.75
	159 PL DEC 20.75
	160 PL DEC 20.75
	161 PL DEC 20.75
	162 PL DEC 20.75
	163 PL DEC 20.75
	164 PL DEC 20.75
	165 PL DEC 20.75
	166 PL DEC 20.75
	167 PL DEC 20.75
	168 PL DEC 20.75
	169 PL DEC 20.75
	170 PL DEC 20.75
	171 PL DEC 20.75
	172 PL DEC 20.75
	173 PL DEC 20.75
	174 PL DEC 20.75
	175 PL DEC 20.75
	176 PL DEC 20.75
	177 PL DEC 20.75
	178 PL DEC 20.75
	179 PL DEC 20.75
	180 PL DEC 20.75
	181 PL DEC 20.75
	182 PL DEC 20.75
	183 PL DEC 20.75
	184 PL DEC 20.75
	185 PL DEC 20.75
	186 PL DEC 20.75
	187 PL DEC 20.75
	188 PL DEC 20.75
	189 PL DEC 20.75
	190 PL DEC 20.75
	191 PL DEC 20.75
	192 PL DEC 20.75
	193 PL DEC 20.75
	194 PL DEC 20.75
	195 PL DEC 20.75
	196 PL DEC 20.75
	197 PL DEC 20.75
	198 PL DEC 20.75
	199 PL DEC 20.75
	200 PL DEC 20.75
	201 PL DEC 20.75
	202 PL DEC 20.75
	203 PL DEC 20.75
	204 PL DEC 20.75
	205 PL DEC 20.75
	206 PL DEC 20.75
	207 PL DEC 20.75
	208 PL DEC 20.75
	209 PL DEC 20.75
	210 PL DEC 20.75
	211 PL DEC 20.75
	212 PL DEC 20.75
	213 PL DEC 20.75
	214 PL DEC 20.75
	215 PL DEC 20.75
	216 PL DEC 20.75
	217 PL DEC 20.75
	218 PL DEC 20.75
	219 PL DEC 20.75
	220 PL DEC 20.75
	221 PL DEC 20.75
	222 PL DEC 20.75
	223 PL DEC 20.75
	224 PL DEC 20.75
	225 PL DEC 20.75
	226 PL DEC 20.75
	227 PL DEC 20.75
	228 PL DEC 20.75
	229 PL DEC 20.75
	230 PL DEC 20.75
	231 PL DEC 20.75
	232 PL DEC 20.75
	233 PL DEC 20.75
	234 PL DEC 20.75
	235 PL DEC 20.75
	236 PL DEC 20.75
	237 PL DEC 20.75
	238 PL DEC 20.75
	239 PL DEC 20.75
	240 PL DEC 20.75
	241 PL DEC 20.75
	242 PL DEC 20.75
	243 PL DEC 20.75
	244 PL DEC 20.75
	245 PL DEC 20.75
	246 PL DEC 20.75
	247 PL DEC 20.75
	248 PL DEC 20.75
	249 PL DEC 20.75
	250 PL DEC 20.75
	251 PL DEC 20.75
	252 PL DEC 20.75
	253 PL DEC 20.75
	254 PL DEC 20.75
	255 PL DEC 20.75
	256 PL DEC 20.75
	257 PL DEC 20.75
	258 PL DEC 20.75
	259 PL DEC 20.75
	260 PL DEC 20.75
	261 PL DEC 20.75
	262 PL DEC 20.75
	263 PL DEC 20.75
	264 PL DEC 20.75
	265 PL DEC 20.75
	266 PL DEC 20.75
	267 PL DEC 20.75
	268 PL DEC 20.75
	269 PL DEC 20.75
	270 PL DEC 20.75
	271 PL DEC 20.75
	272 PL DEC 20.75
	273 PL DEC 20.75
	274 PL DEC 20.75
	275 PL DEC 20.75
	276 PL DEC 20.75
	277 PL DEC 20.75
	278 PL DEC 20.75
	279 PL DEC 20.75
	280 PL DEC 20.75
	281 PL DEC 20.75
	282 PL DEC 20.75
	283 PL DEC 20.75
	284 PL DEC 20.75
	285 PL DEC 20.75
	286 PL DEC 20.75
	287 PL DEC 20.75
	288 PL DEC 20.75
	289 PL DEC 20.75
	290 PL DEC 20.75
	291 PL DEC 20.75
	292 PL DEC 20.75
	293 PL DEC 20.75
	294 PL DEC 20.75
	295 PL DEC 20.75
	296 PL DEC 20.75
	297 PL DEC 20.75
	298 PL DEC 20.75
	299 PL DEC 20.75
	300 PL DEC 20.75
	301 PL DEC 20.75
	302 PL DEC 20.75
	303 PL DEC 20.75
	304 PL DEC 20.75
	305 PL DEC 20.75
	306 PL DEC 20.75
	307 PL DEC 20.75
	308 PL DEC 20.75
	309 PL DEC 20.75
	310 PL DEC 20.75
	311 PL DEC 20.75
	312 PL DEC 20.75
	313 PL DEC 20.75
	314 PL DEC 20.75
	315 PL DEC 20.75
	316 PL DEC 20.75
	317 PL DEC 20.75
	318 PL DEC 20.75
	319 PL DEC 20.75
	320 PL DEC 20.75
	321 PL DEC 20.75
	322 PL DEC 20.75
	323 PL DEC 20.75
	324 PL DEC 20.75
	325 PL DEC 20.75
	326 PL DEC 20.75
	327 PL DEC 20.75
	328 PL DEC 20.75
	329 PL DEC 20.75
	330 PL DEC 20.75
	331 PL DEC 20.75
	332 PL DEC 20.75
	333 PL DEC 20.75
	334 PL DEC 20.75
	335 PL DEC 20.75
	336 PL DEC 20.75
	337 PL DEC 20.75
	338 PL DEC 20.75
	339 PL DEC 20.75
	340 PL DEC 20.75
	341 PL DEC 20.75
	342 PL DEC 20.75
	343 PL DEC 20.75
	344 PL DEC 20.75
	345 PL DEC 20.75
	346 PL DEC 20.75
	347 PL DEC 20.75
	348 PL DEC 20.75
	349 PL DEC 20.75
	350 PL DEC 20.75
	351 PL DEC 20.75
	352 PL DEC 20.75
	353 PL DEC 20.75
	354 PL DEC 20.75
	355 PL DEC 20.75
	356 PL DEC 20.75
	357 PL DEC 20.75
	358 PL DEC 20.75
	359 PL DEC 20.75
	360 PL DEC 20.75
	361 PL DEC 20.75
	362 PL DEC 20.75
	363 PL DEC 20.75
	364 PL DEC 20.75
	365 PL DEC 20.75
	366 PL DEC 20.75
	367 PL DEC 20.75
	368 PL DEC 20.75
	369 PL DEC 20.75
	370 PL DEC 20.75
	371 PL DEC 20.75
	372 PL DEC 20.75
	373 PL DEC 20.75
	374 PL DEC 20.75
	375 PL DEC 20.75
	376 PL DEC 20.75
	377 PL DEC 20.75
	378 PL DEC 20.75
</	

A Series™ - Contact Size 16 Options (Works with: AT, ATV, AHD-9, ARC, DuraMate and PanelMate Series)

Machined Contacts, Sockets & Pins				
Part Number	Description	Size	AWG	Type
AT60-215-1631	Male Contact - Pin, Gold-plated	16	14	Machined
AT62-209-1631	Female Contact - Socket, Gold-plated	16	14	Machined
AT60-215-16141	Male Contact - Pin, Nickel-plated	16	14	Machined
AT62-209-16141	Female Contact - Socket, Nickel-plated	16	14	Machined
AT60-202-1631	Male Contact - Pin, Gold-plated	16	16-20	Machined
AT62-201-1631	Female Contact - Socket, Gold-plated	16	16-20	Machined
AT60-202-16141	Male Contact - Pin, Nickel-plated	16	16-20	Machined
AT62-201-16141	Female Contact - Socket, Nickel-plated	16	16-20	Machined
AT60-202-1631-22	Male Contact - Pin, Gold-plated	16	22-24	Machined
AT62-201-1631-22	Female Contact - Socket, Gold-plated	16	22-24	Machined
AT60-202-16141-22	Male Contact - Pin, Nickel-plated	16	22-24	Machined
AT62-201-16141-22	Female Contact - Socket, Nickel-plated	16	22-24	Machined

Tooling - Machined Contacts	
Part Number	Description
AUTK-16	Hand Crimp Tool, Size 16
AUTK-100	Universal Heavy Duty Contact Crimping Tool Kit, Size 12/16/20
CA-5D12	Universal Hand Crimp Tool, Size 12/16/20
CA-5E12	Pneumatic Crimp Tool, Size 12/16/20

Contact Removal Tools (For both Machined or Stamped & Formed Contacts)	
Part Number	Description
ATRT-100	Contact and Wedgelock Extraction Tool
AT11-310-1605	Contact Removal Tool, Plastic, Size 16



Sealing Plugs (For both Machined or Stamped & Formed Contacts)	
Part Number	Description
A114017	Sealing Plug, Size 16, White
A114017-SR	Sealing Plug, Size 16, SR01 Series, Black
AT13-217-1605	Locking Sealing Plug, Size 16, Grey
AT13-217-1605-SR	Locking Sealing Plug, Size 16, SR01 Series, Red

Stamped & Formed Contacts, Sockets & Pins				
Part Number	Description	Size	AWG	Type
AT60-14-0122	Male Contact - Pin, Nickel-plated	16	14-18	Stamped & Formed
AT62-14-0122	Female Contact - Socket, Nickel-plated	16	14-18	Stamped & Formed
AT60-14-0144	Male Contact - Pin, Gold-plated	16	14-18	Stamped & Formed
AT62-14-0144	Female Contact - Socket, Gold-plated	16	14-18	Stamped & Formed
AT60-16-0122	Male Contact - Pin, Nickel-plated	16	16-18	Stamped & Formed
AT62-16-0122	Female Contact - Socket, Nickel-plated	16	16-18	Stamped & Formed
AT60-16-0144	Male Contact - Pin, Gold-plated	16	16-18	Stamped & Formed
AT62-16-0144	Female Contact - Socket, Gold-plated	16	16-18	Stamped & Formed
AT60-16-0622	Male Contact - Pin, Nickel-plated	16	16-20	Stamped & Formed
AT62-16-0622	Female Contact - Socket, Nickel-plated	16	16-20	Stamped & Formed
AT60-16-0644	Male Contact - Pin, Gold-plated	16	16-20	Stamped & Formed
AT62-16-0644	Female Contact - Socket, Gold-plated	16	16-20	Stamped & Formed
AT60-16-0677	Male Contact - Pin, Tin-plated	16	16-20	Stamped & Formed
AT62-16-0677	Female Contact - Socket, Tin-plated	16	16-20	Stamped & Formed
AT60-16-0822	Male Contact - Pin, Nickel-plated	16	20-22	Stamped & Formed
AT62-16-0822	Female Contact - Socket, Nickel-plated	16	20-22	Stamped & Formed
AT60-16-0844	Male Contact - Pin, Gold-plated	16	20-22	Stamped & Formed
AT62-16-0844	Female Contact - Socket, Gold-plated	16	20-22	Stamped & Formed

Tooling - Stamped & Formed Contacts	
MFX-3950	Crimp Die - Size 16, 18-20AWG
MFX-3953	Crimp Die - Size 16, 16-18AWG
MFX-3975	Crimp Die - Size 16, 14-16AWG
MFX-3990	Crimp Die - Size 16, 20-22AWG
ATT-16-00	Hand Crimp Tool - Size 16, 14-16AWG
ATT-16-01	Hand Crimp Tool - Size 16, 18-20AWG
ATT-1612-03	Hand Crimp Tool - Size 16, 20-22AWG

Looking for pricing, stock, or lifecycle information?

Click below to explore more details on WIN SOURCE:

-  [View AT04-4P-RD01](#) on WIN SOURCE
-  [Amphenol](#) Information

Optimize Your Supply Chain with WIN SOURCE Solutions

-  Global Sourcing Solution
-  Obsolete Management
-  Cost Control Management
-  Shortage Management
-  Alternative Solution
-  Excess Inventory Management