



**THE DATASHEET OF
451001**



- 1
- 2
- 3
- 4
- 5
- 6
- 7
- 8
- 9
- 10
- 11
- 12
- 13
- 14
- 15
- 16
- 17
- 18

COVERING

Injected polyurethane, hardness 55 Shore D.

WHEEL CENTRE BODY

Polyamide based (PA) technopolymer.
Glass-fibre reinforced polyamide based (PA) technopolymer hub cap.

STANDARD EXECUTIONS

- **RBL**: hub with pass-through hole.
- **RSL**: hub with ball bearings. Ideal and silent solution for heavy loads and continuous moving.

APPLICATIONS

Excellent rolling resistance and elasticity features, good wear and tearing resistance.

For selection parameters see Technical data (on page 1295).
RE.FF wheels are also supplied with steel sheet brackets RE.FF-N (see page 1249).

ENVIRONMENTAL CONDITIONS

Suitable for use in environments with the presence of atmospheric agents, alcohols and glycols, weak organic and mineral acids, water and saturated vapour.

ROLLING RESISTANCE - FORCE / LOAD APPLIED

The diagram shows the force to be applied to a wheel to keep it moving at the constant speed of 4 km/h, according to the applied load. The intersection point with a 50N value is the maximum transportable load with a manually actuated 4-wheel trolley; in fact, 200N = 50N x 4 wheels is the maximum force that may be supported by the operator according to the regulations in force regarding work safety.

MECHANICAL MOVING WITH TOWING DEVICES

For mechanical towing, please see the technical specifications to determine the capacity variation.

TEMPERATURE

If operating temperatures in an application differ from the standard range of values, please see the technical specifications to determine the capacity variation.

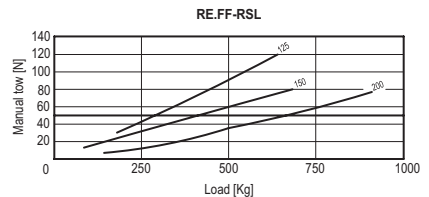
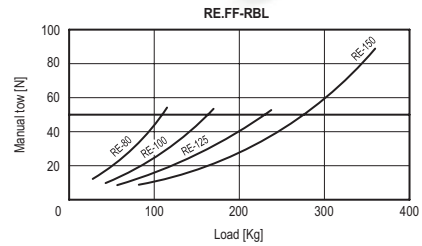

Conversion Table	
1 mm = 0.039 inch	
D	
mm	inch
40	1.56
50	1.95
60	2.34
80	3.12

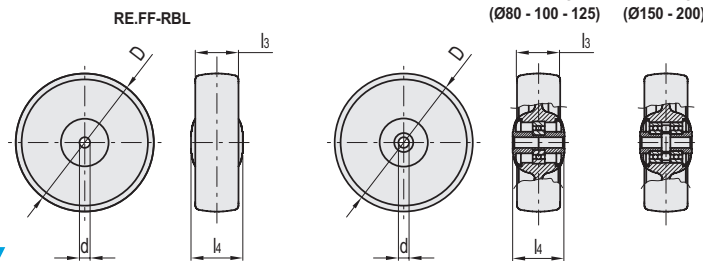

RE.FF-RBL

Code	Description	D	d	l3	l4	Static load# [N]	Rolling resistance# [N]	Dynamic carrying capacity# [N]	
451001	RE.FF-080-RBL	80	12	30	39	2200	1200	1200	110
451006	RE.FF-100-RBL	100	12	30	44	3000	1700	1700	150
451011	RE.FF-125-RBL	125	15	35	44	3500	2300	2300	250
451016	RE.FF-150-RBL	150	20	45	59	5000	2800	3500	470
451018	RE.FF-200-RBL	200	20	50	59	7500	3200	3500	870

RE.FF-RSL

Code	Description	D	d	l3	l4	Static load# [N]	Rolling resistance# [N]	Dynamic carrying capacity# [N]	
451021	RE.FF-080-RSL	80	8	30	40	2200	1300	1300	170
451023	RE.FF-100-RSL	100	8	30	45	3000	2000	2000	210
451025	RE.FF-125-RSL	125	8	35	45	3500	2500	2500	300
451027	RE.FF-150-RSL	150	12	45	60	7000	3000	3500	760
451029	RE.FF-200-RSL	200	12	50	60	7500	3600	4500	1160

For static load, rolling resistance and dynamic carrying capacity see Technical data on page 1296.

Looking for pricing, stock, or lifecycle information?

Click below to explore more details on WIN SOURCE:

- [View 451001 on WIN SOURCE](#)
- [Elesa USA Corporation Information](#)

Optimize Your Supply Chain with WIN SOURCE Solutions

- ✓ Global Sourcing Solution
- ✓ Obsolete Management
- ✓ Cost Control Management
- ✓ Shortage Management
- ✓ Alternative Solution
- ✓ Excess Inventory Management