



**THE DATASHEET OF**  
**2043010001**



# Squba 1.80 and 3.60mm-Pitch Sealed Wire-To-Wire Connector System

**molex**

Squba 1.80 and 3.60mm-Pitch Sealed Wire-to-Wire Connector Systems are designs that offer an IP67-seal rating and carry up to 14.0A of current to deliver reliable power in a wide range of space-constrained applications

## Features and Advantages

### Protected, low-profile positive latch

Prevents wire from getting caught on latch and damaging it. Minimizes latch size to prevent latch from adding to connector's package size

### Mated housings

Offers receptacle and plug housings to fit design need

### Seal caps

Protect seals from damage during shipping, handling and use. Align terminals to prevent seal from being punctured during assembly

### Sealed components with proven performance

Delivers an IP67-sealed rating. Prevents ingress of dust and water to ensure reliable connection

### Voided circuit options (1.80mm-pitch version)

Offers design flexibility for 3, 5, 7 and 9 circuit needs

### Clean-body terminals

Avoids seal punctures

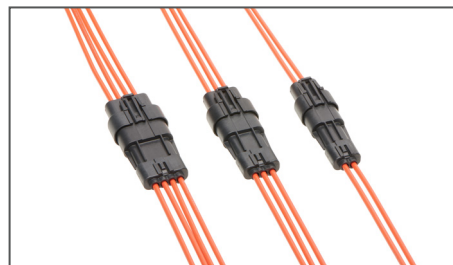
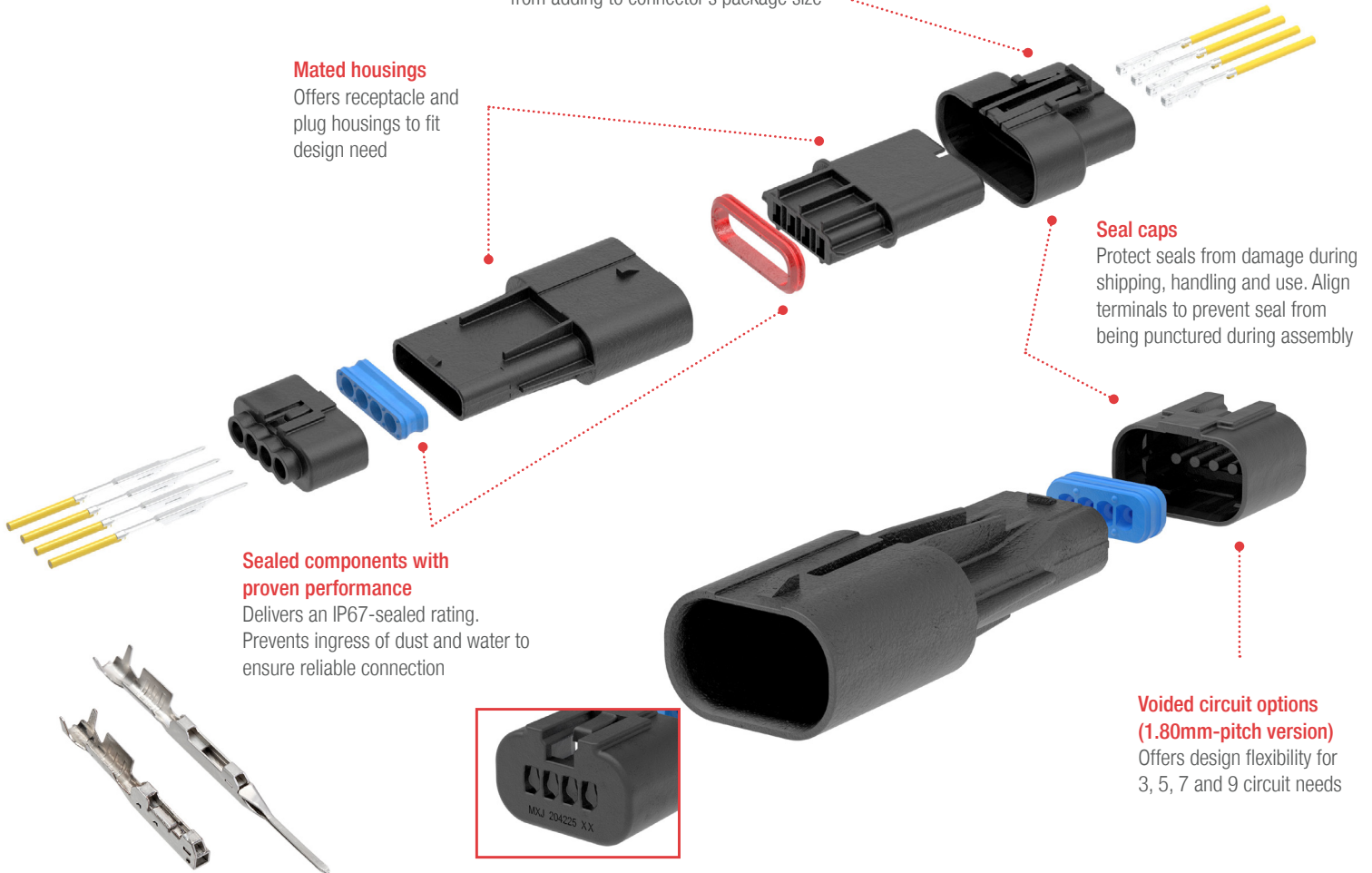

Squba 3.60mm-Pitch Sealed Connector Family, Fully Mated, 2 to 4 Circuits, with a Current of up to 14.0A

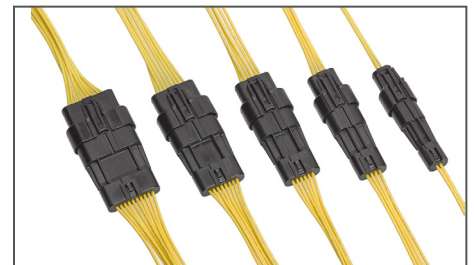

Squba 1.80mm-Pitch Sealed Connector Family, Fully Mated, 2 to 10 circuits, Void Options Available for 3-, 5-, 7- and 9-Circuit Needs, with a Current of up to 6.0A

# Squba 1.80 and 3.60mm-Pitch Sealed Wire-To-Wire Connector System

**molex**

## Markets and Applications

### Consumer

Liquid dispensing equipment  
HVAC equipment  
Landscaping equipment

### Commercial vehicle

ATV  
Marine: under-dash wiring, lighting  
Forklifts  
Trucks  
Buses  
Recreational vehicles

### Industrial

Robotics  
Industrial machines and motors  
Food processing equipment/plants  
Industrial controls

### Connected Home

Security and surveillance  
Smart appliance  
Home health and wellness  
Home automation



Security Systems



HVAC



Robotic Arm



ATV

## Specifications

### REFERENCE INFORMATION

Receptacle Packaging: Tray  
Plug Packaging: Bulk  
Crimp Terminal Packaging: Reels  
UL File No.: TBD  
CSA File No.: TBD

	<b>1.80mm</b>	<b>3.60mm</b>
Use With:	22 to 24 AWG	16 to 20 AWG
Insulation Diameter:	0.95 to 1.40mm	1.50 to 2.40mm
Designed In:	Millimeters	
RoHS:	Yes	
Halogen Free:	No	
Glow Wire Compliant:	TBD	
IP Rating:	IP67	

### ELECTRICAL

	<b>1.80mm</b>	<b>3.60mm</b>
Voltage (max.):	125V	600V
Current (max.):	6.0A	14.0A
Contact Resistance:	10 milliohms	
Dielectric Withstanding Voltage:	Leakage < 5mA	
Insulation Resistance (min.):	100 Megohms	

### MECHANICAL

Terminal Retention to Housing (min.): 30N  
Mating Force (max.): 45N  
Unmating Force (max.): 35N  
Durability (max.): 10 Cycles

### PHYSICAL

Housing: Plastic  
Contact: Copper Alloy  
Plating:  
Overall — Tin  
Underplating — Nickel  
Operating Temperature: -40 to +105°C

# Squba 1.80 and 3.60mm-Pitch Sealed Wire-To-Wire Connector System



## Ordering Information

### Squba 1.80mm Receptacles

Parts	Description	Circuits	Seal Plug Position
<a href="#">2042200002</a>	Sealed Receptacles	2	none
<a href="#">2042200004</a>		4	
<a href="#">2042200006</a>		6	
<a href="#">2042200008</a>		8	
<a href="#">2042200010</a>		10	
<a href="#">2042201110</a>		9	10
<a href="#">2042204004</a>		3	4
<a href="#">2042206006</a>		5	6
<a href="#">2042208008</a>		7	8

### Squba 1.80mm Plugs

Parts	Description	Circuits	Seal Plug Position
<a href="#">2042230002</a>	Sealed Plugs	2	none
<a href="#">2042230004</a>		4	
<a href="#">2042230006</a>		6	
<a href="#">2042230008</a>		8	
<a href="#">2042230010</a>		10	
<a href="#">2042231110</a>		9	10
<a href="#">2042234004</a>		3	4
<a href="#">2042236006</a>		5	6
<a href="#">2042238008</a>		7	8

### Squba 1.80mm Terminals

Parts	Description	Wire Gauge (AWG)
Receptacle Terminals		
<a href="#">2043010001</a>	Matte Tin Plating	22-24
Plug Terminals		
<a href="#">2042261001</a>	Matte Tin Plating	22-24

### Squba 3.60mm Receptacles

Part No.	Component	Circuits
<a href="#">2077820002</a>	Sealed Receptacles	2
<a href="#">2077820003</a>		3
<a href="#">2077820004</a>		4

### Squba 3.60mm Terminals

Series		Wire Gauge (AWG)	
Receptacle Terminals			
<a href="#">2077770001</a>	Matte Tin Plating	16	Reel
<a href="#">2077770002</a>		18-20	
Plug Terminals			
<a href="#">2077760001</a>	Matte Tin Plating	16	Reel

### Squba 3.60mm Plugs

Part No.	Component	Circuits
<a href="#">2077780002</a>	Sealed Plugs	2
<a href="#">2077780003</a>		3
<a href="#">2077780004</a>		4

[www.molex.com/link/squba.html](http://www.molex.com/link/squba.html)

Molex is a registered trademark of Molex, LLC in the United States of America and may be registered in other countries; all other trademarks listed herein belong to their respective owners.

## Looking for pricing, stock, or lifecycle information?

Click below to explore more details on WIN SOURCE:

 [View 2043010001 on WIN SOURCE](#)

 [Molex, LLC Information](#)

## Optimize Your Supply Chain with WIN SOURCE Solutions

-  Global Sourcing Solution
-  Obsolete Management
-  Cost Control Management
-  Shortage Management
-  Alternative Solution
-  Excess Inventory Management